

RANÁ DOBA BRONZOVÁ – LEVANTA, JORDÁNSKO A MEZOPOTÁMIE

Jižní Levanta

Map of relevant Early Bronze Age Sites in the Levant

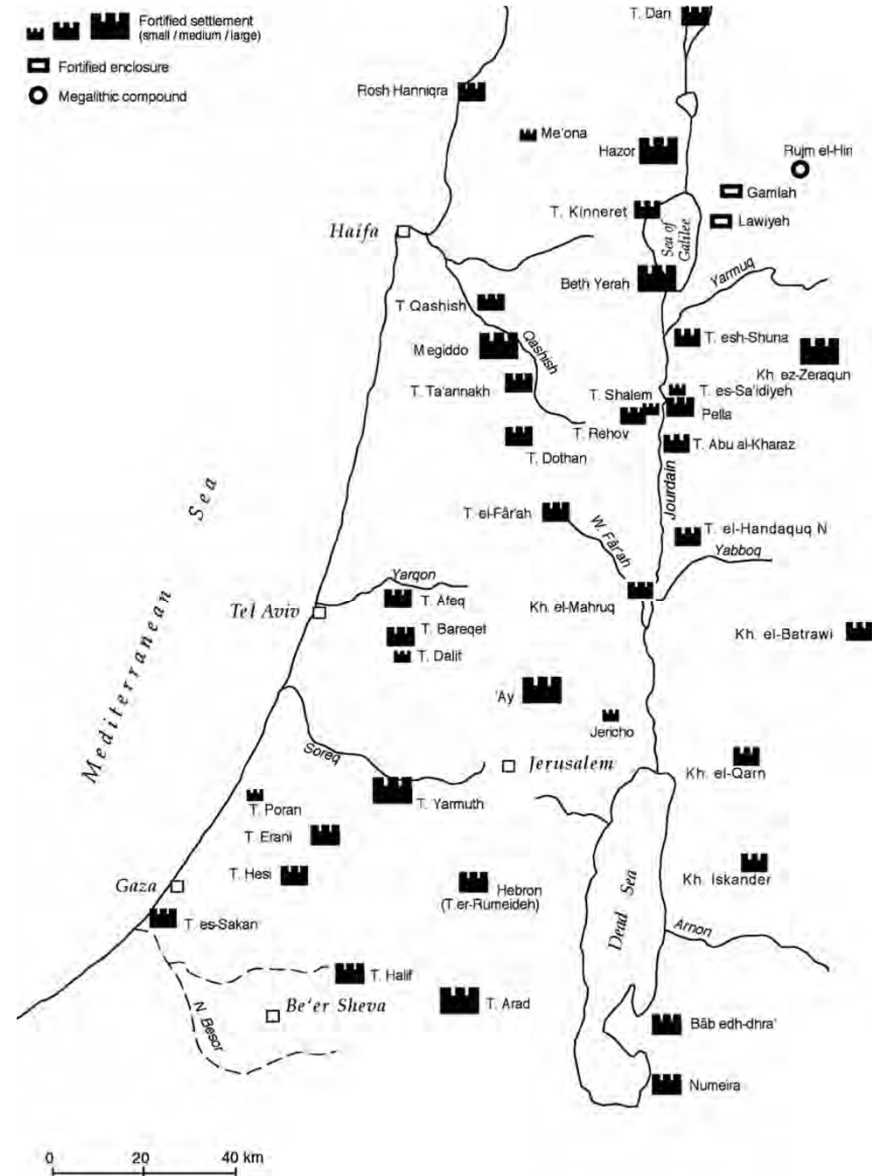

ARAD

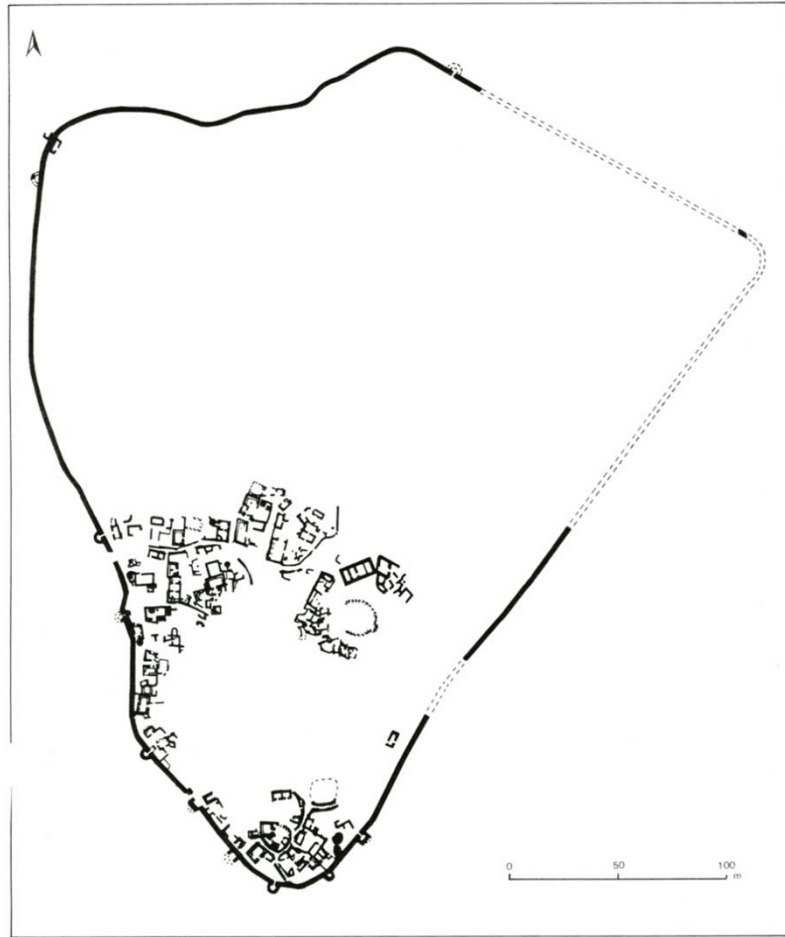

Jordánsko

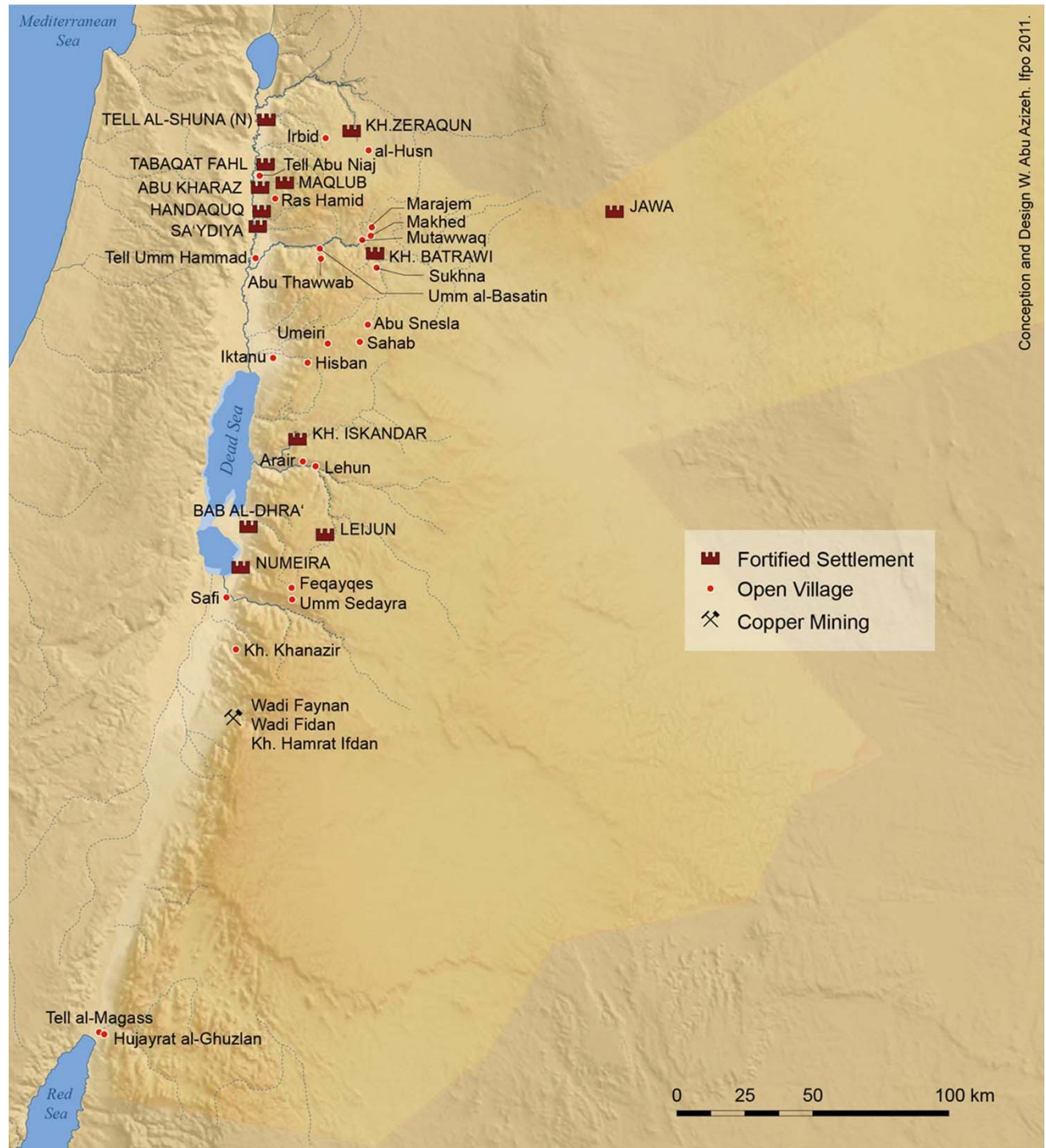

BÁB EDH-DHRÁ

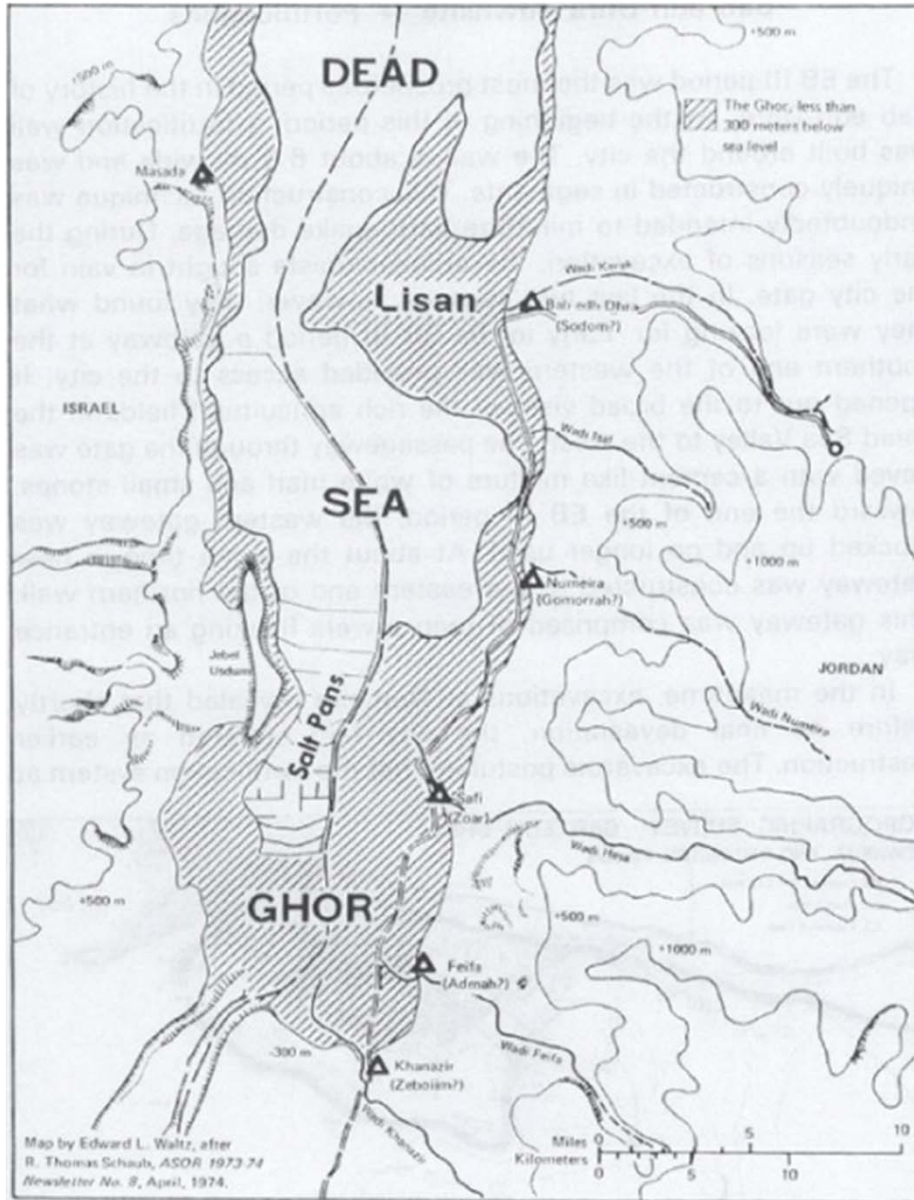

Sumerská města - ED

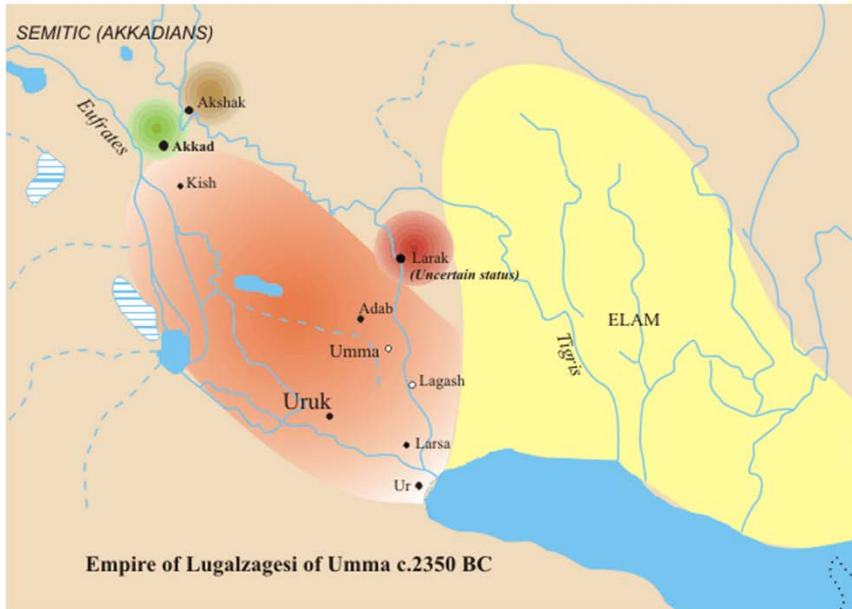

Panství krále Lugalzagesi z Ummy



Královské pohřebiště v Uru

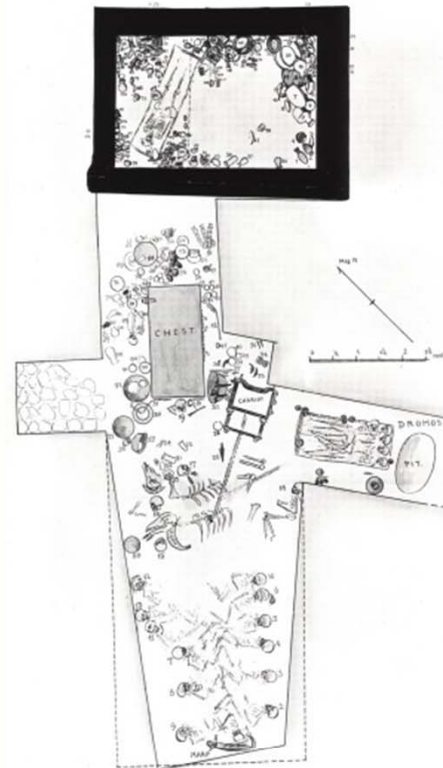
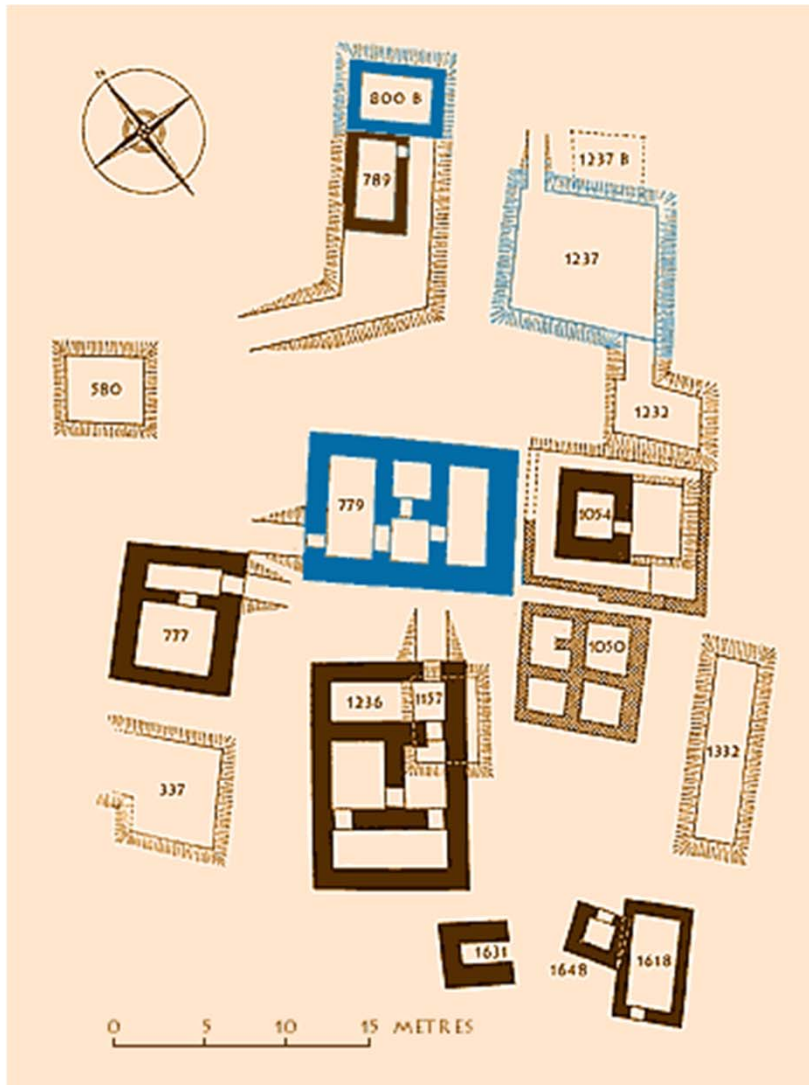

PG 800, královna Puabi

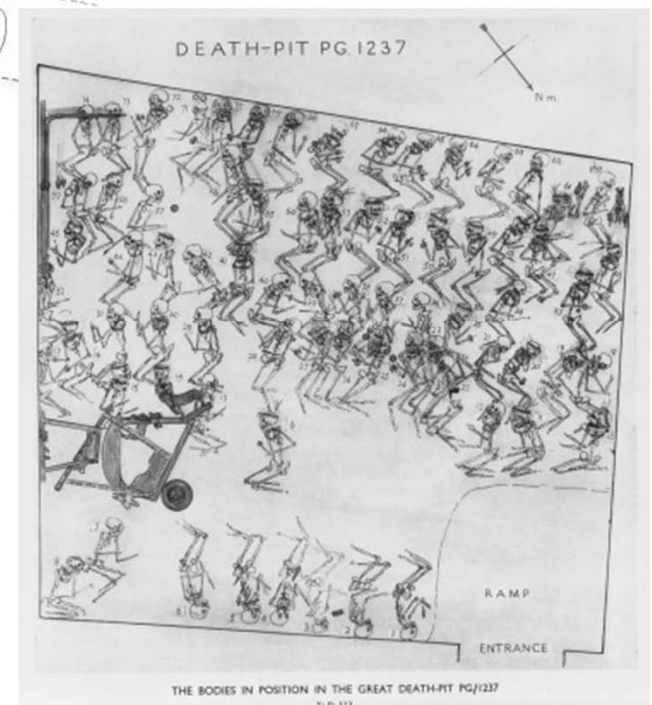

PG 1237, tzv. velká pohřební jáma

Staroakkadská říše



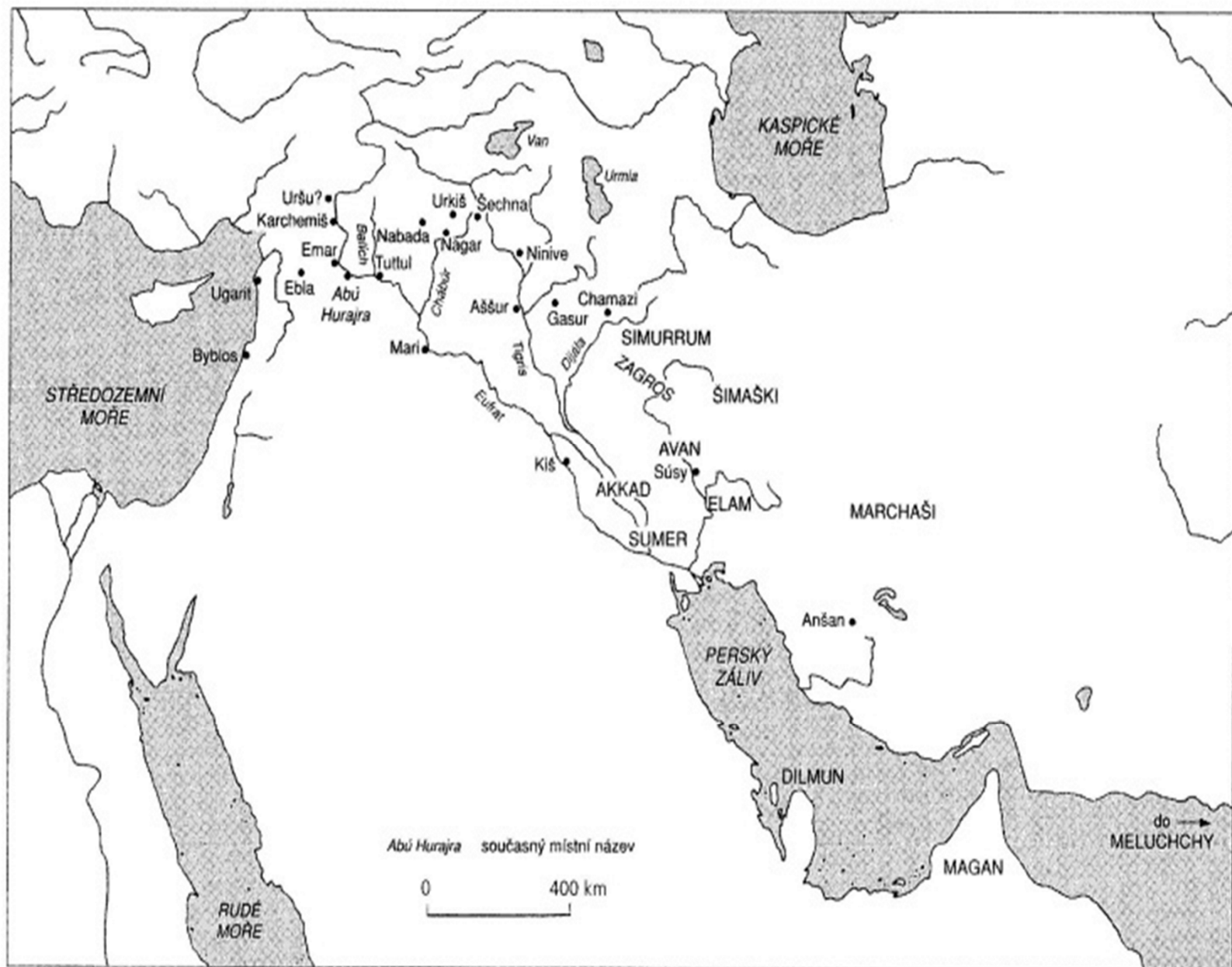

Mapa 3.2 Blízky východ okolo roku 2400

Třetí dynastie z Uru



S LEVANTA

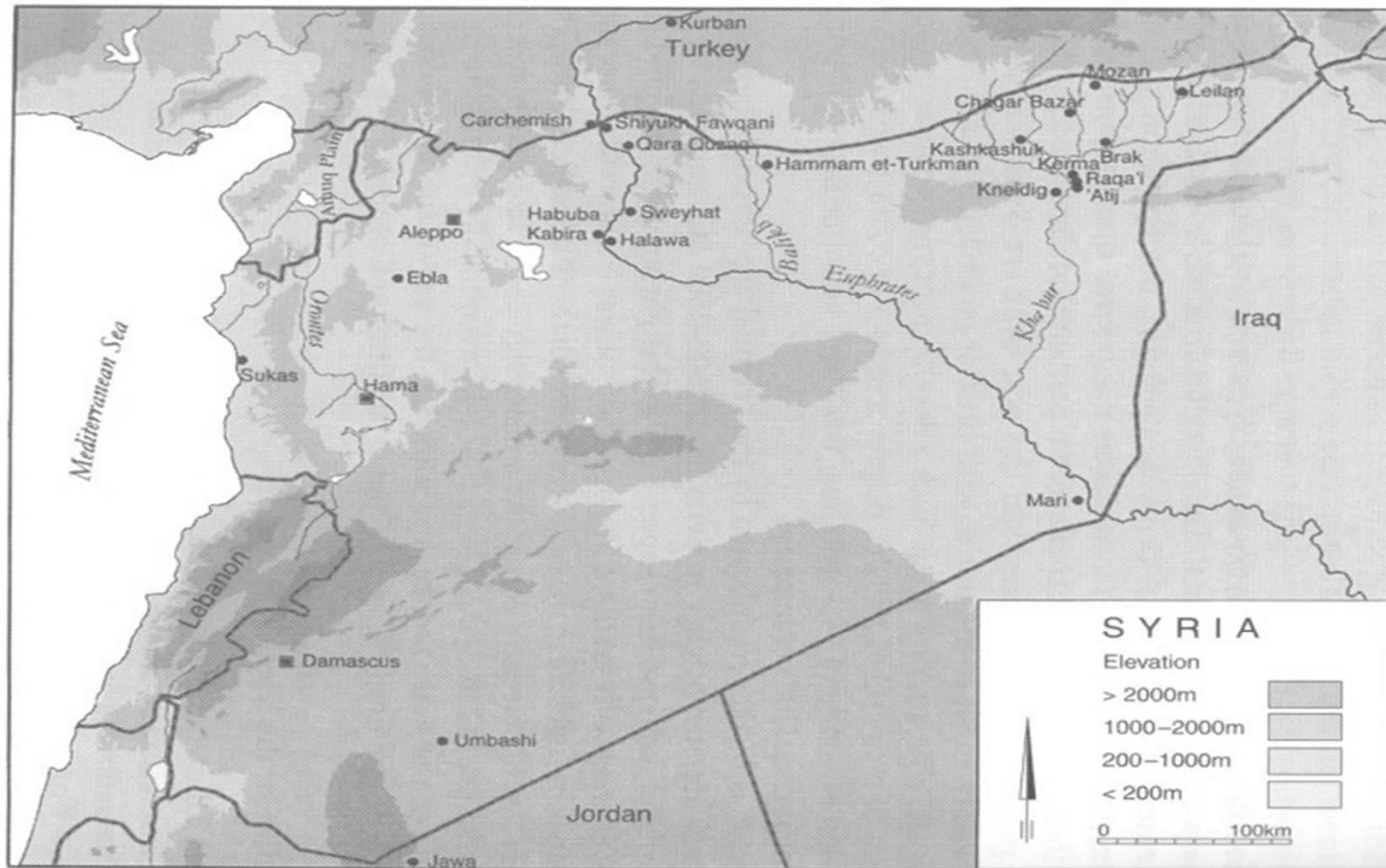

Fig. 7.1 Syria in the early third millennium BC.

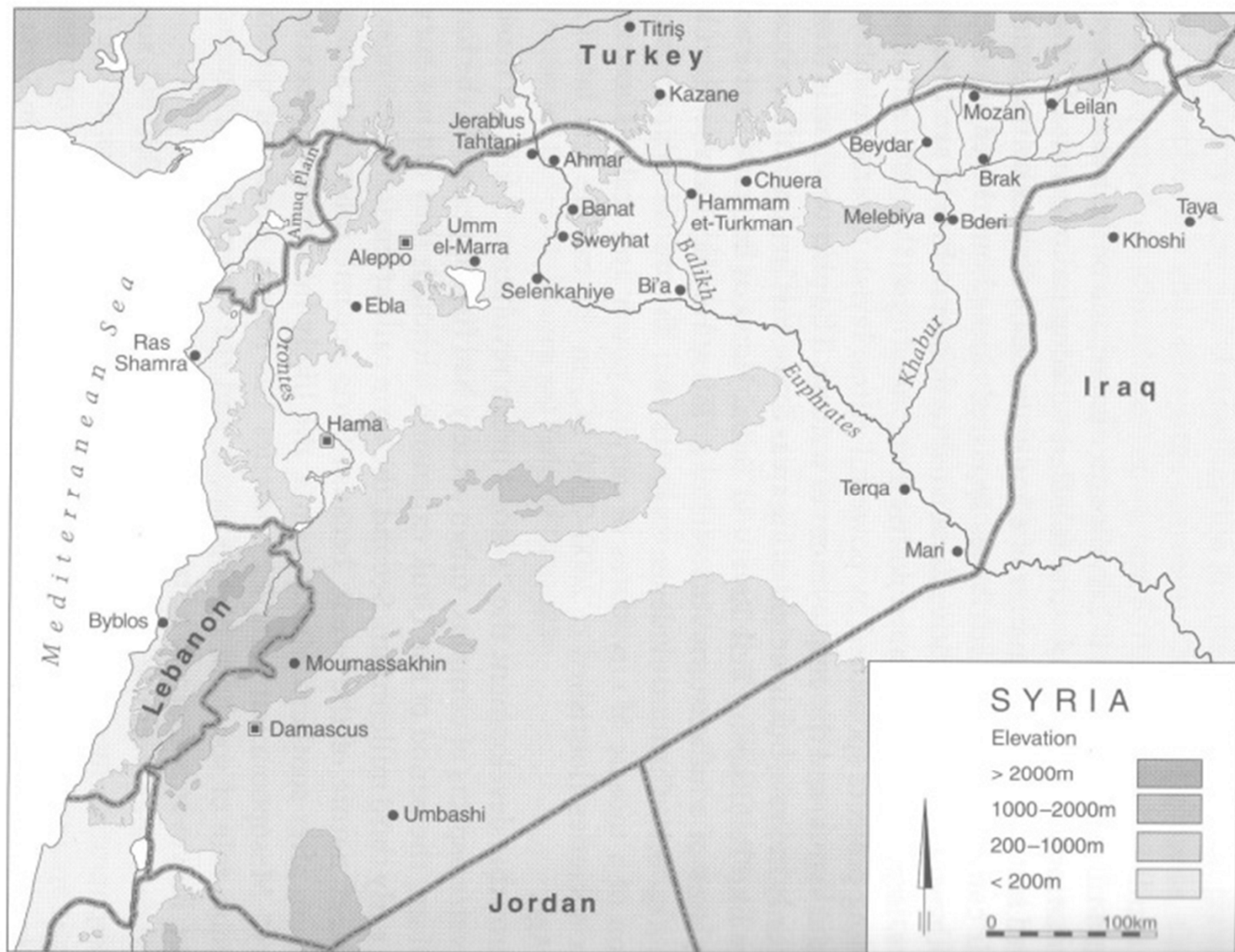
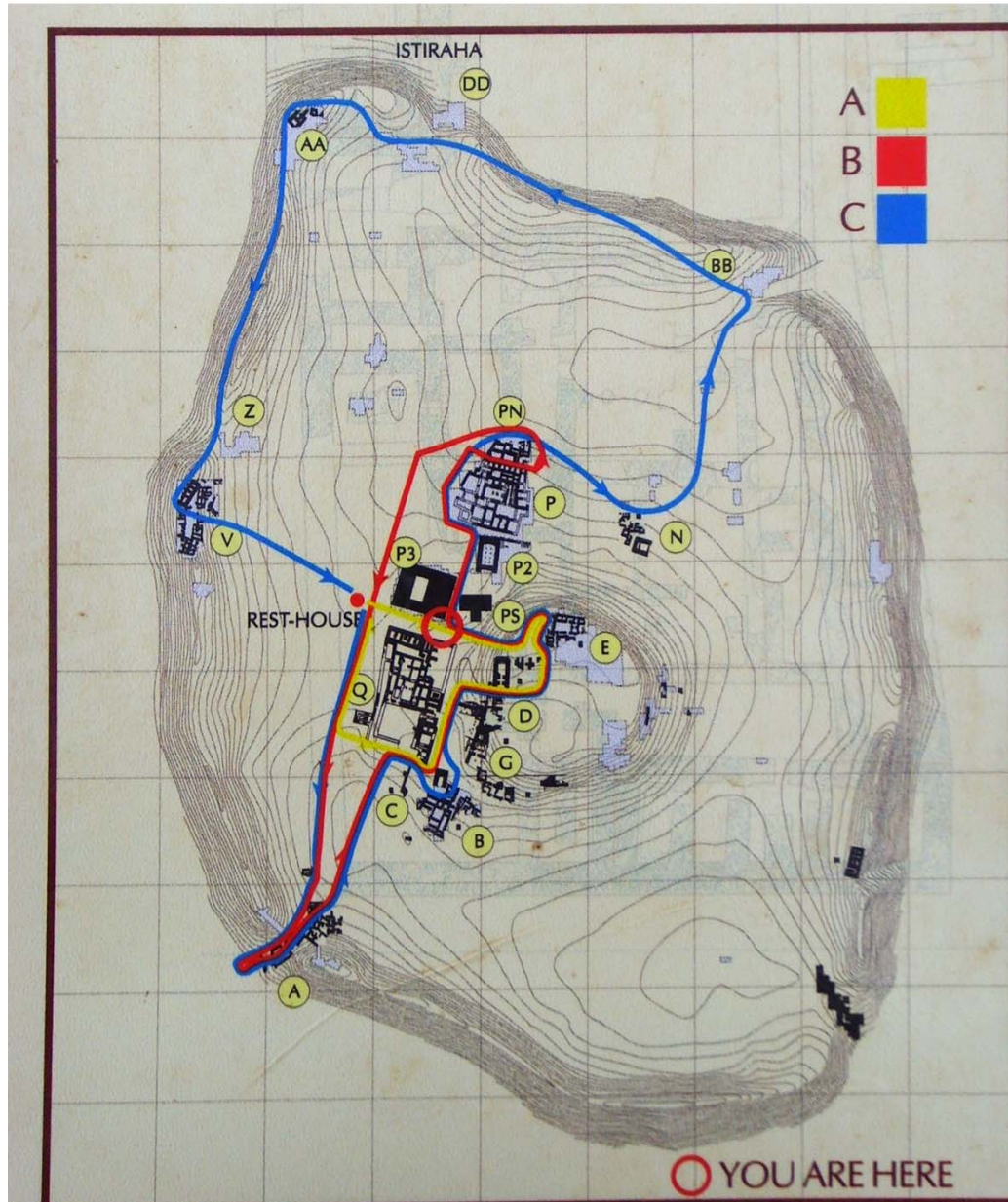
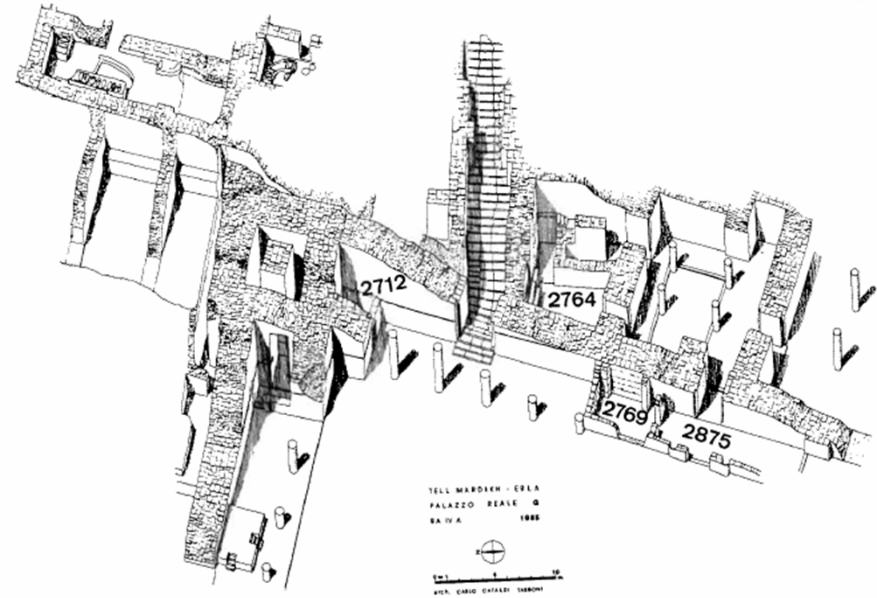

Fig. 8.1 Syria in the mid/late third millennium BC.

EBLA



Ebla, královský palác G a archiv



MARI

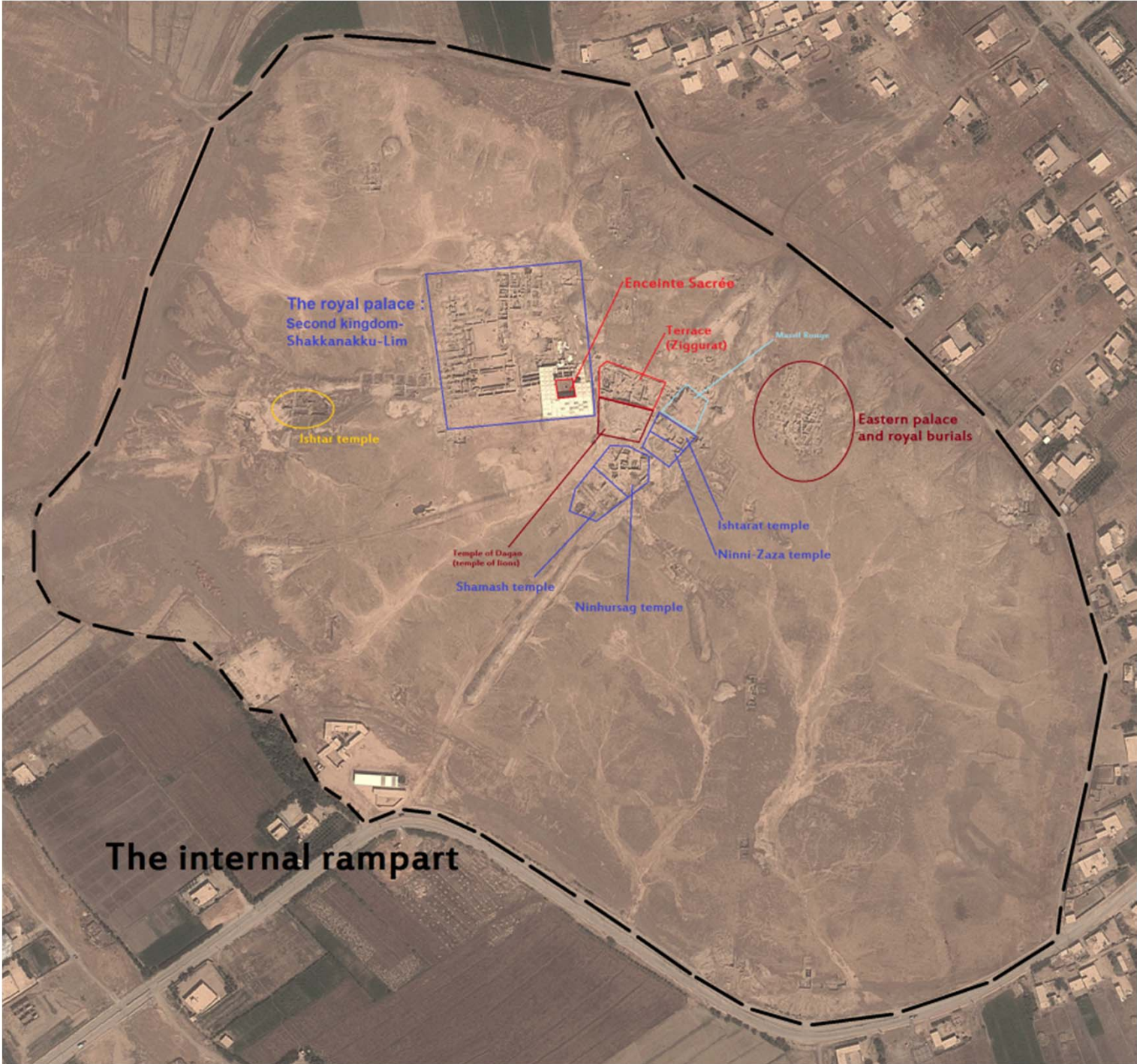

1. království Ebly a Mari



2. království Ebly a Mari

