

EGYPT – PRVNÍ PŘECHODNÉ
OBDOBÍ, STŘEDNÍ ŘÍŠE A DRUHÉ
PŘECHODNÉ OBDOBÍ –
dodatečné materiály, mapy
apod.

První přechodné období

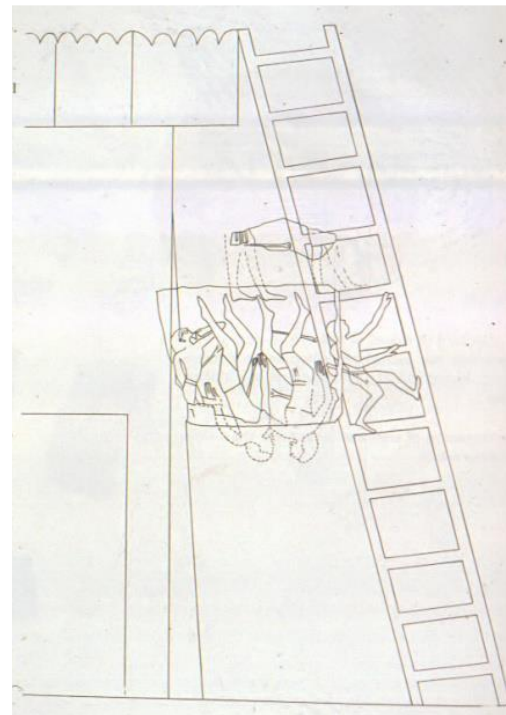

Boje během FIP



F.I.P.-MIDDLE KINGDOM

Dynasty 11 (2160-1991 B.C.)

The Tomb of General Intef at Thebes



SIEGE WARFARE: Mobile siege tower

F.I.P.-MIDDLE KINGDOM

Dynasty 11 (2160-1991 B.C.)

The Tomb of Khety at Beni Hasan

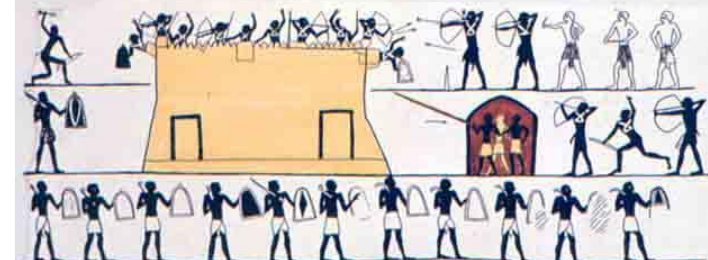

SIEGE WARFARE:

Battering ram & protective covering

MENTUHOTEP II. - sjednotitel

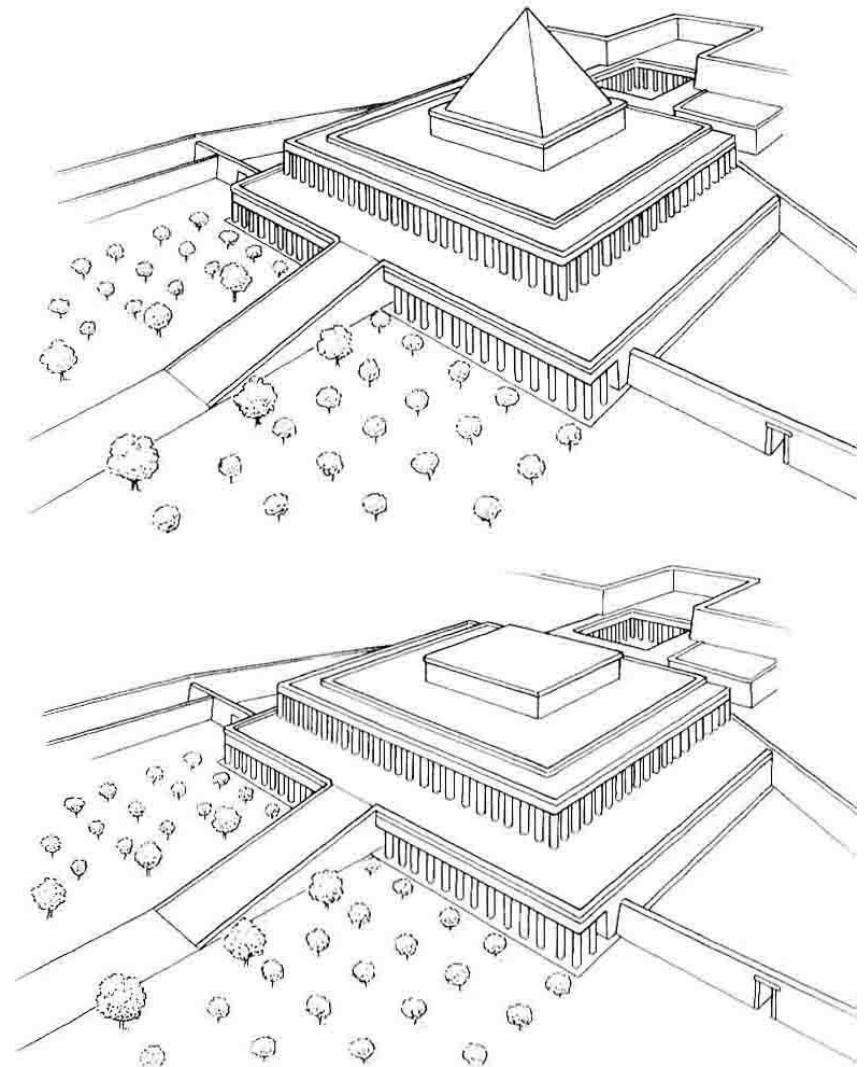
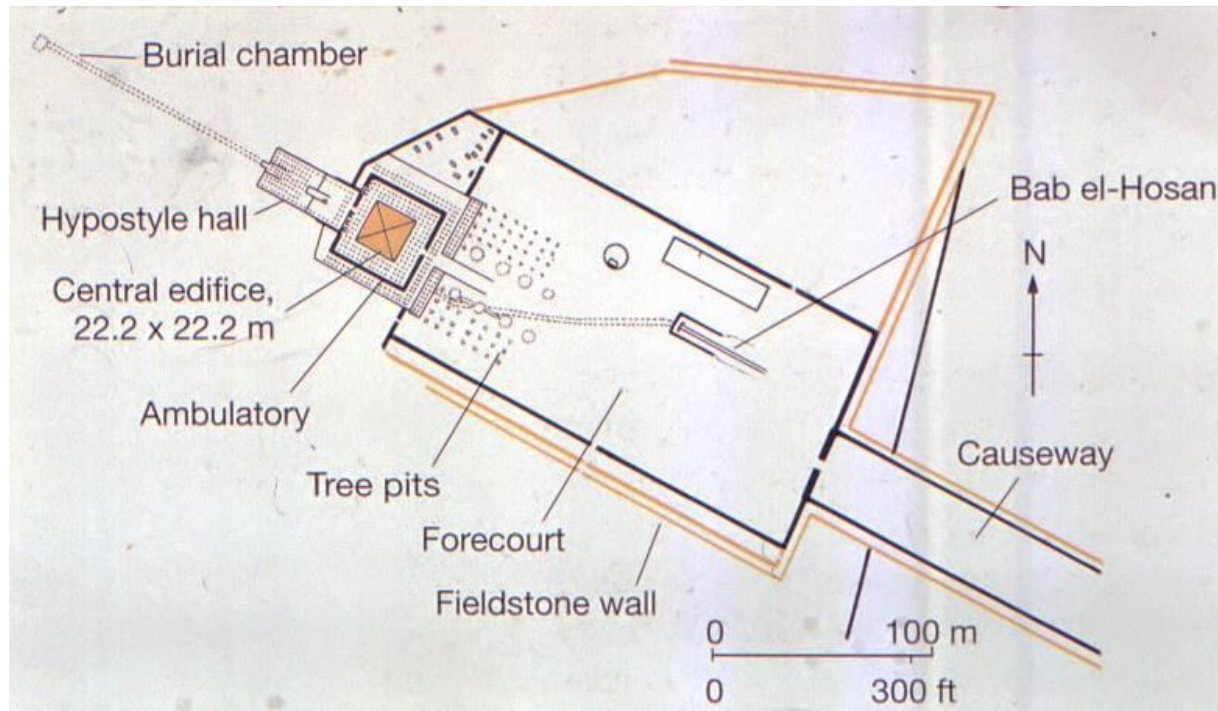

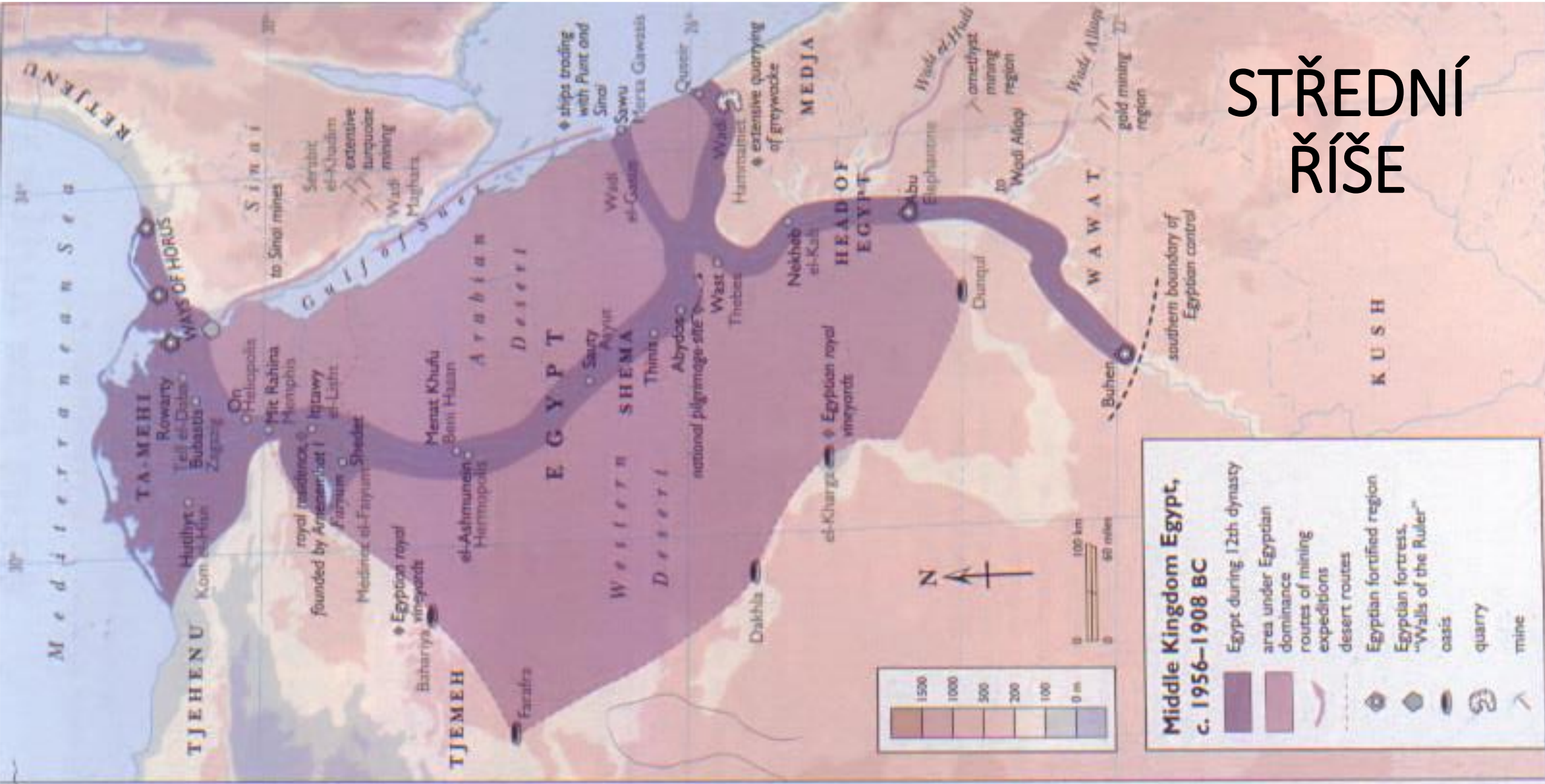

STŘEDNÍ ŘÍŠE

Middle Kingdom Egypt, c. 1956-1908 BC

- Egypt during 12th dynasty
- area under Egyptian dominance
- routes of mining expeditions
- desert routes
- Egyptian fortified region
- Egyptian fortress, "Walls of the Ruler"
- oasis
- quarry
- mine

Pohřebiště v
Il-Láhúnu –
nové hlavní
město Ic-Tauej

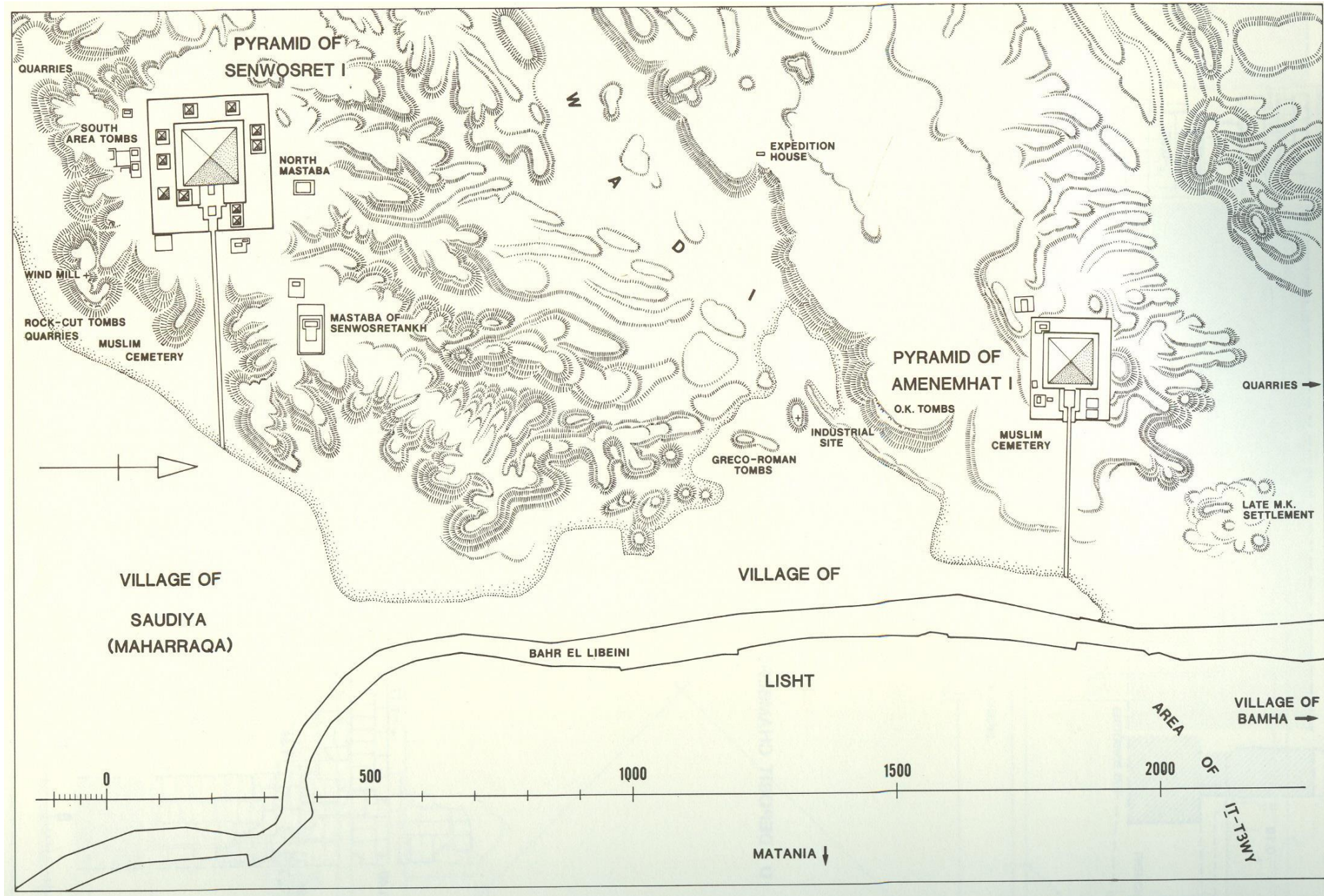

Amenemhet II – poklad z Todu



Fajjúmská oáza

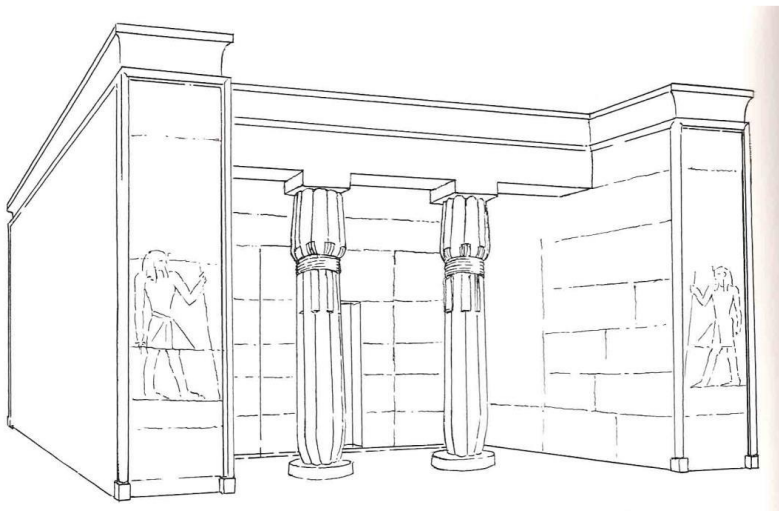

Chrám v Medinet Madi



Střední říše – lokality v Núbii

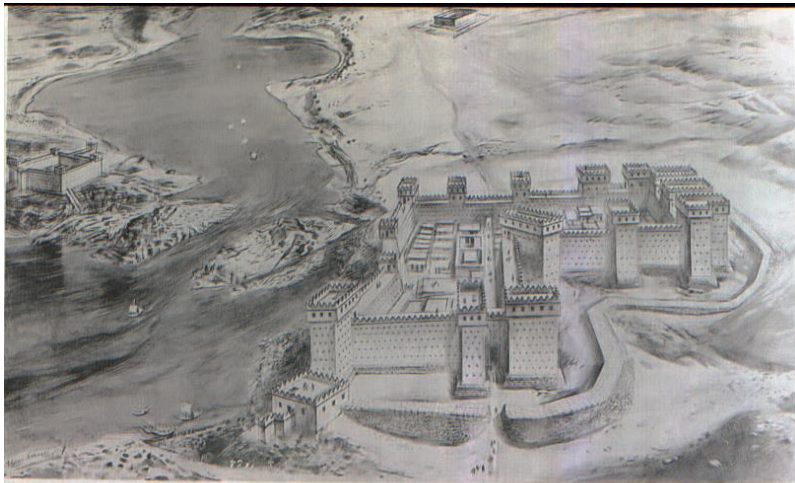

The fortress of Semna; a reconstruction by A. Sorrell.

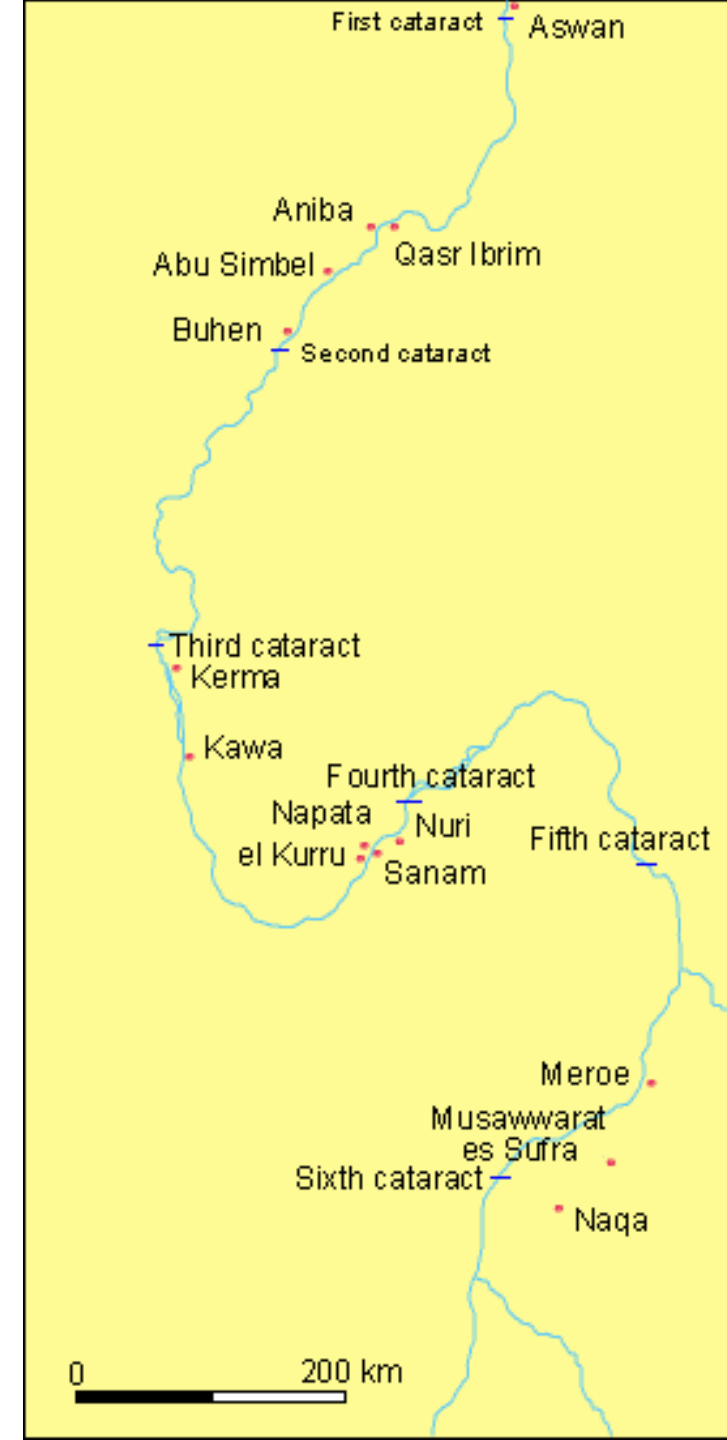
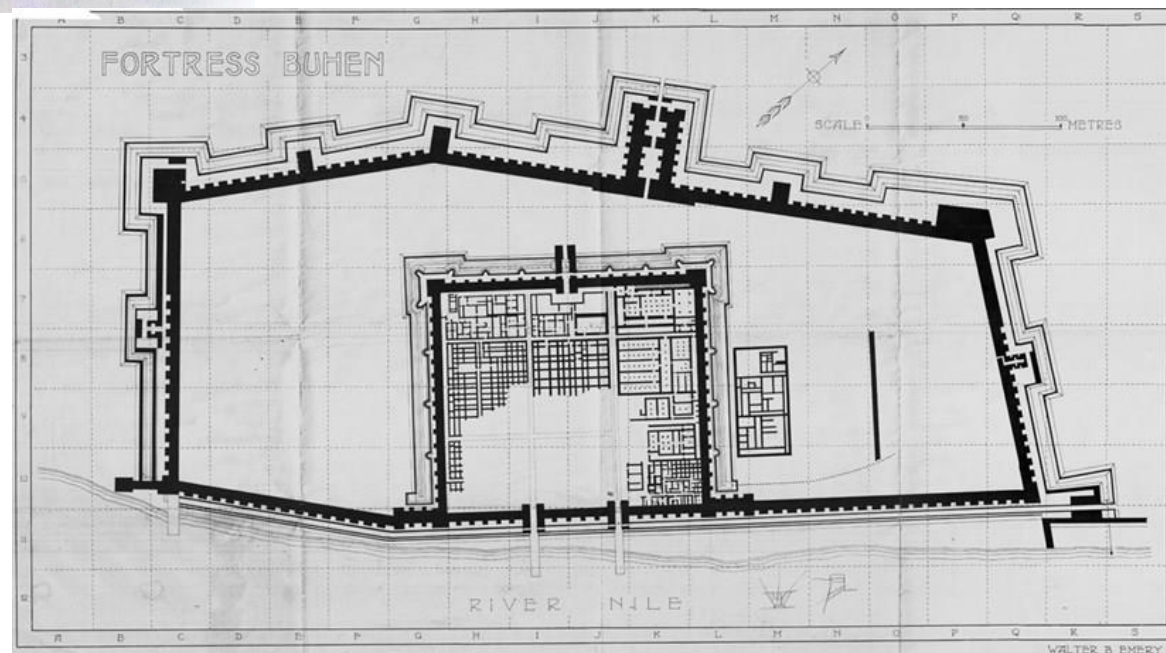

SIP

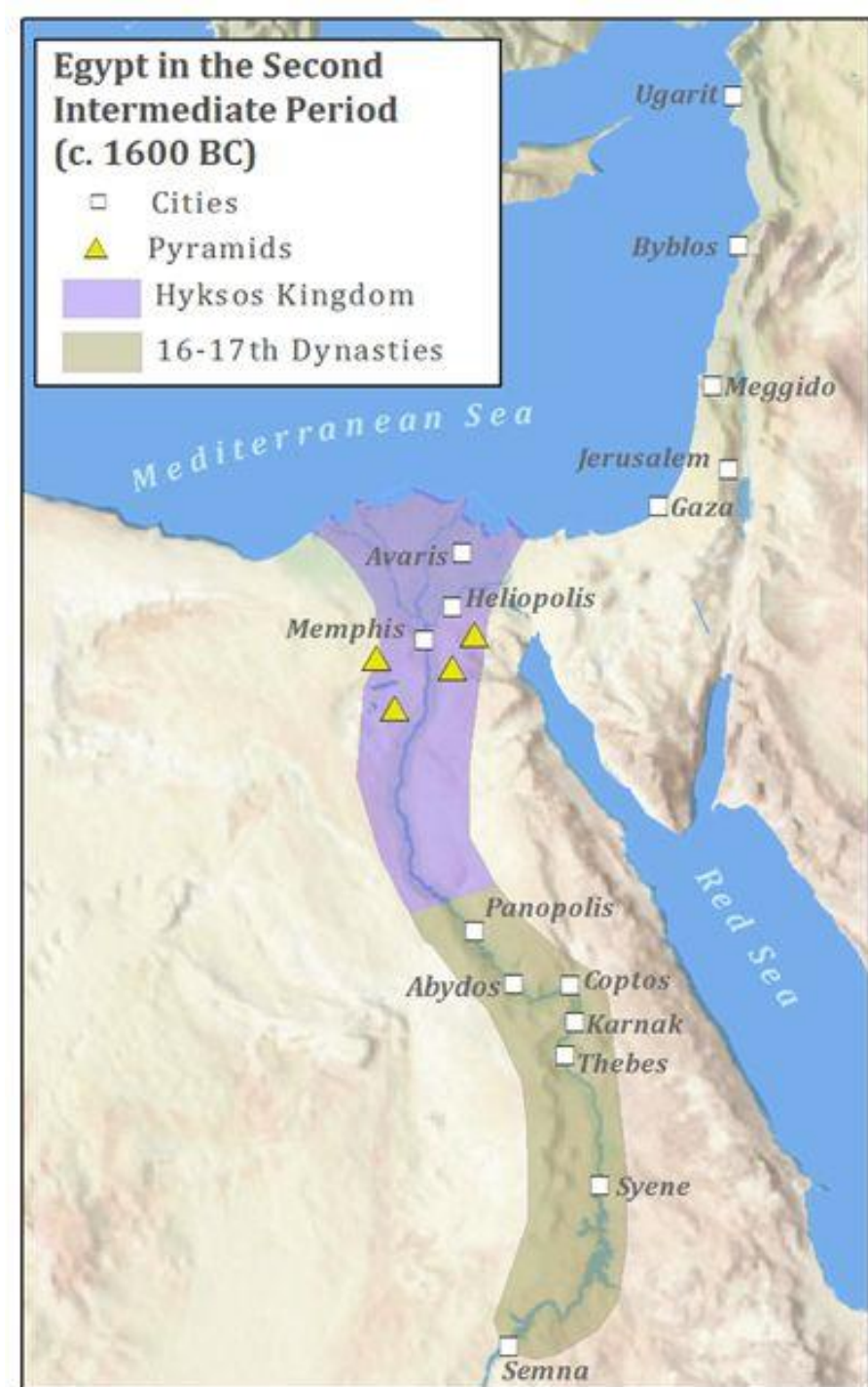

AVARIS

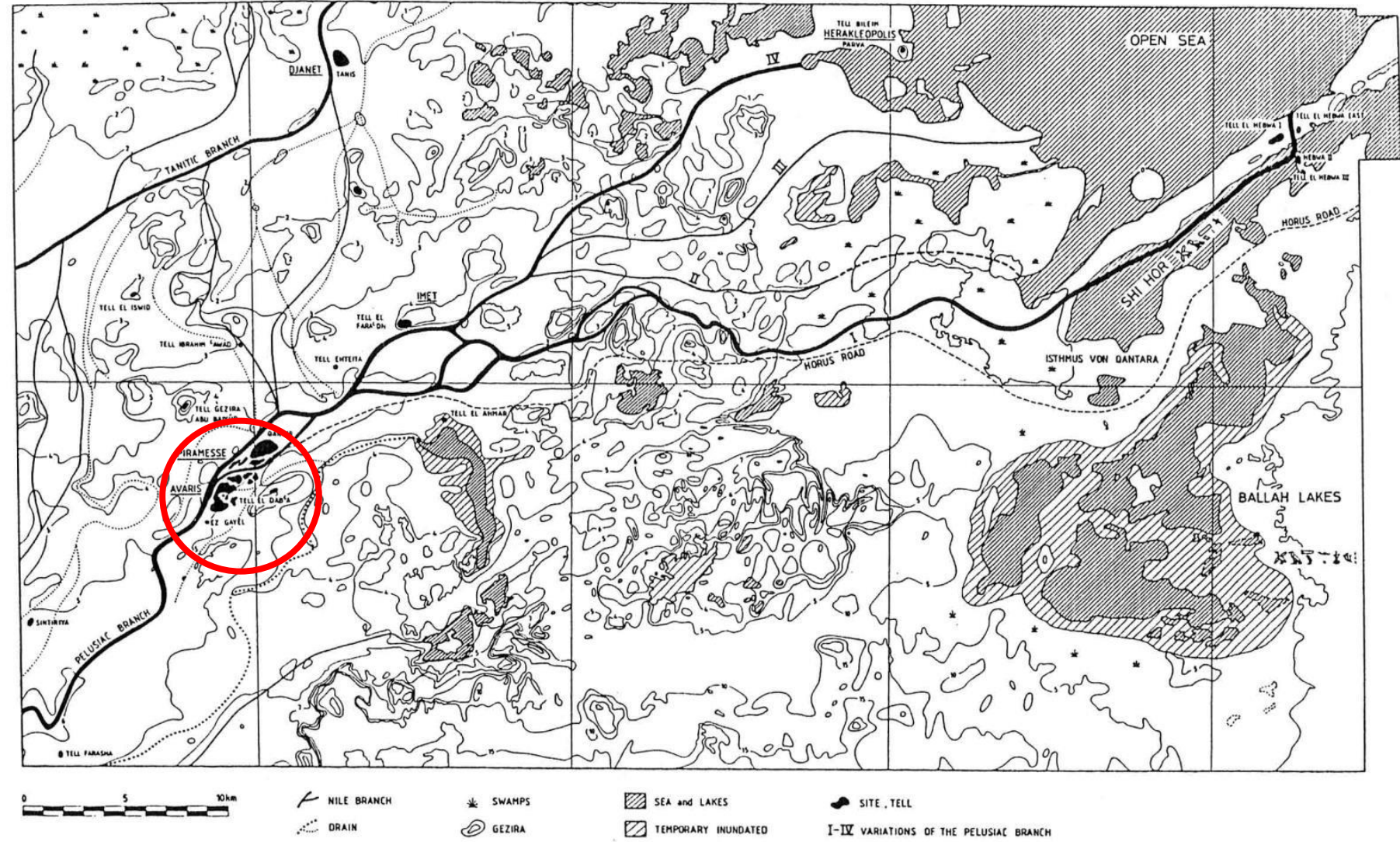
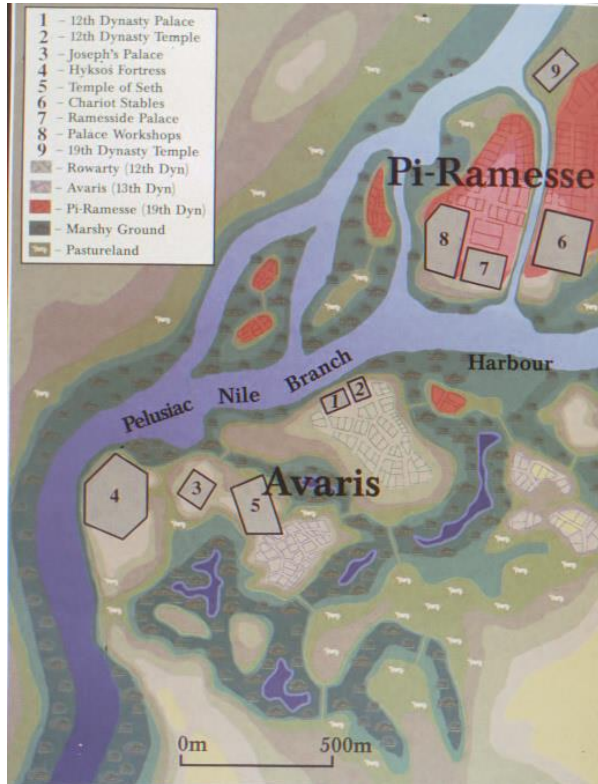

Fig. 1 Map of the eastern Delta and a reconstruction of the ancient environment and Nile branches.

MITTELSAALHOUSE



Fig. 8 A Syrian 'Mittelsaalhaus' from the settlement of the late 12th Dynasty.

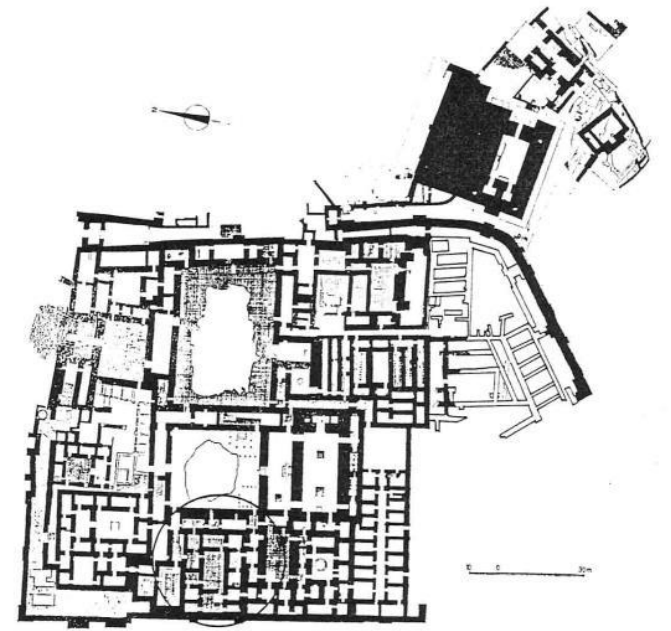

Fig. 9 The palace of Mari with 'Mittelsaalhaus'-elements encircled.

