

Ubaid a Uruk v Mezopotámii

UBAID



Sídelní struktura

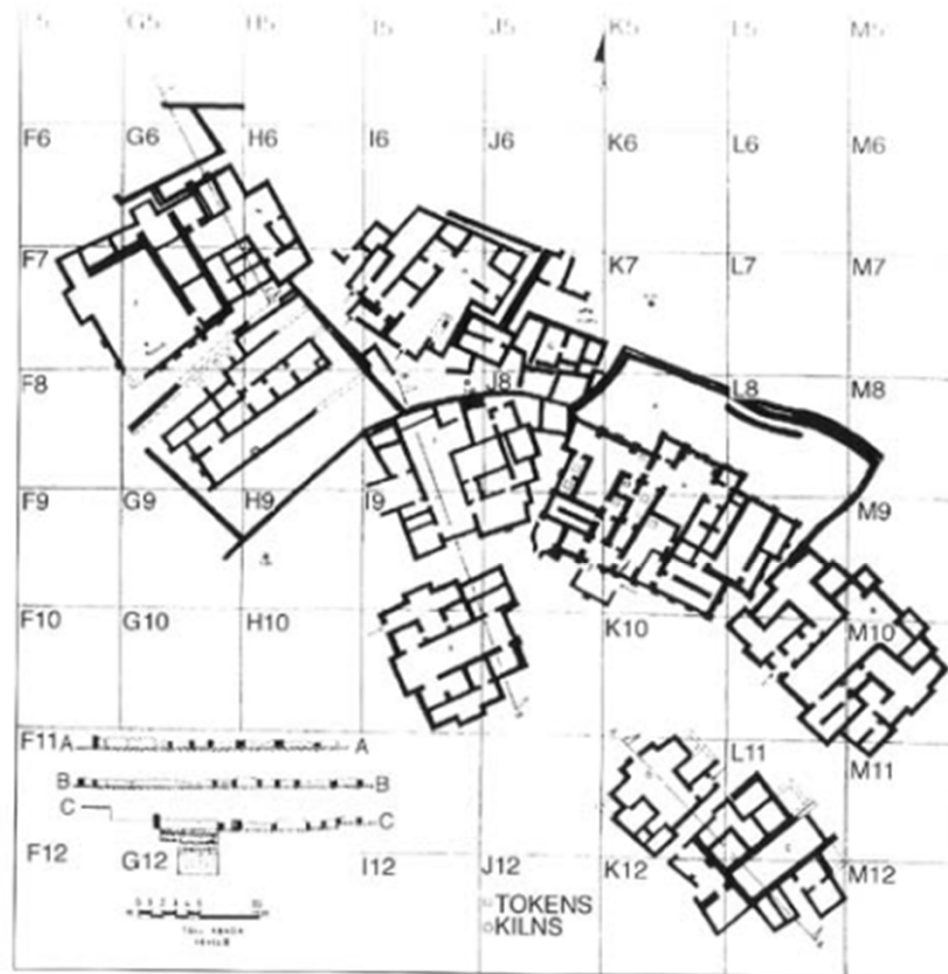
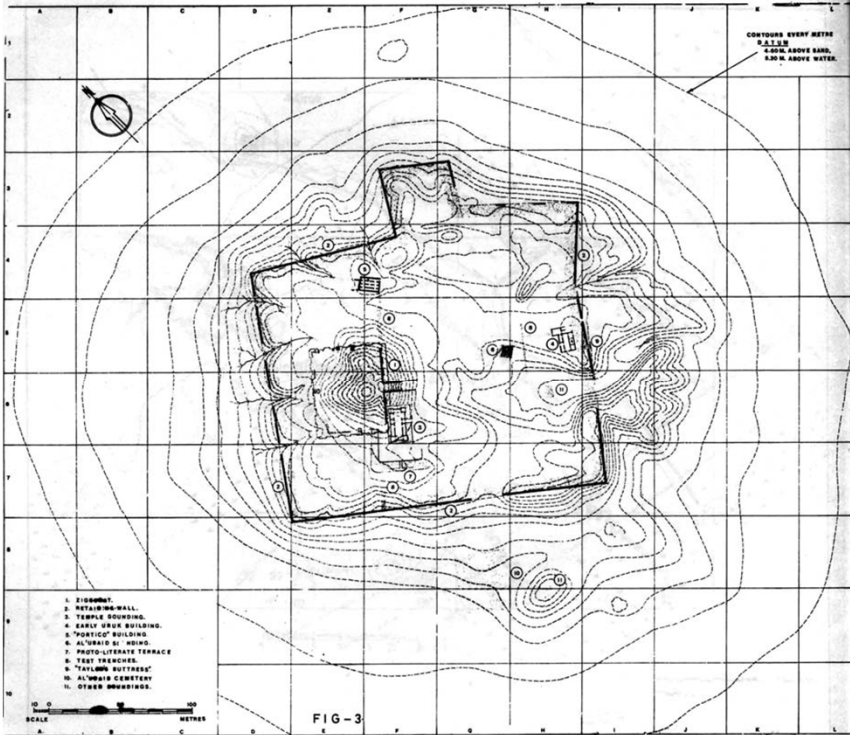
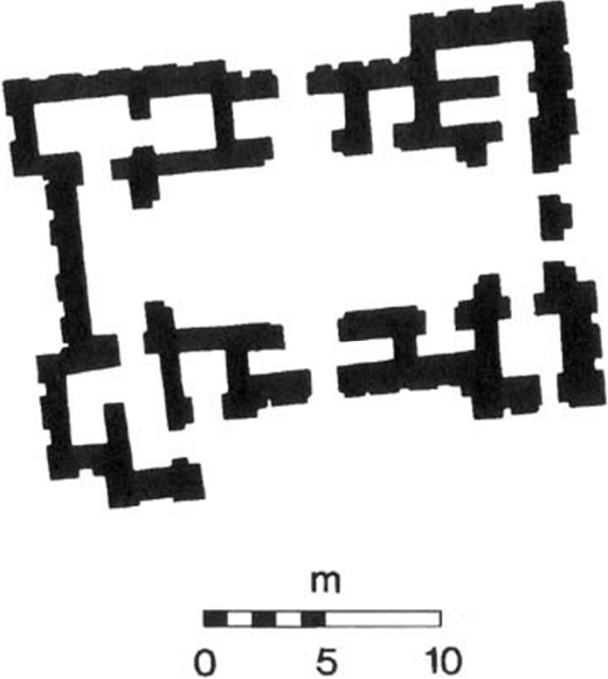

Figure 3.23 Plan of the Level II settlement at Tell Abada showing large houses rightly nucleated (early Ubaid 3)

Source: Jasim 1985, pt 2: fig. 13

ERIDU



3.3 Temple from Eridu (after Safar et al. 1981:fig. 39, Temple VII)

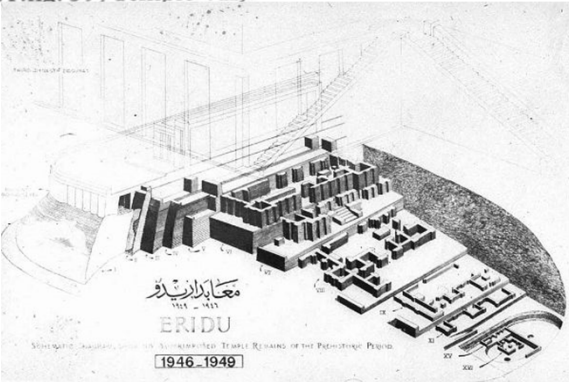

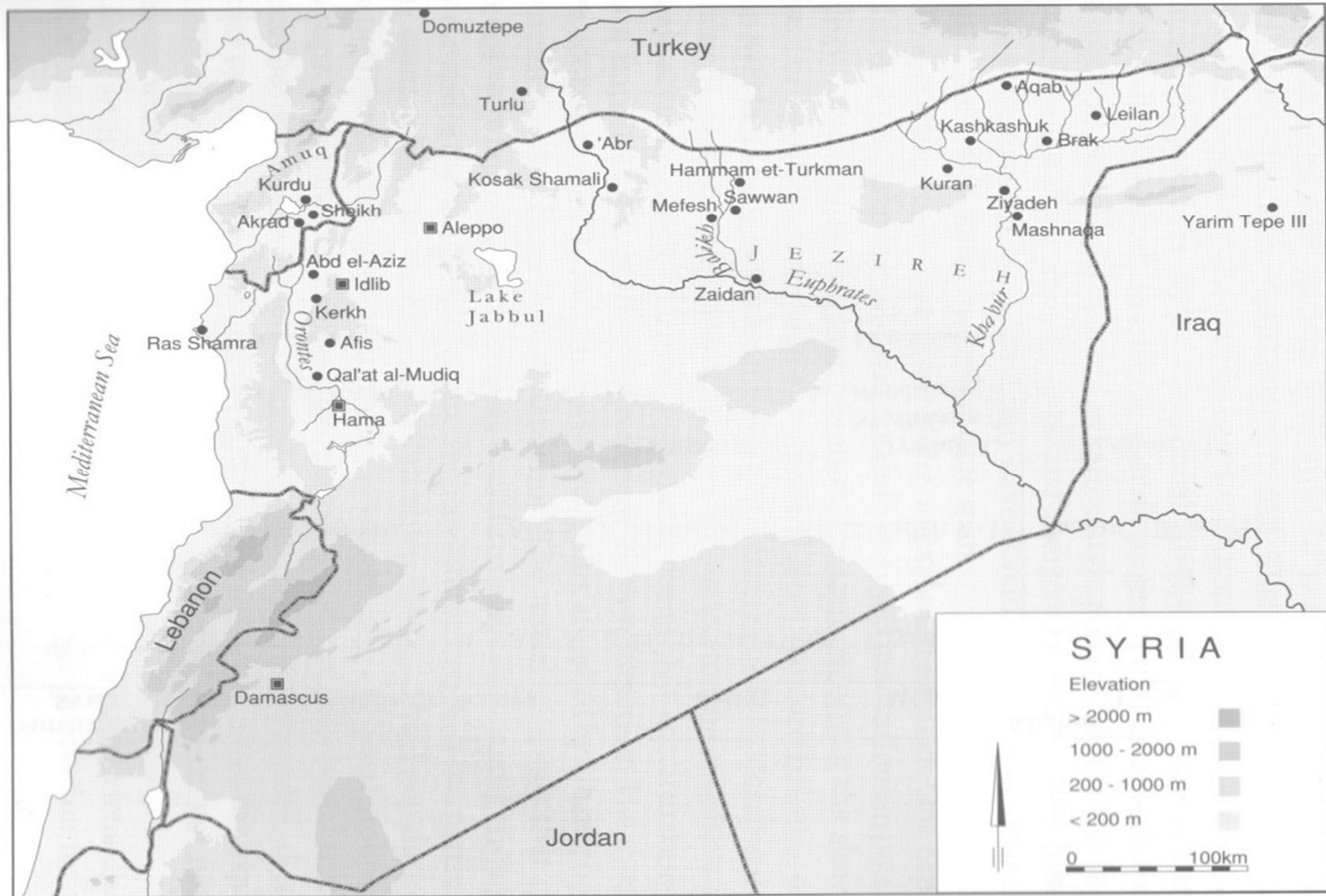
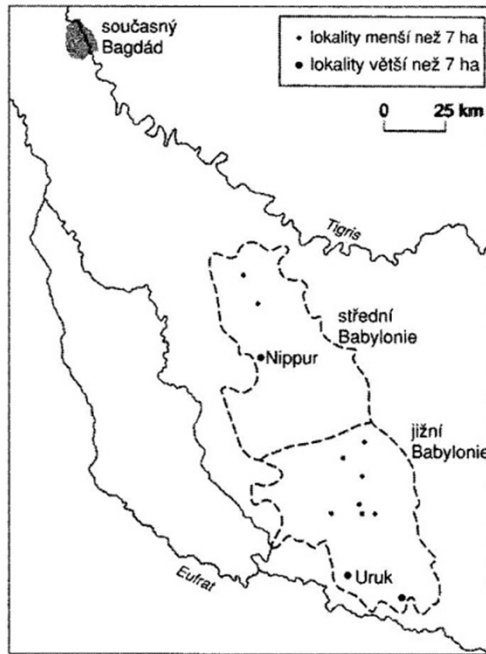
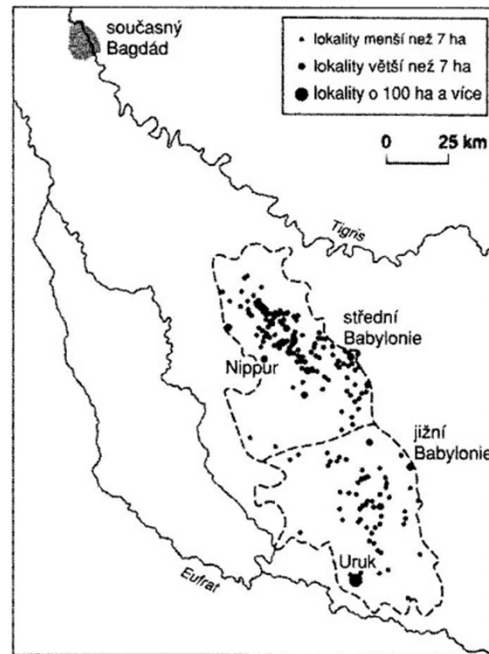

Fig. 5.1 Syria in the late sixth and fifth millennia BC, with the main Ubaid sites mentioned in the text.



(a) obejdské období



(b) rané urucké období

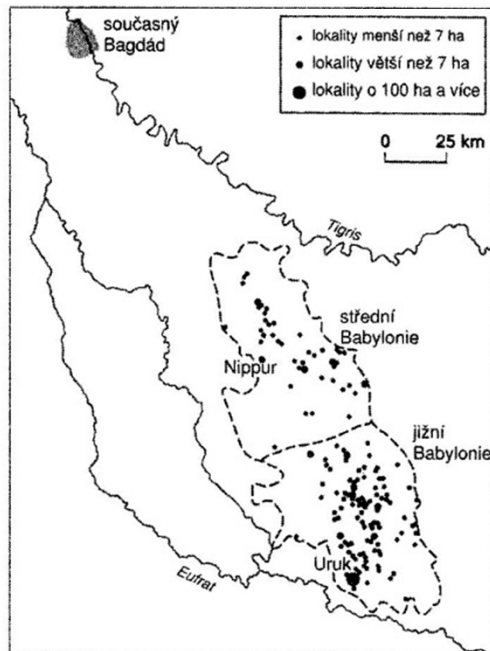

(c) pozdní urucké období

Osídlení J Mezopotámie

Hmotná kultura urucké kultury



URUK, Warka

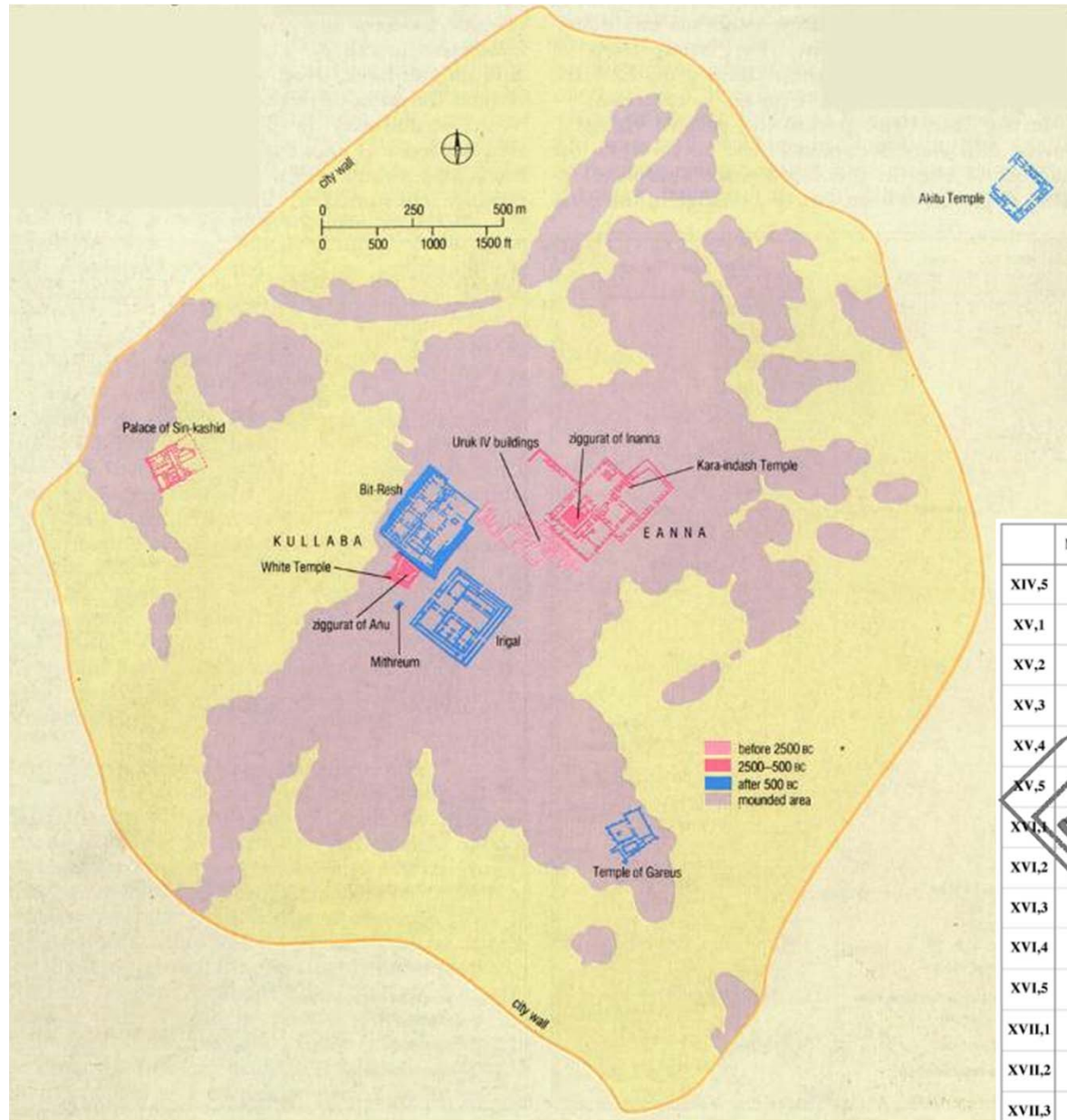

Pozdní Uruk IV, ca. 3200-3000 BC

	Me	Na	Nb	Nc	Nd	Ne	Oa	Ob	Oc	Od	Oe	Pa	Pb	Pc	Pd	Pe	Qa
XIV,5																	
XV,1																	
XV,2																	
XV,3																	
XV,4																	
XV,5																	
XVI,1																	
XVI,2																	
XVI,3																	
XVI,4																	
XVI,5																	
XVII,1																	
XVII,2																	
XVII,3																	
XVII,4																	
XVII,5																	

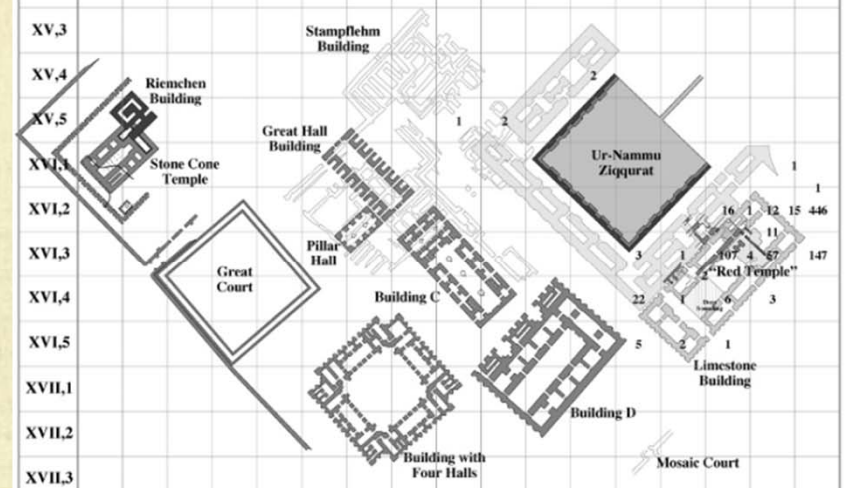

Urucká expanze

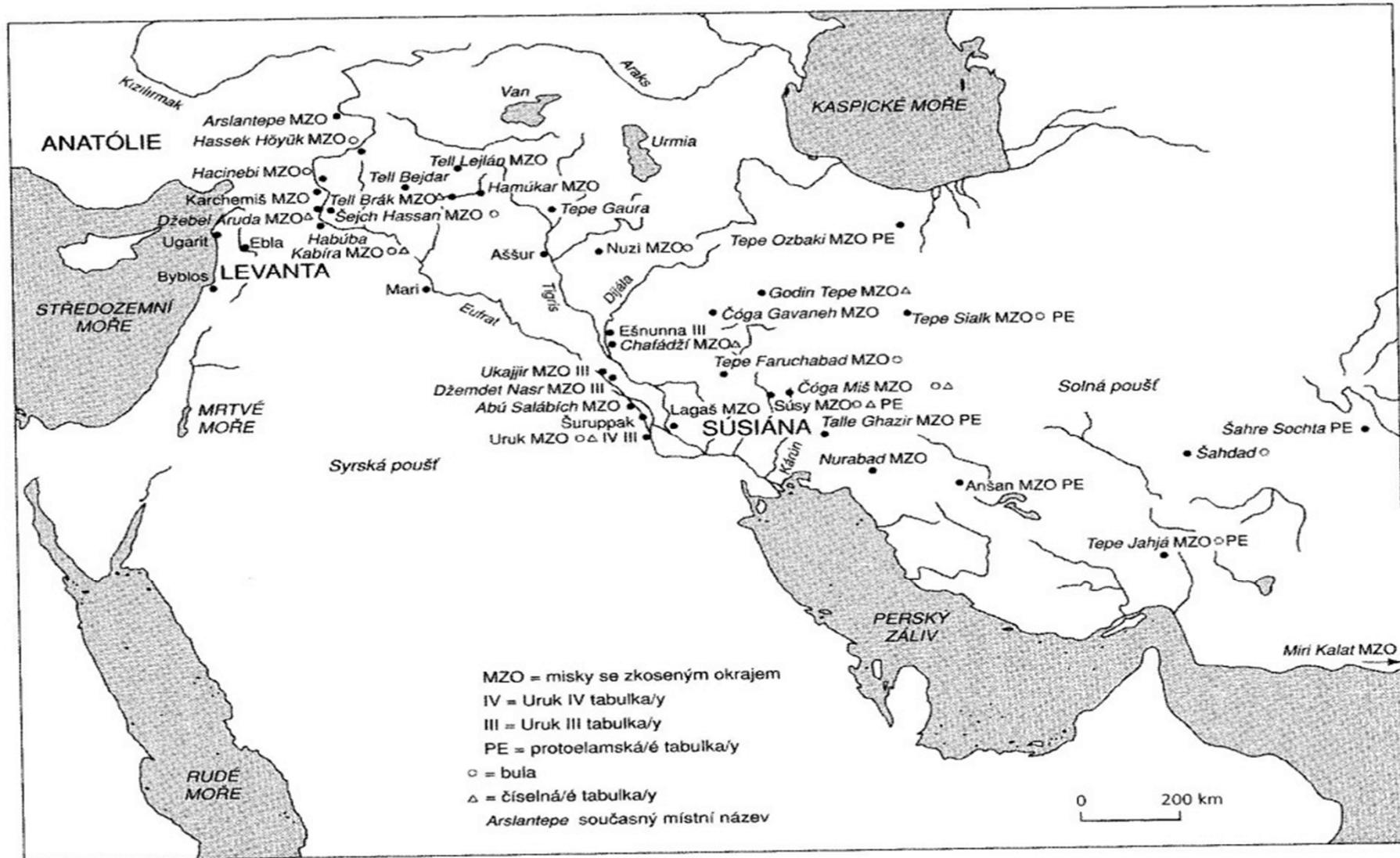

Urucký horizont v Sýrii

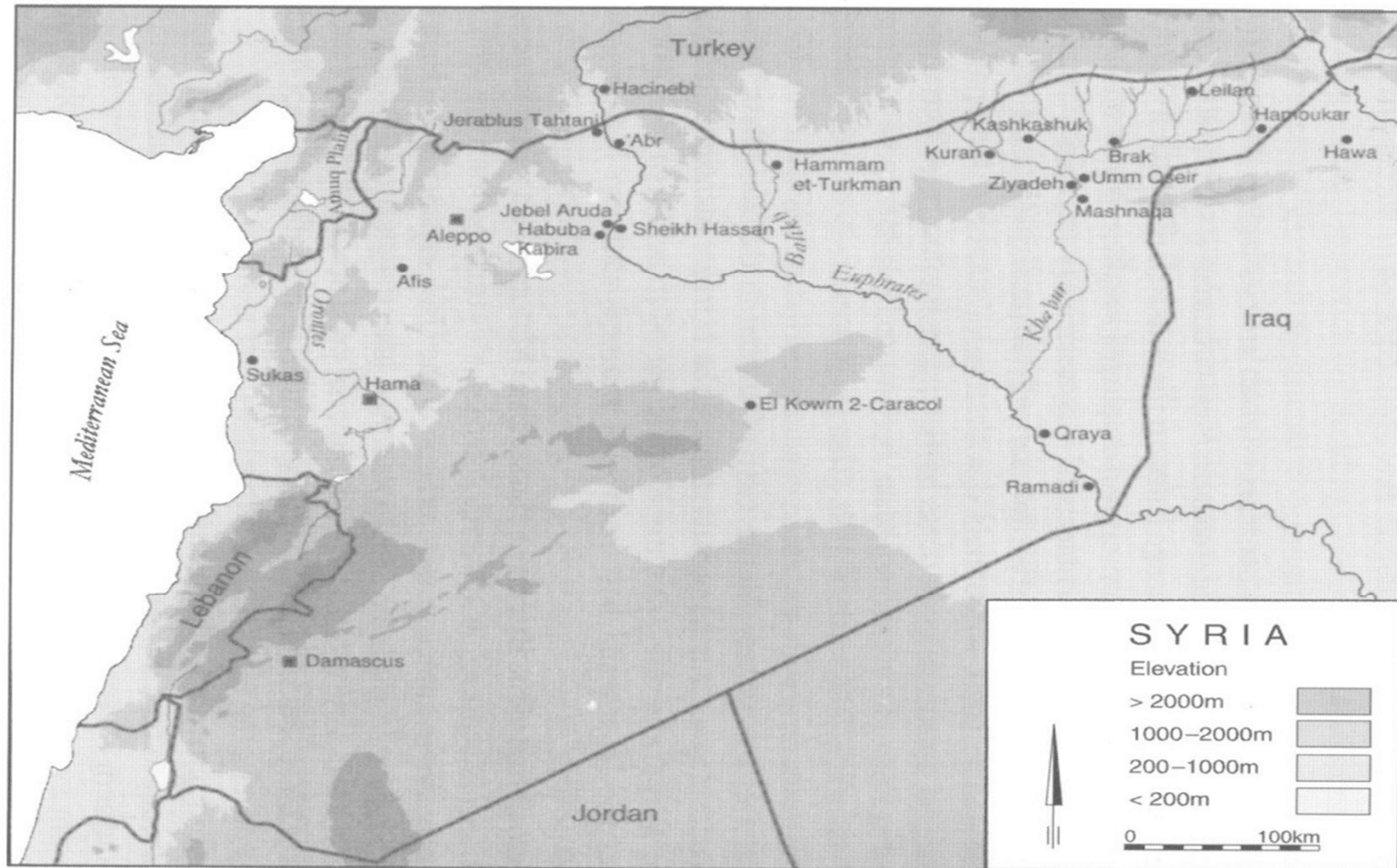
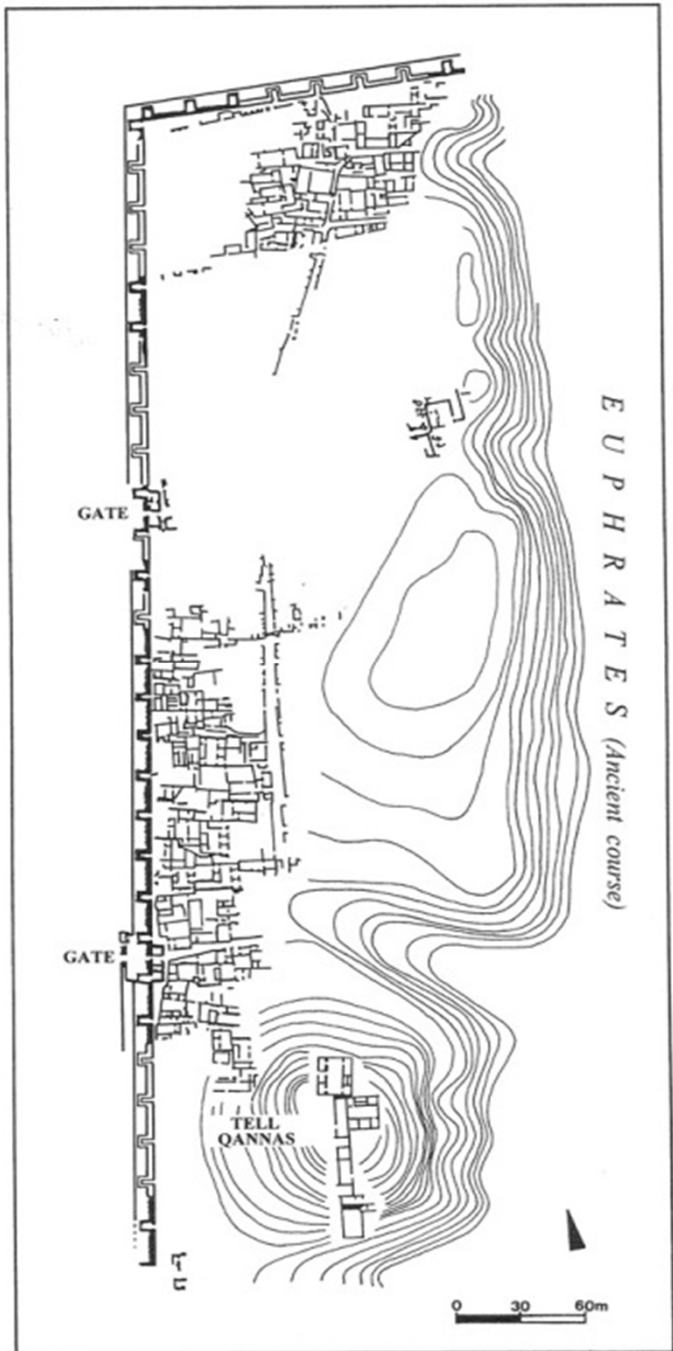

Fig. 6.1 Svria in the fourth millennium BC.

Habuba Kabira

- Střední Eufrat



TELL BRAK

