

The Buildings and the Images of the Imperial Cult

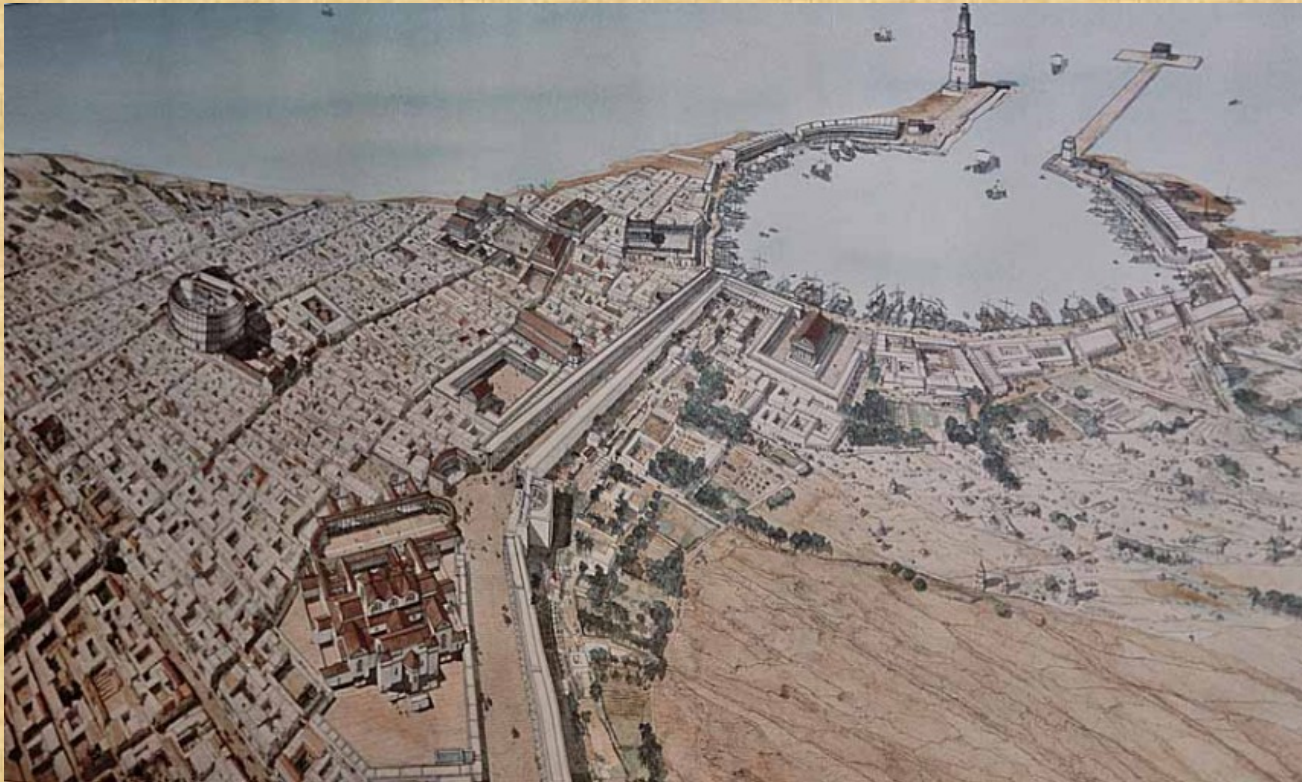

VI Leptis Magna

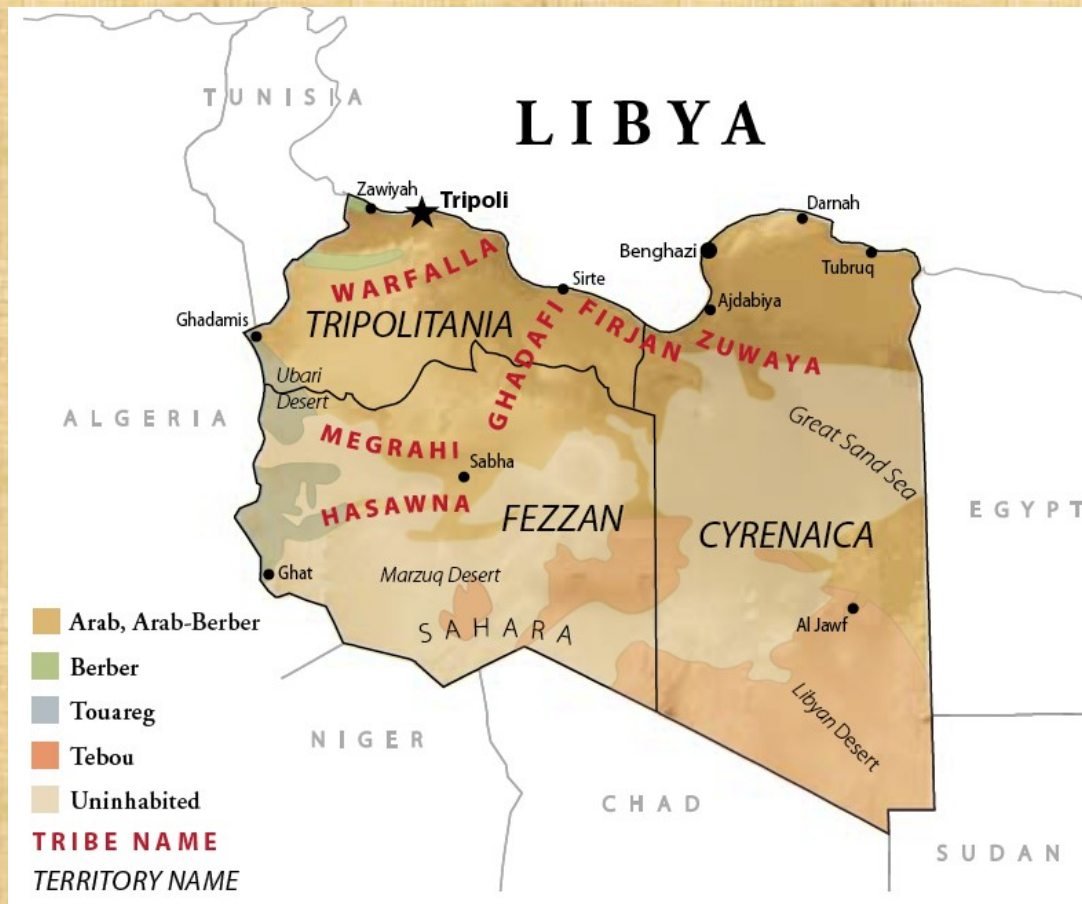

- North Africa – most of the country in the Sahara desert
- population: along the coast and its immediate hinterland
- Tripoli – the capital
- 3 historical regions:
 - a) Tripolitania
 - b) Cyrenaica
 - c) Fezzan
- Two languages: Greek and Punic
- History:
 - trading post – Phoenicians
 - Cyrenaica**
 - 630 BC – Greek colonization – city Cyrene – Persians – Alexander the Great – Ptolemaic kingdom

Tripolitania

5th c. BC – Carthage – hegemony across most of the North Africa – fall of Carthage – Numidian kings – Roman empire as a province Africa Nova with Crete – golden age 2nd and 3rd c. AD

Fezzan

5th c. BC – 5th c. AD – Garamantian Empire – operated trans-saharan trade routes between Carthage and the Roman Empire and Sahelian states of west and central Africa

Carthage

Location of Archaeological Site of Cyrene

Sallust
The War with Jugurtha



Leptis Magna (Libya)

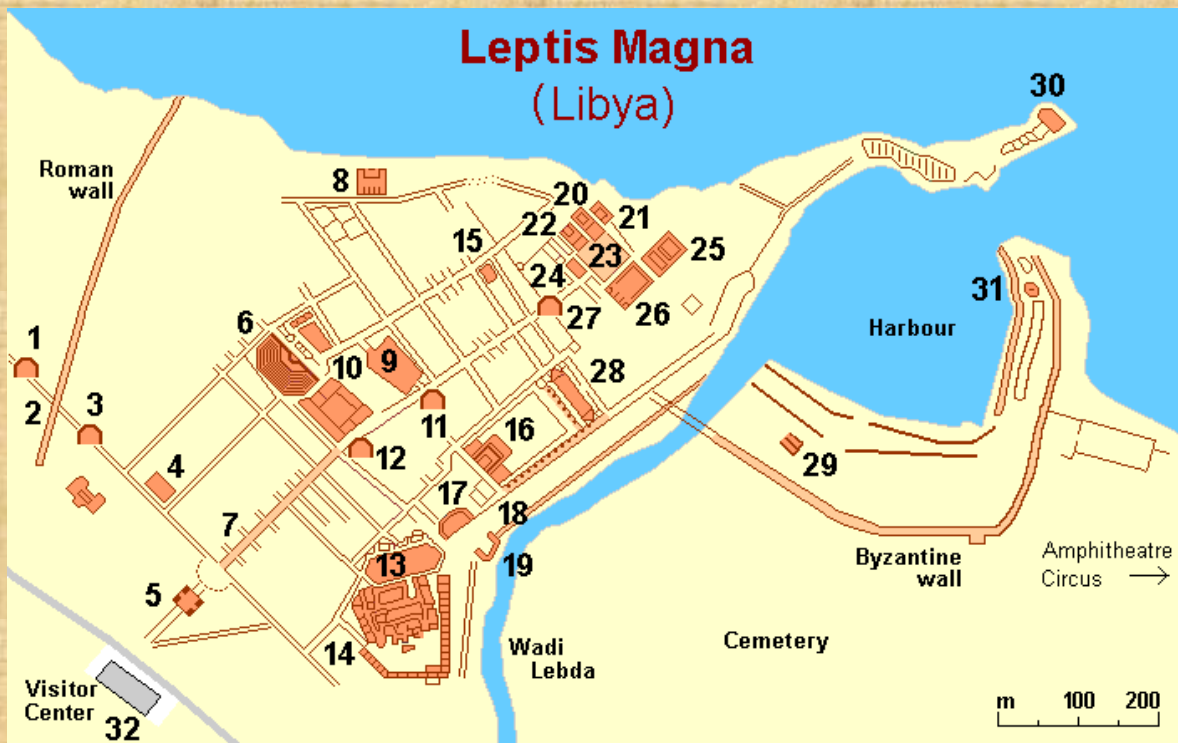

1 Marcus Aurelius Arch	9 Market	17 Church	25 Curia
2 West Gate	10 Chalcidicum	18 Colonnade	26 Old Basilica
3 Antonius Pius Arch	11 Tiberius Arch	19 Nymphaeum	27 Byzantine Gate
4 Schola and Baths	12 Trajan Arch	20 Roma & Augustus temple	28 Severan Basilica
5 Septimius Severus Arch	13 Palaestra	21 Hercules temple	29 Jupiter temple
6 Theater	14 Hadrianus Baths	22 Liber Pater temple	30 Light House
7 Via Trionfale	15 Serapaeum	23 Old Forum	31 Dorian temple
8 Baths	16 Severan Forum	24 Old Forum Church	32 Museum

- 130 km east of Tripoli, near Khom, on the coast
- founded by Phoenicians – 12th c. BC
- prominence when Carthage a major power in the Mediterranean – 4th c. BC
- after the 3rd Punic War – part of the Roman Republic
- Septimius Severus – independent city
- high degree of preservation (earthquakes, abandoned – Arab conquest)



General plan of the old forum



The Old Forum

Augustan age reconstructions: Claudius (53/54 AD), the Antonines (mid. 2nd c. AD)

3 temples N side:

Liber Pater

Hercules

Rome and Augustus

-typical Leptitan temples: very high podium housing rooms in its inside

-Augustan period: theatre, market, The Old Forum,



Excavations

The temple excavated in 1922, 1925 – 27, 1932, published only partly

J.B. Ward Perkins – after the war, only basic research

Systematic research – 2001 – 2003
2001 – the first recognition of the structures and the size of the temple

2002 – cleaning the structures, detailed survey, fragments documentation, a small trench to study foundations

2003 – historical research and documentation – based on photos, drawings and aerial photos from 1965 -architectural fragments determine different phases of the temple

The two semi-columns in the rear side of the temple have been always visible

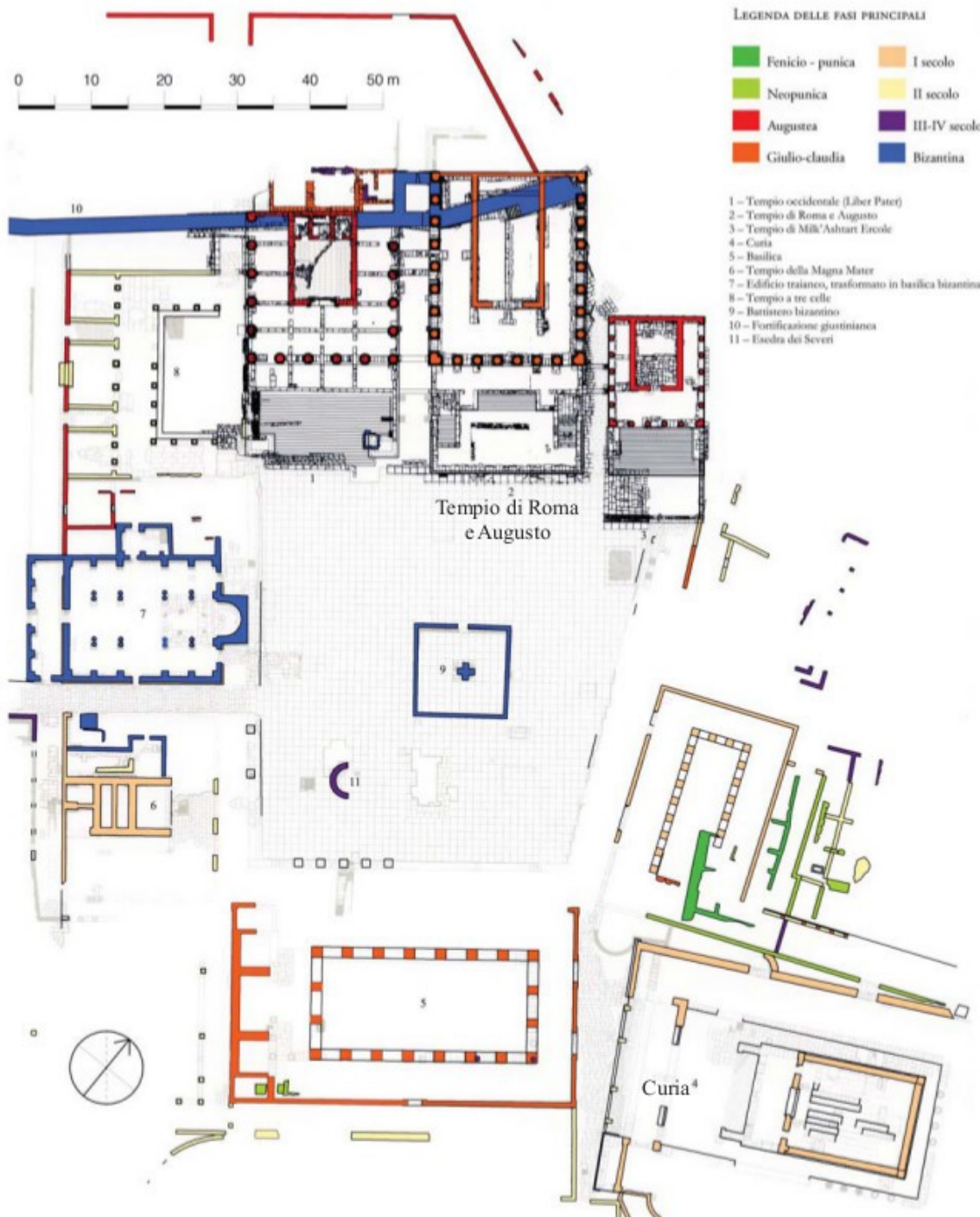

The Old Forum

South-west, north-east: two streets linking the Old Forum with the residential quarters at north-west

-7 phases

The Temple of Rome and Augustus

Phase I – Tiberian period

-construction of the building, first figurative cycle (Tiberian)

Phase II – Claudian period

-Remake of the square pavement and bilingual inscription, other two figurative cycles (Claudian)

Phase III – Antonine period

-Works on the peristasis and the top order of the *cella*

Phase IV – Destruction and later re-occupations

310 and 365 AD

The Temple of Roma and Augustus

Date: 14 – 23 AD

Position: the centre of the north-east part of the Old Forum

-south-east the Temple of *Liber Pater*, opposite side the Temple of Hercules

Dimensions: 41,41 x 21,05 m

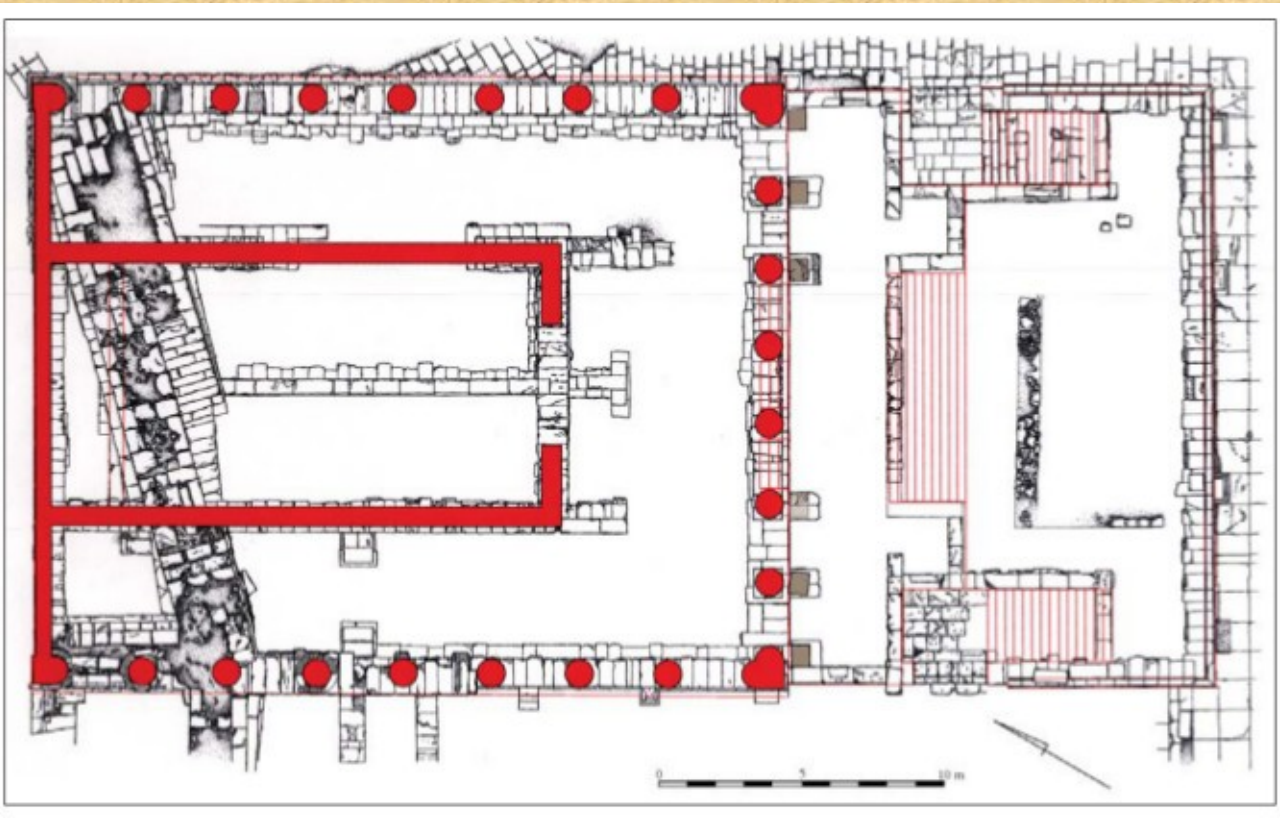

Type: ionic, *peripteros sine postico* on a high podium, octastyle porch, 8 columns on its sides too - corners: heart-shaped half-columns

Podium: 5.09 m high above the surface level of the forum, in front a lower part – rostra (2.77 m height), 3 staircases, Ras el-Hammam limestone (rear wall in sandstone covered with plaster)

Cella: 10.30 x 18.55 m, podium covered with marble slabs in the back supported the cult statues

Some urban models of the temple:

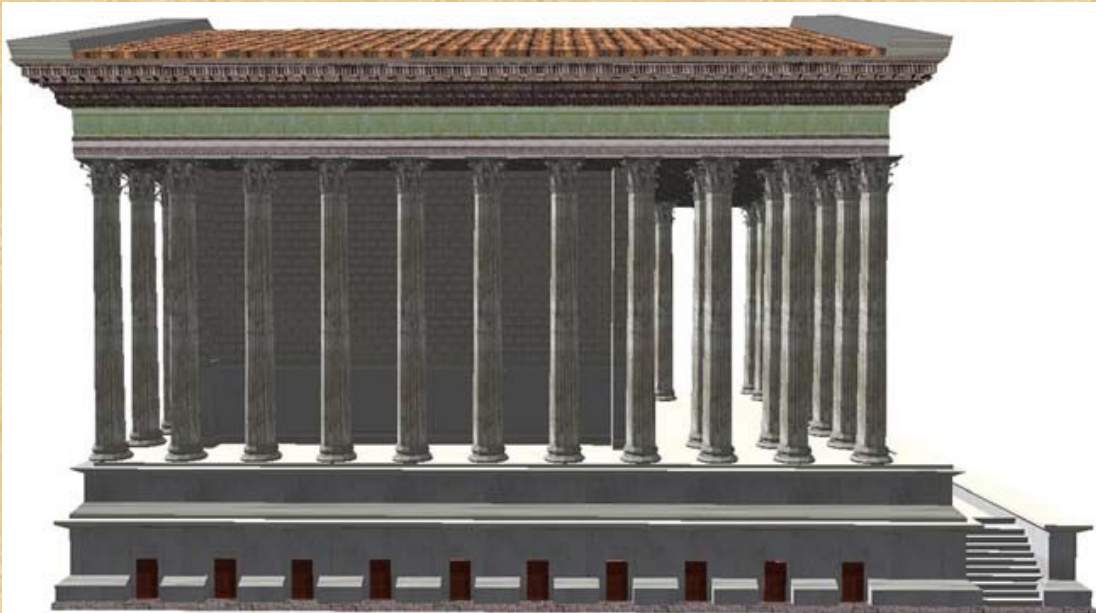
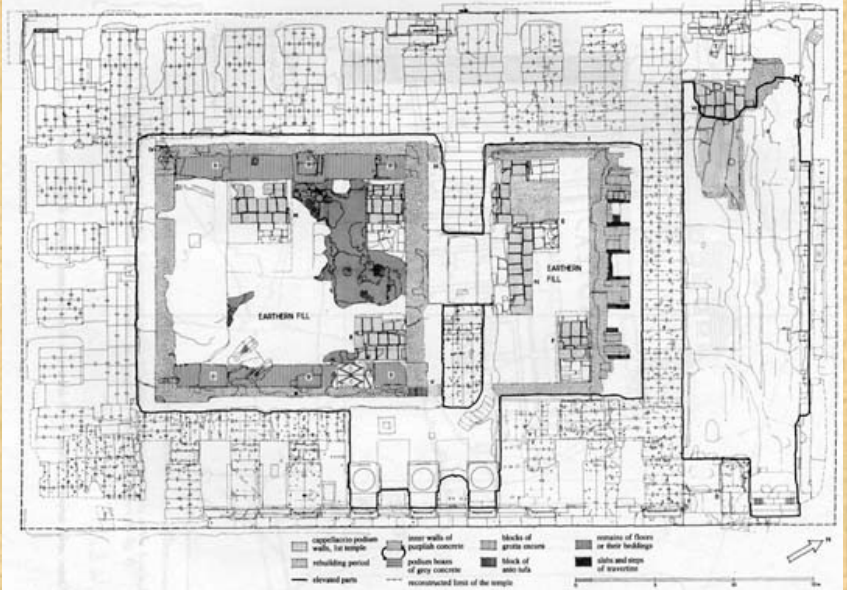

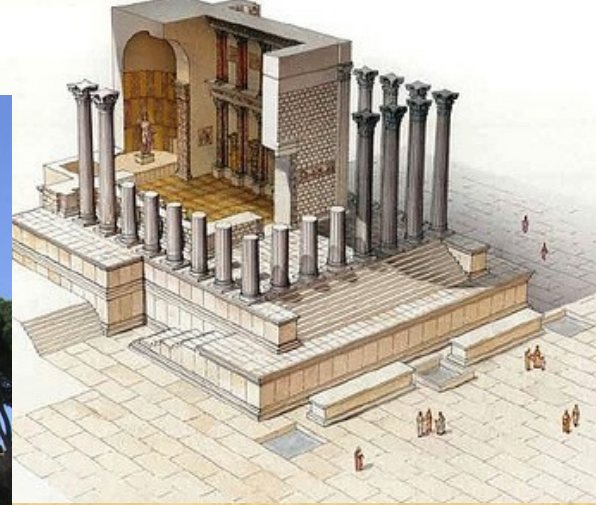
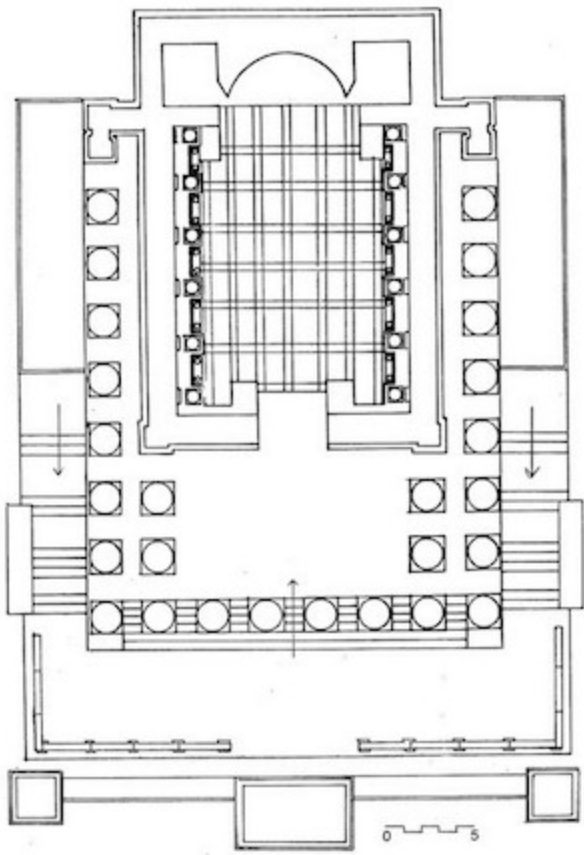

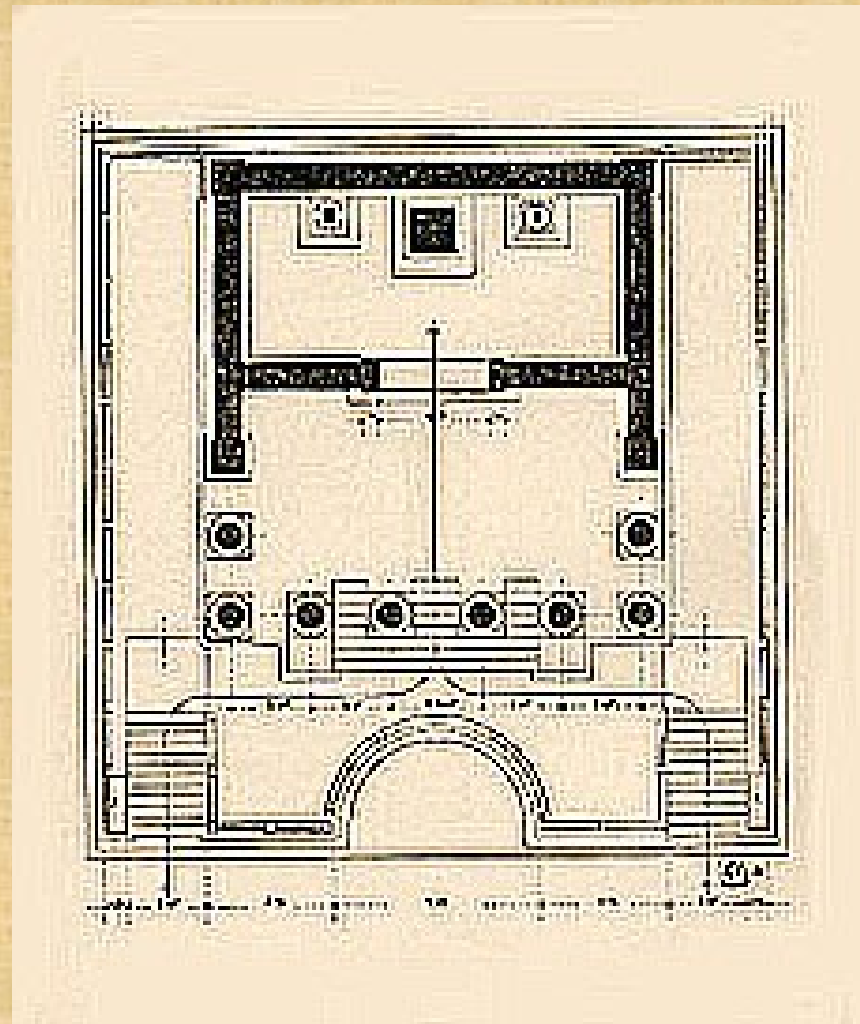



Special features

podium:

- inner rooms in the podium closed and enlightened by narrow windows – probably contained a valuable objects (*aerarium* of the city?)
- arches on impostes – structures between podiums, supported elevated passage – linked the temples at the level of the intermediate terrace





Tunisia, Sufetula

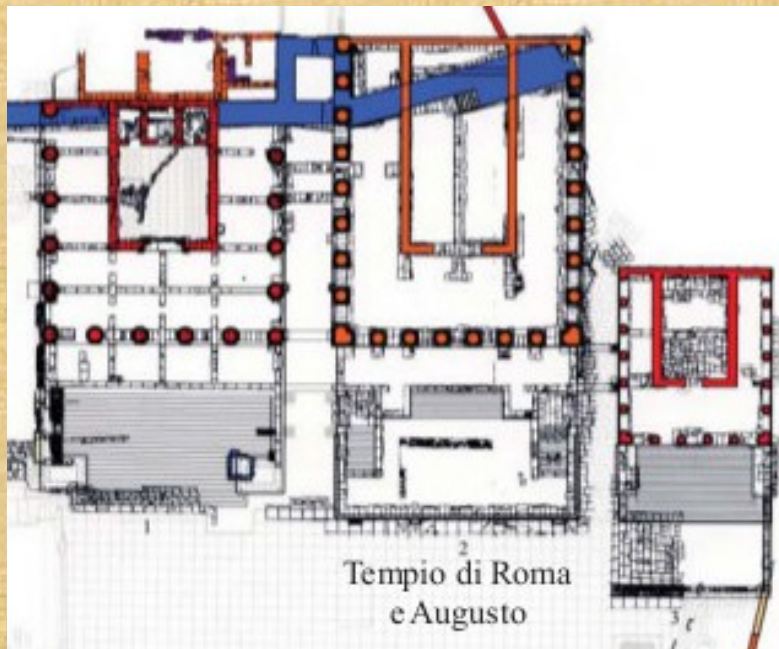

Leptis Magna, Libya

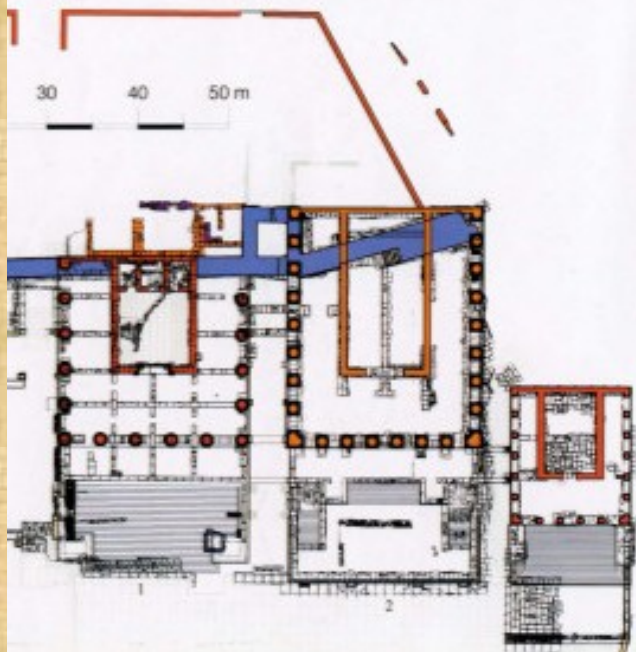

- The three temples aligned on the front line (evidence of a Punic tradition) – a sanctuary with three cells, visual unity
- later phase – other arches built
- passageways – widened the fruition of the internal paths of the sacred space (the temple accessible through two stairways, *pronaos* of the other two temples)
- built at the moment of the erection of the Temple of Rome and Augustus

A front terrace
B intermediate terrace
C temple
D side passageways

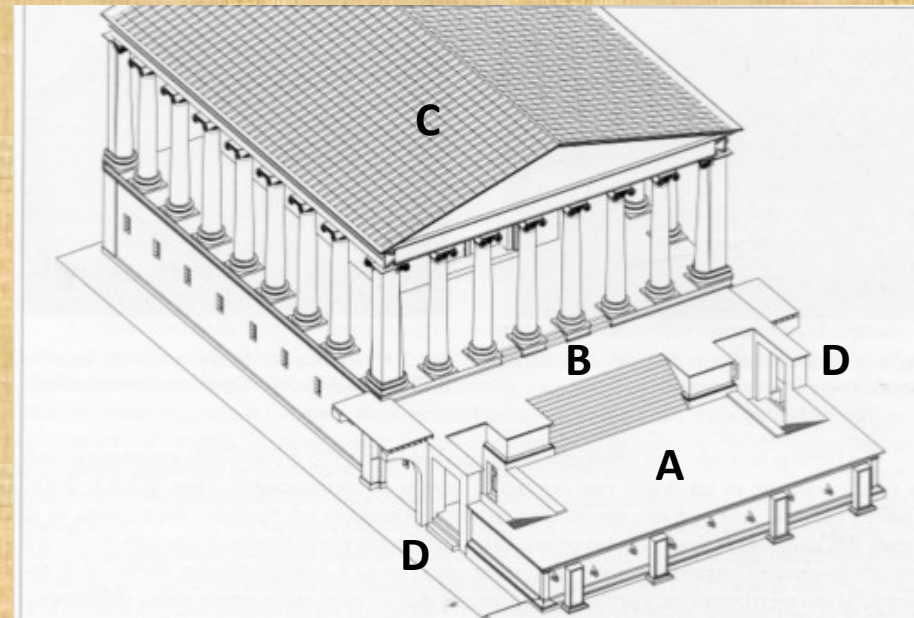

- in the sides of the tribune – two passageways preceded by three steps, one passed into a square chamber of disengagement, from which the tribune was reachable or the spaces under the intermediate terrace (*favissae*)
- design comes from the need to create a terrace facing directly the forum with no loss of spaces (frontal stairway)

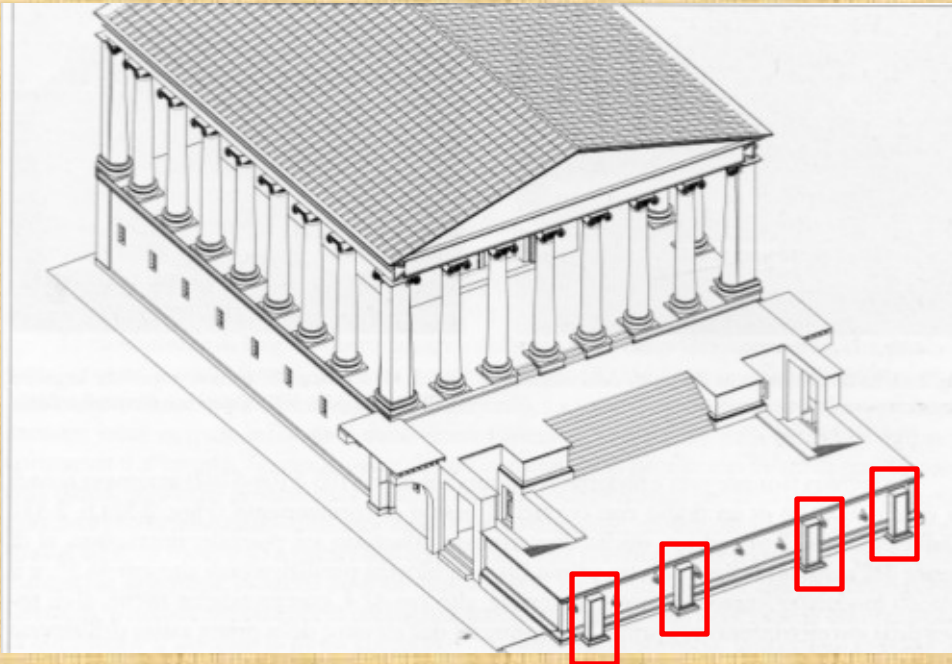

-front side of the tribune – a series of
rostra sculptured in limestone, one
preserved in situ
- the comparison – the Temple of Divus
Julius (Hadrianic sestertertius)



- 8 x 8 columns, semi – columns in the corners, attic bases, smooth and tapered shaft, made by drums with a ionic capital

- the architrave was made of single blocks, not monolithic (limestone and sandstone are not suitable for monolithic trabeations)

- Only one block preserved with the upper half of a *tabula ansata* (a tablet with dovetail handles, very popular in Rome for votive reliefs)



Ipotesi di restituzione dell'angolo sud-est della tribuna con i rostri e le stele apposte in età claudia (elaborazione grafica Ch. Nitti).

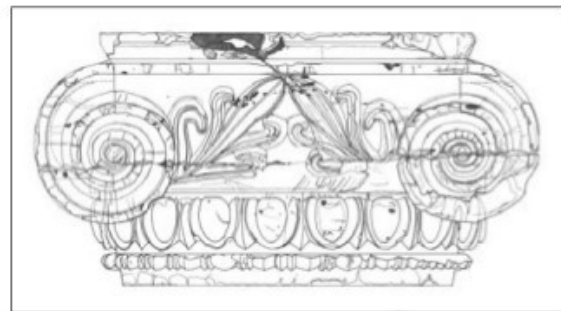

Capitello ionico in calcare pertinente alla peristasi (rilievo arch. M.A. Mellace).

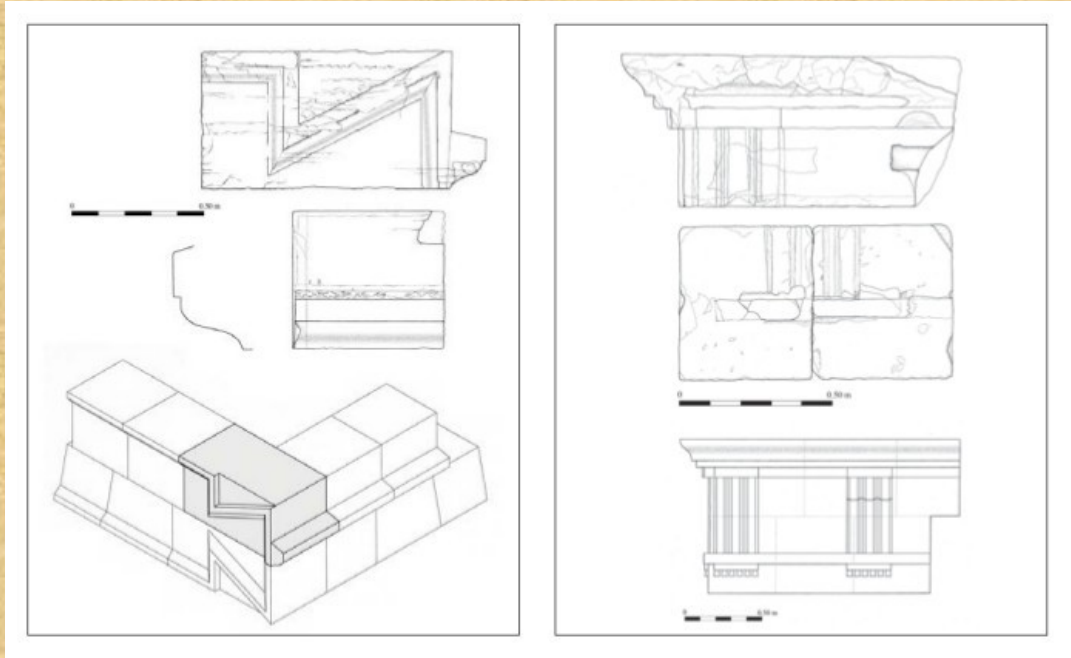
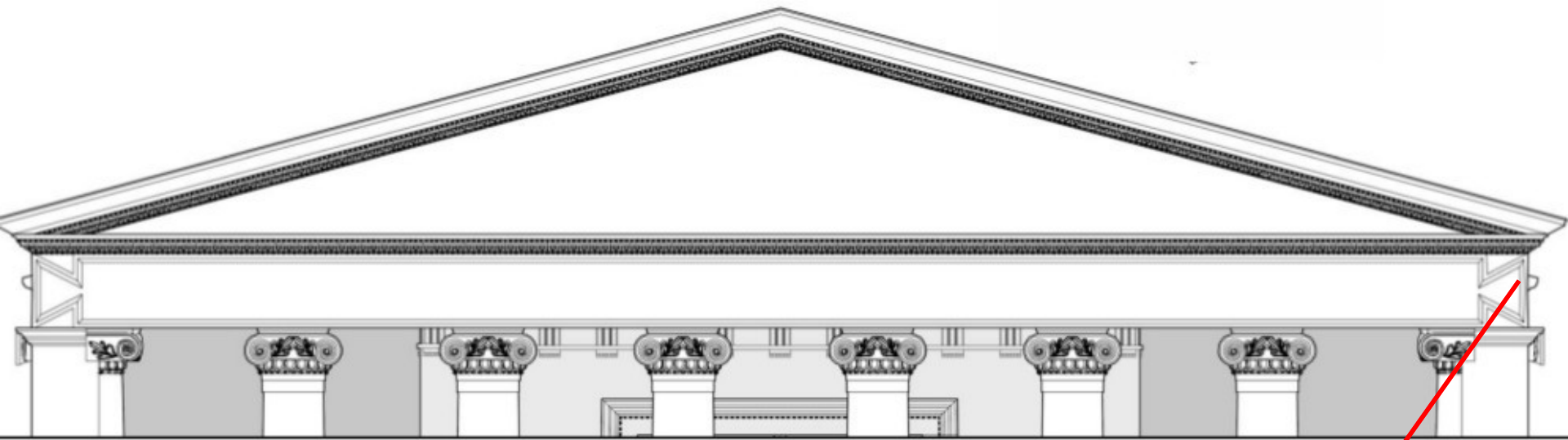

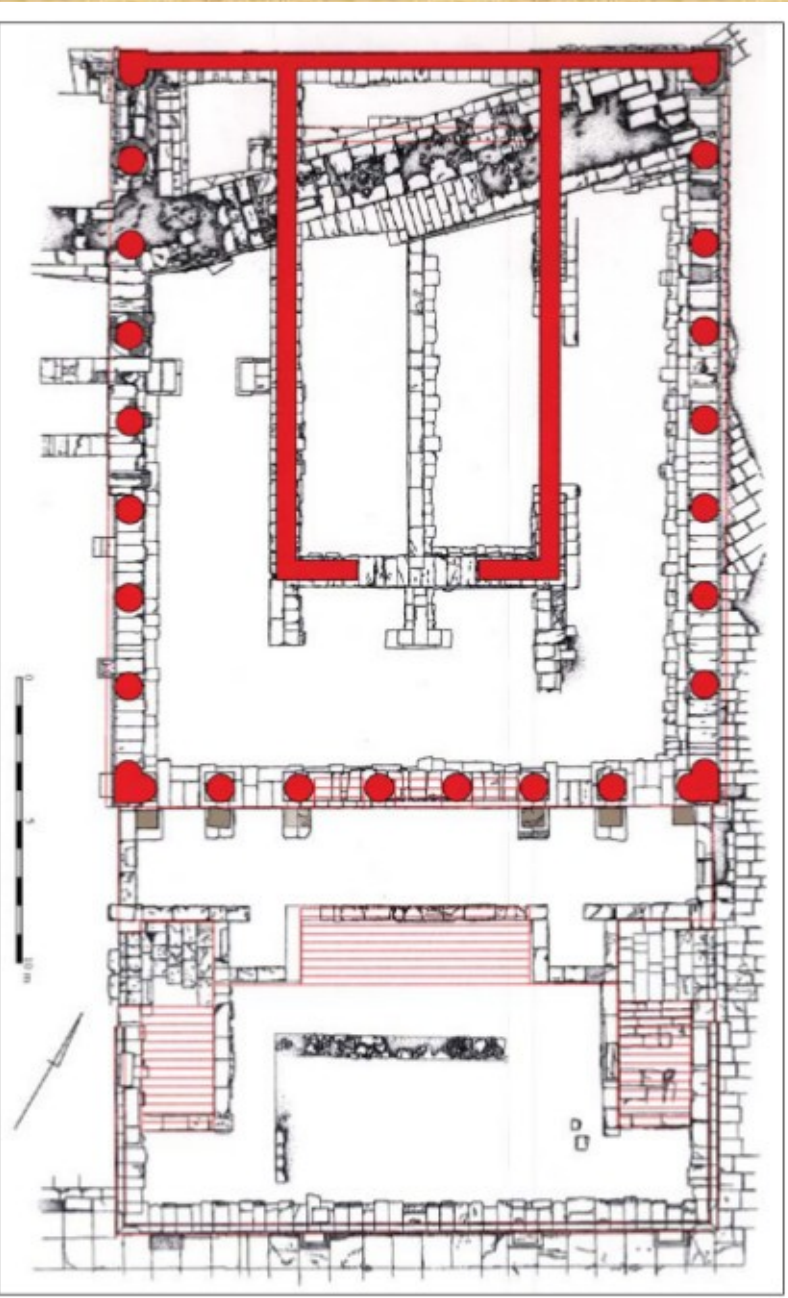

-the *cella* measures 10.30 x 18.55 m with a large podium in the rear as wide as the *cella* itself, against the rear wall

- the podium covered with marble slabs (*pavonazzetto, giallo antico, green serpentine*)

- the *cella* contains a single room (the three partition walls must have been a further support of the floor)

Phase I – Tiberian period

- large description above the doorway in limestone, found during excavations
- neo-punic inscription

...the statues of the god Augustus and of Rome and of Tiberius Augustus and of Julia Augusta and of Germanicus and of Drusus Caesar and of Agrippina, the wife of Germanicus and [of Livia the wife of Drusus and of Antonia the [mother of Ger]manicus and of Agrippina [the mother of] Drusus and the collection of statues of the god Augustus and the throne of the statue of the god Augustus

...of the statue of the god Augustus and the vestments of the statues of Germanicus and of Drusus Caesar... for Tiberius Caesar and the quadriga of [Germanicus and of Drusus Caesar] and the bronze doors and the ceiling of the portico and the forecourt of the sanctuary and the porticos, they were taken up at the expense ..., the sufets being Baliton, the son of Hanno G... Saturninus and Bodmelqart, the son of Bodmelqart Tapapi ...riculus.



The statues listed in the inscription:

1. Divus Augustus (head)
2. Rome (head)
3. Tiberius Augustus (head)
4. Julia Augusta [Livia] (head)
5. Germanicus' mother Antonia (complete standing statue)
6. Germanicus' wife Agrippina [Maior] (complete standing statue)
7. Germanicus (head in the round)
8. Quadriga
9. Quadriga
10. Drusus [Minor] Caesar (head in the round)
11. Drusus [Minor] Caesar's wife Livia [Livilla]
12. Drusus [Minor] Caesar's mother Vipsania Agrippina (head in the round)

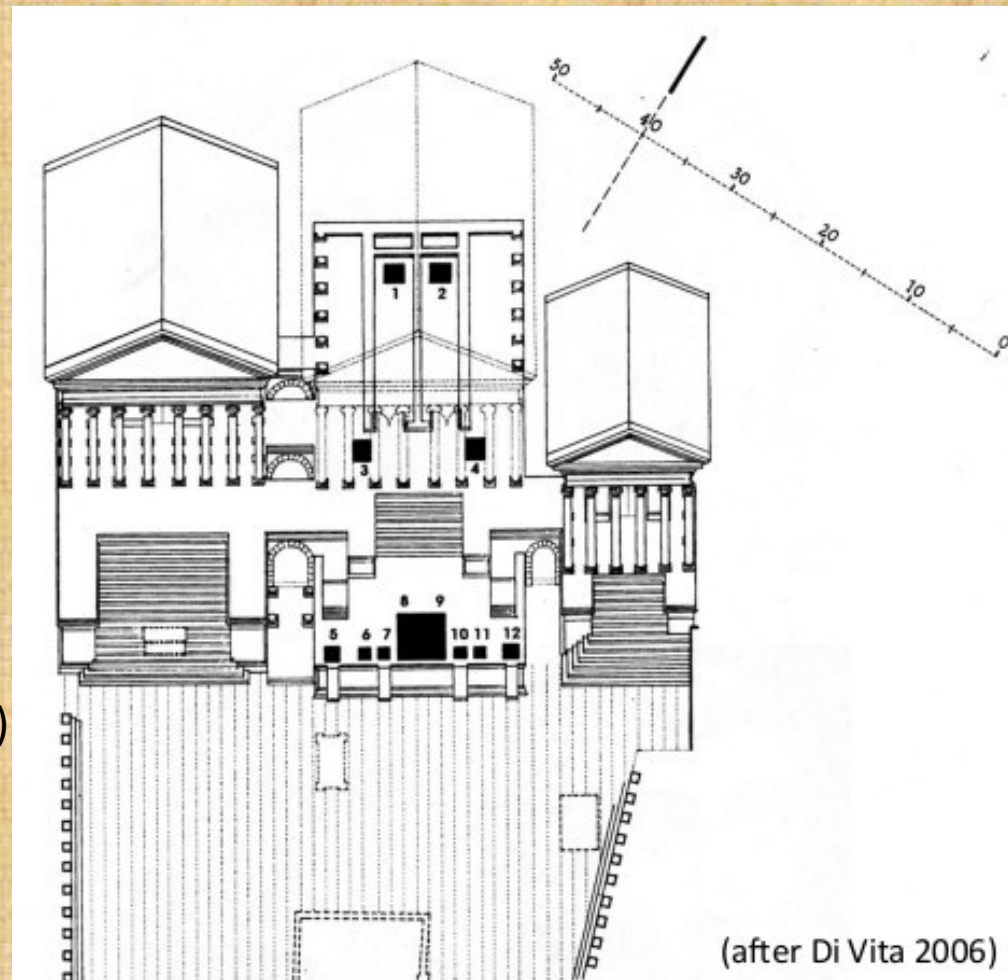

(after Di Vita 2006)

- quadriga: for Germanicus and Drusus Caesar, only several blocks of the base found, some of them inscribed, the quadriga must have been in bronze, 1.5 times larger than life-size, total width 5.30 m, coherent with the space between the two rostra in the middle
- all statues are in the Museum of Tripoli, they were studied in the 40's on the basis of the list of the dedicatory inscription
- The heads of the acroliths 1-4 are all partially empty inside (the same technique of assembling the statue of Genius Augusti in the Hall of the Colossus)

- internal dimensions of the *cella* are 17.25 x 8.70 m, the base against the rear wall was 2.06 m deep, housed the acroliths of **Augustus and Rome** only (4:1), Tiberius and Livia outside (not enough room)
- dimensions of Augustus 3.50 m wide, 7.60 m high

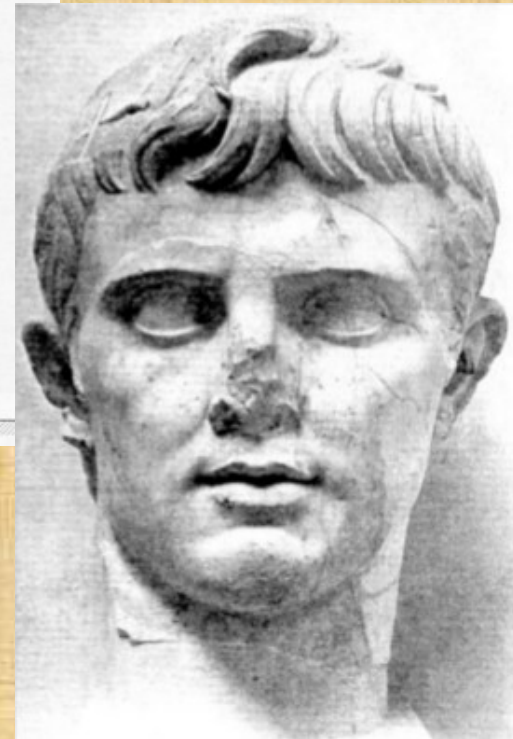
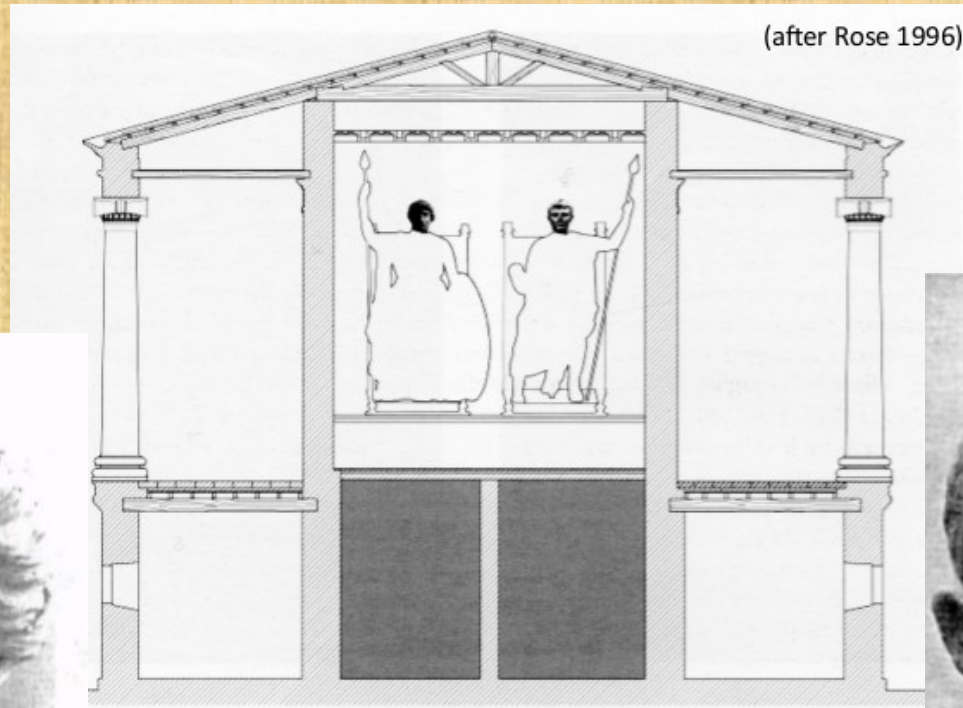

- the statues of **Tiberius and Livia** were placed outside the *cella* (both were still alive at the time of construction), the best place is the *pronaos* at each side of the doorway (Pantheon of Agrippa – Augustus and Agrippa during their lifetime)
- inside the podium - remains of a structure similar to that under the base inside the *cella* – it could have supported two segments of the base 2.20 m deep, on which the two acroliths of Tiberius and Livia were places (3:1)

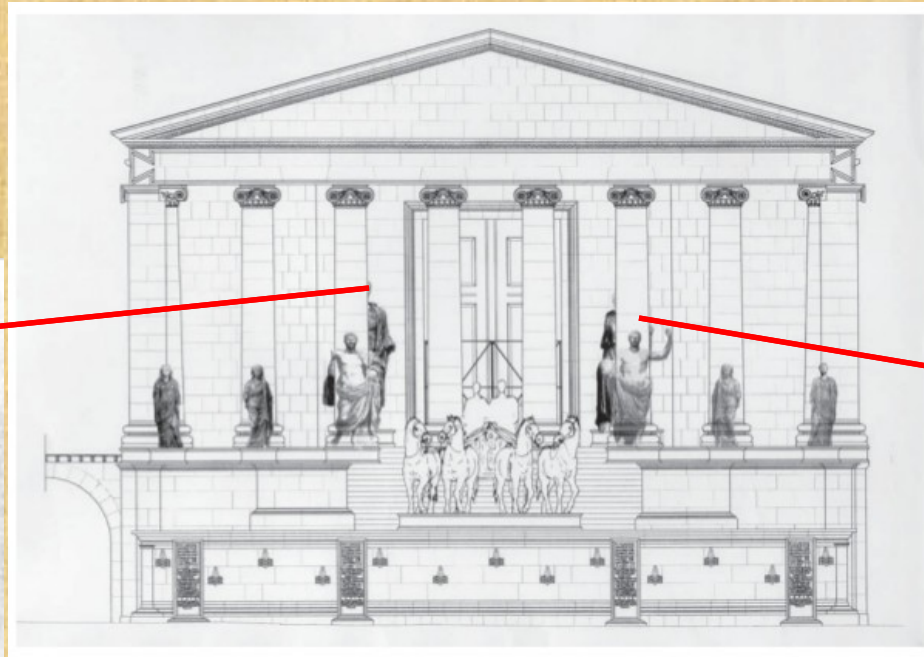

- the number of remaining statues is the subject of discussion – the main problem: were Germanicus and Drusus Minor shown twice? (standing and in the quadriga) or only once?

Reasons for the first hypothesis:

- a) The quadriga was in bronze, the two heads are in marble
- b) The ratio of the quadriga 1.5:1, the heads are 2:1
- c) The marble heads are unfinished in the back (Germanicus) and show the hole for a tenon (Drusus Minor) – not in the sight, must have been secured on its back



Germanicus



Drusus Minor

The result – several sculptural groups:

1. In the cella – Augustus and Rome
2. Under the pronaos – Tiberius and Livia
3. Under the intermediate terrace, in alignment with the outer three columns on both sides of the temple: Antonia Maior (A), Agrippina Maior (B), Livilla (C), Vipsania Agrippina (D) and the other two, who cannot be but Germanicus (E) and Drusus Minor (F) depicted standing. (Germanicus and Drusus Minor 2:1, wives and mothers 1.5:1)
4. The quadriga on the tribune, inside filled with soil according to the building tradition for North-Africa

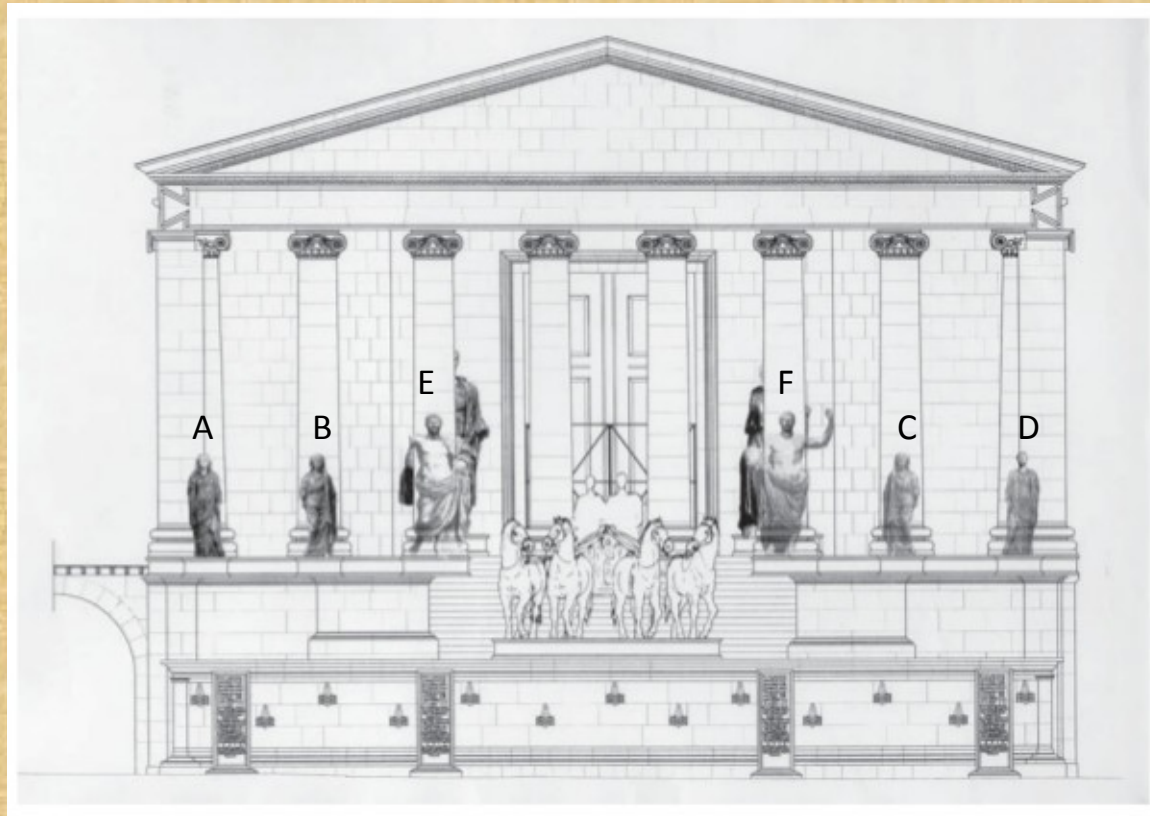

Germanicus



Drusus Minor



Antonia Minor



Agrippina Maior

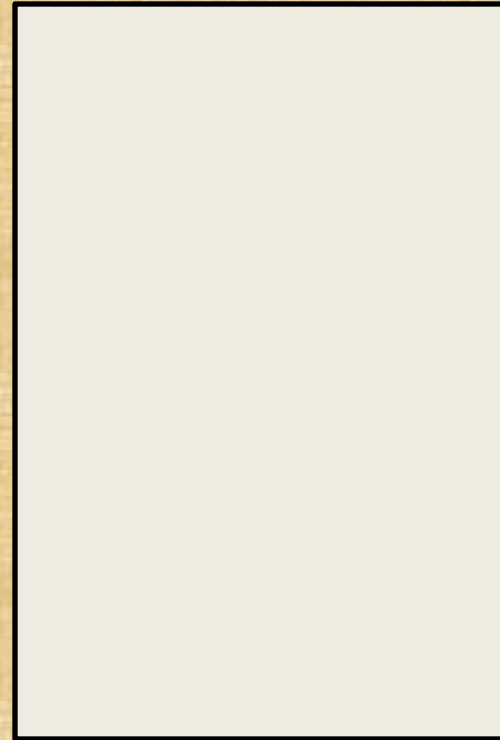

Livilla

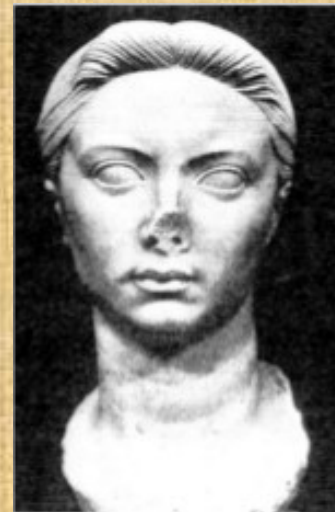

Vipsania Agrippina

The chronology of the Temple of Rome and Augustus

- deduced by

the relationship of the temple with the pavement of the square

the adjacent temples

the inscription above the doorway

Results:

1. Relative chronology: the temple is later than both the other two temples (the arches were additionally added), but earlier than the pavement of the square (dated to 53 AD by an inscription)
2. The absolute chronology is possible due to the inscription. The temple itself was built in function of the sculptural cycle
 - a) The presence of the acrolith of Augustus inside the temple and Livia and Tiberius at each side of the doorway, the term *divus* related to the name of Augustus and the attribute Augustus to the name of Tiberius in the inscription suggest a date post 14 AD
 - b) End of the works – after 32 AD (*damnatio memoriae* of Livilla, wife of Drusus, whose statue was on the terrace of the temple) or even before 29 AD, the year of Agrippina's exile to Pandataria (today Ventotene)
 - c) The Quadriga with Germanicus and Drusus Minor – its base partly preserved, the titles indicate a date after the death of the two princes, already heroized there. The monument must have been ready at the moment in which the inscription above the doorway was made. Then, the end of the works ranges from 23 AD (Drusus's death) to 29 AD (Agrippina's exile)

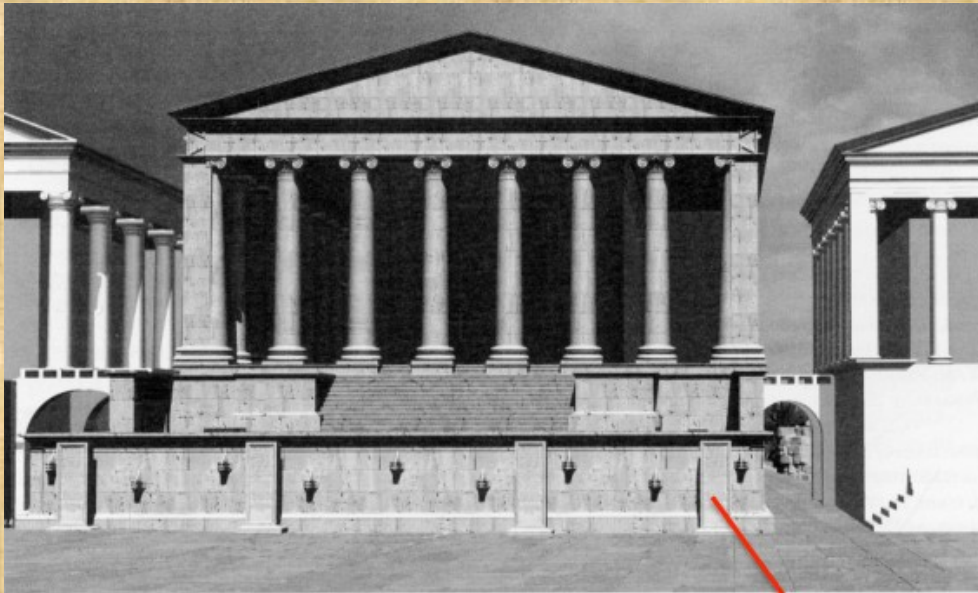

Phase II – Claudian period

- 4 bilingual stelae (Latin and Neo-Punic) attest that in 53 AD a rich citizen of Leptis offered *de pecunia sua columnas cum superficie et forum*
- new pavement, a three-side portico, three connected temples and a basilica at the opposite side of the temples – the Roman-Italic trend

- the new pavement – large slabs of limestone of Ras el-Hammam (the level of the square raised by 32 cm)
- in front of the tribune, against the front side, the bases of four inscribed *stelae* were put (three of them are still *in situ*), they are not evenly spaced, but are placed in two pairs slightly closer to the corners
- the *stelae* also indicate a position of the statues on the tribune of a later date – did not clutter the area of the central quadriga



two sculptural cycles in this period:

- a) only the bases survive – found close to the Temple of Rome and Augustus

- 5 identical bases:
- 1) DIVO AVGVSTO (Augustus)
 - 2) DIVAE AVGV (Livia)
 - 3) TI. CAESARI DIVI AVGV F AVGVSTO (Tiberius)
 - 4) TI CLAUDIO CAESARI AVGV GERMANICO PONT MAX TRIB POT V IMP XI P P COS DESIG IIII (Claudius) – 45 – 46 AD
 - 5) (erased) MESSALINAE C[...] (Messalina)

-none of the survived statues can be ascribed to such bases

- the dimensions suggest statues with the ratio 1:1, they must have been placed against a wall (the back side is rough)



4 and 1



2



3

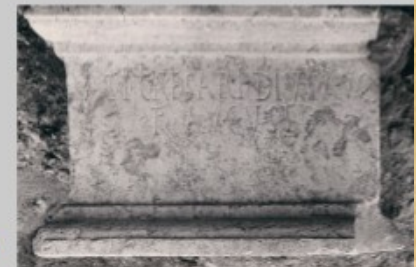

5

b) Three seated statues and one standing

-the ratio is 1.5:1

- probably a fourth seated statue was part of the cycle, so four enthroned statues located on the level of the tribune, at the sides of the quadriga, in correspondence with the *stelae* below

- the standing statues on the pavement below

- but, the seated statue of Claudius shows a hole for a tenon – must have been placed at the wall, the same with the Tiberius statue

- the standing Tiberius statue was found in the *cella*, so some of the Julio-Claudian portraits must have been located inside the *cella*

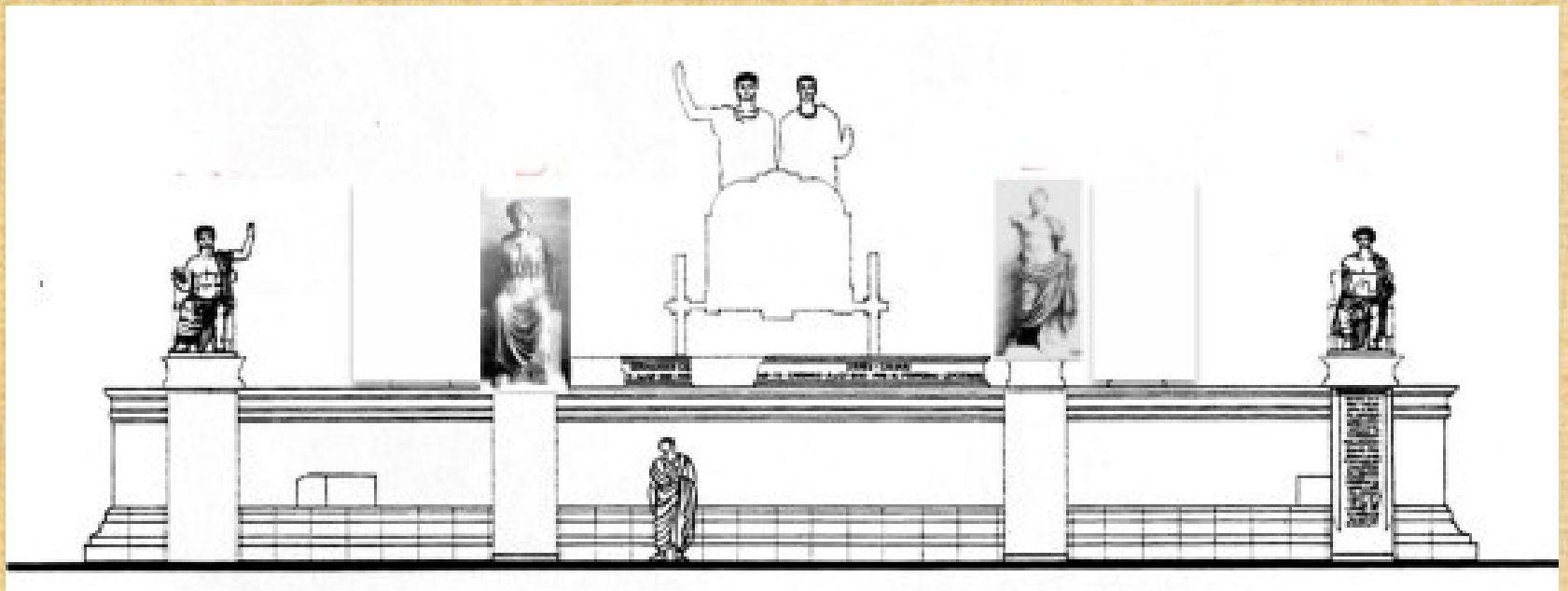

- the preserved statues portray:

- a) Seated Augustus
- b) Seated Livia (reconstructed from two large fragments, the lower could also belong to a fourth (female) seated statue)
- c) Seated Claudius
- d) Standing Tiberius



