

WESERN SYRIAN ASSAMBLAGE

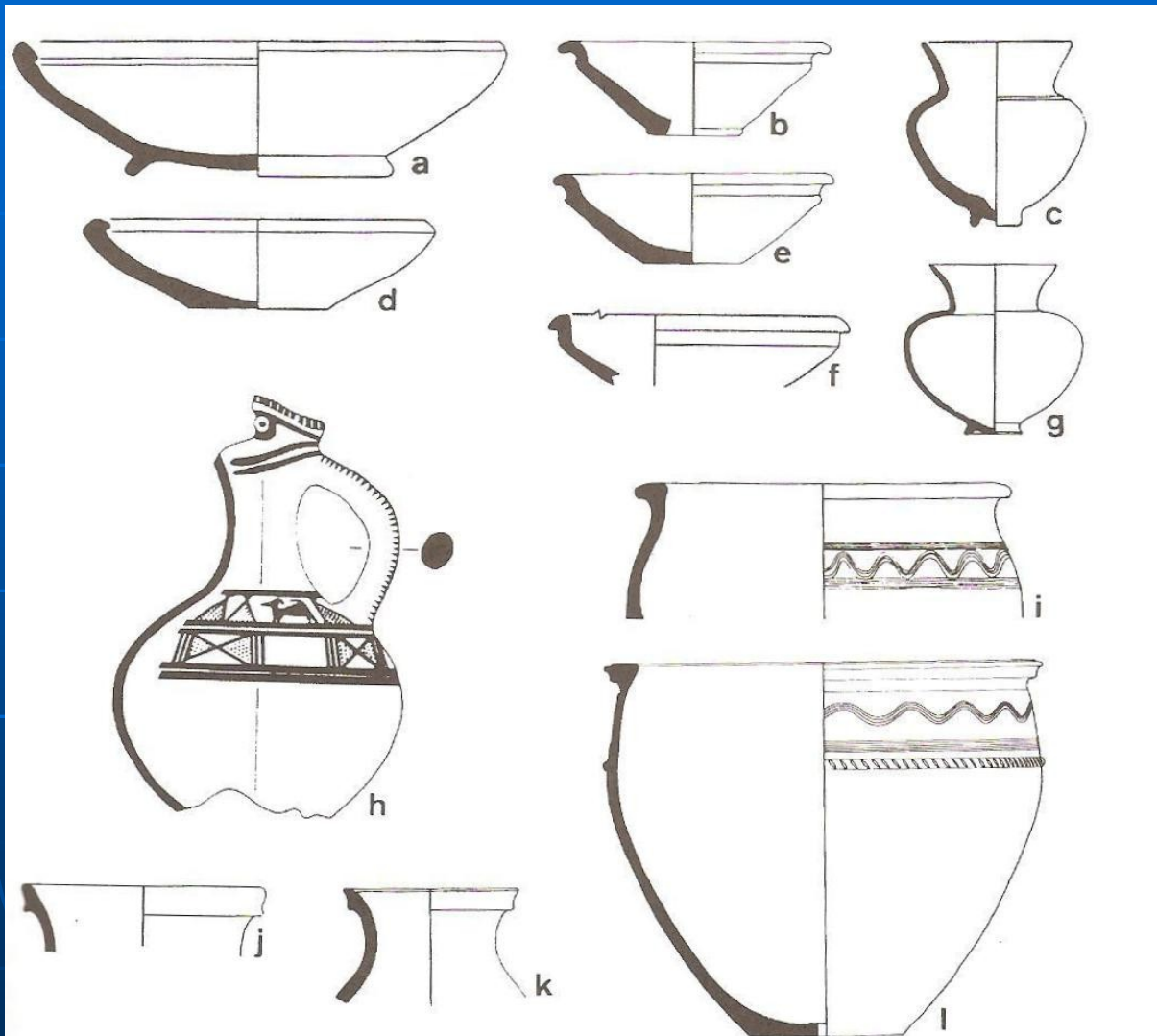
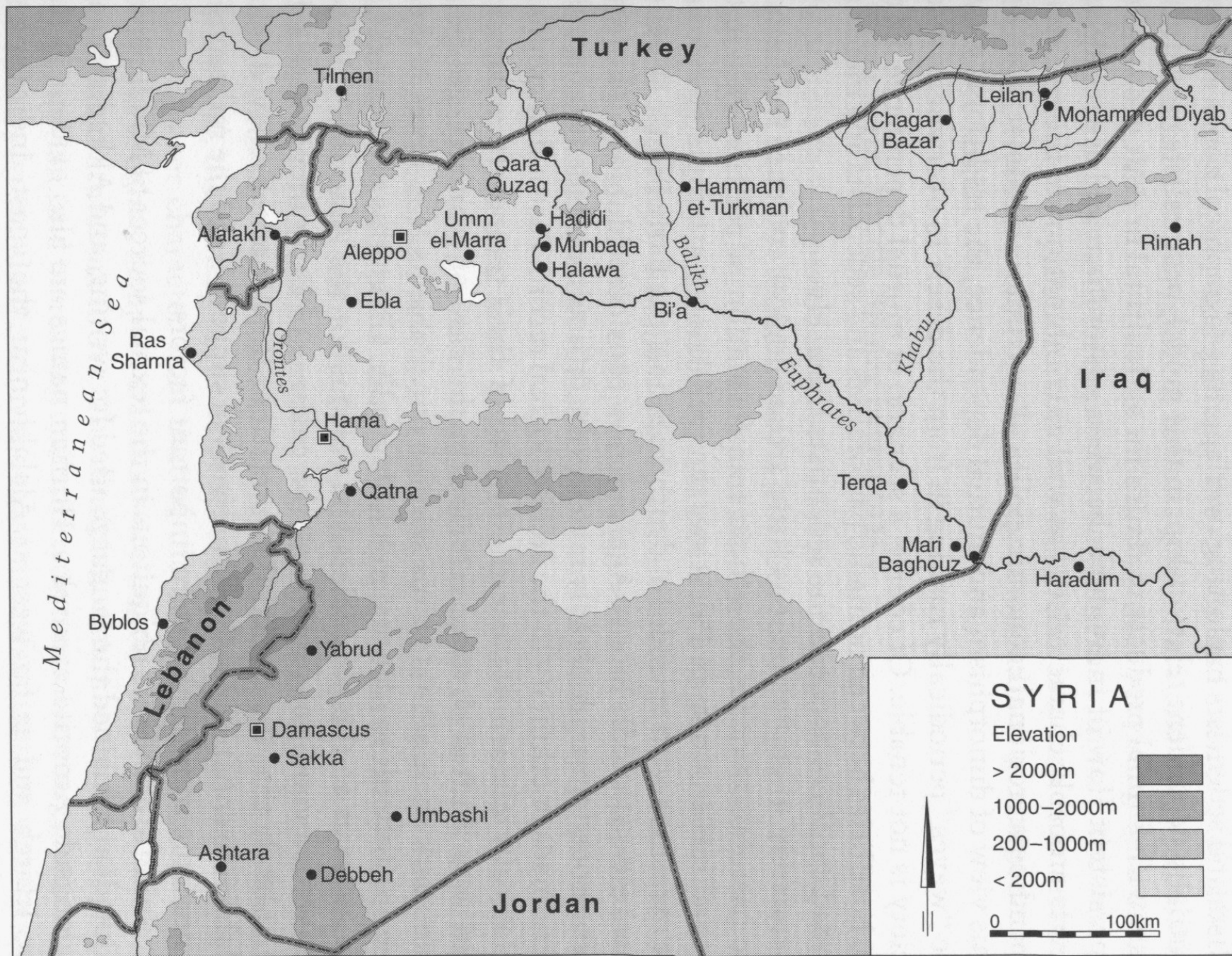


Fig. 9.3 Early second-millennium BC pottery from western Syria (scale 1:5 except i, l, 1:10).

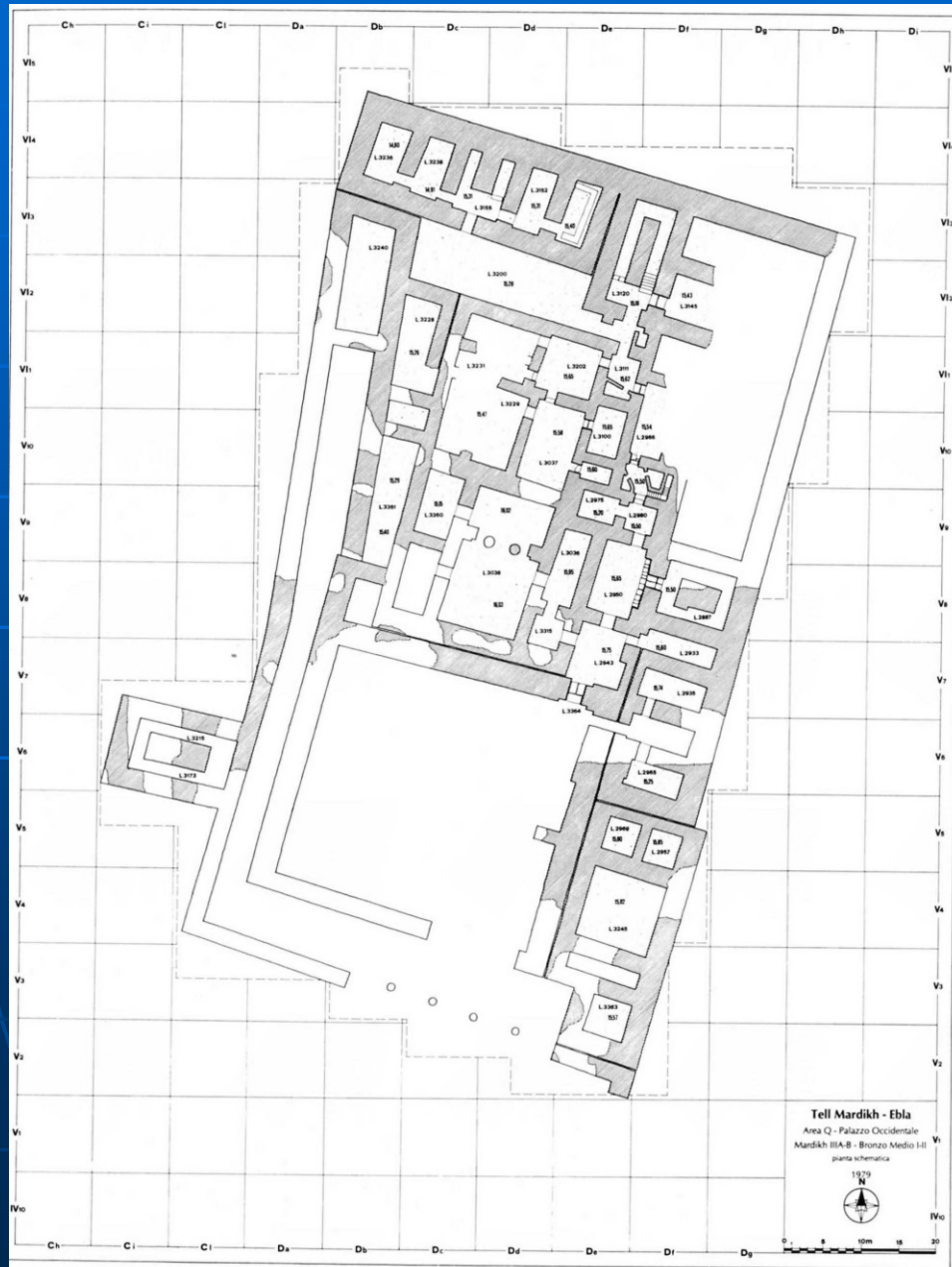
EBLA – MB I KING IBBIT-LIM STATUE



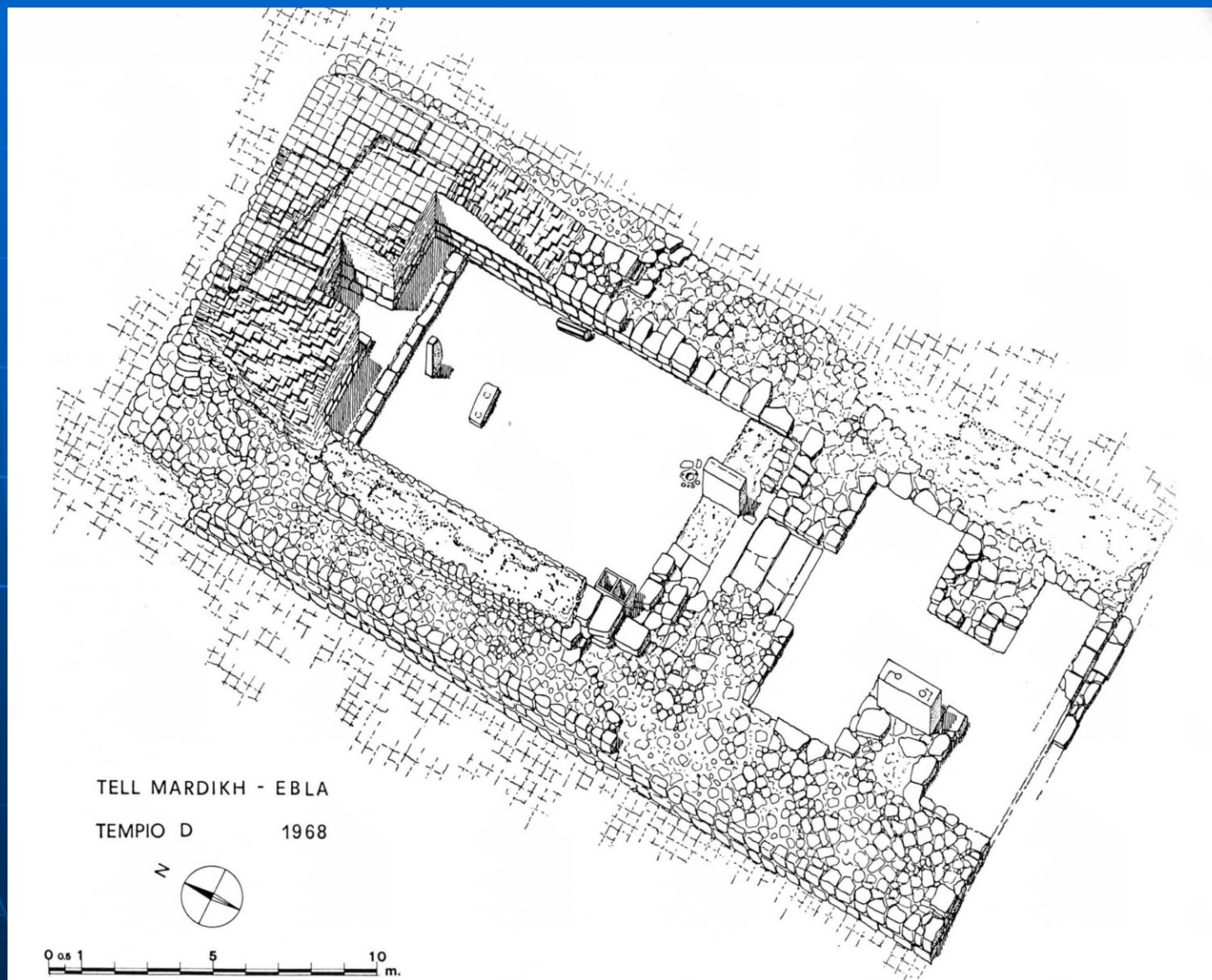




MB II EBLA – WESTERN PALACE (Q)

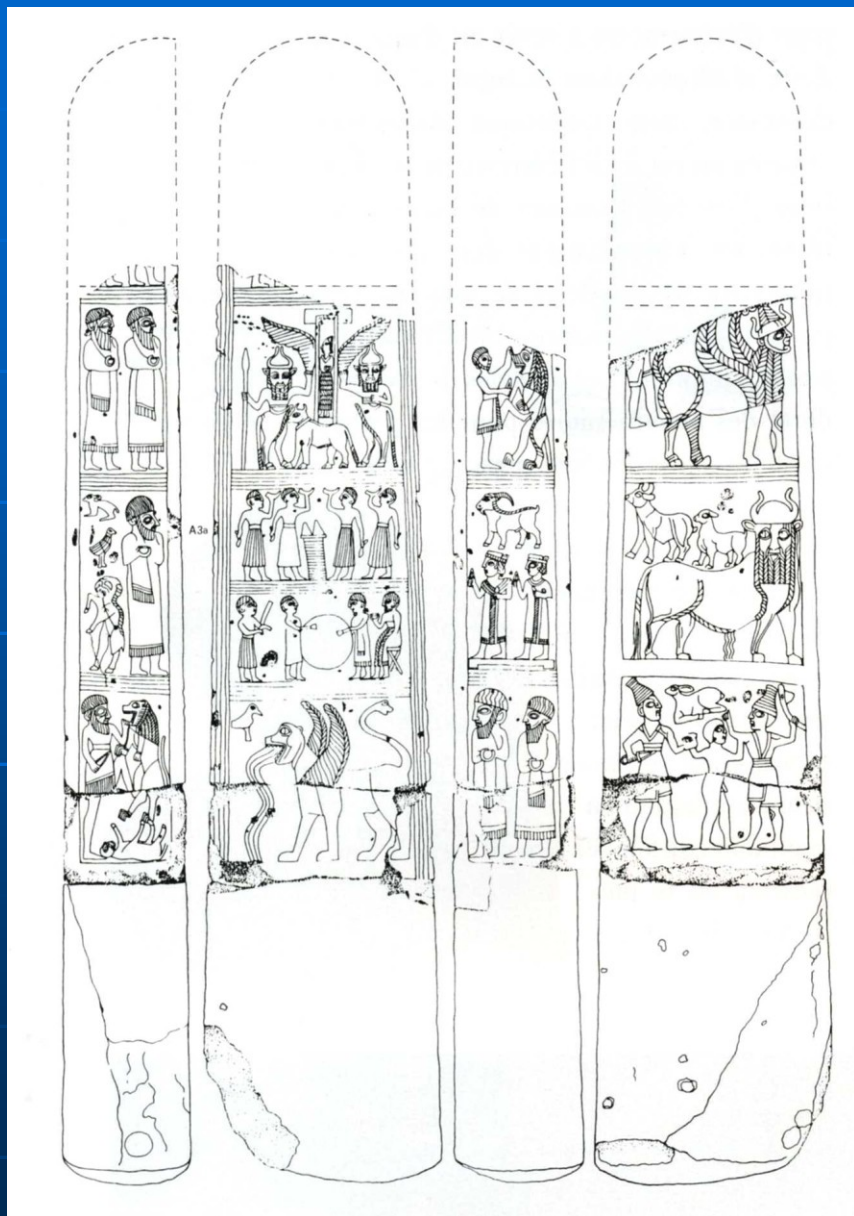


MB II EBLA – TEMPLE D



arch. CARLO CATALDI TASSONI

MB II EBLA – ISHTAR'S STELE FROM VICINITY OF TEMPLE D

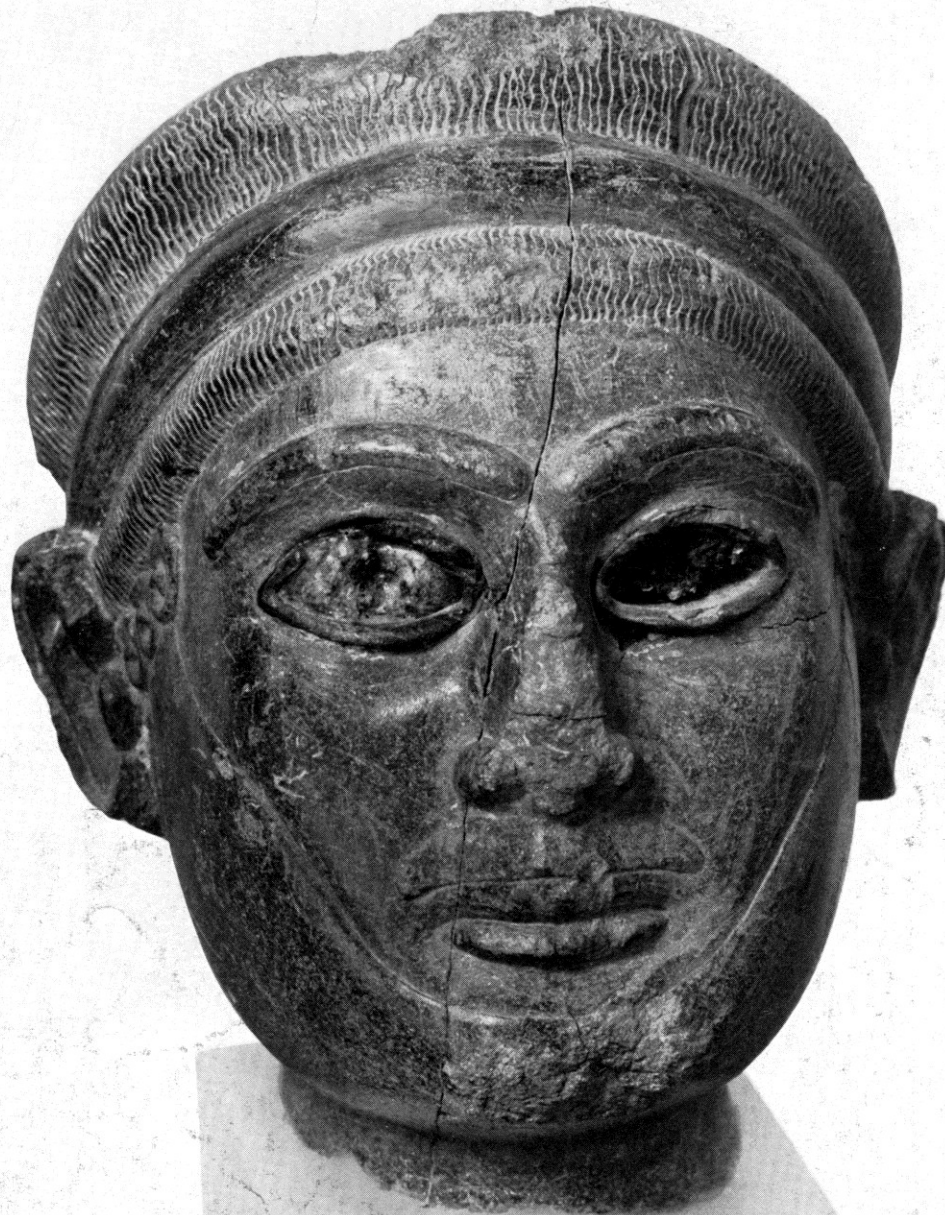




MONUMENT P3



YARIMLIM'S HEAD FROM ALALH (Tell Acana)



ROYAL STATUES FROM QATNA (Tell Mishrife)



KHABUR WARE

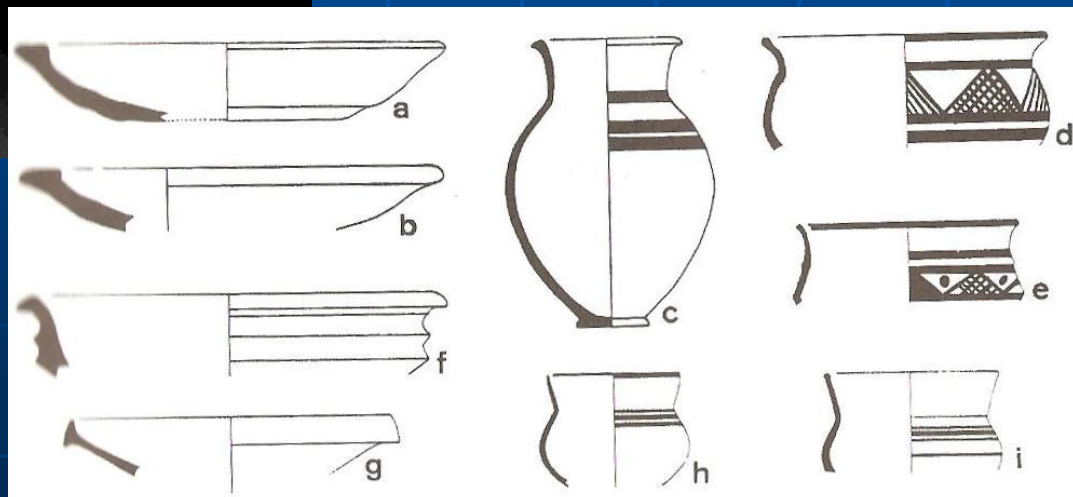


Fig. 9.14 Early second-millennium BC pottery from the Syrian Jezireh (scale 1:5).

TEMPLE AND PALACE FROM SHUBAT ENLIL/ SHEHNA (Tell Leilan)

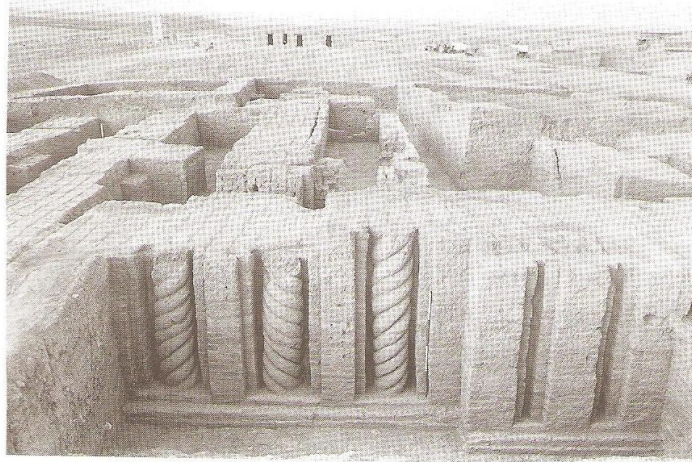
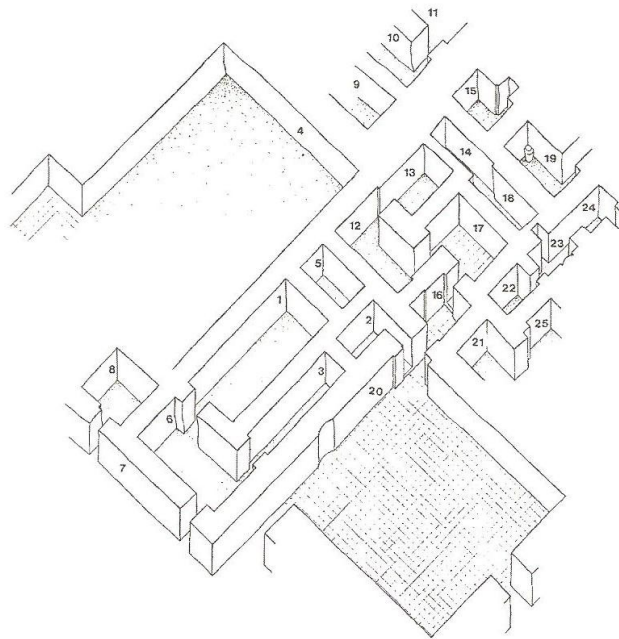


Fig. 9.15 North façade with semi-engaged columns, Leilan acropolis temple.

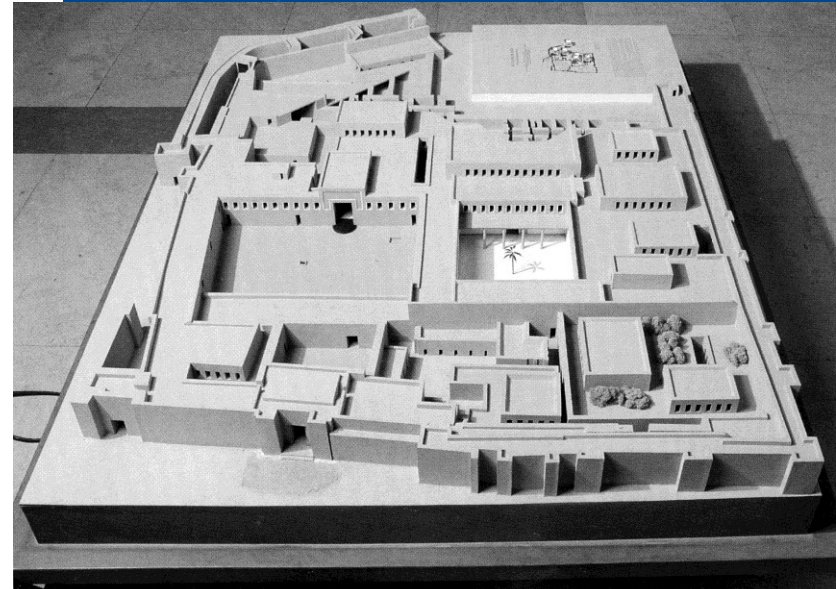
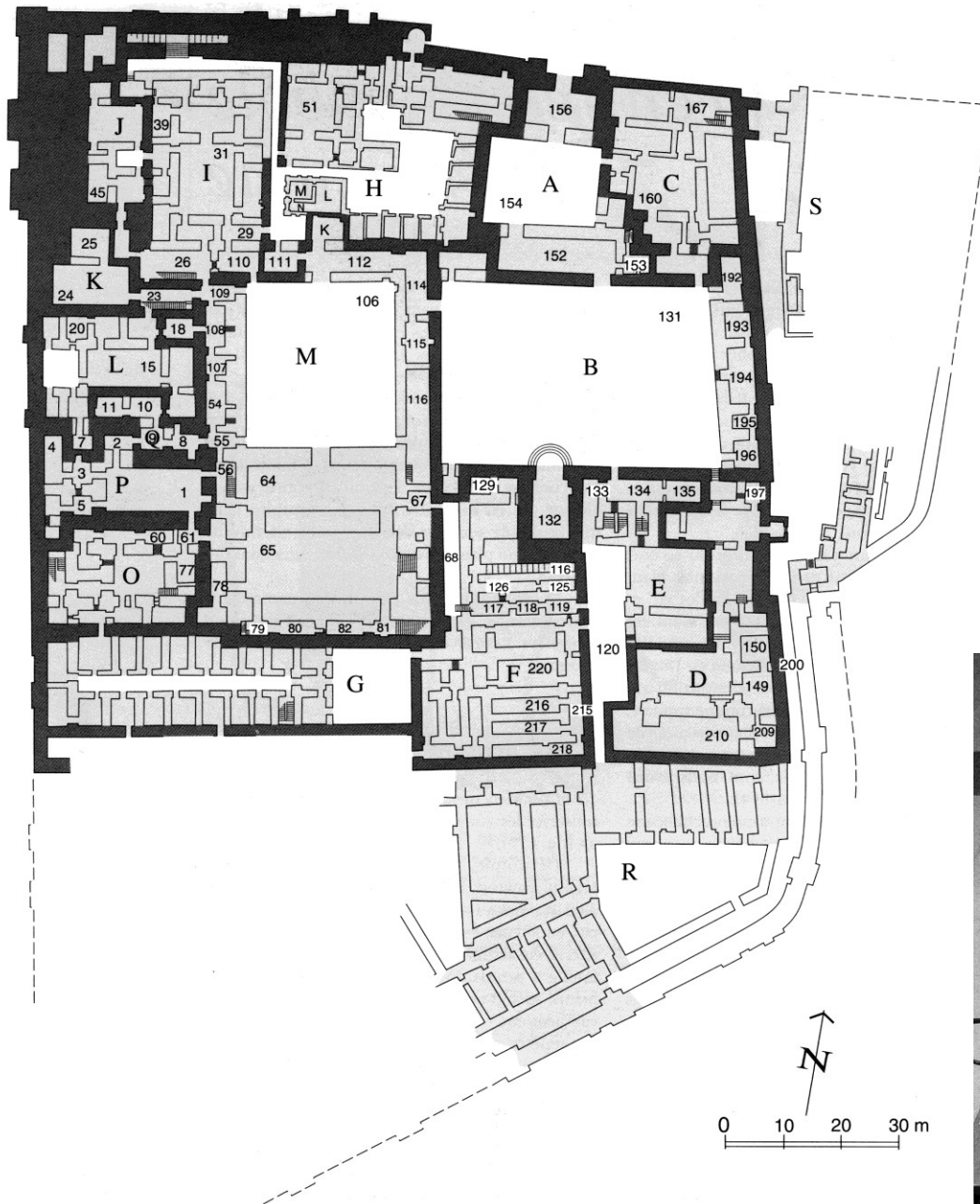


TELL LEILAN 1985-1987
LOWER TOWN PALACE

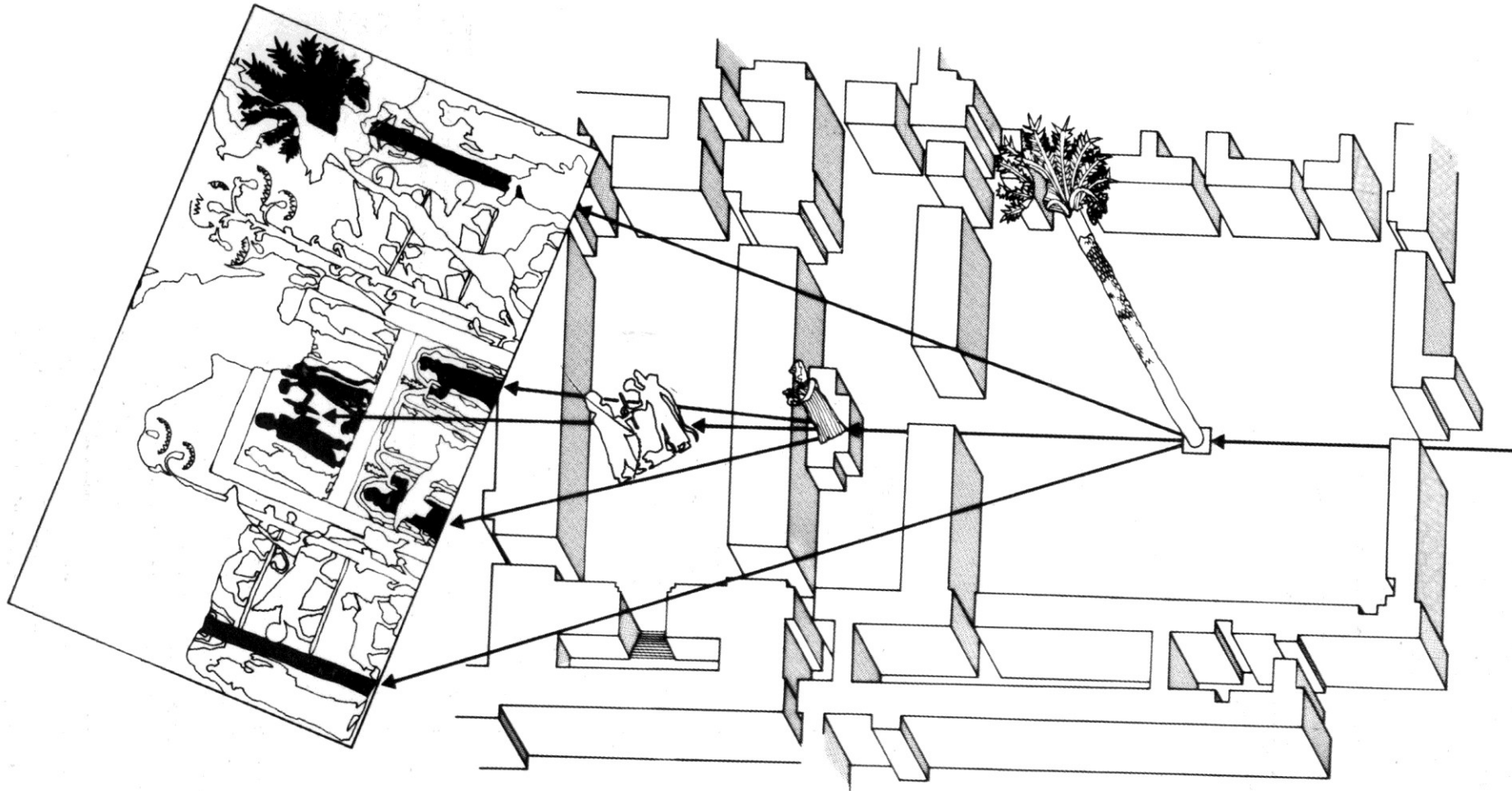


Fig. 9.16 Eastern lower town palace at Leilan.

ZIMRILIM'S PALACE FROM MARI

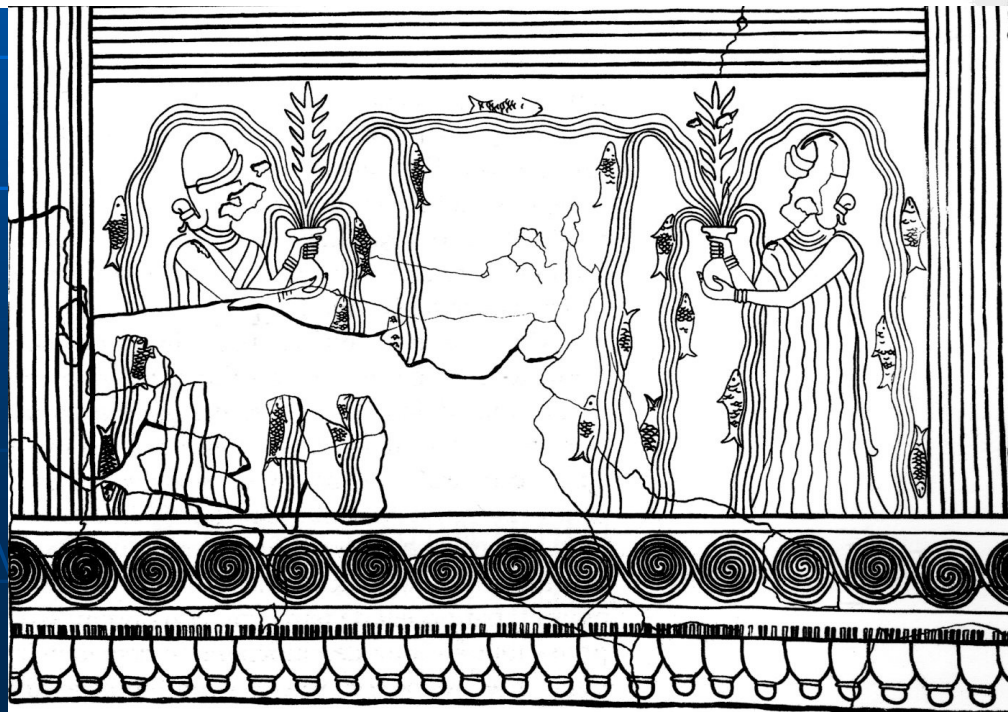
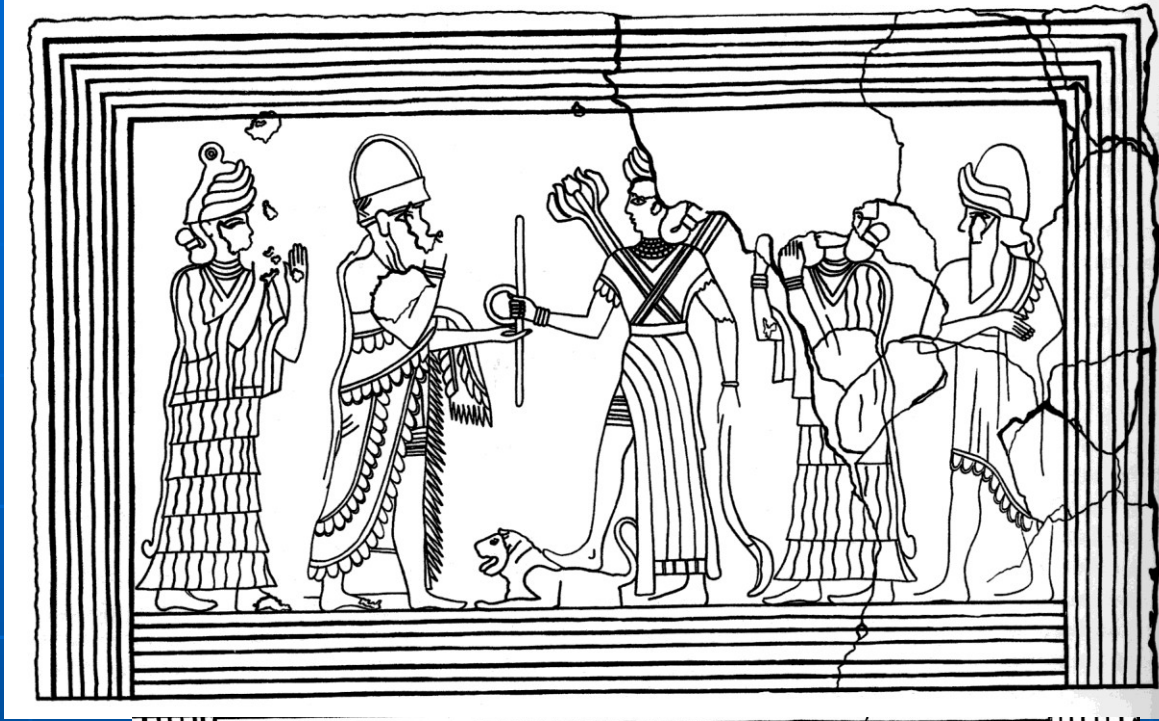


THE INVESTITURE OF ZIMRILIM PAINTING



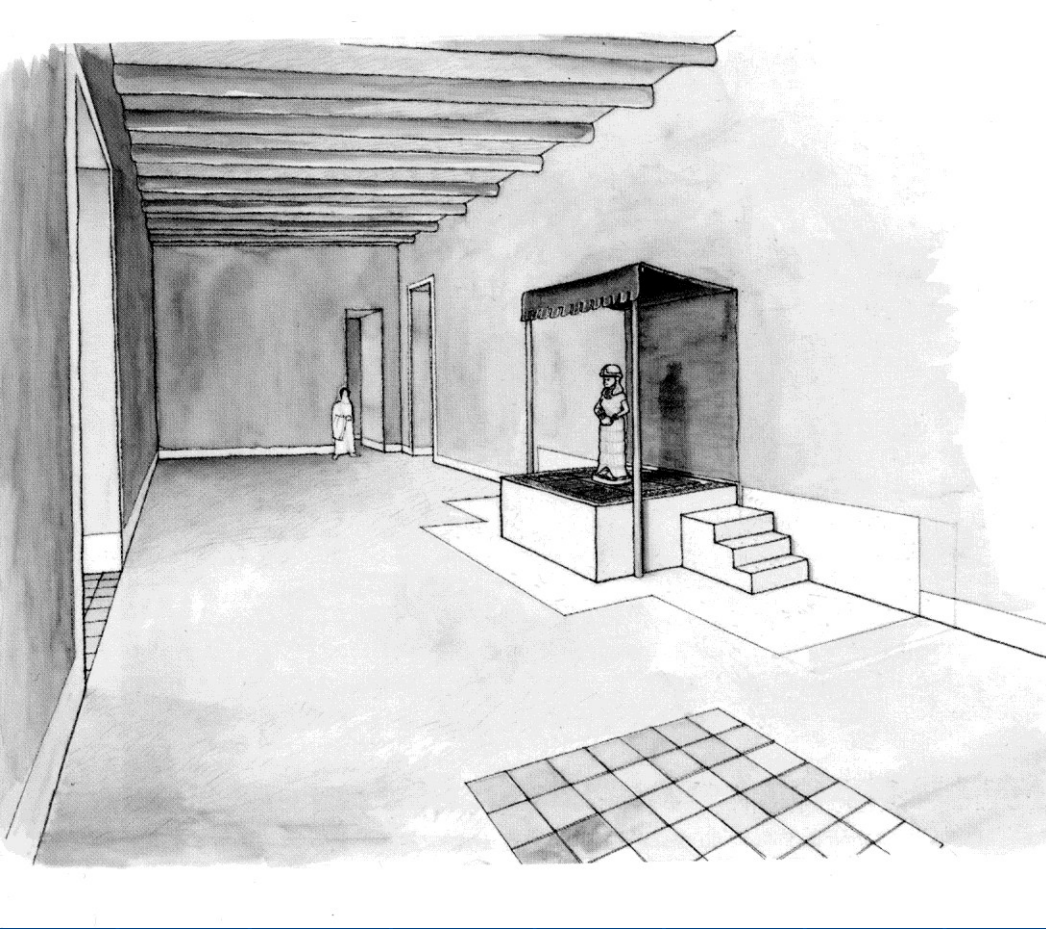
THE INVESTITURE OF ZIMRILIM











SHAKANAKKUS: ISHTUP-ILUM AND PUZUR-ISHTAR STATUES

