

CHRONOLOGY IN THE SECOND HALF OF THE 3rd MILLENNIUM

Early Jezireh II – 2600 = ED IIIa

Early Jezireh IIIa - 2500 = ED IIIb

Early Jezireh IIIb – 2350 = ED IIIb

Early Jezireh IIIb – 2300 = Akkad

Early Jezireh IVa – 2250 = Akkad

Early Jezireh IVb – 2200 = Akkad

Early Jezireh IVb - 2100 = UR III

Early Jezireh IVa – 2000 = UR III

CERAMIC SEQUENCE

EARLY JEZIREH II (2600-2500) = Late Ninivite 5

EARLY JEZIREH IIIa (2500-2400) = Late Ninivite 5 +
Metallic Ware + polichrome painted stands

EARLY JEZIREH IIIb (2400-2300) = Metallic Ware +
„Akkadian Assamblage”

METALLIC WARE (left) POLICHROME PAINTED STANDS

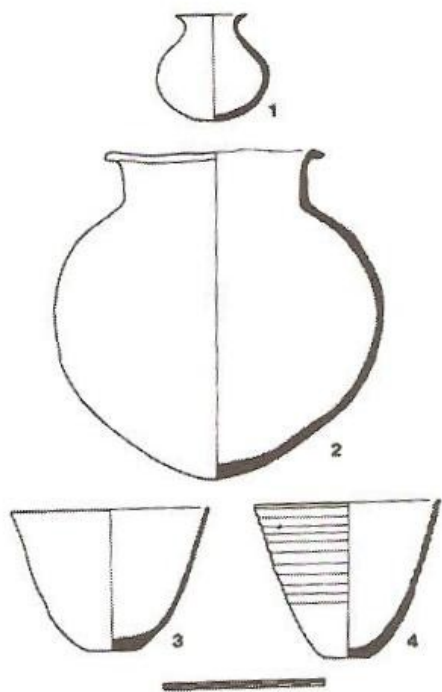

Ryc. 25. Tell Chuera, przykłady naczyń typu *Metallic Ware* (wg Pruß A. 2000b, 203, fig. 2).

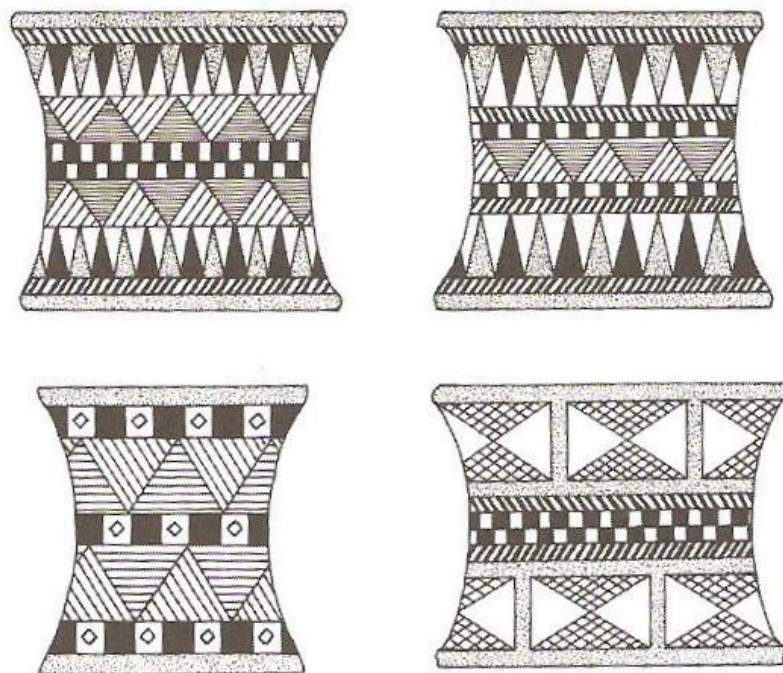

Ryc. 26. Typy malowanych podstawek pod naczynia, okres wczesnodynastyczny II/III (wg Valentini S. 2003, 76, fig. 2).

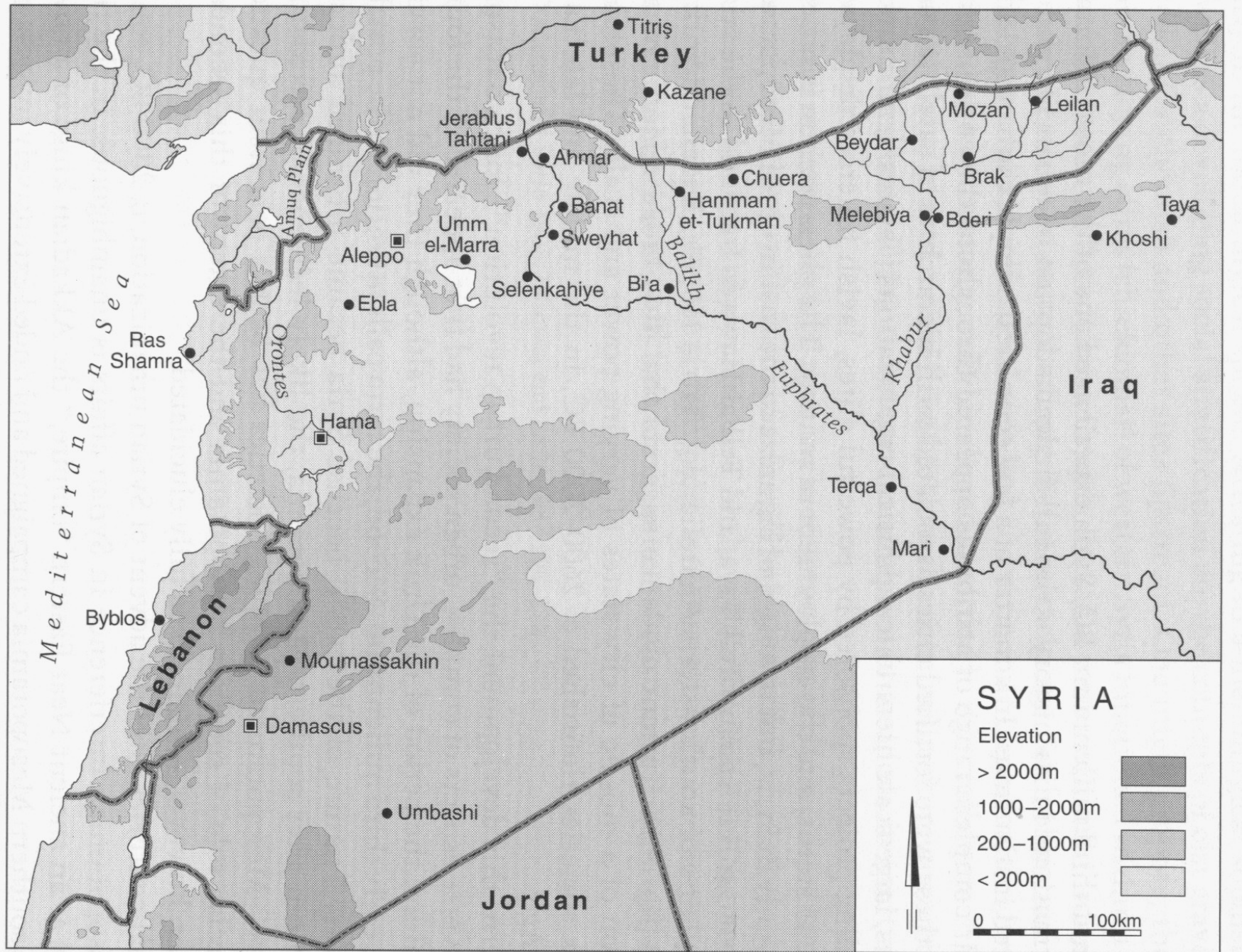

TELL BRAK – OVAL BUILDING

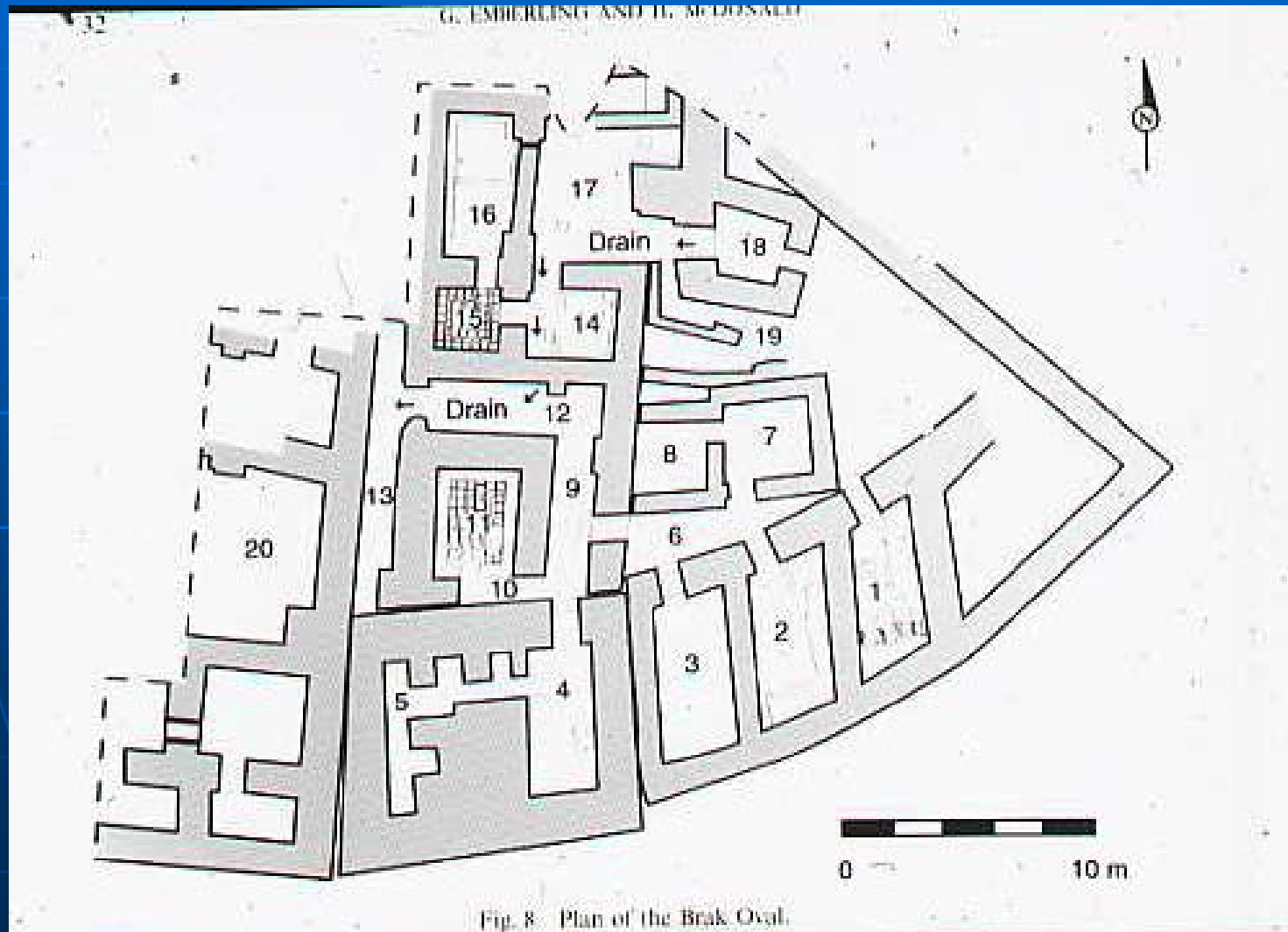

TELL CHUERA – KRANZHÜGEL

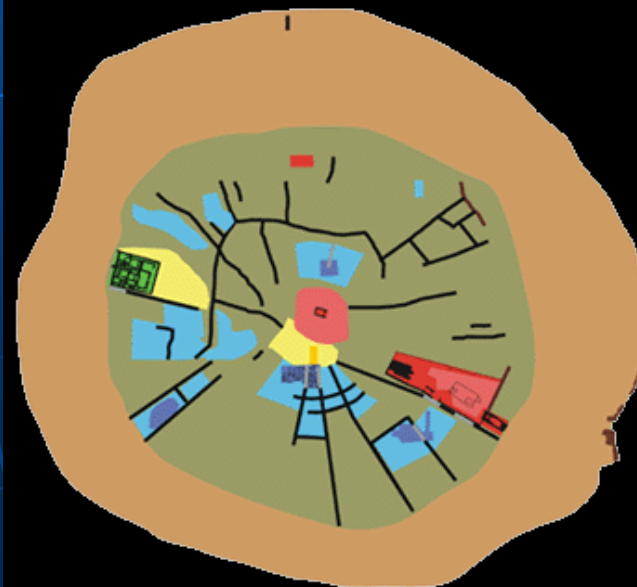
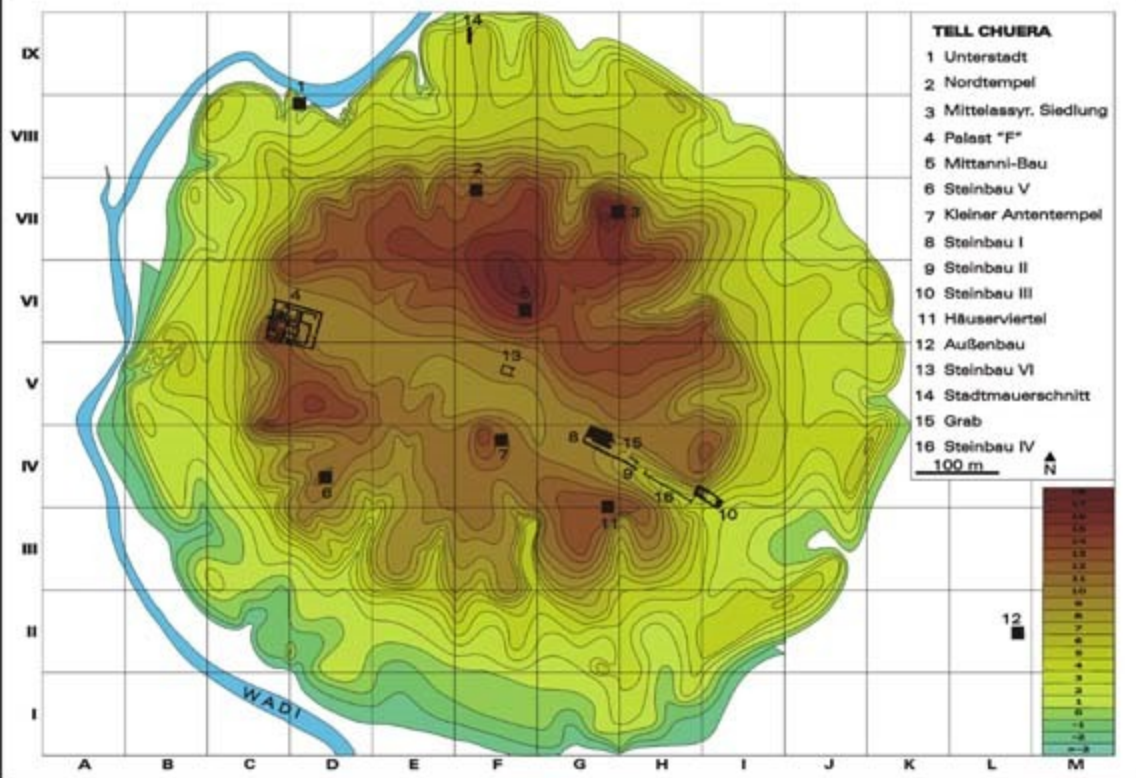

Flächennutzungsplanung

Unterstadt: Flächennutzung im städtischen Umfeld, vornehmlich überörtlicher Wohnbevölkerung

Obenstadt: Bereiche mit ungestörter Flächennutzung

Funktionsbereiche in der Obenstadt:

durch Entfernung nach Freizeitanlagen
nahgelegenen angeordnet

Wohngebiet

Tempelbereich

Freizeitanlagen

Straßen

Befestigung, Tore







Palast

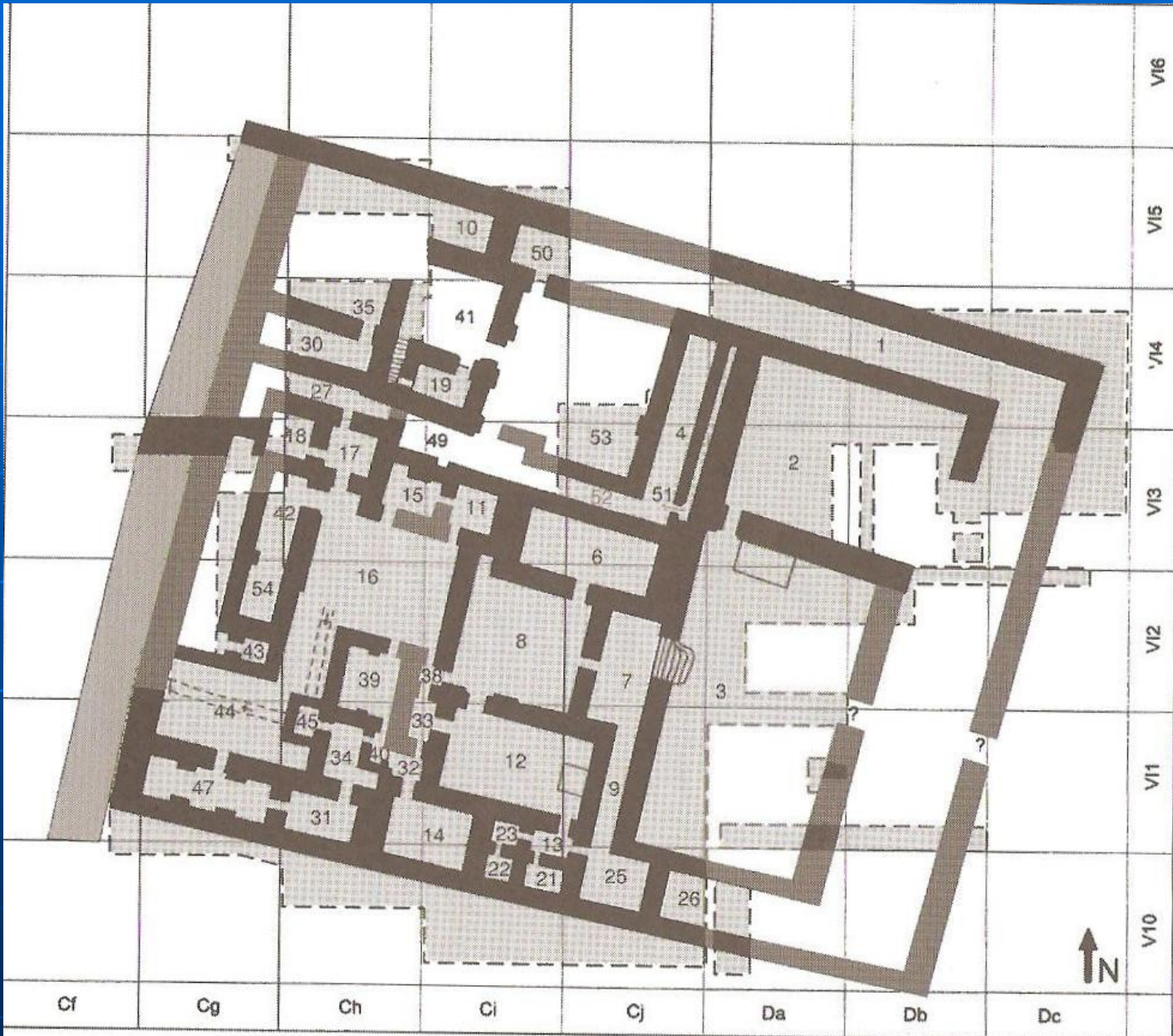



Tell Chuera
 Palace F
 Level 2b1
 State of 2000



-  excavated walls
-  reconstructed palace walls
-  reconstructed inner city wall
-  excavated area
-  room number
-  podium
-  drain

0 10m



Antentempel Schicht 1

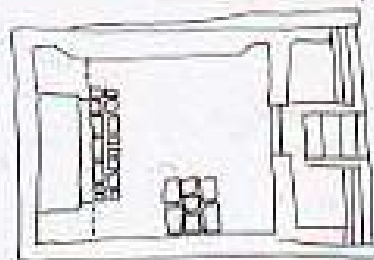

Antentempel Schicht 2

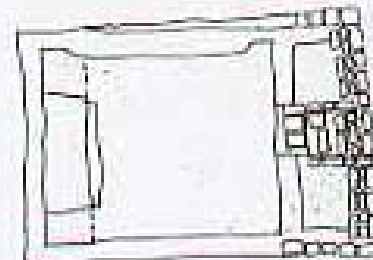

Antentempel Schicht 3

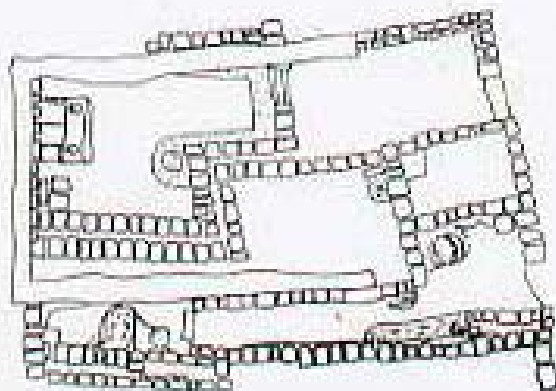

Tempel der Schicht 4

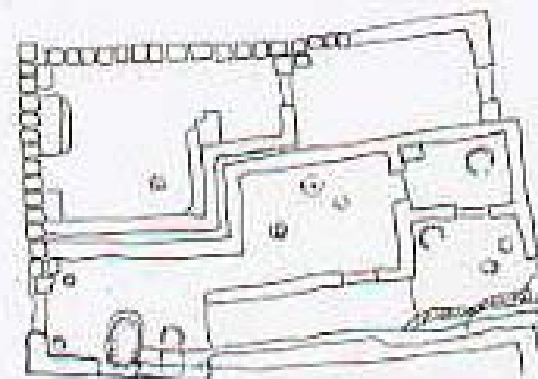

Tempel der Schicht 5



Abb. 3 Kl. Anten-Tempel, Schicht 1—5 (schematische Bauaufnahmen)

o-
a
e-
a-
el
a
à
si
à
o-
s-
z,
o-
an
o-
t:

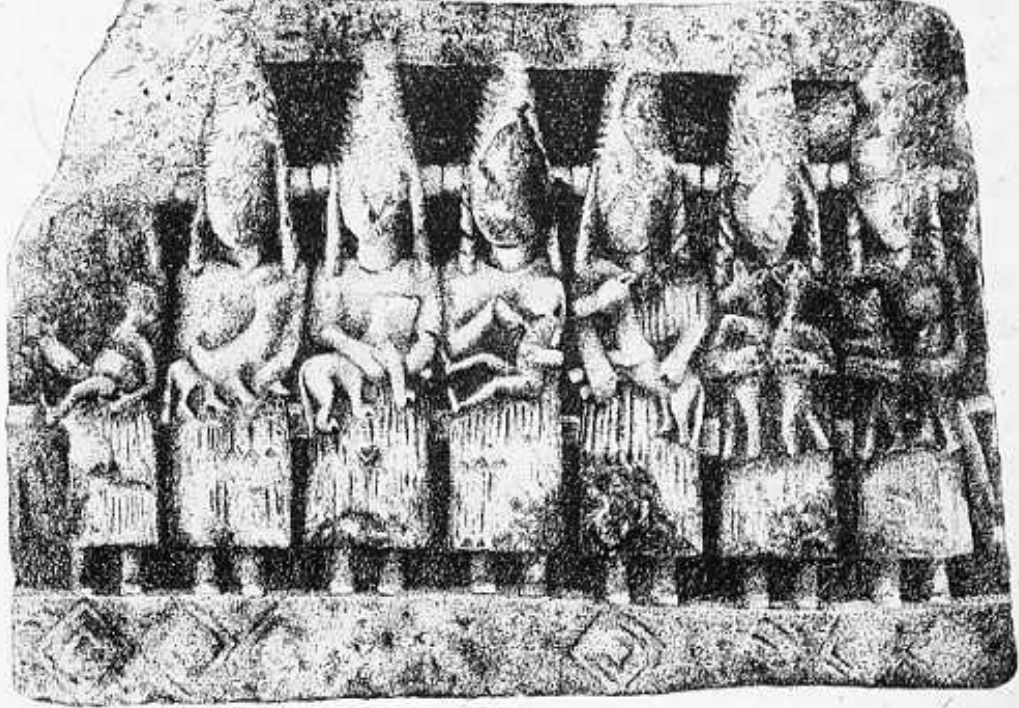

TELL BEIDAR PALACE – PHASE 1 AND 2

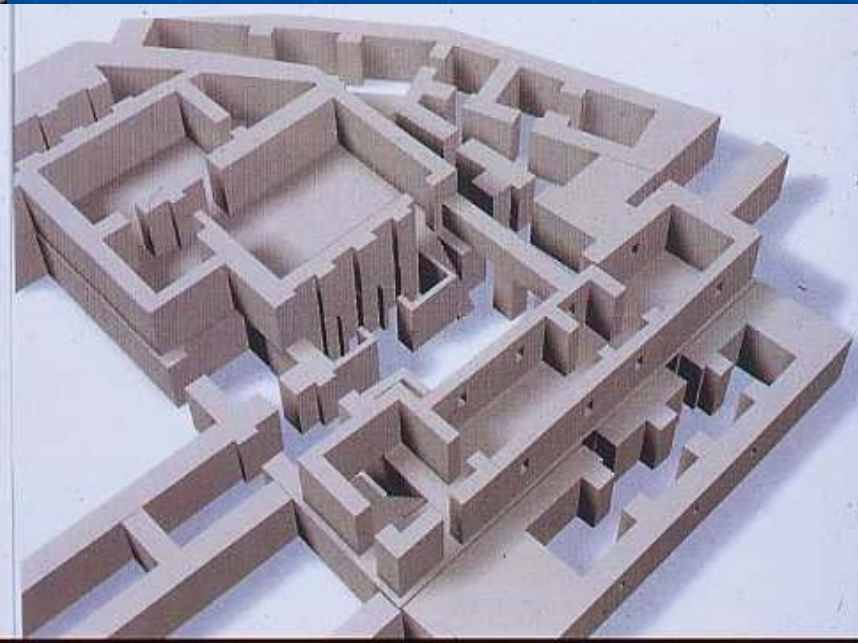
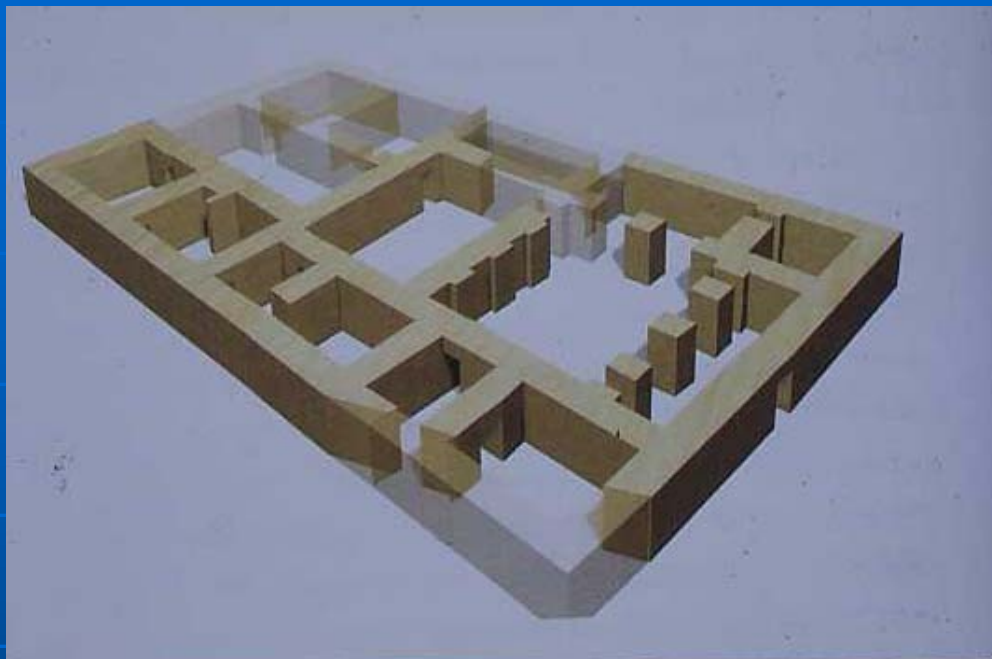

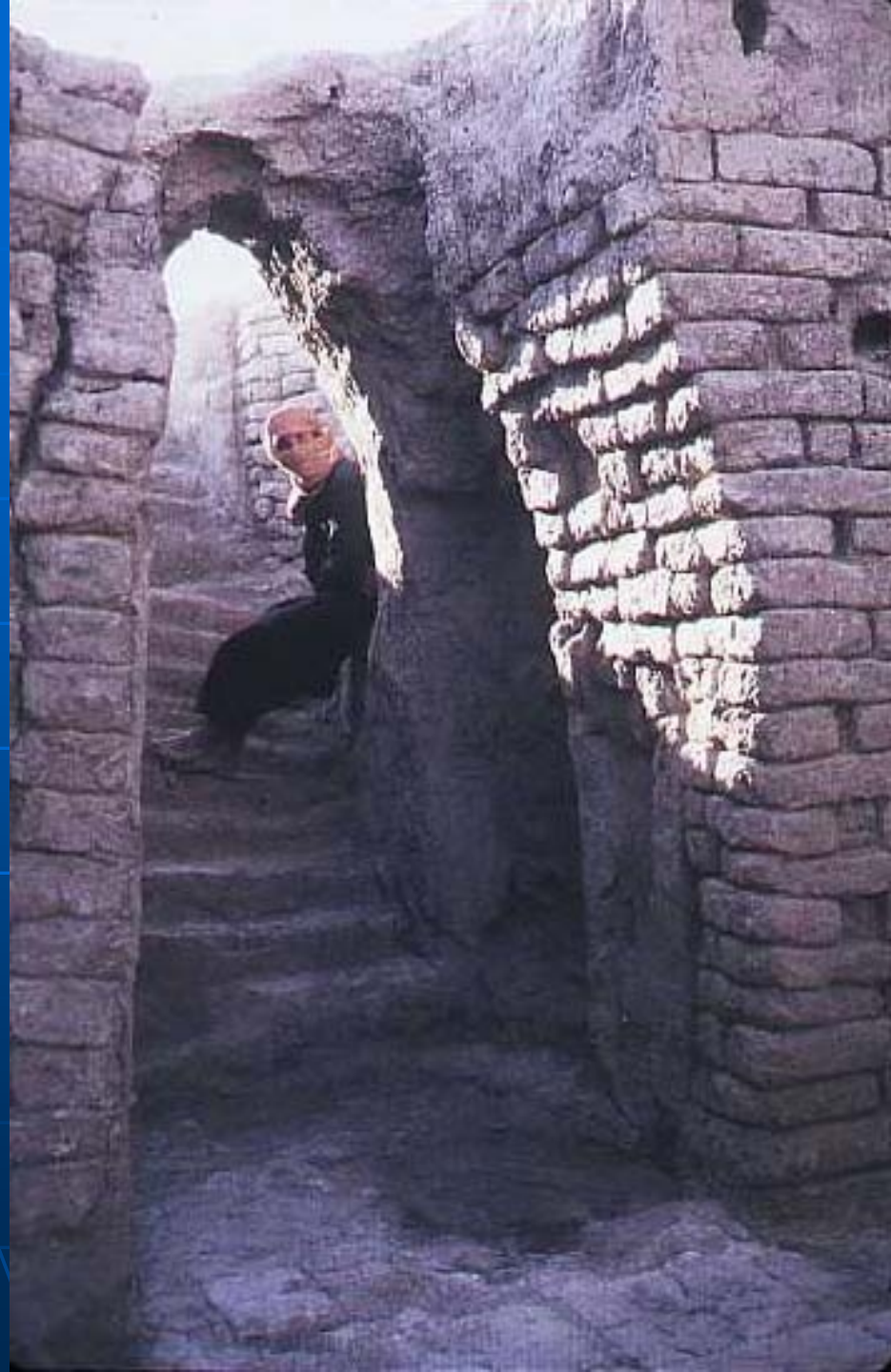



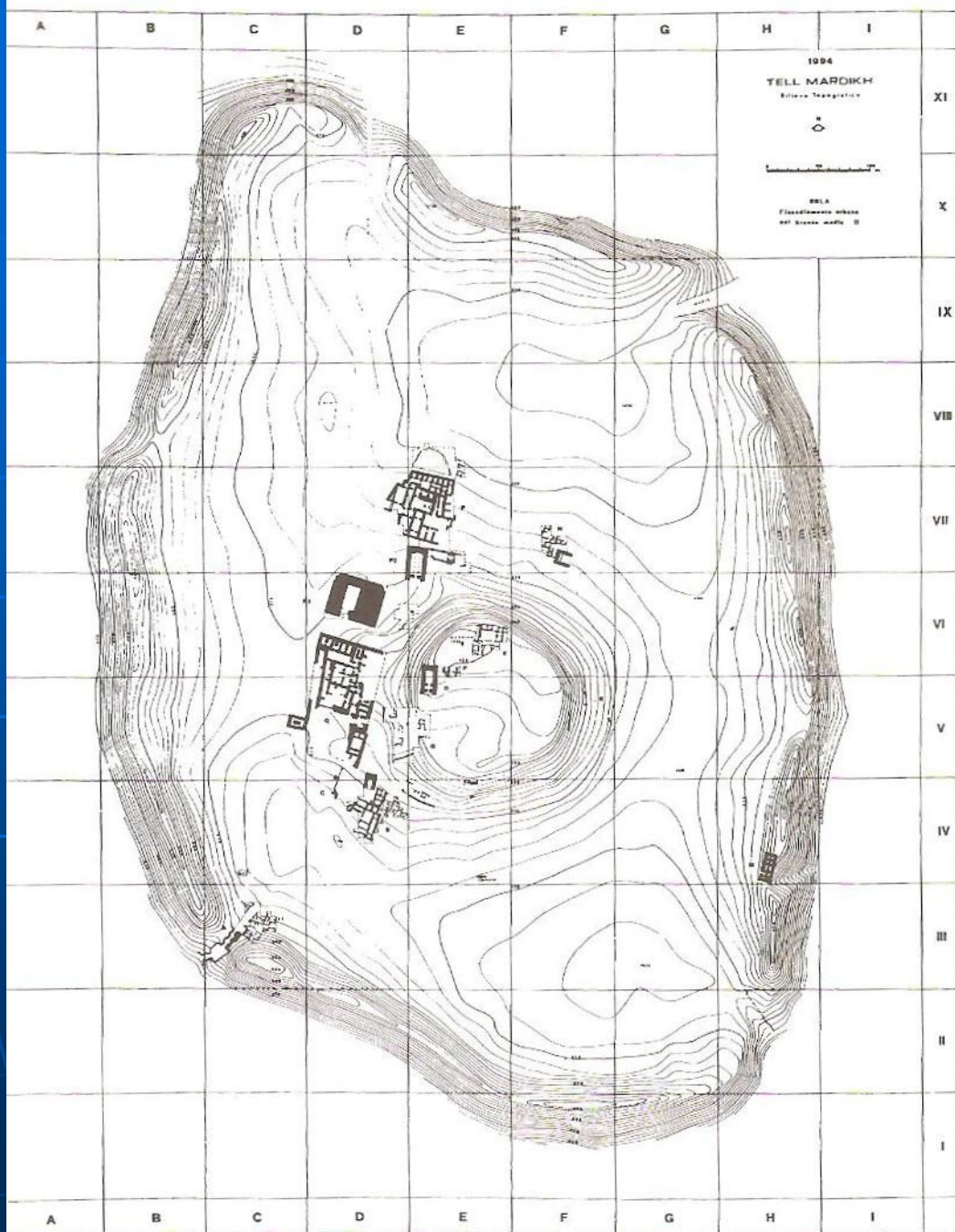
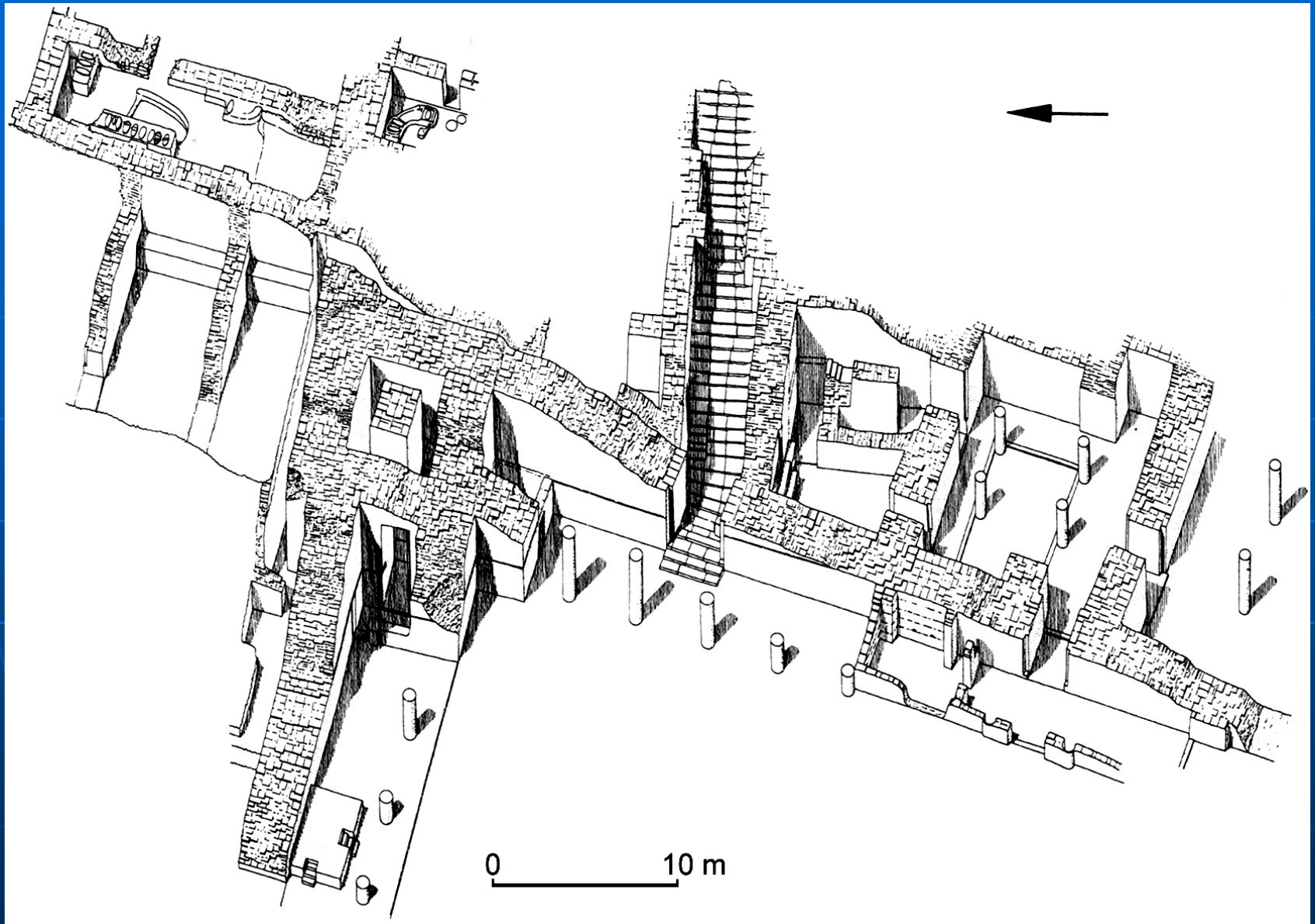

Fig. 9.5 Ebla; note thick enclosure wall around site and acropolis

EBLA – PALACE G ca. 2350-2100 BC



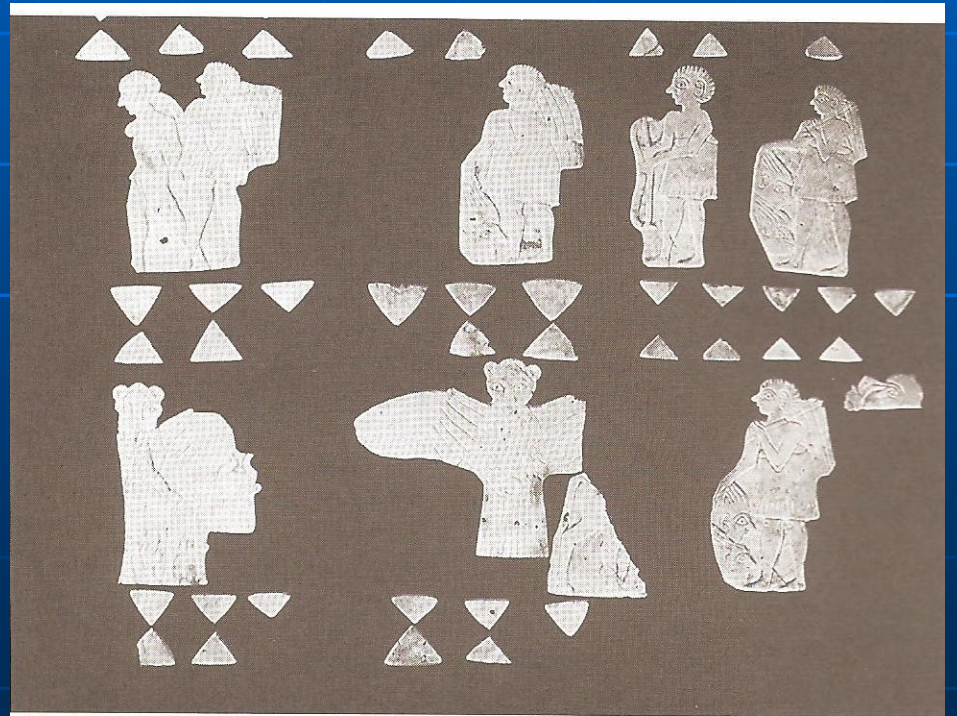

Fig. 8.6 Limestone inlays from the "Standard of Ebla."

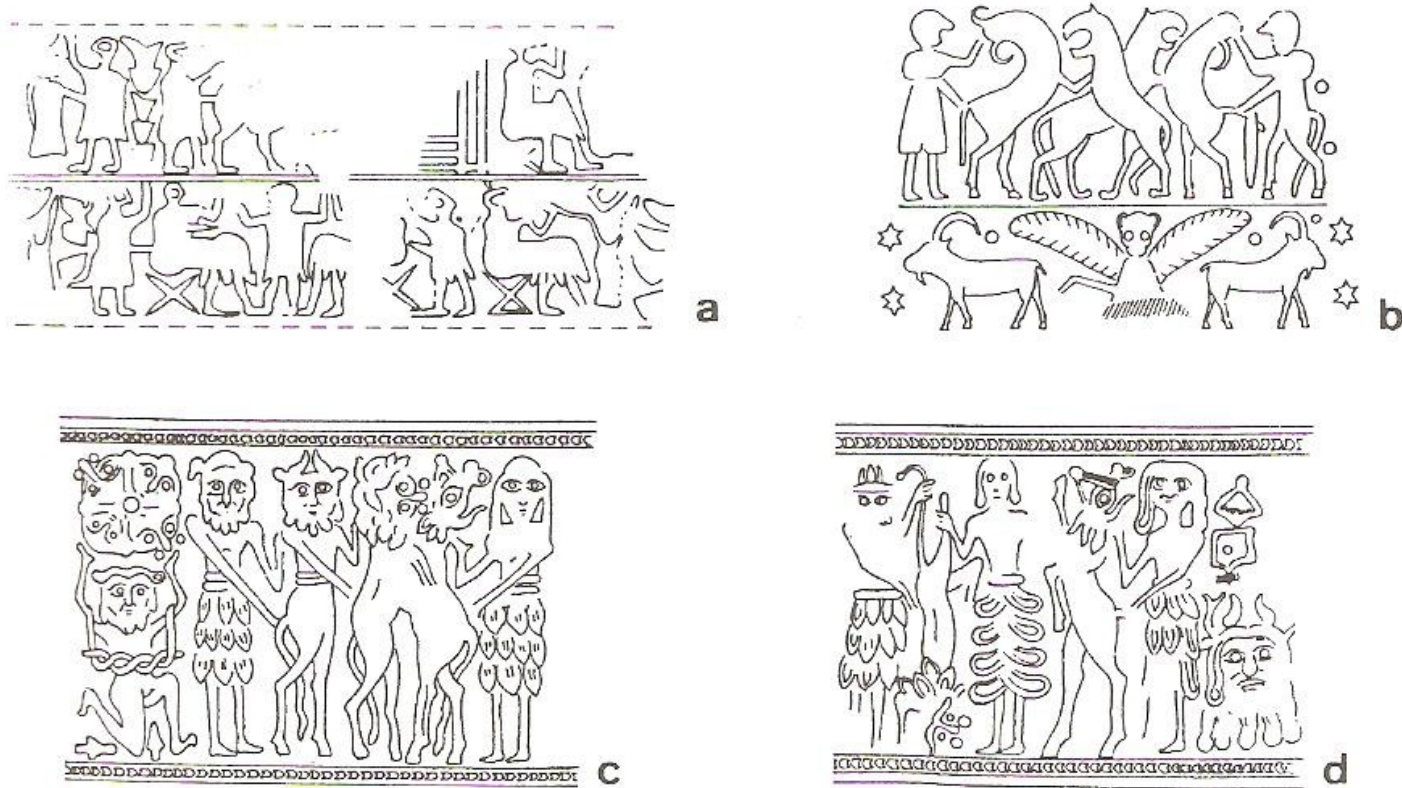

Fig. 8.7 Mid/late third-millennium BC cylinder seal art from Brak (a–b) and Ebla (c–d).

the practice. Noting that the relatively simple, linear sealings on the vessels

TELL BANAT – TOMB 7 (up)
THE WHITE MONUMENT (down)
ca. 2600-2450 BC

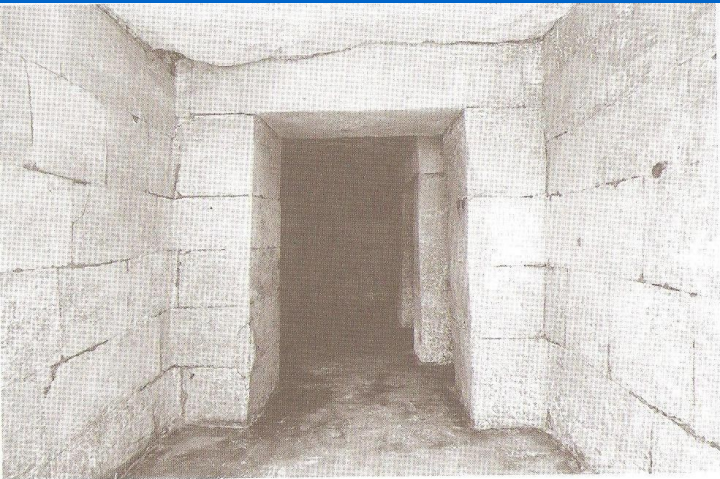
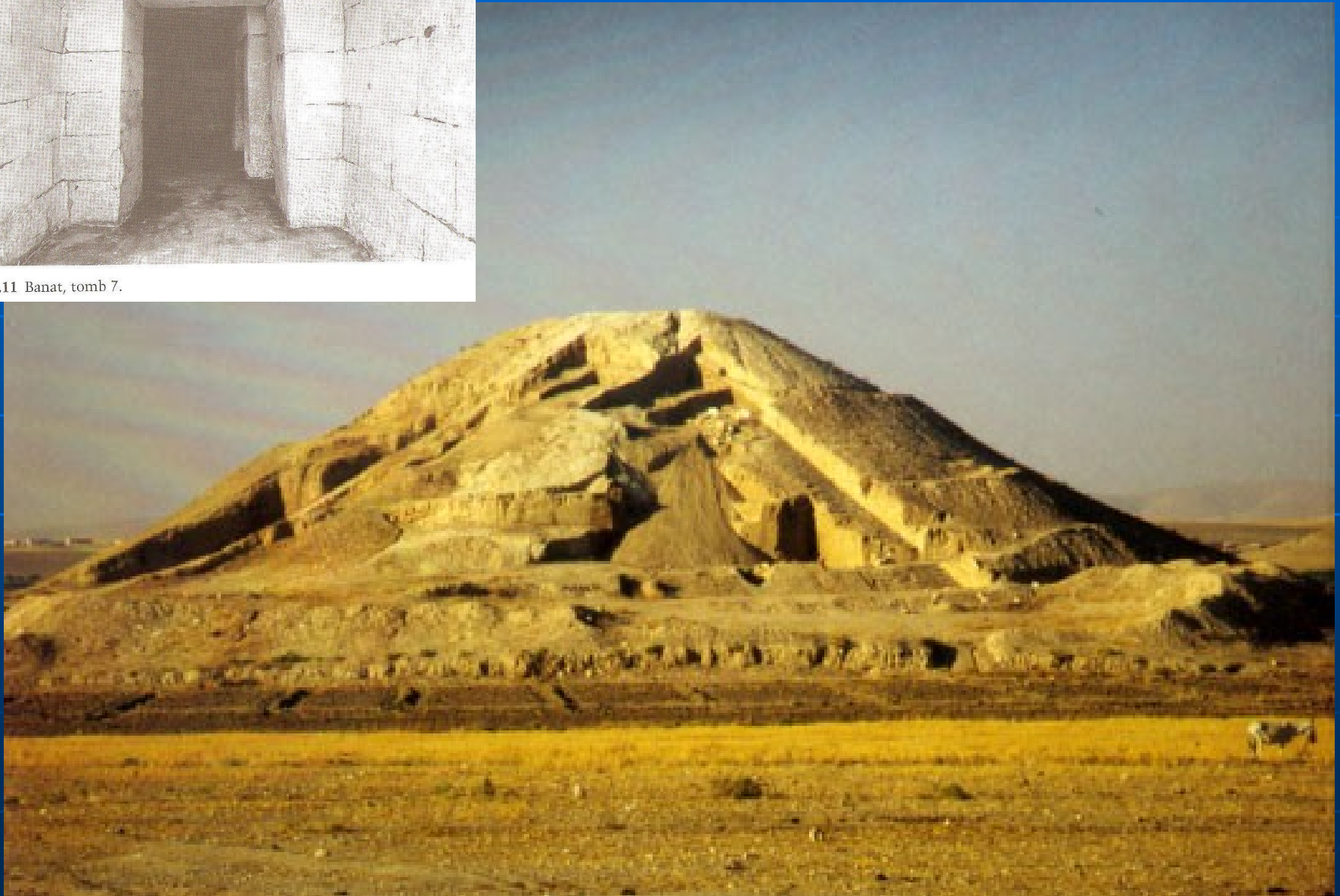
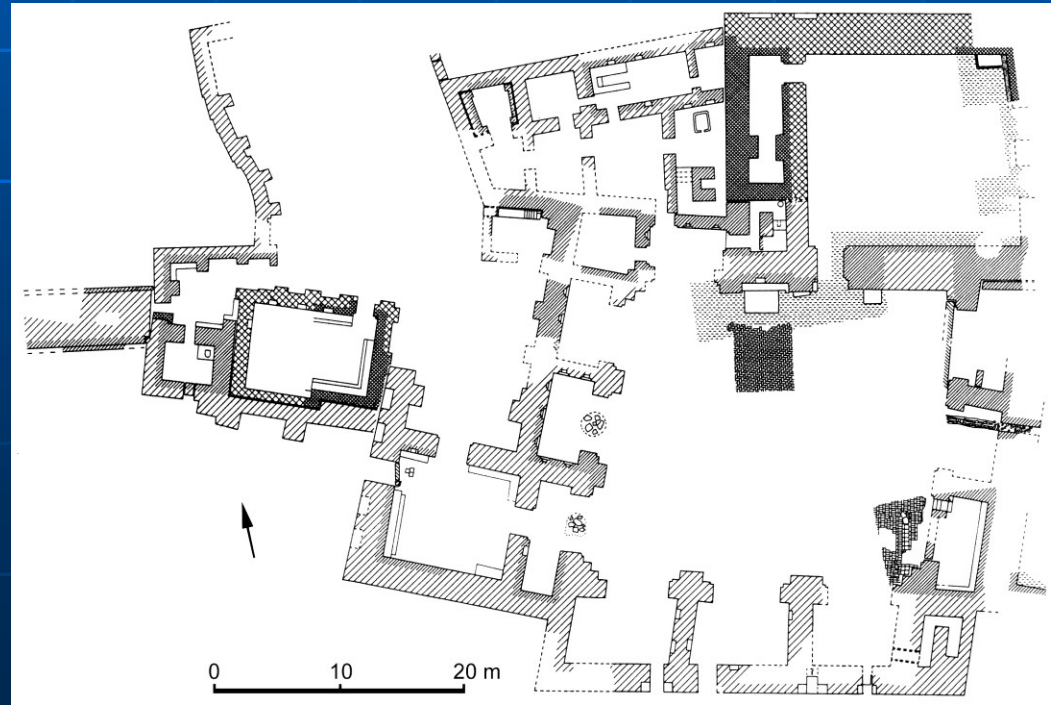
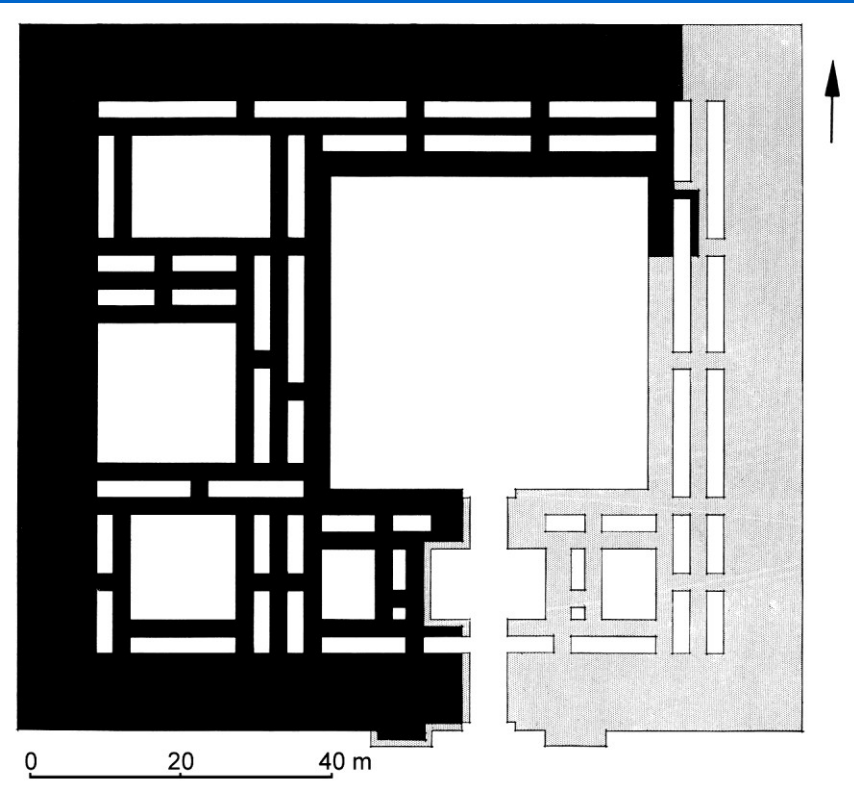

Fig. 8.11 Banat, tomb 7.



TELL BRAK: NARAMSIN'S FORT AND ADMINISTRATIVE SECTOR



LATE III MILLENNIUM PALACE AT URKESH (Tell Mozan)

