

# CHRONOLOGY IN THE SECOND HALF OF THE 3rd MILLENNIUM

**Early Jezireh II – 2600 = ED IIIa (MESOPOTAMIA)**

**Early Jezireh IIIa - 2500 = ED IIIb**

**Early Jezireh IIIb – 2350 = ED IIIb**

**Early Jezireh IIIb – 2300 = Akkad**

**Early Jezireh IVa – 2250 = Akkad**

**Early Jezireh IVb – 2200 = Akkad**

**Early Jezireh IVb - 2100 = UR III**

**Early Jezireh IVa – 2000 = UR III**

## CERAMIC SEQUENCE

EARLY JEZIREH II (2600-2500) = Late Ninivite 5

EARLY JEZIREH IIIa (2500-2400) = Late Ninivite 5 +  
Metallic Ware + polichrome painted stands

EARLY JEZIREH IIIb (2400-2300) = Metallic Ware +  
„Akkadian Assamblage”

# METALLIC WARE (left), top and bottom) POLICHROME PAINTED STANDS (right, bottom)

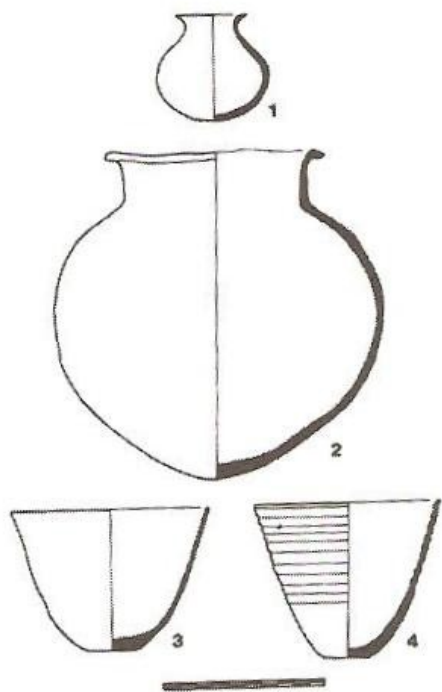

Ryc. 25. Tell Chuera, przykłady naczyń typu *Metallic Ware* (wg Pruß A. 2000b, 203, fig. 2).

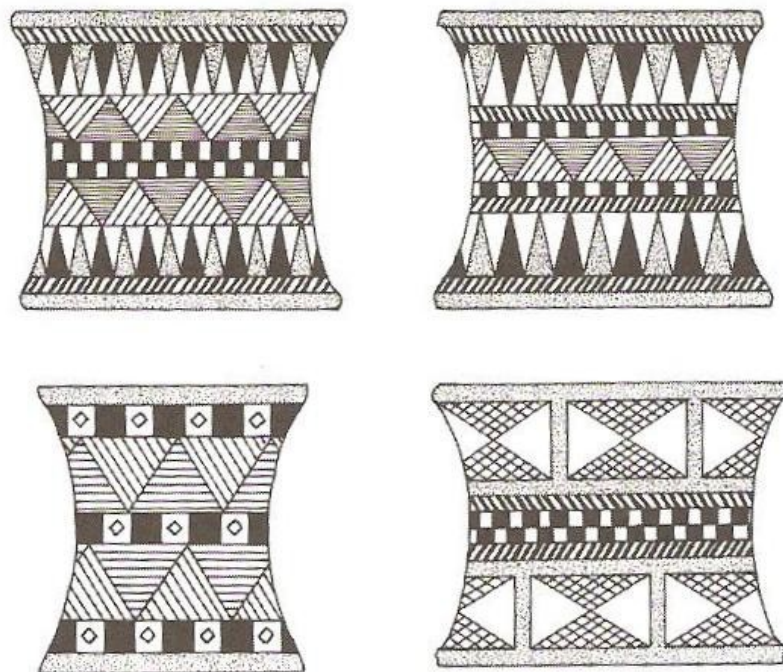

Ryc. 26. Typy malowanych podstawek pod naczynia, okres wczesnodynastyczny II/III (wg Valentini S. 2003, 76, fig. 2).

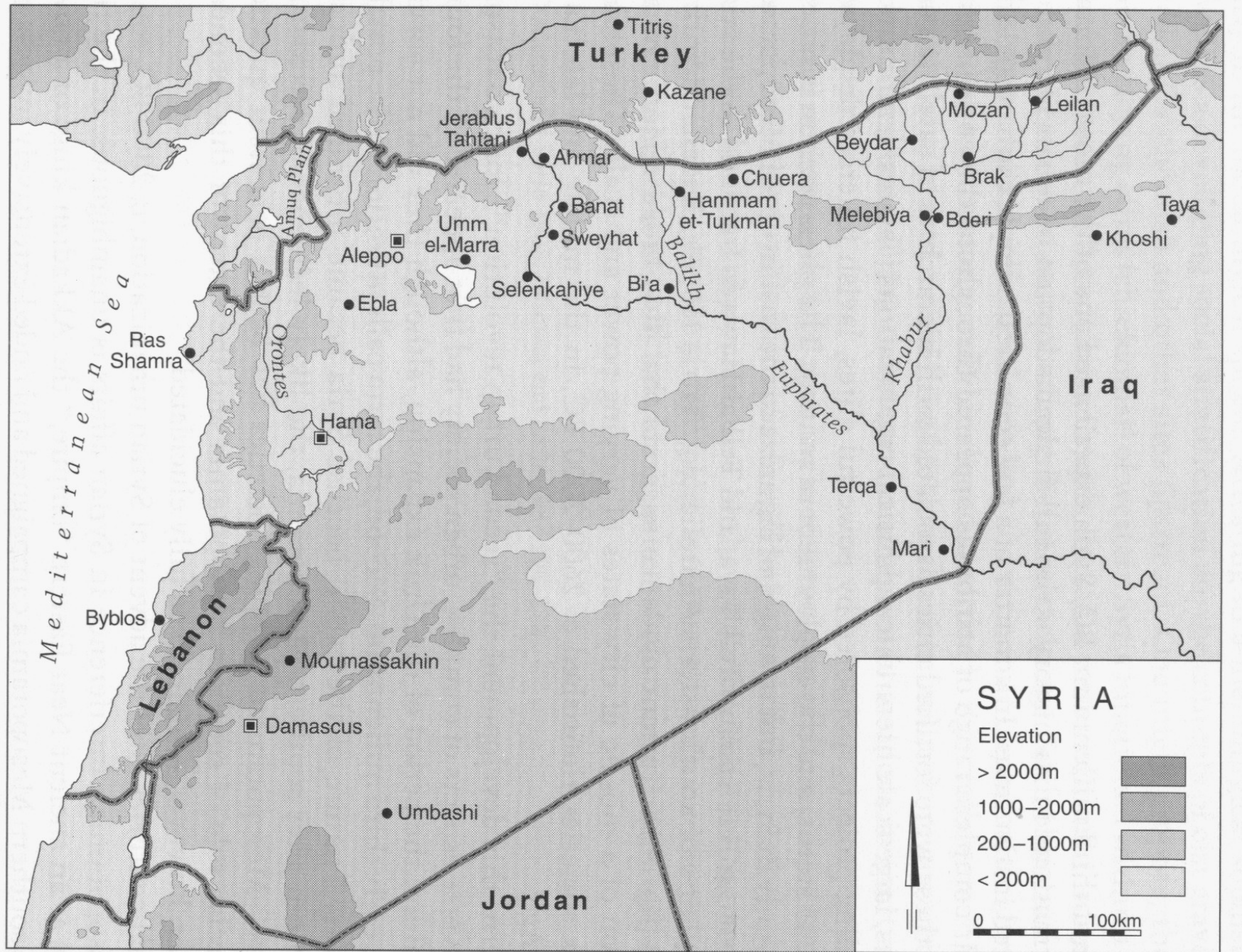

# TELL BRAK – OVAL BUILDING

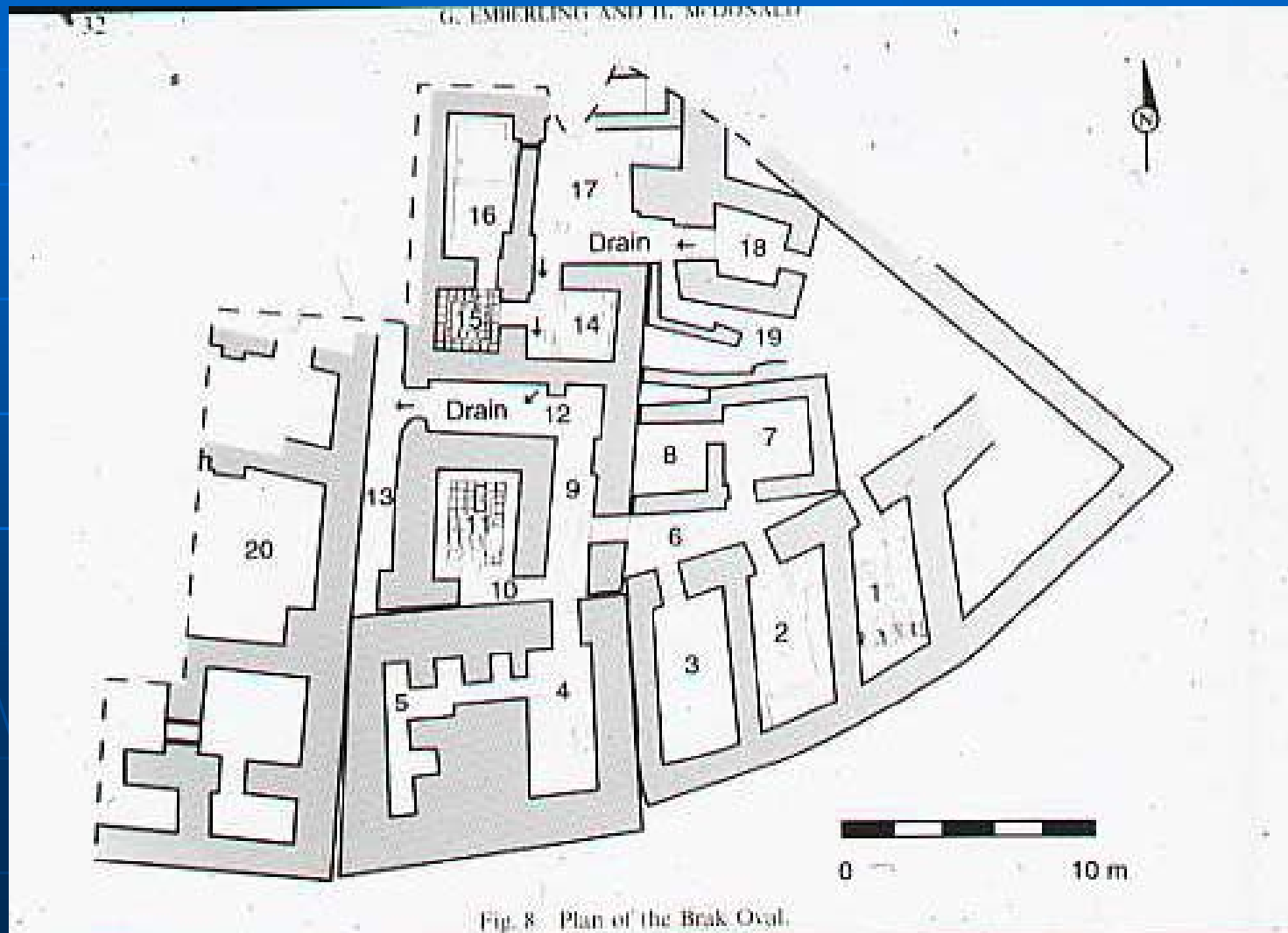

# TELL CHUERA – KRANZHÜGEL

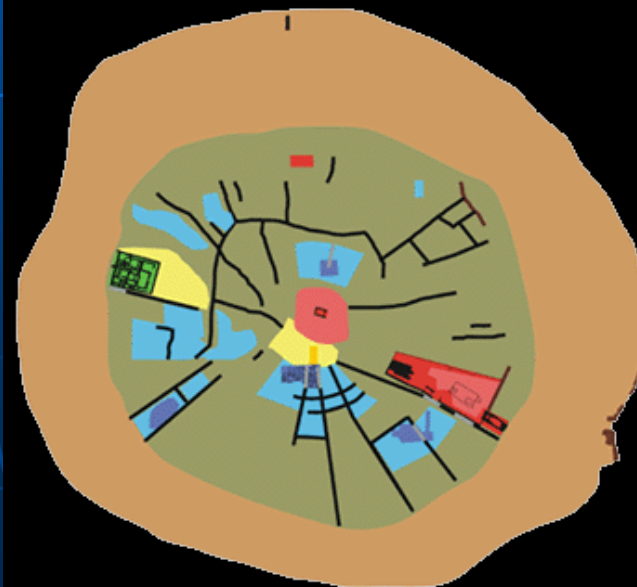
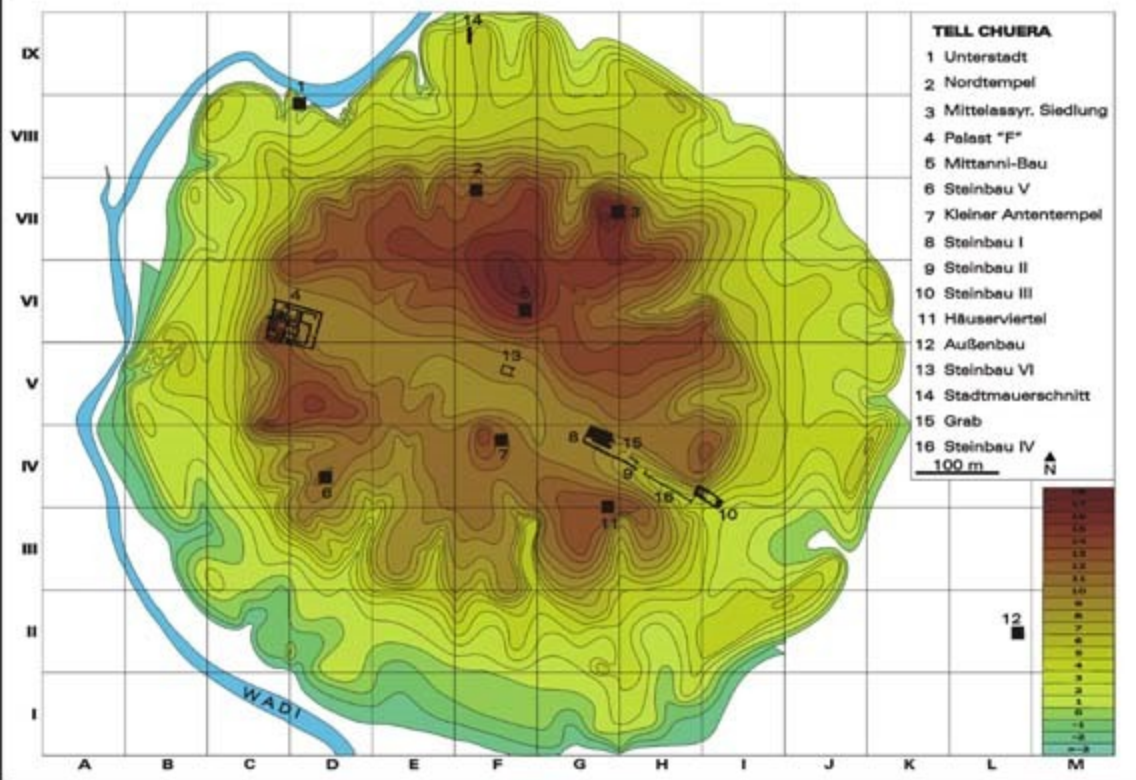

## Flächverteilung

Unterstadt: Flächenverteilung im obigen angeführt, vornehmlich überhöhter Wohnbebauung

• Oberstadt: Bereiche mit ungenutzter Flächenverteilung

## Funktionsbereiche in der Oberstadt:





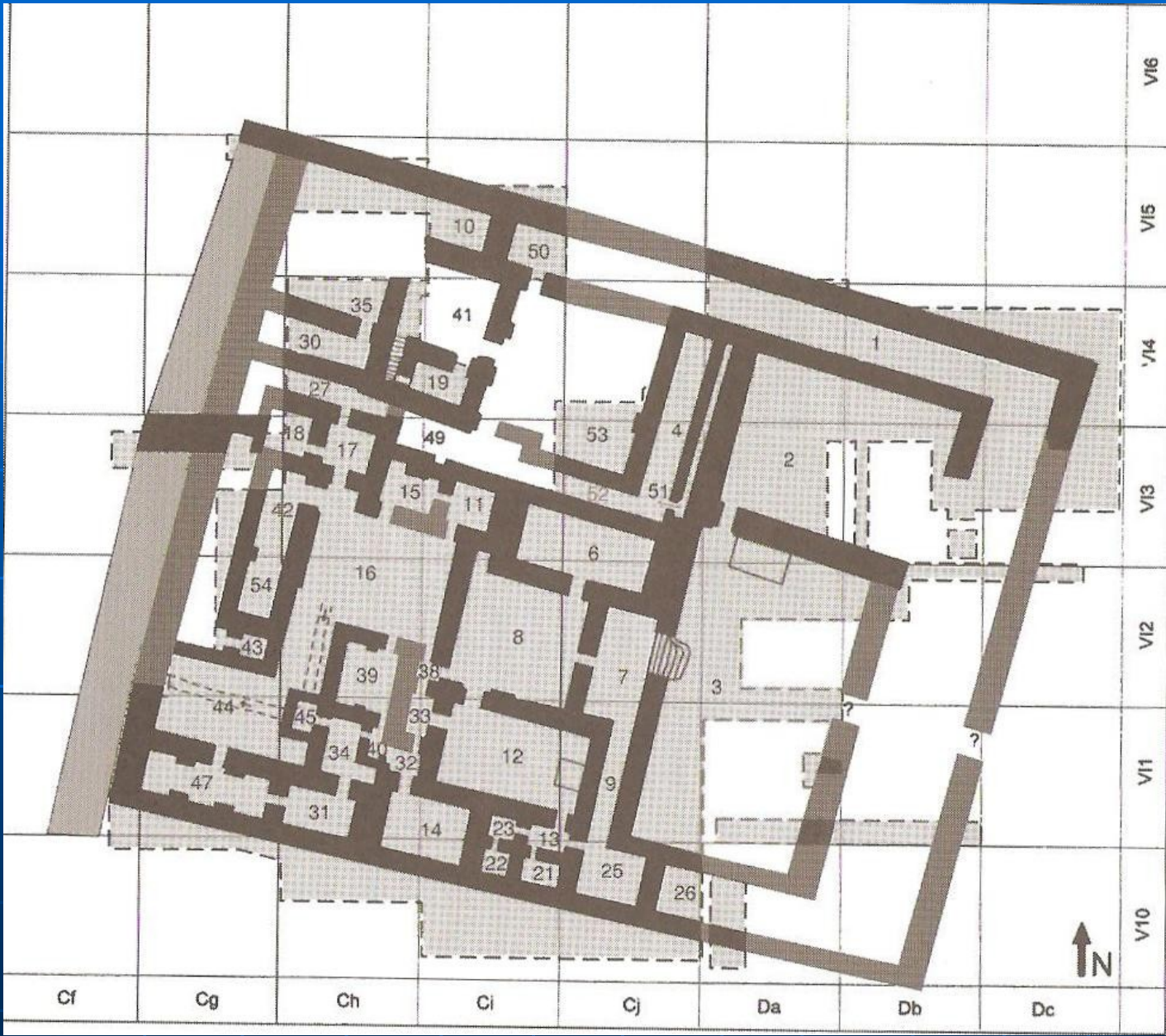

durch Entfernung nach Freizeitanlagen  
nahgelegenen angeführt

Wohngebiet		
Tempelbereich		
Freizeitanlagen		
Straßen		
Befestigung, Tore		
Palast		



Tell Chuera  
 Palace F  
 Level 2b1  
 State of 2000



-  excavated walls
-  reconstructed palace walls
-  reconstructed inner city wall
-  excavated area
-  room number
-  podium
-  drain

0 10m



# Temple in antis from Tell Chuera in Upper Khabur – different phases



Antentempel Schicht 1

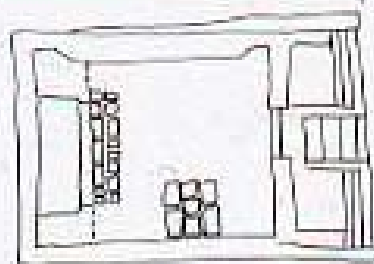

Antentempel Schicht 2

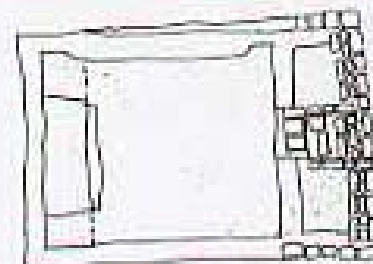

Antentempel Schicht 3

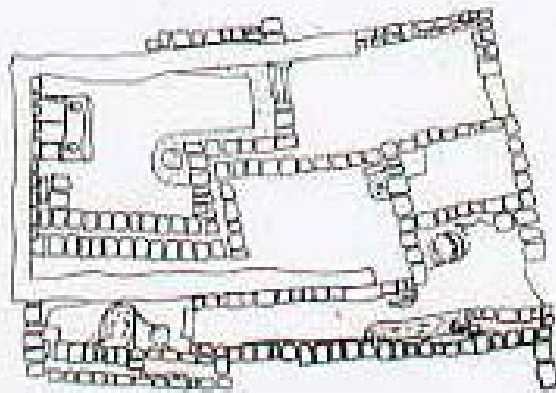

Tempel der Schicht 4

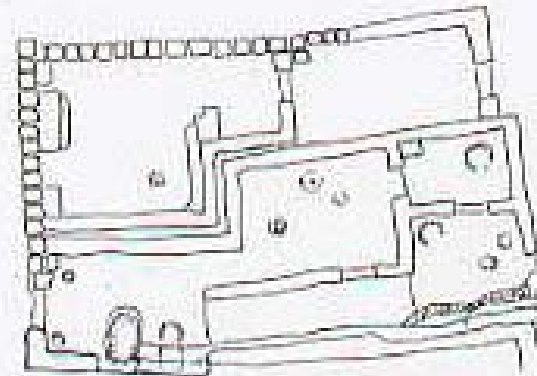

Tempel der Schicht 5



Abb. 3 Kl. Anten-Tempel, Schicht 1–5 (schematische Bauaufnahmen)

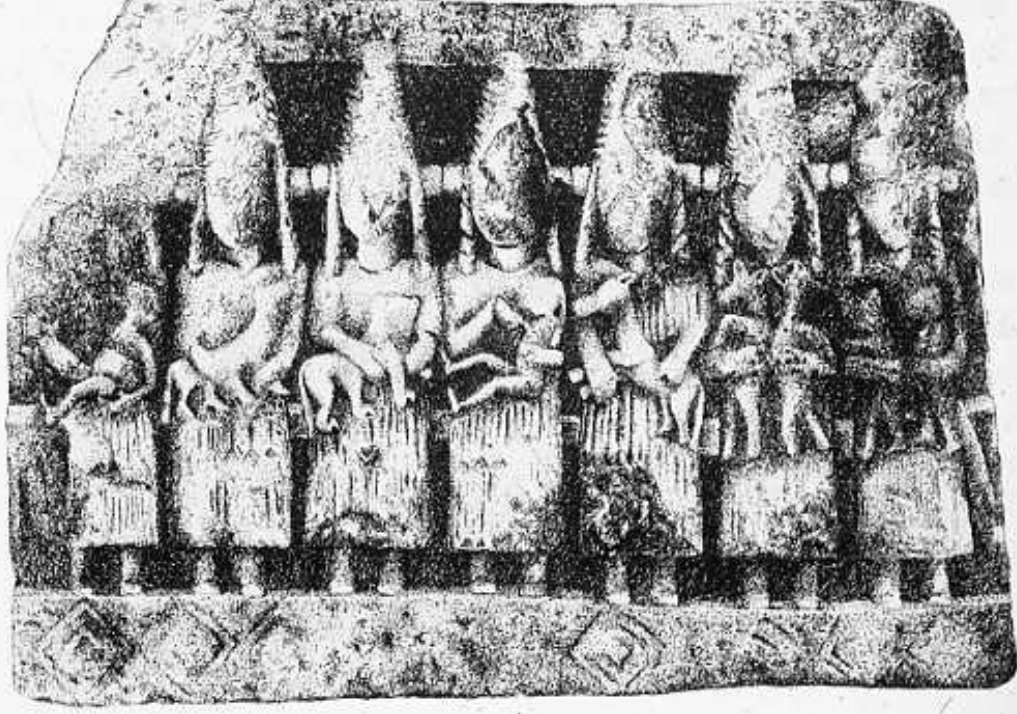

Cultic basin from Tell Chuera (top, left), praying man figurine (bottom, right)



# TELL BEIDAR PALACE – PHASE 1 AND 2

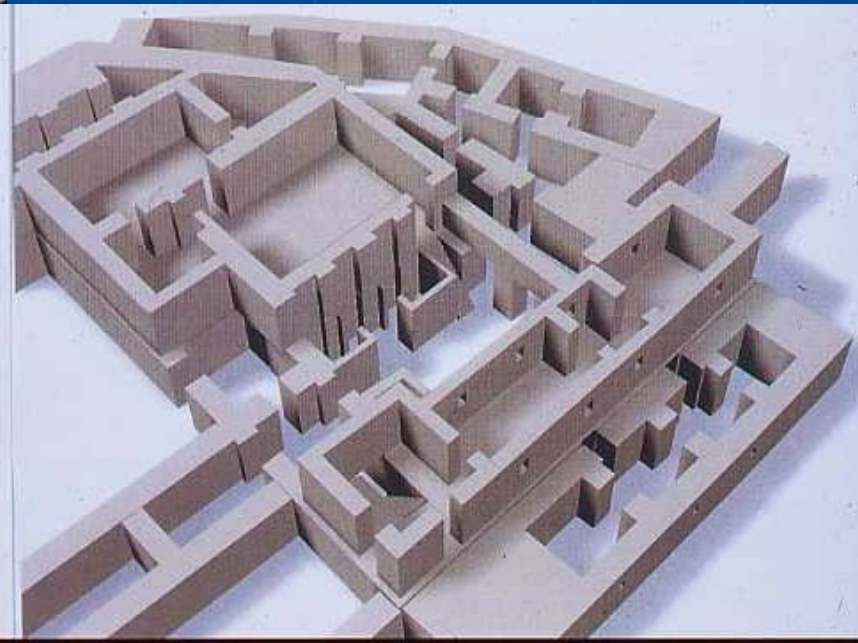
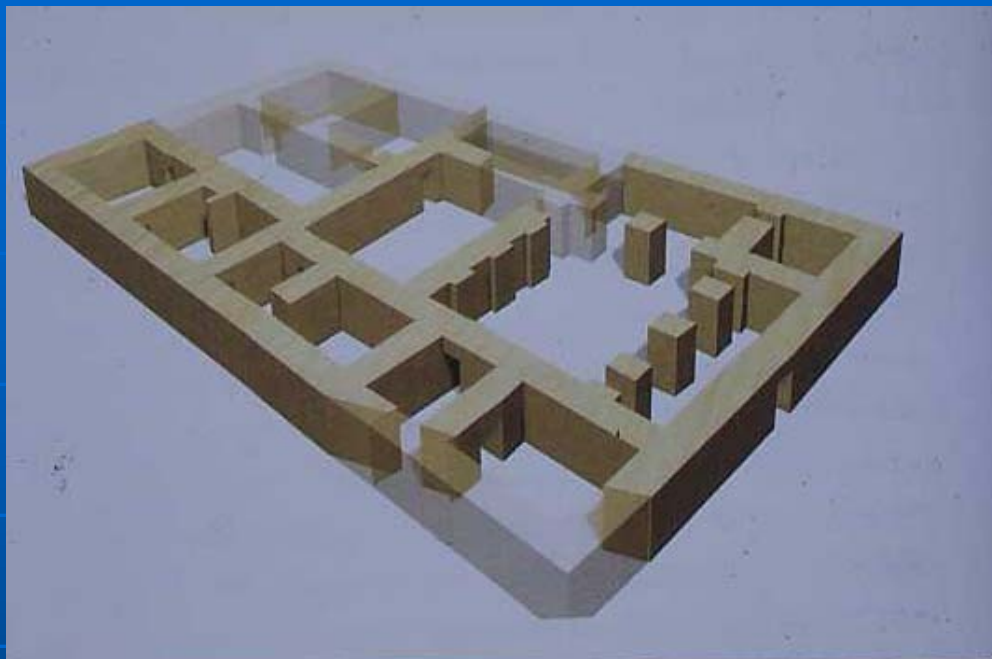

Tell Beidar –  
arched passage  
leading to the  
palace

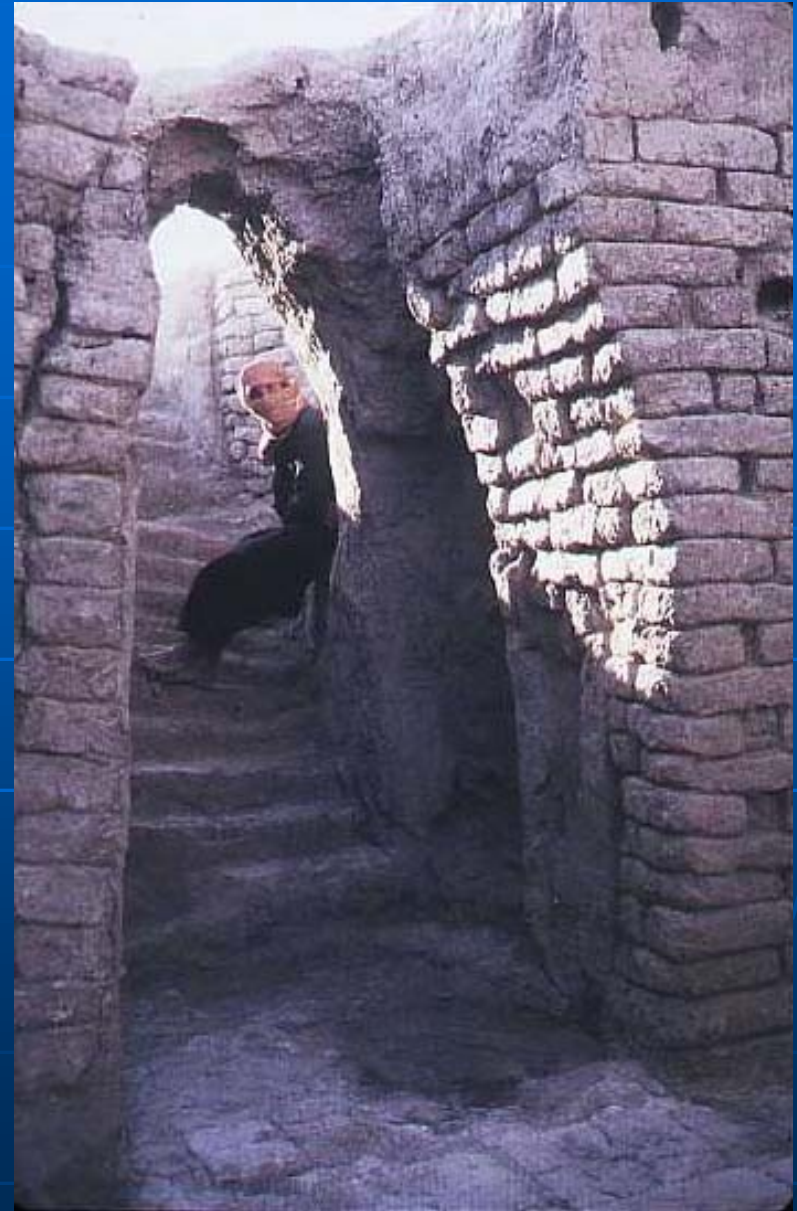

# A granary from Tell Beidar



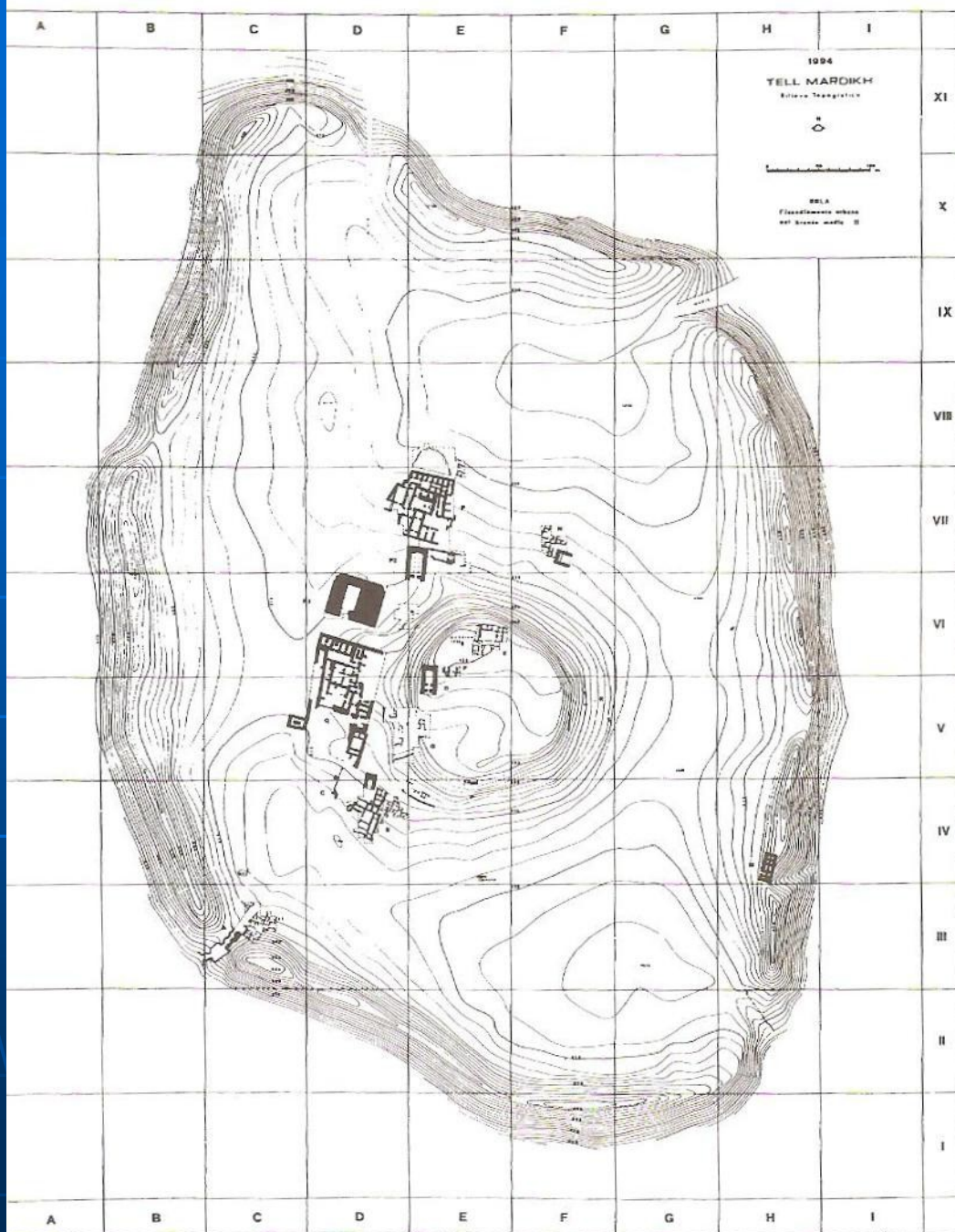
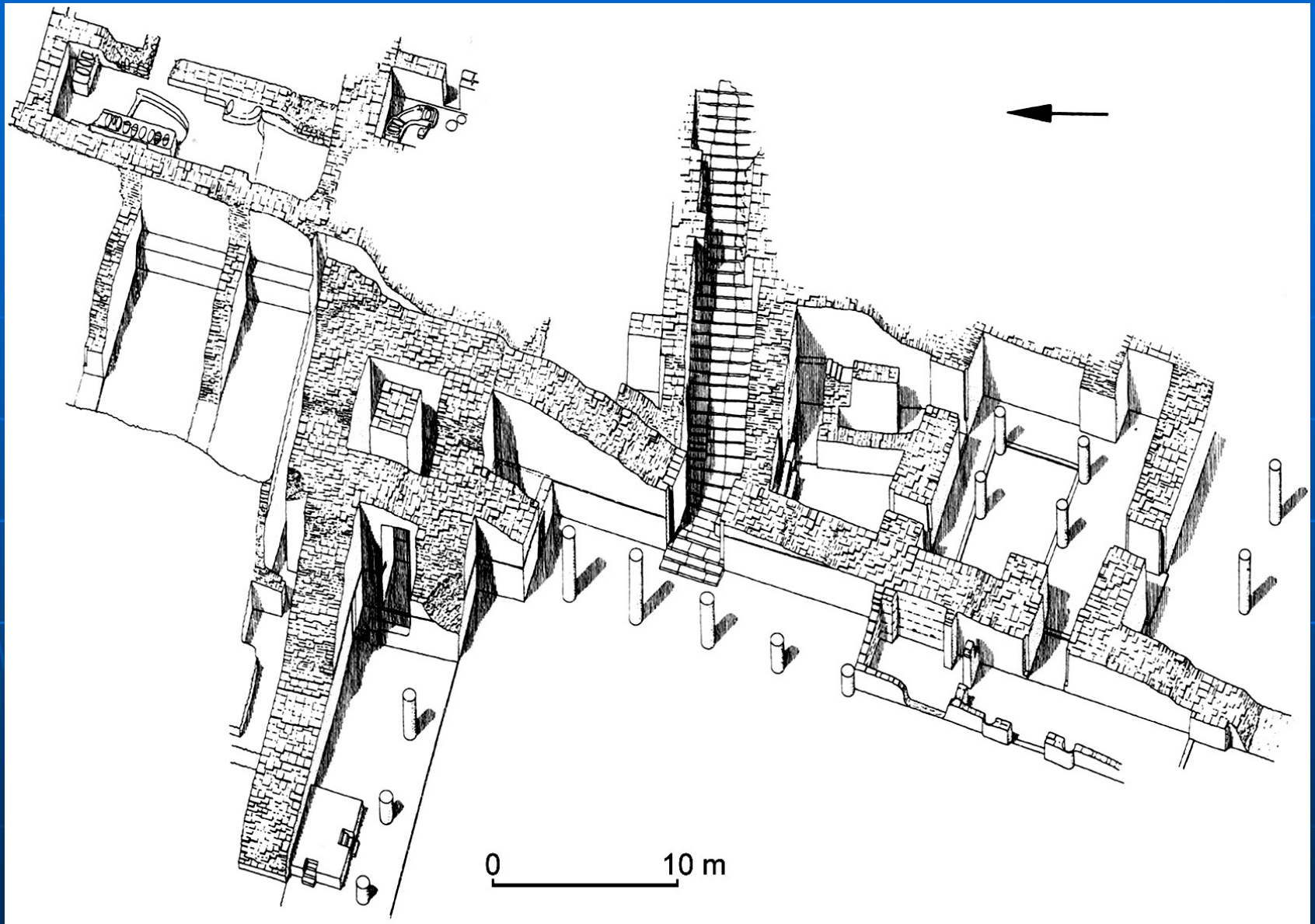

Fig. 9.5 Ebla; note thick enclosure wall around site and acropolis

# EBLA – PALACE G ca. 2350-2100 BC







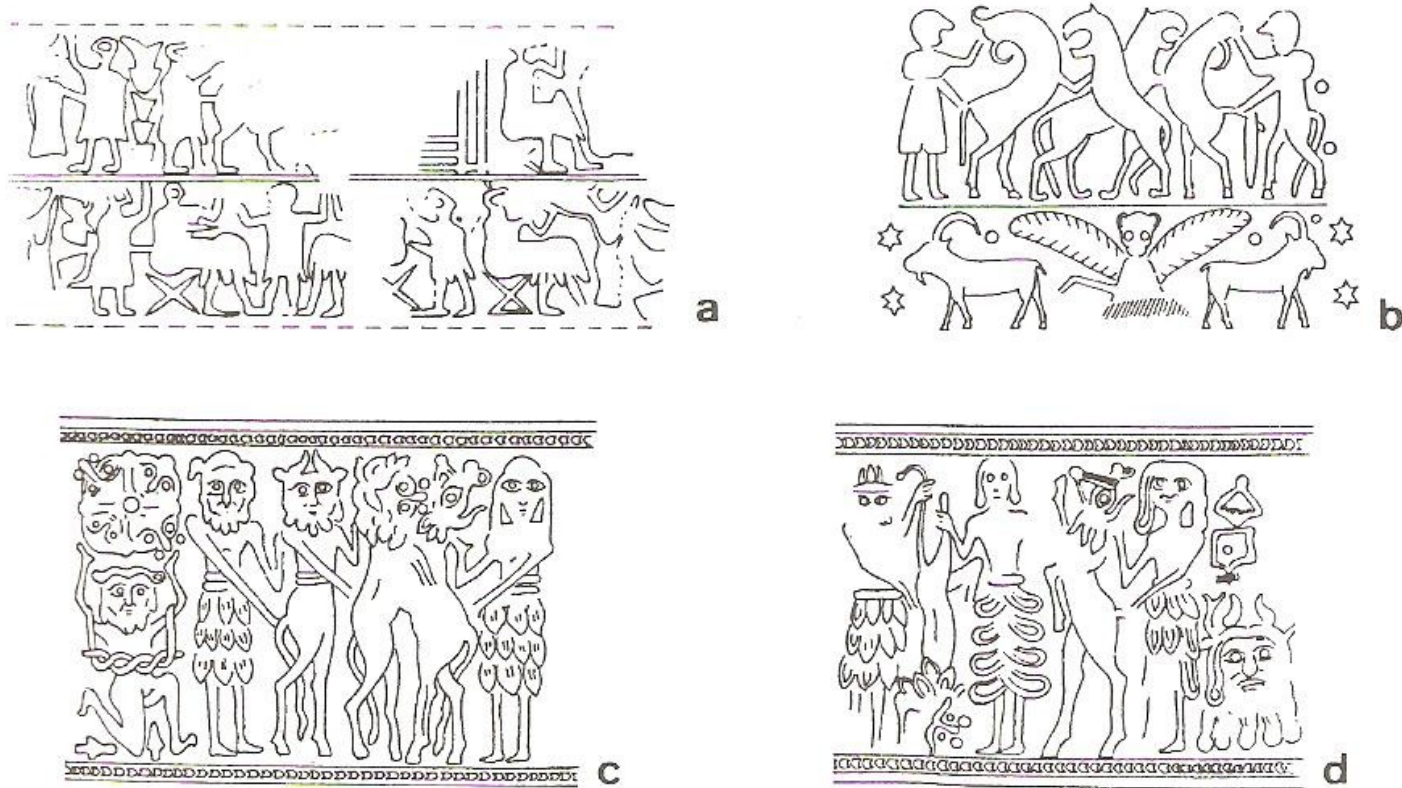

Fig. 8.7 Mid/late third-millennium BC cylinder seal art from Brak (a–b) and Ebla (c–d).

the practice. Noting that the relatively simple, linear sealings on the vessels

TELL BANAT – TOMB 7 (top)  
THE WHITE MONUMENT (bottom)  
ca. 2600-2450 BC

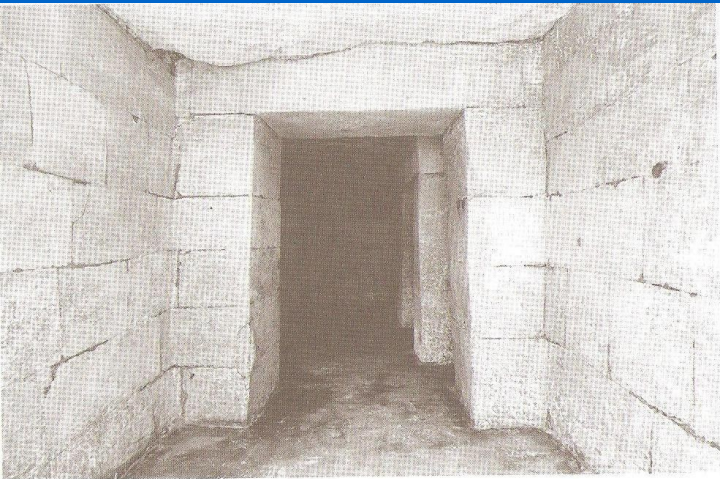
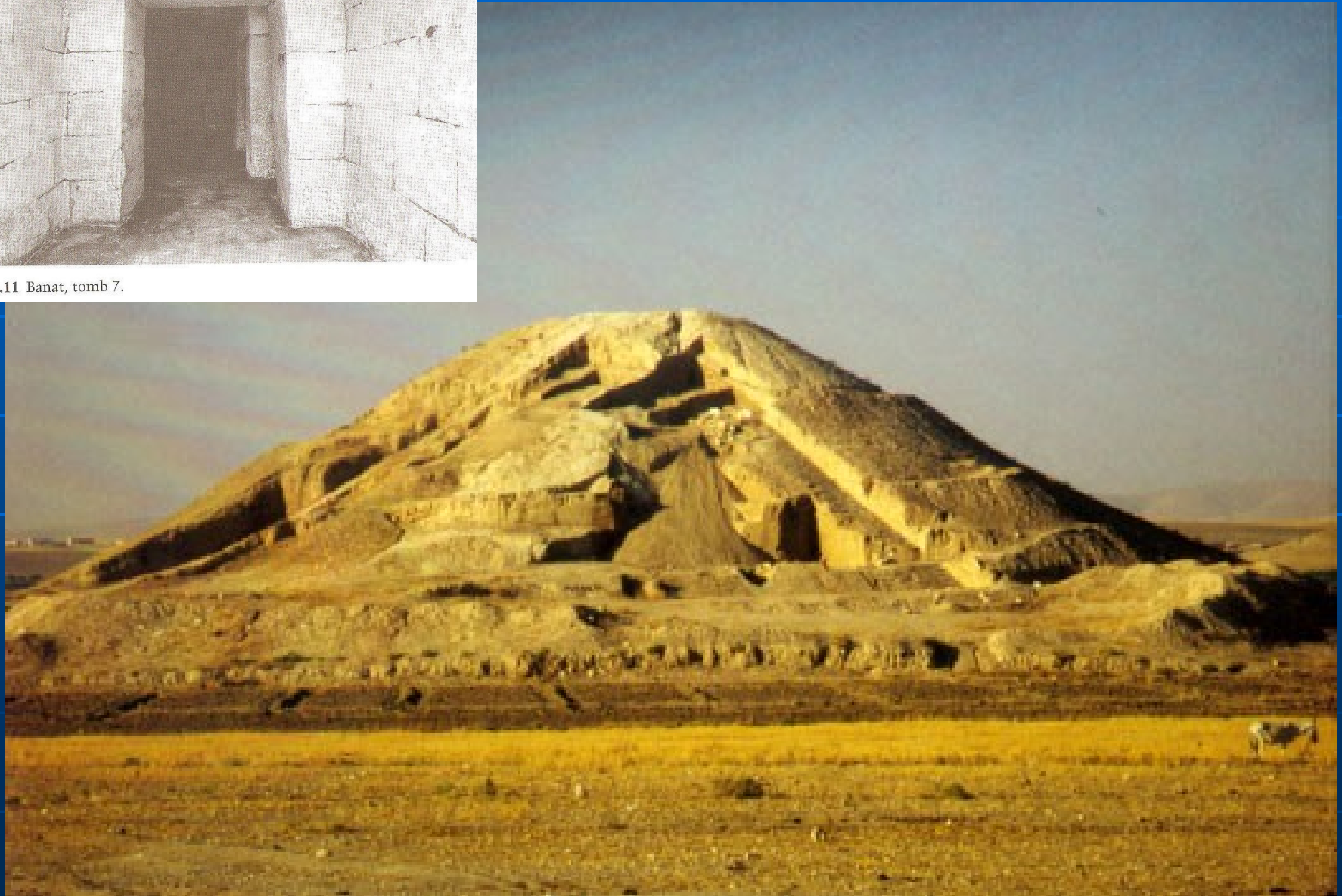
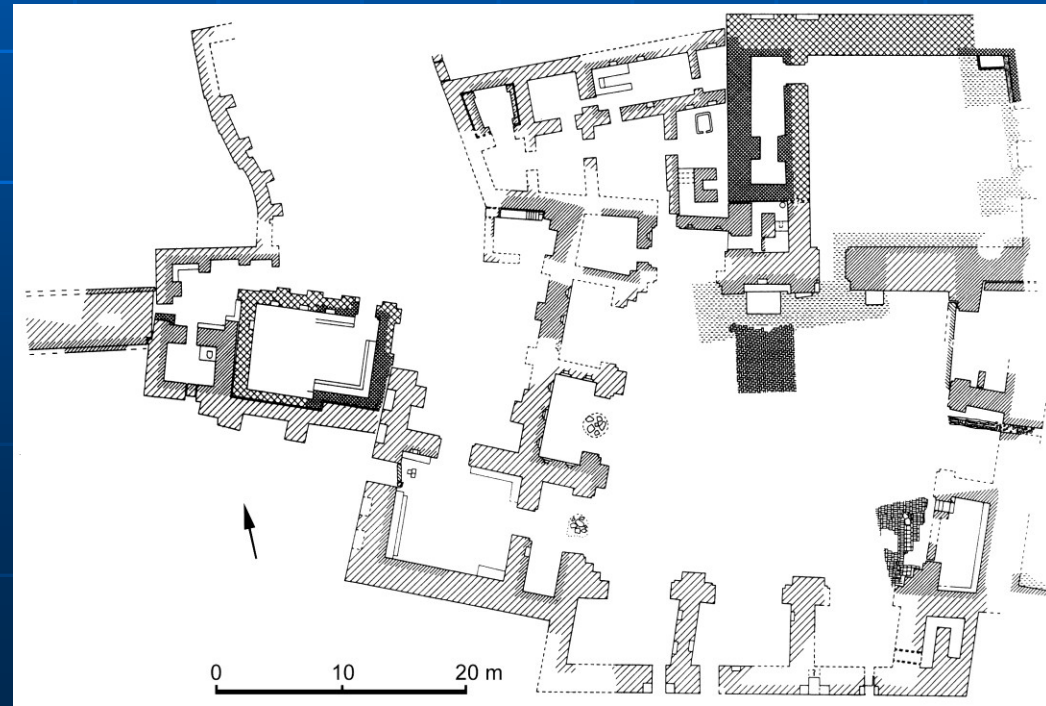
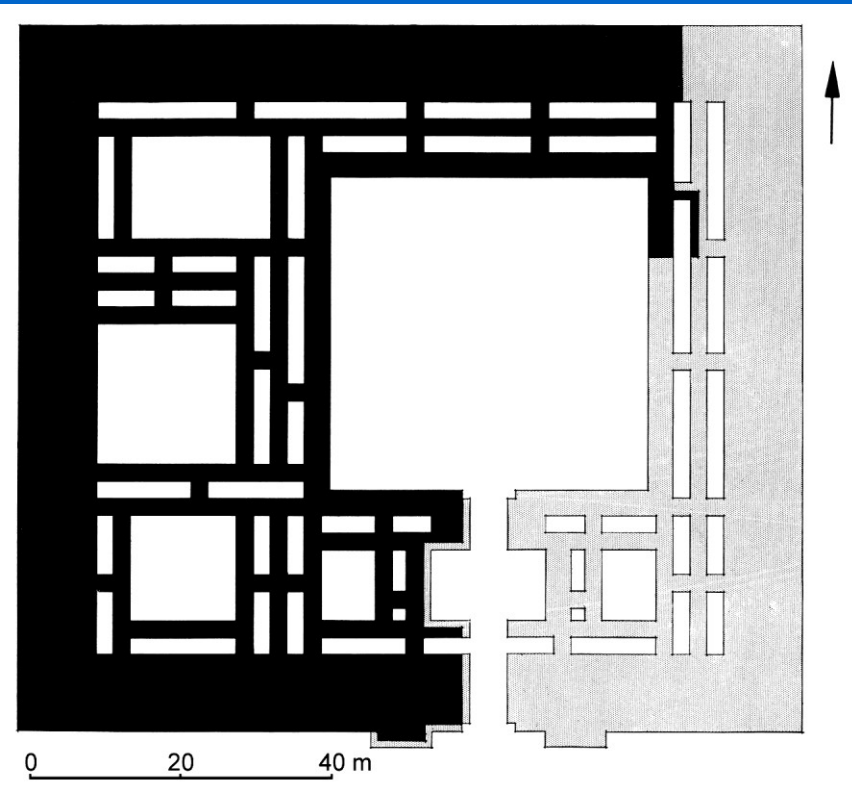

Fig. 8.11 Banat, tomb 7.



# TELL BRAK: NARAMSIN'S FORT AND BUILDINGS OF ADMINISTRATIVE SECTOR



# LATE III MILLENNIUM PALACE AT URKESH (Tell Mozan)

