

THE MIDDLE BRONZE AGE IN THE NEAR EAST

EBLA IN MBA

EBLA (Tell Mardikh)



Ebla - Syrie

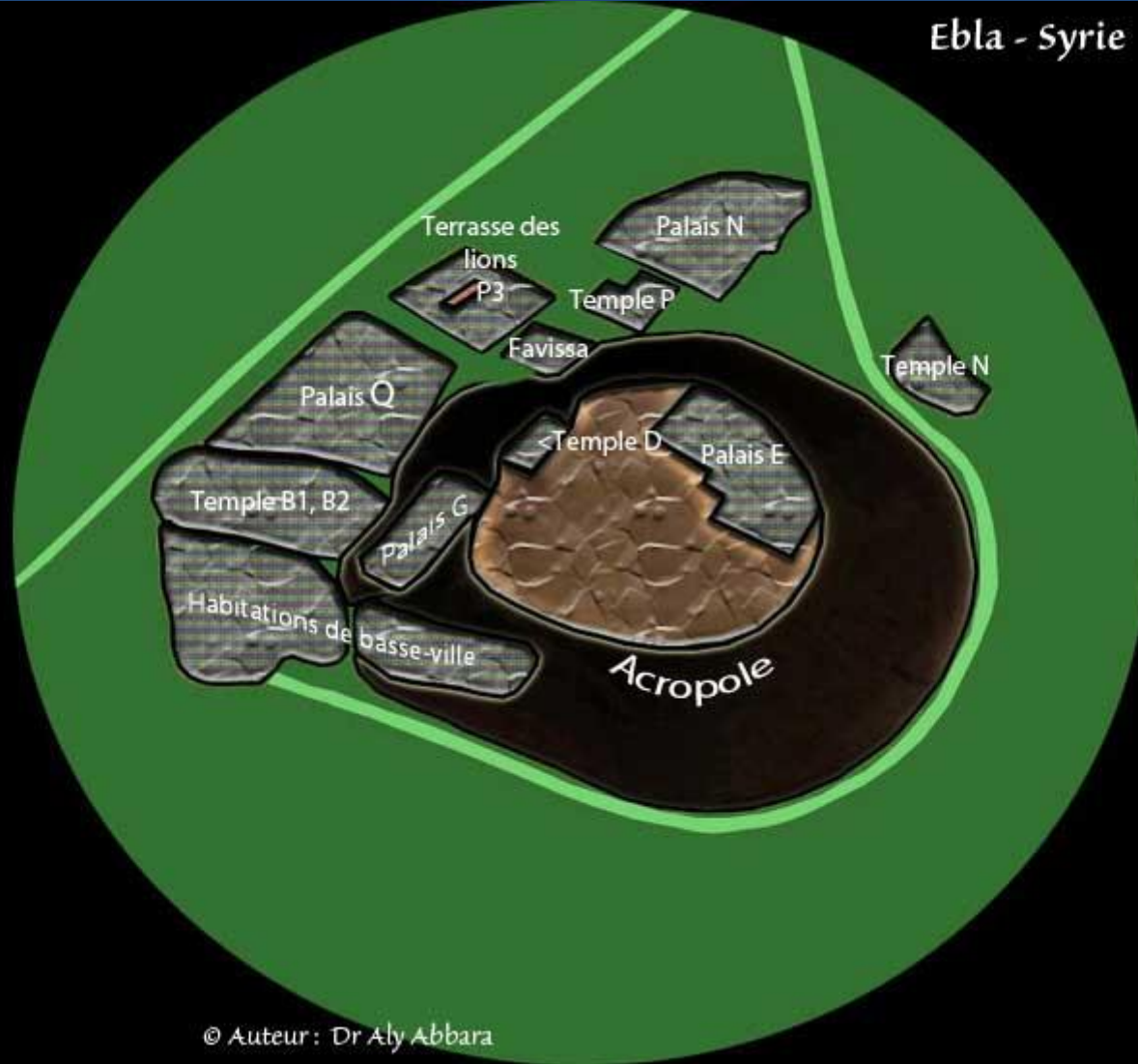

EBLA – MB I KING IBBIT-LIM STATUE



MB I AXE TYPE







THE ROYAL HYPOGEUM FOUND UNDER PALACE Q IN EBLA

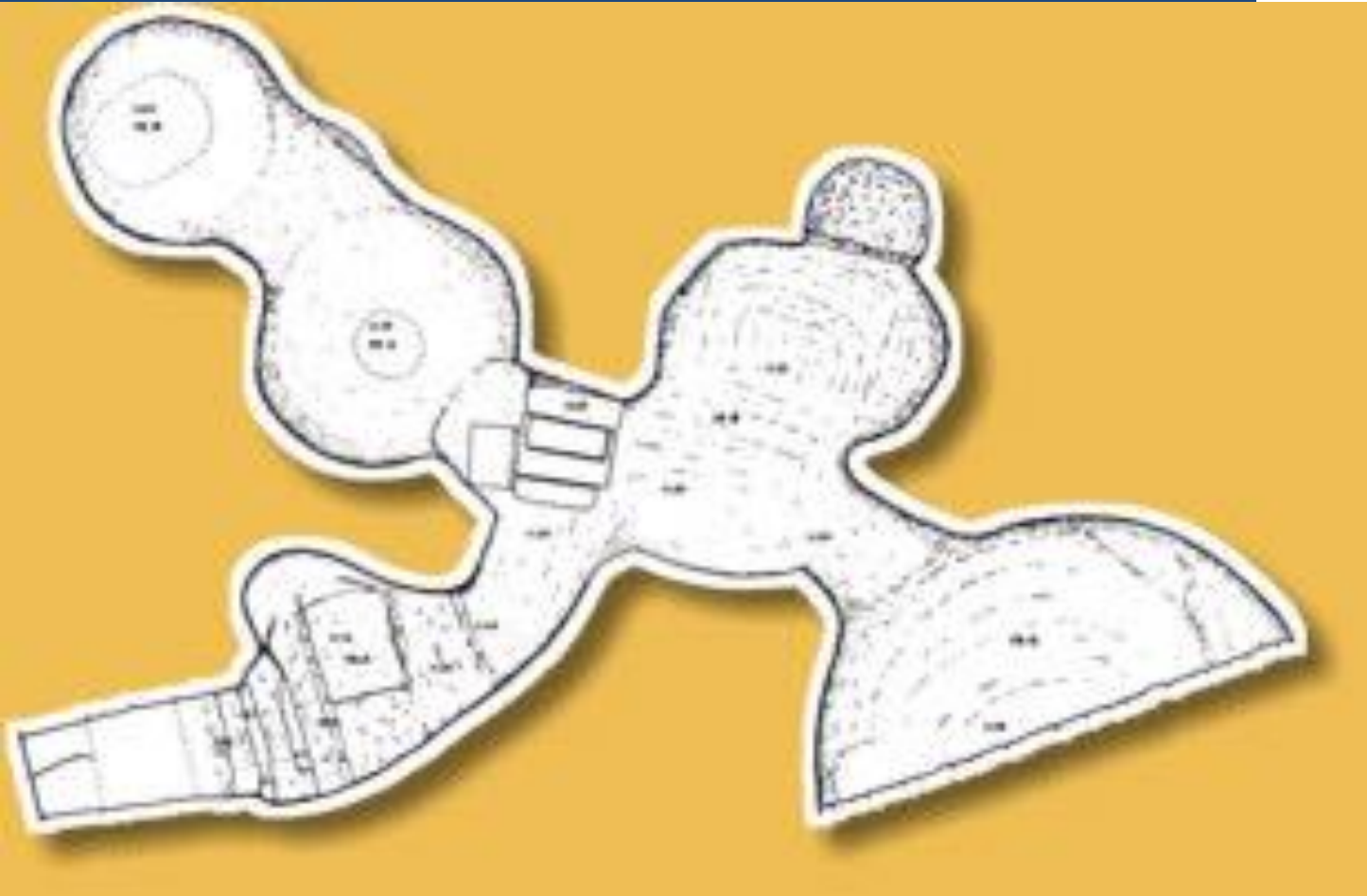
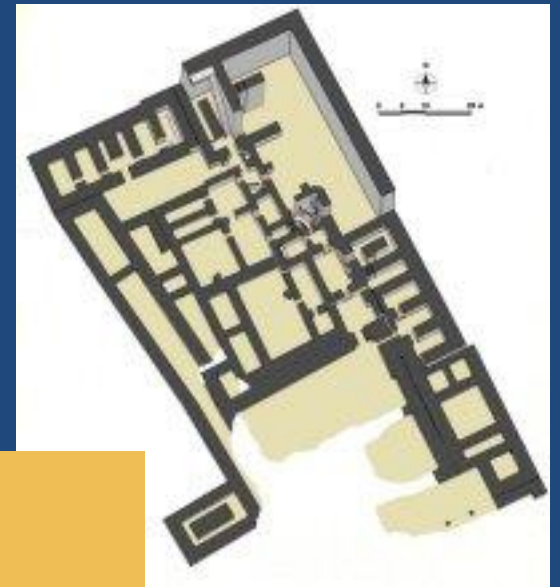

„LORD OF THE GOATS” TOMB



A MACE OF PHARAO HETEPHRE
OF XIII DYNASTY



Ebla
vers 1800-1750 av. J.-C.
Tombe de la princesse

Musée d'Idlib
Syrie



© aly-abbara.com

Ebla - vers 1800-1750 av. J.-C.

Tombe du seigneur aux Capridés

Objet funéraire - Colombe dédiée à Ishtar

Musée d'Idlib - Syrie



© aly-abbara.com

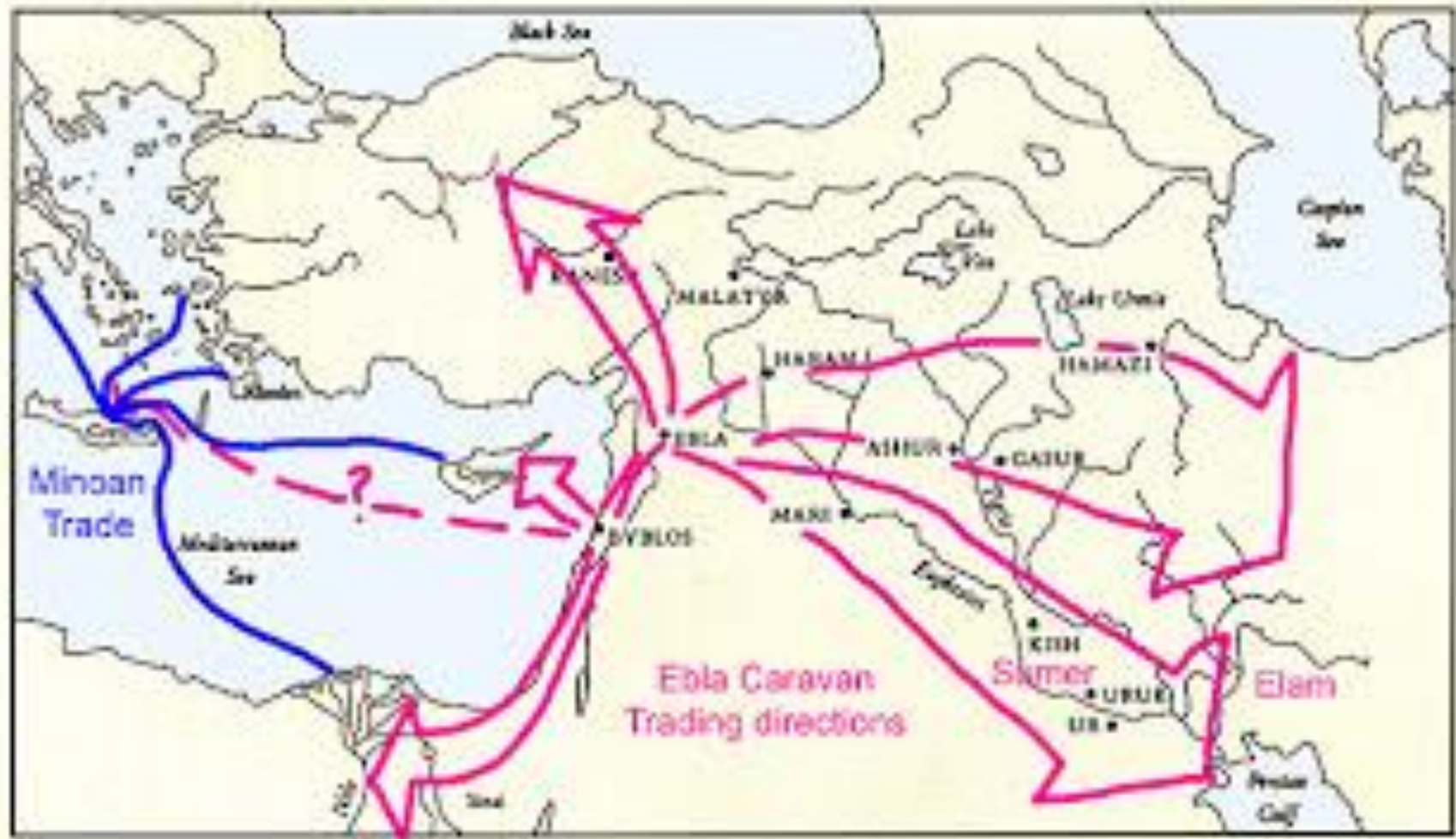

MB II EBLA – TEMPLE D (ACROPOLIS)

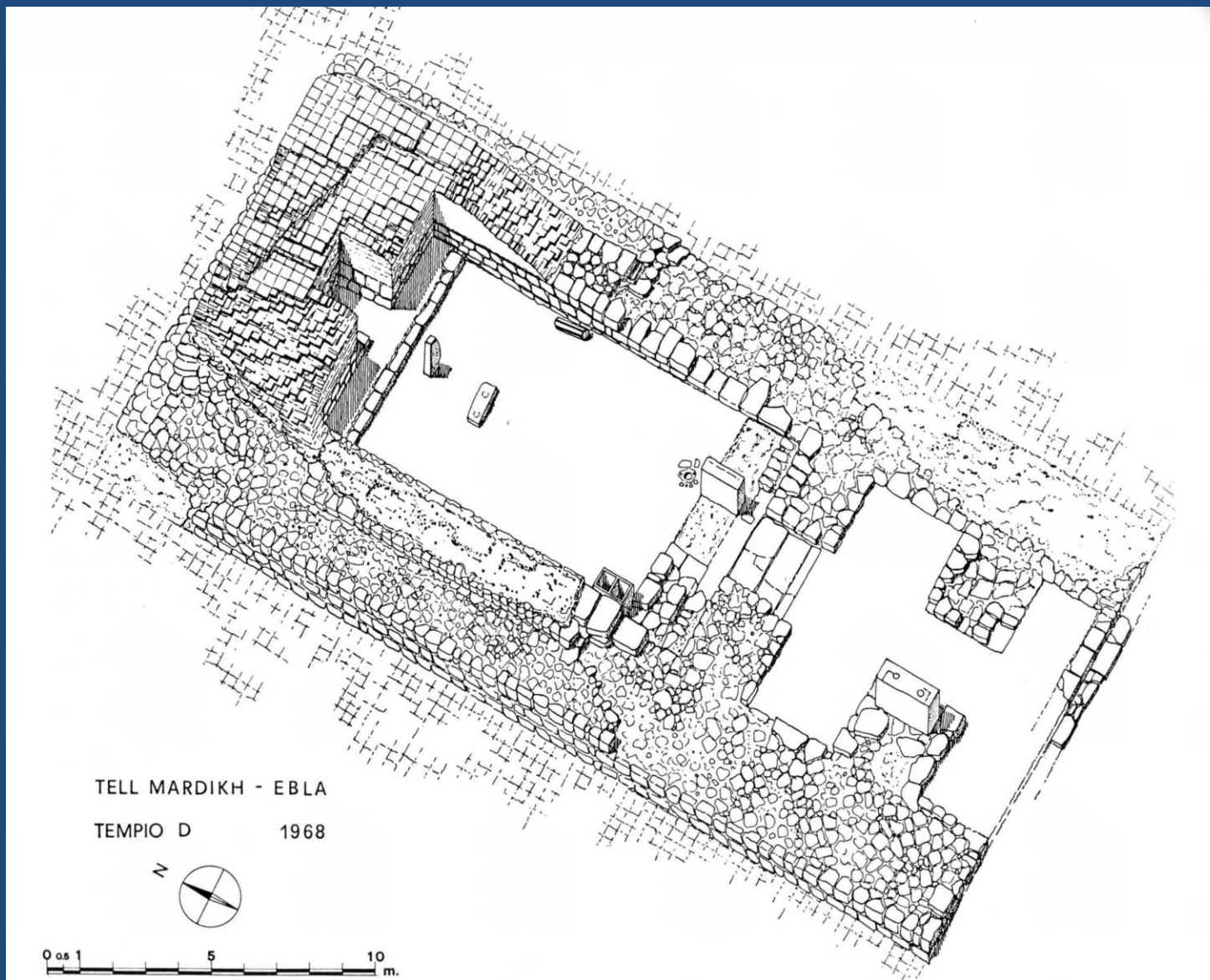

TELL MARDIKH - EBLA

TEMPIO D 1968

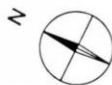

0 0.5 1 5 10 m.

arch. CARLO CATALDI TASSONI



aly-abbara.com

MB II EBLA – ISHTAR'S STELE FROM VICINITY OF TEMPLE D

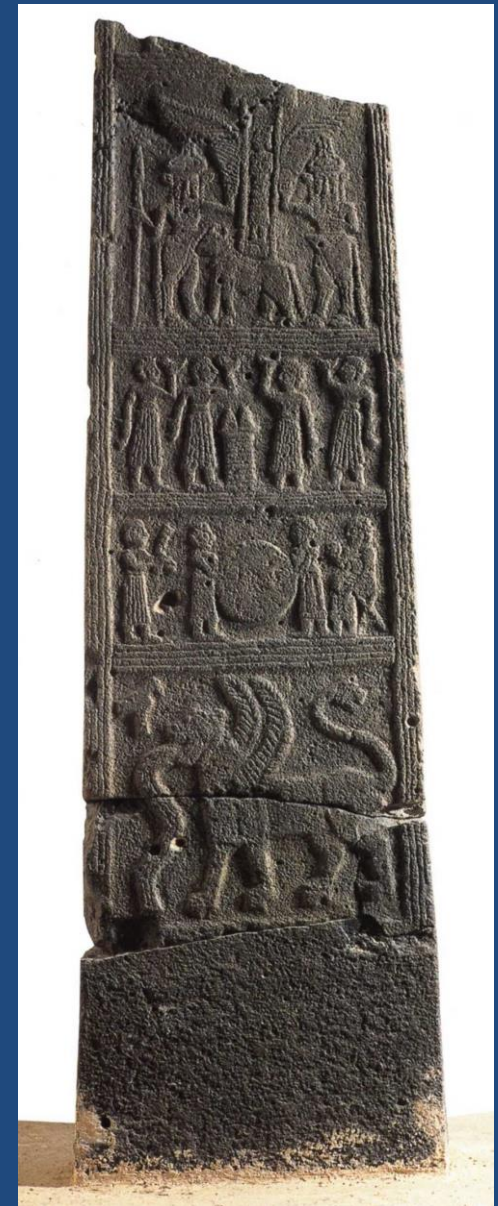
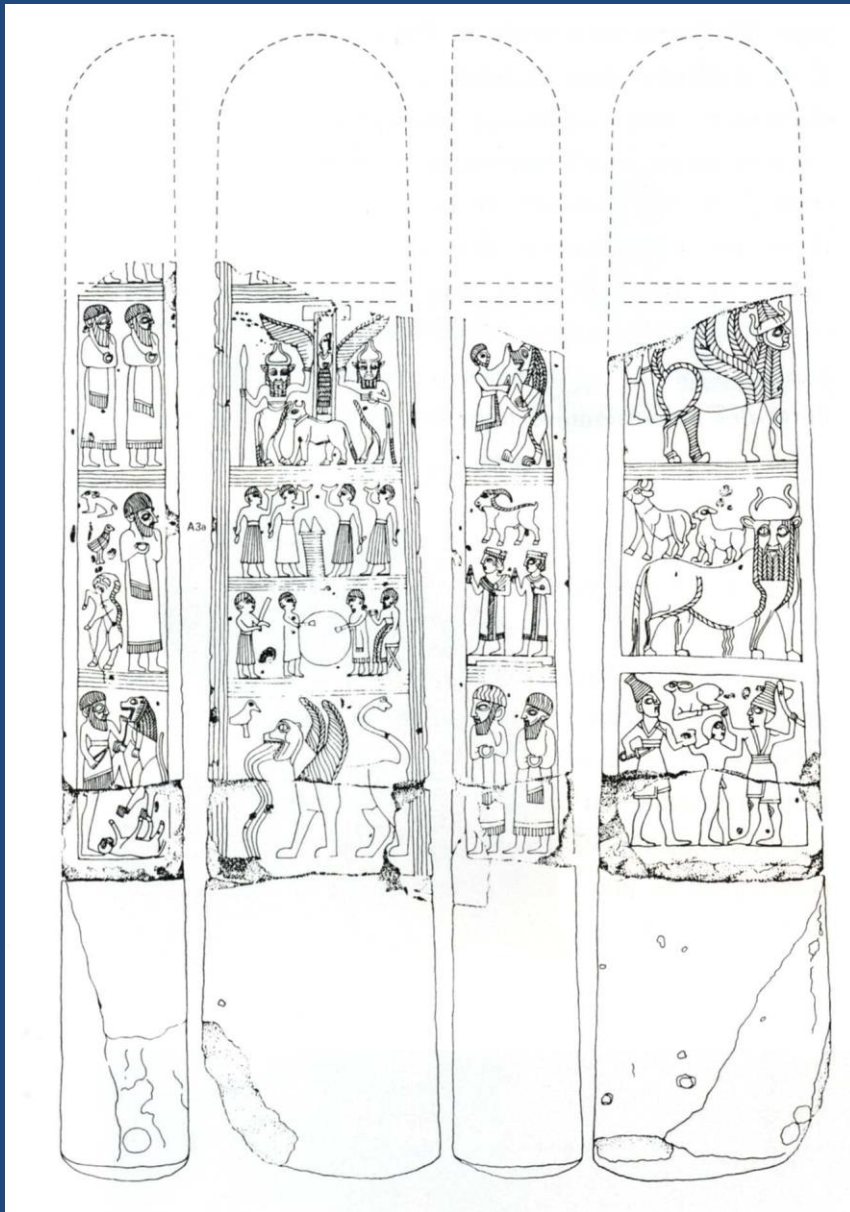

ROYAL STATUES FOUND IN TEMPLES D and P2



TEMPLE P2 „ISHTAR’S TEMPLE (lower town)

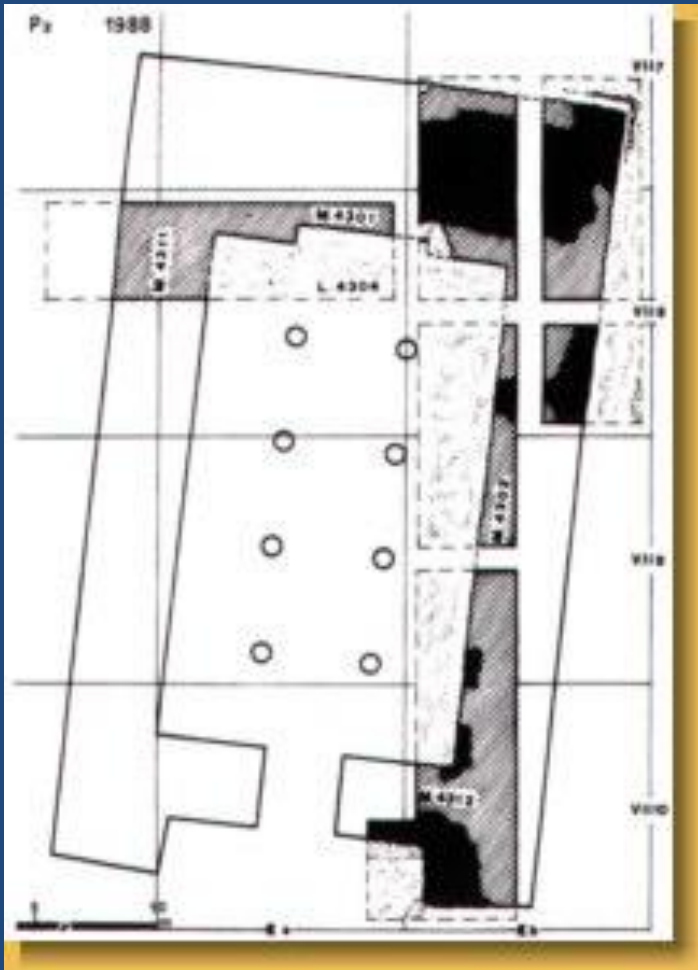

CULTIC BASIN FROM A TEMPLE



MONUMENT P3





gettyimages
DEA PICTURE LIBRARY

122316046

Ebla

vers 1800-1750 av. J.-C.

figures décoratives
sur céramique faisant
référence au culte

d'Ishtar

Musée d'Idlib

Syrie

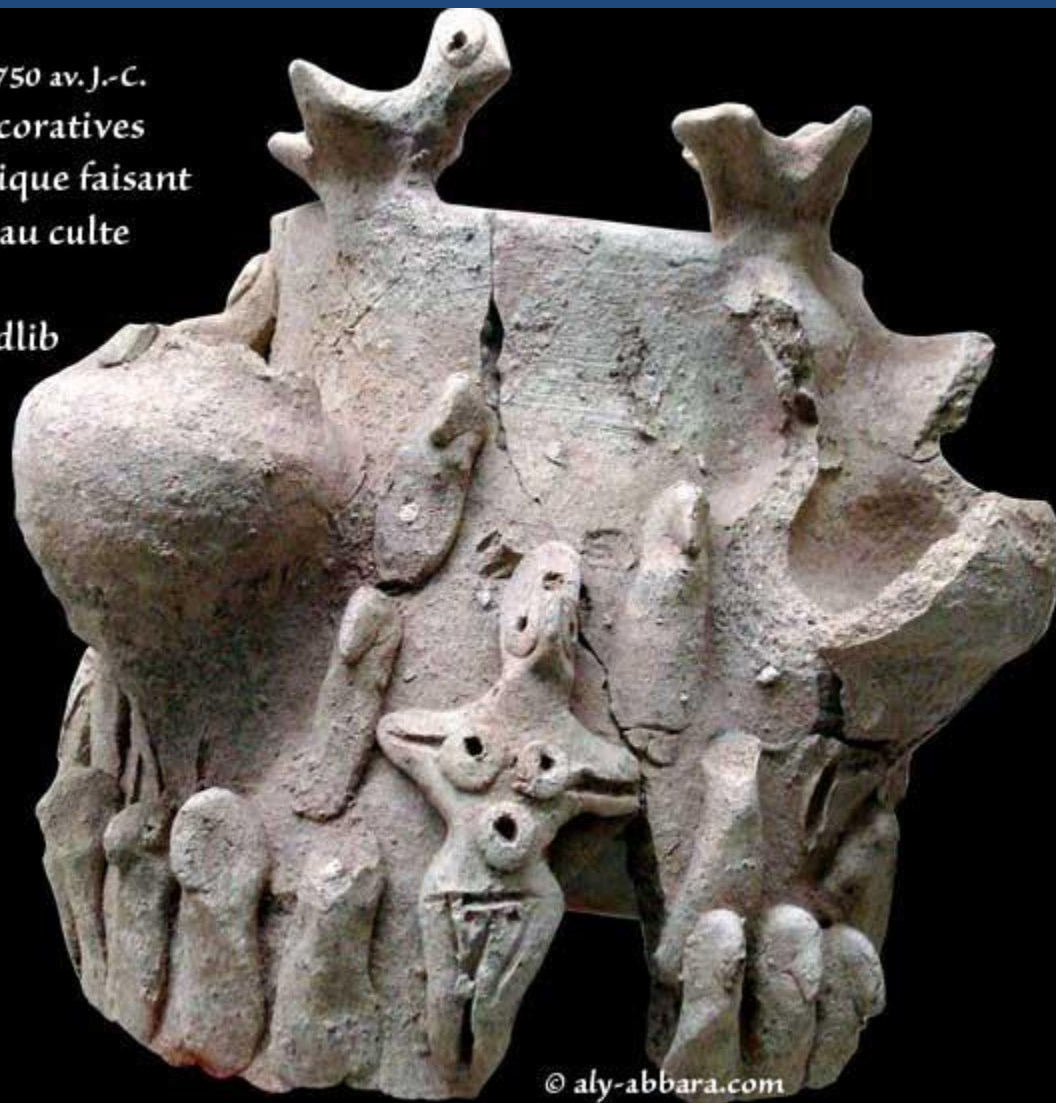

© aly-abbara.com

SANCTUARY B2 – TEMPLE OF THE ROYAL ANCESTORS

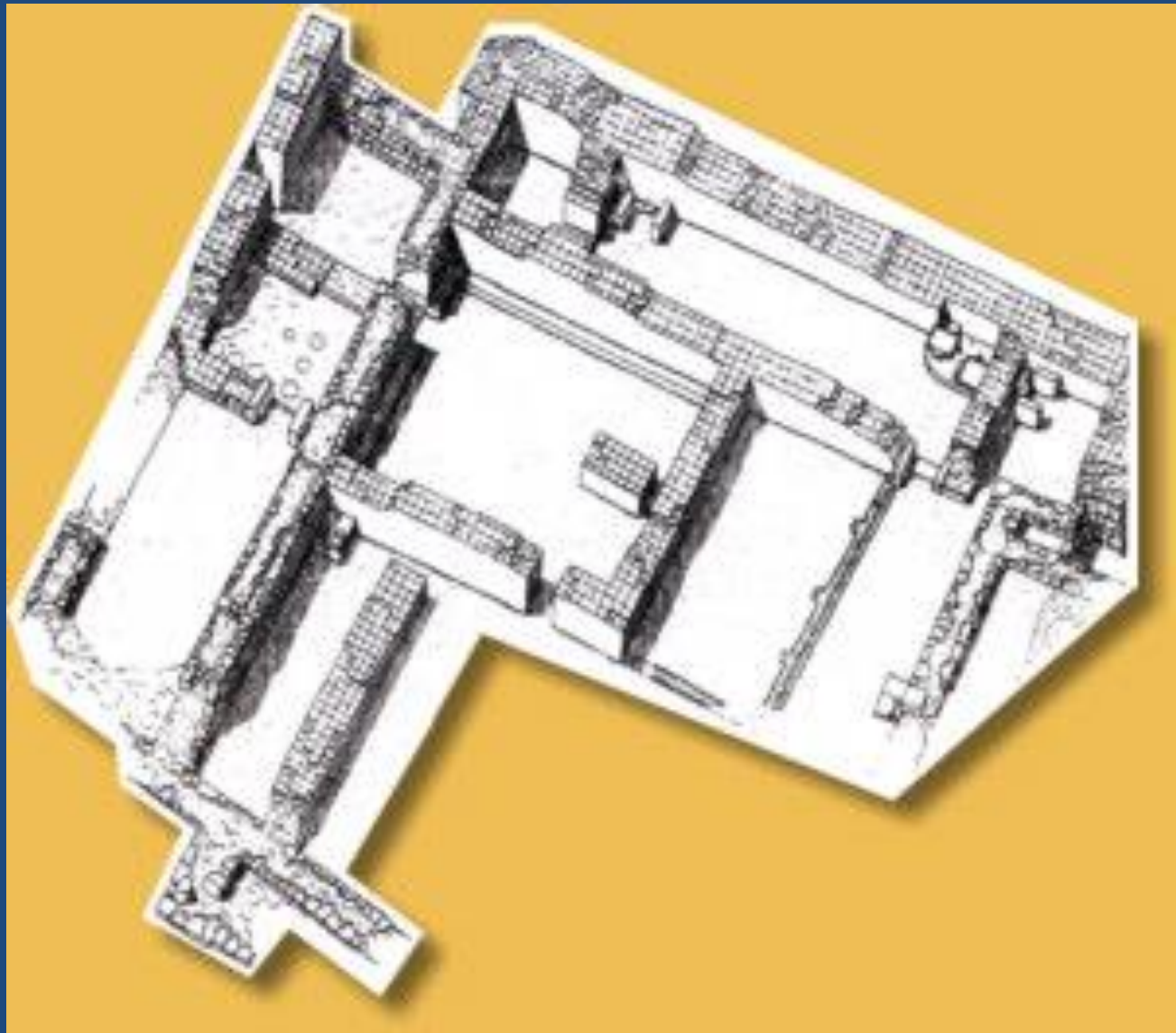

TEMPLE N: „SHAMASH” TEMPLE



CULTIC BASIN FOUND IN THE TEMPLE





DAMASCUS GATE

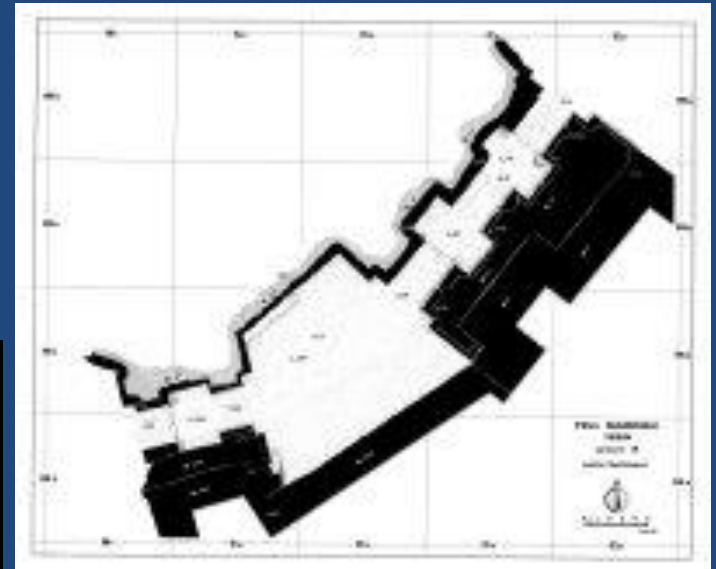

GATES

