

EARLY BRONZE AGE I

Levant

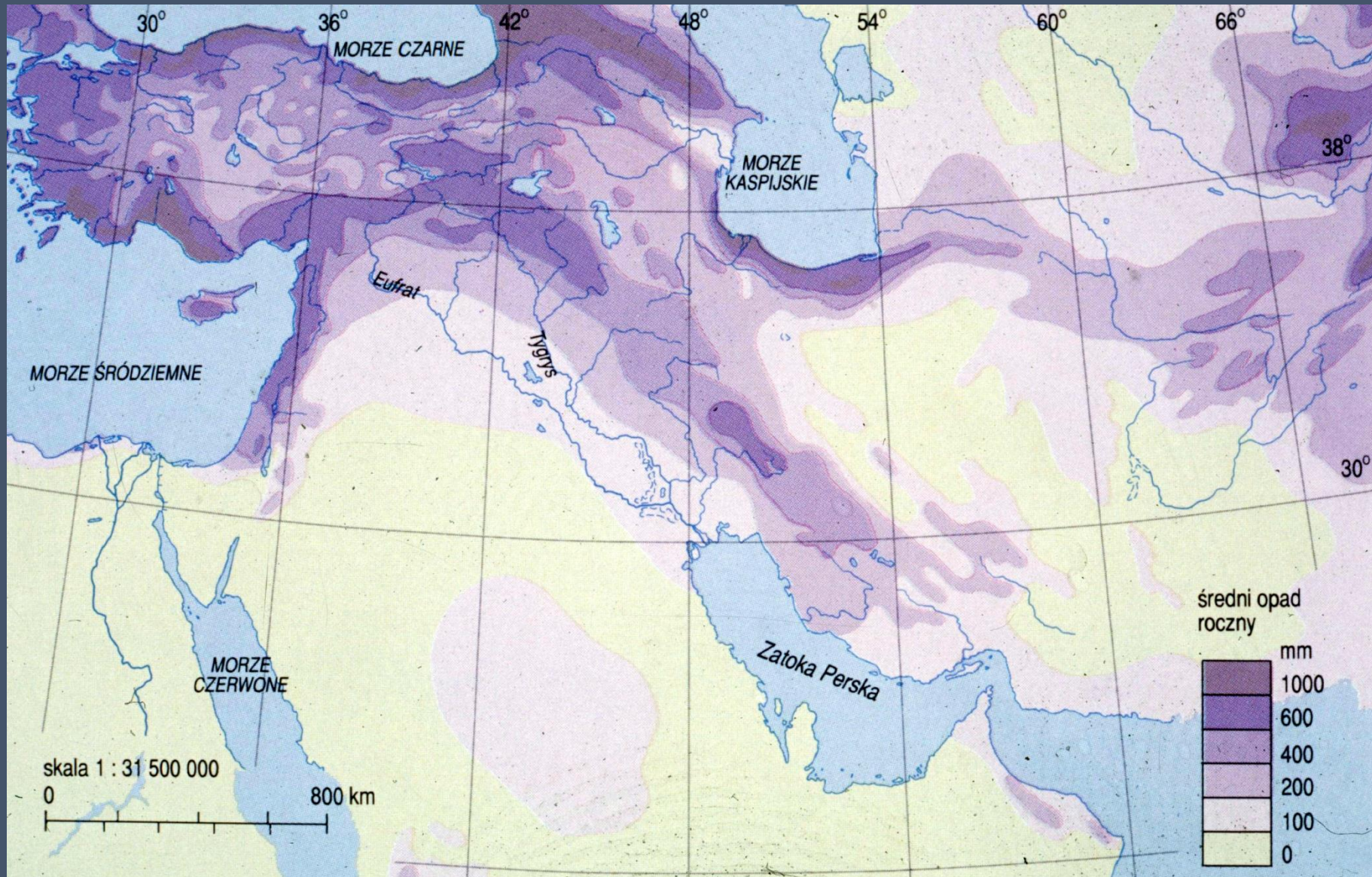



Istanbul

Ankara

TURKEY

BLACK SEA

Mt. Ararat

CASPIAN SEA

Aras

Carthachemish Haran

Nineveh

Assyria

CYPRUS

Ugarit

Ebla

Euphrates

Asshur

Tigris

Ecbatana

MEDITERRANEAN SEA

LEBANON

SYRIA

IRAQ

Media

Iran

Persia

Damascus

Hazor

Baghdad

Babylon

Babylonia

Susa

Alexandria

Amman

Jerusalem

Nippur

Beersheba

JORDAN

Ur

Cairo

Memphis

Sinai

Ezion-geber

Mt Sinai

Tell el-Amarna
Akhetaten

Nile

Red Sea

Saudi Arabia

The Persian Gulf

EGYPT

Thebes

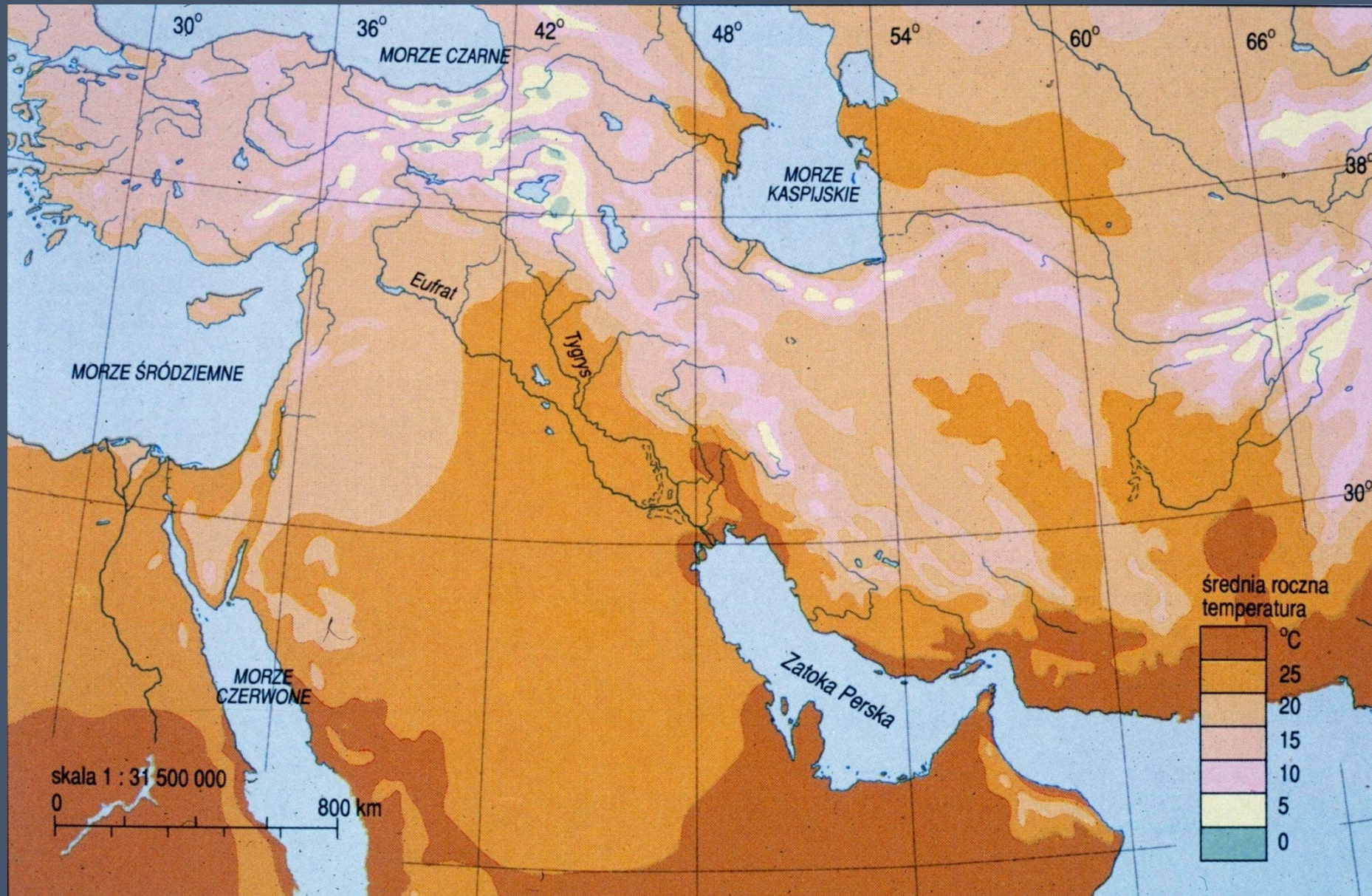

CEDAR TREES OF LEBANON



GOLAN HEIGHTS





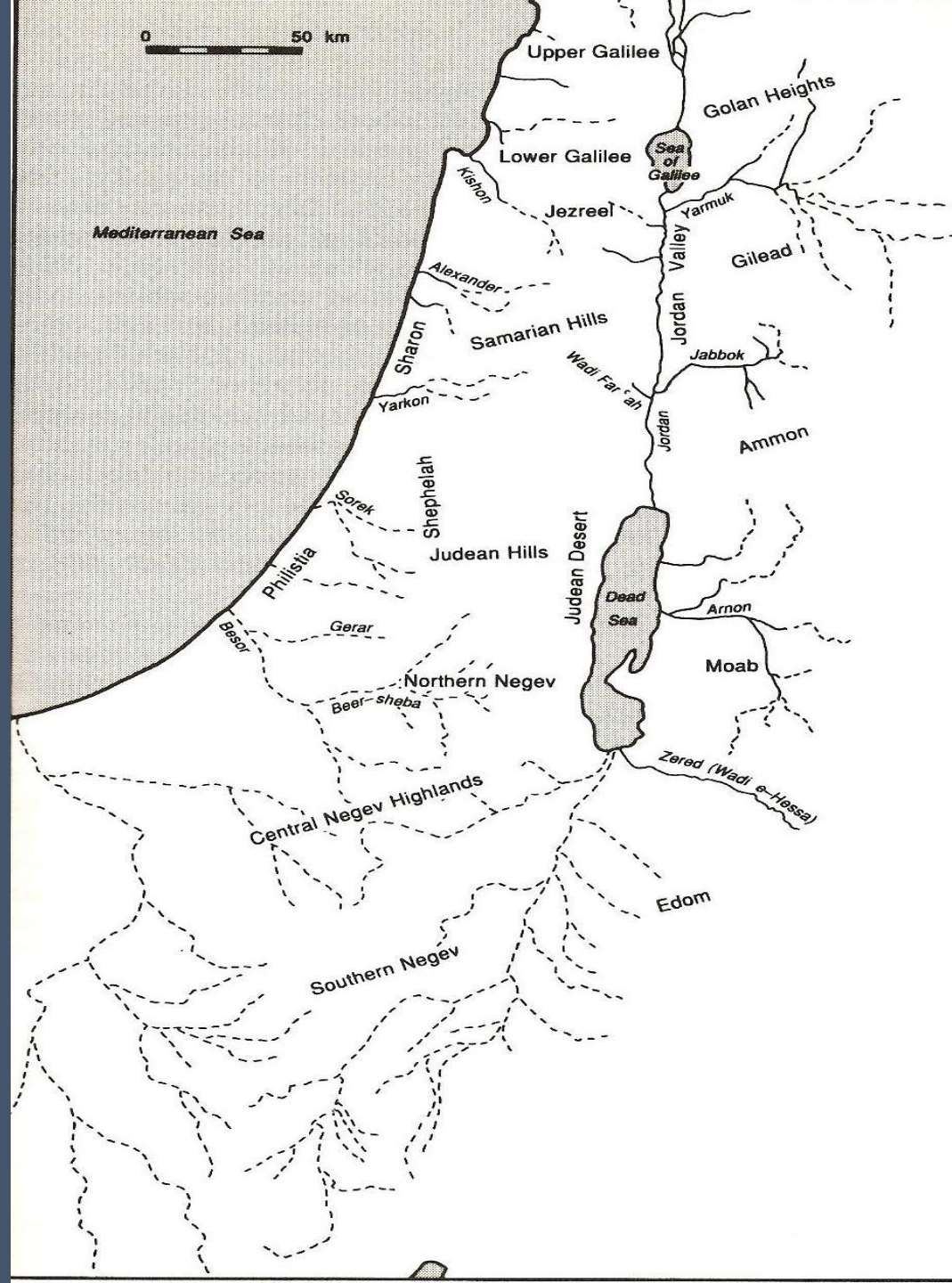

RIVER VALLEYS AND MOUNTAIN RANGES



SINAI



CHRONOLOGY OF EARLY BRONZE AGE IN SOUTHERN LEVANT

Early Bronze I: 3700 – 3100 BC (pre-urban)

Early Bronze II – III: 3100 – 2500 BC

Early Bronze IV = INTERMEDIATE PERIOD

NORTHERN LEVANT

EB I + EB II: 3100 – 2600 (pre-urban)

EB III: 2600 – 2450

EB IV: 2450 - 2000



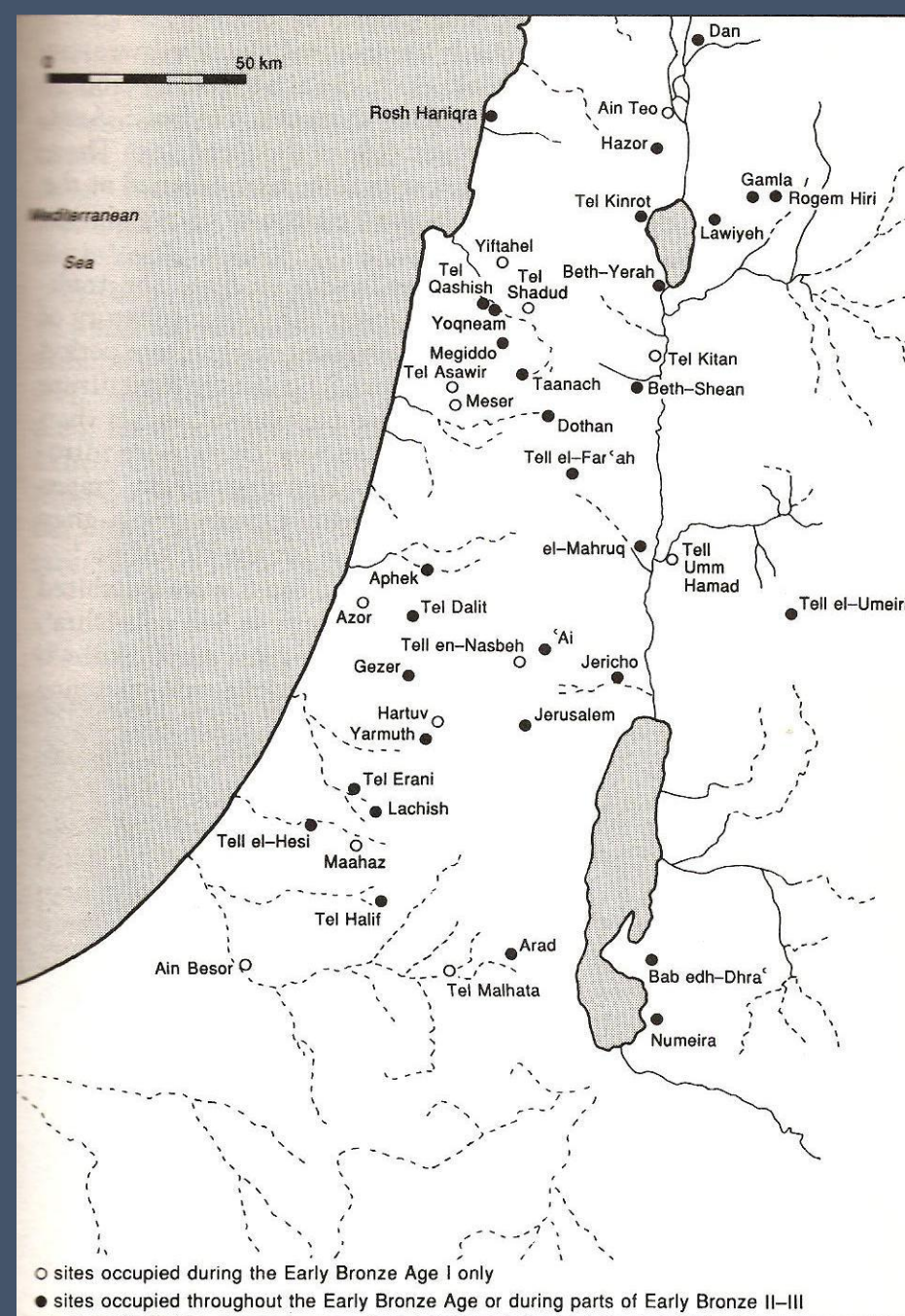

4.1 MAP OF EXCAVATED EARLY BRONZE AGE SITES



Arad
EBA I

Tell Arad
Early Bronze (EB) City (3000-2650 BC)
and Israelite Fortress (950-586 BC)
Adapted from a photograph by Bible Place



EARLY BRONZE I DWELLINGS: MEGIDDO, YFTAHEL

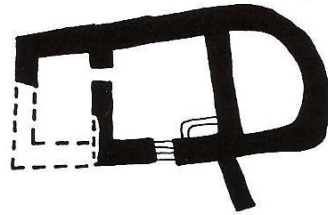

1. Dwelling, Megiddo Stage IV. R. Engberg and G.M. Shipton: *Notes on the Chalcolithic and Early Bronze Age Pottery of Megiddo*, Chicago, 1934, Fig. 2.

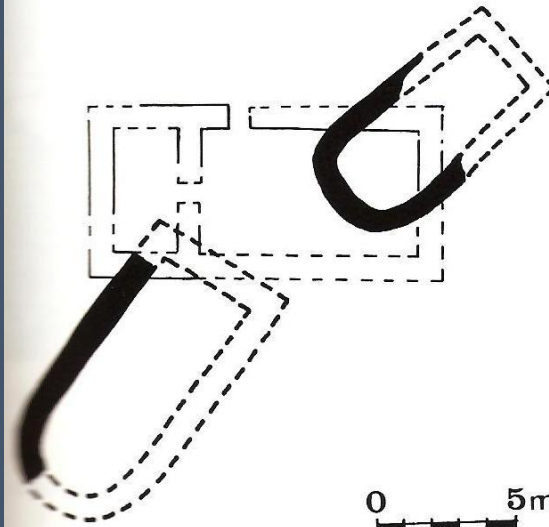

2. Dwelling, Meser. *IEJ* 9 (1959), p. 15, Fig. 2.

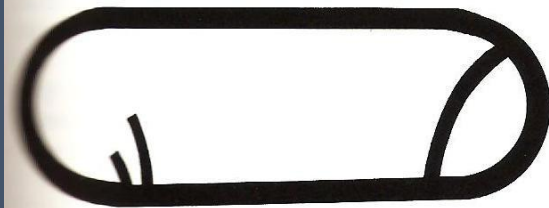

3. Dwelling Yiftah'el.

MEGIDDO TEMPLE EB I

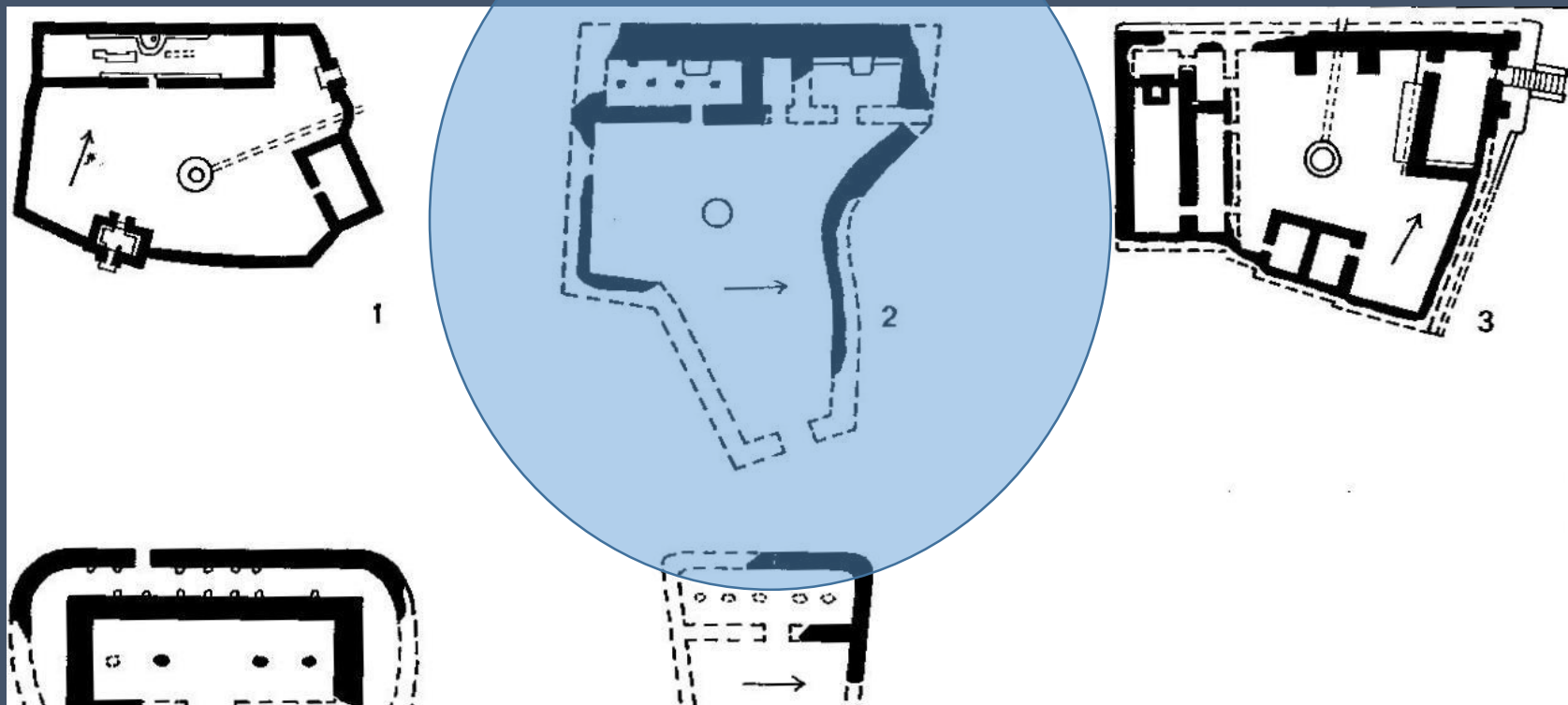

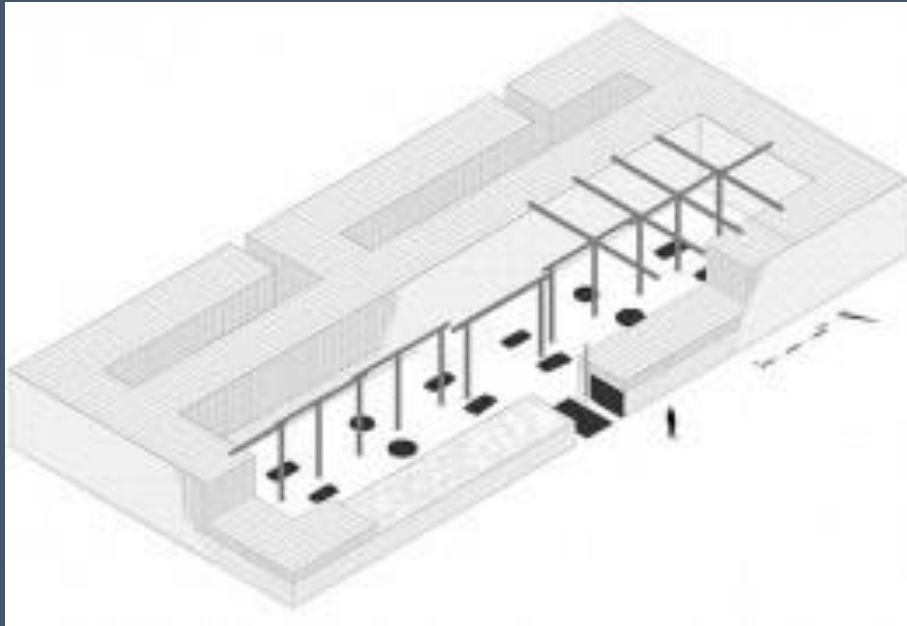

EB I Megiddo temple



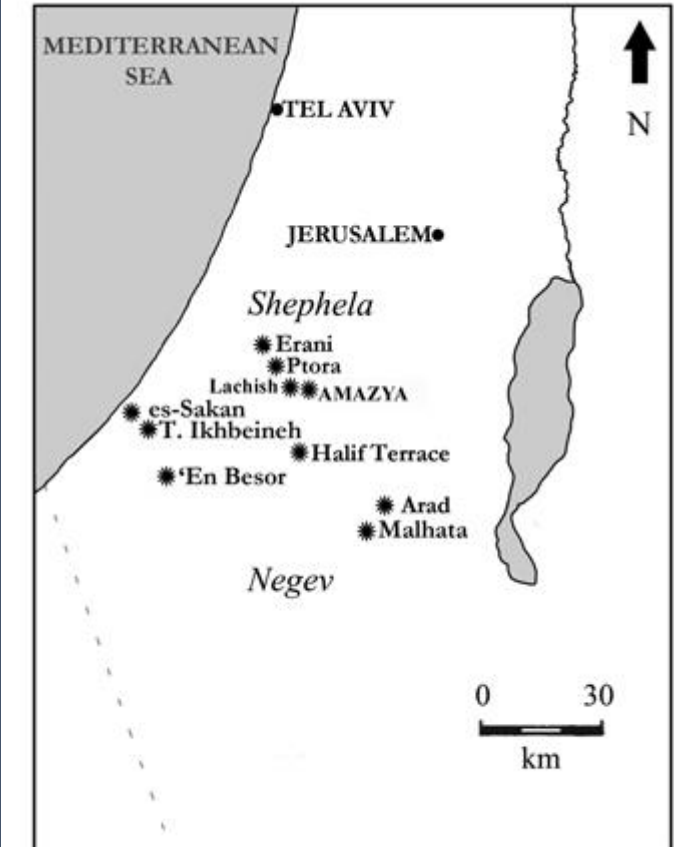

EBA I silos in Amaziya

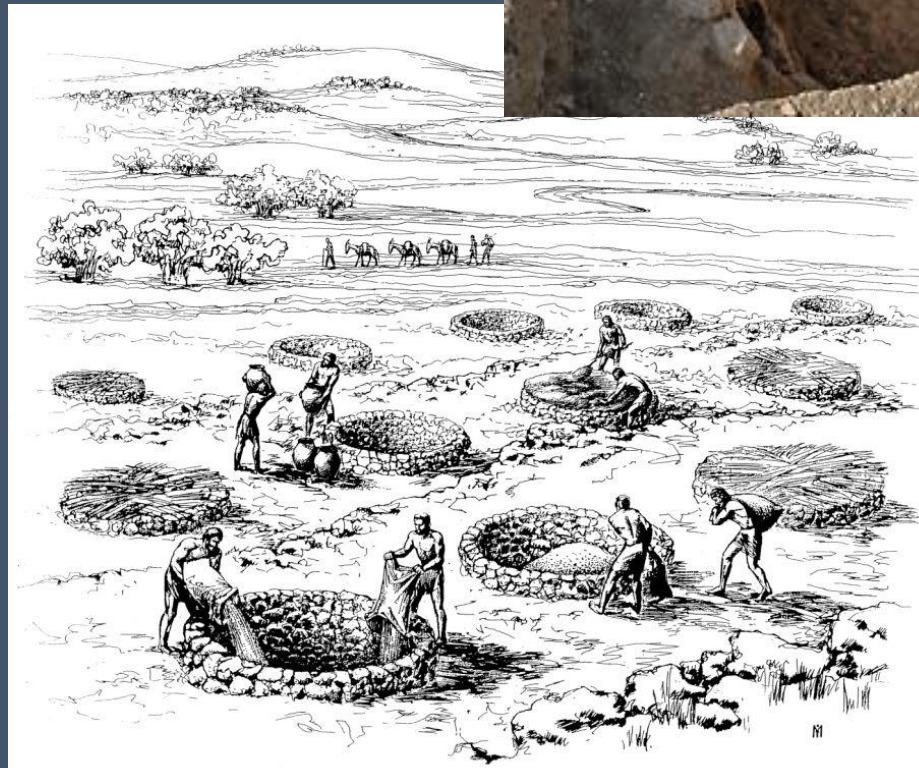

BAB EDH-DRA' – PLAN OF CEMETERY AND SETTLEMENT

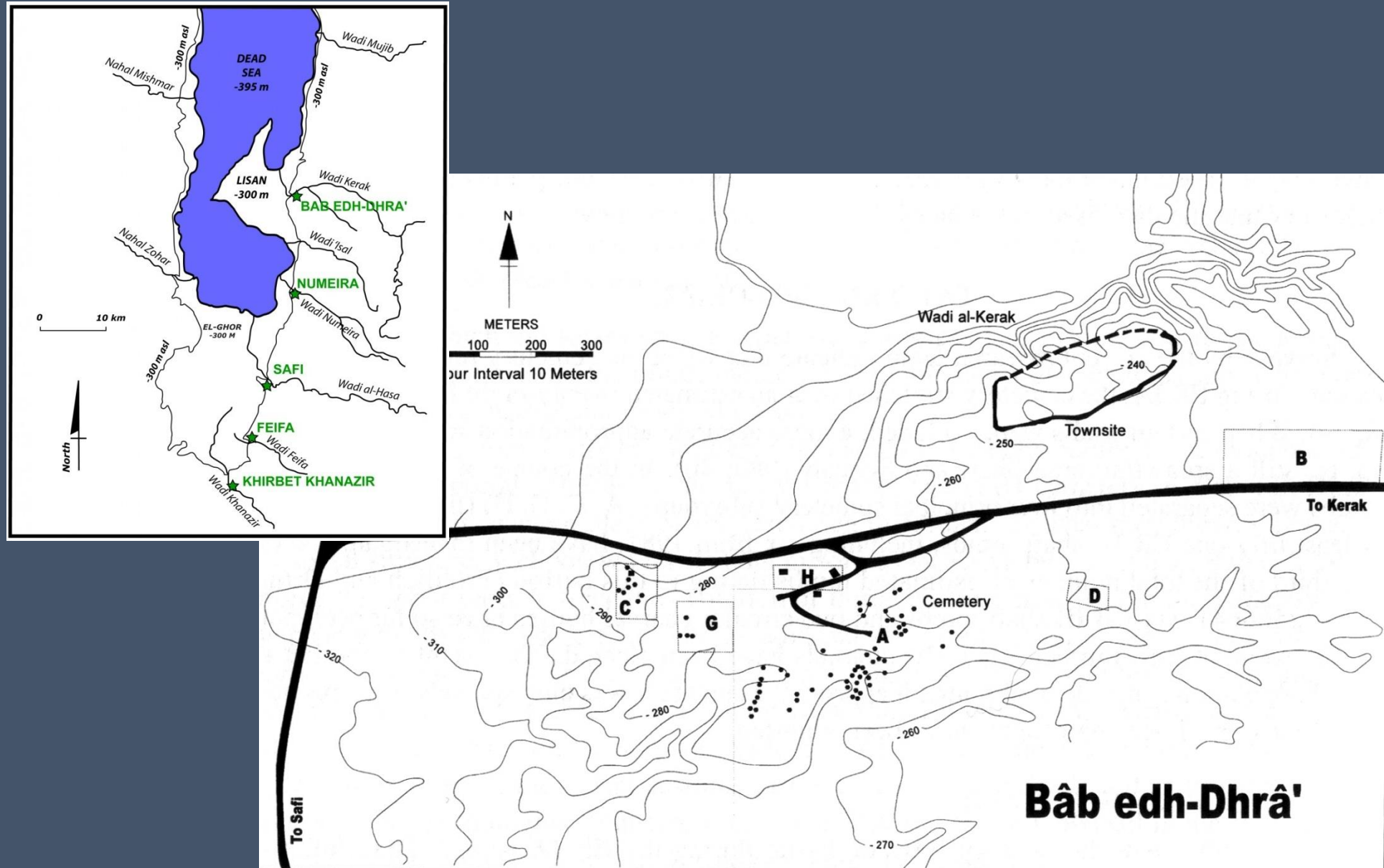

FIGURE 13.1. Plan of the town site and cemetery at Bâb edh-Dhrâ'

PLAN OF EB I MULTIPLE SHAFT BURIAL

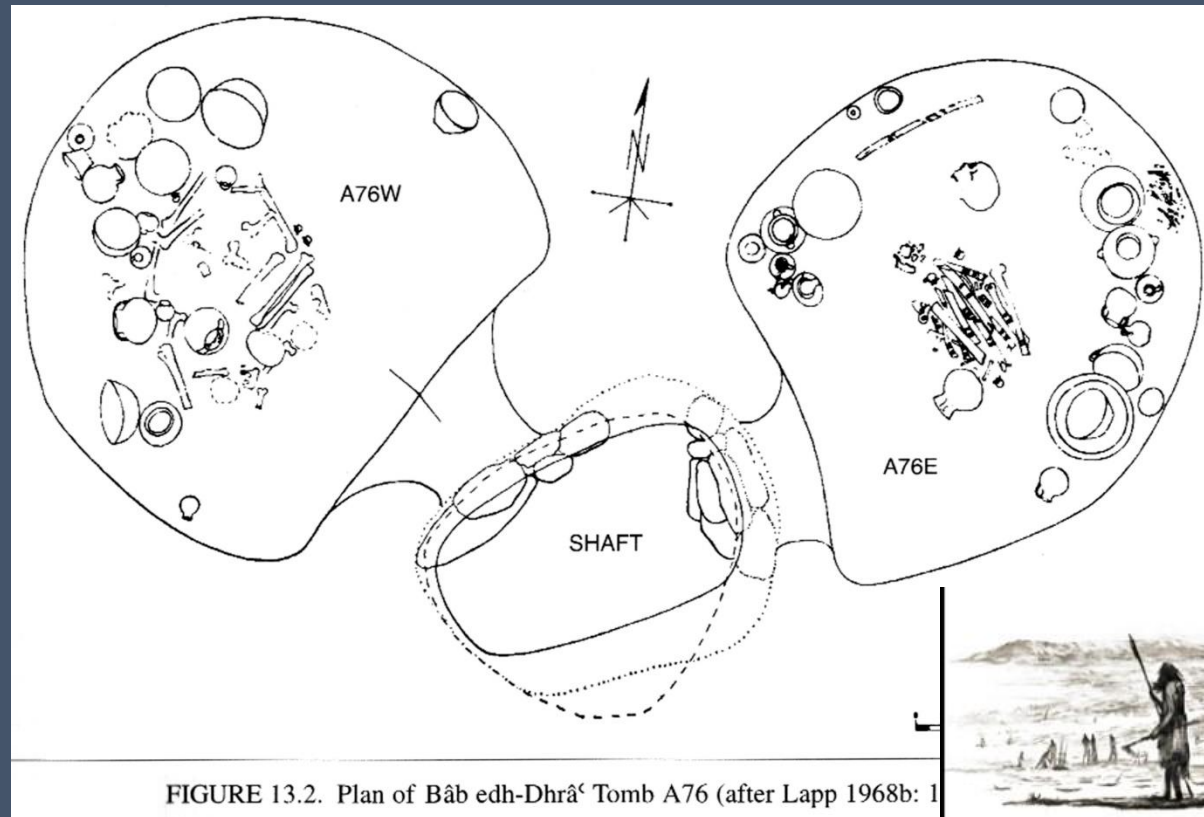
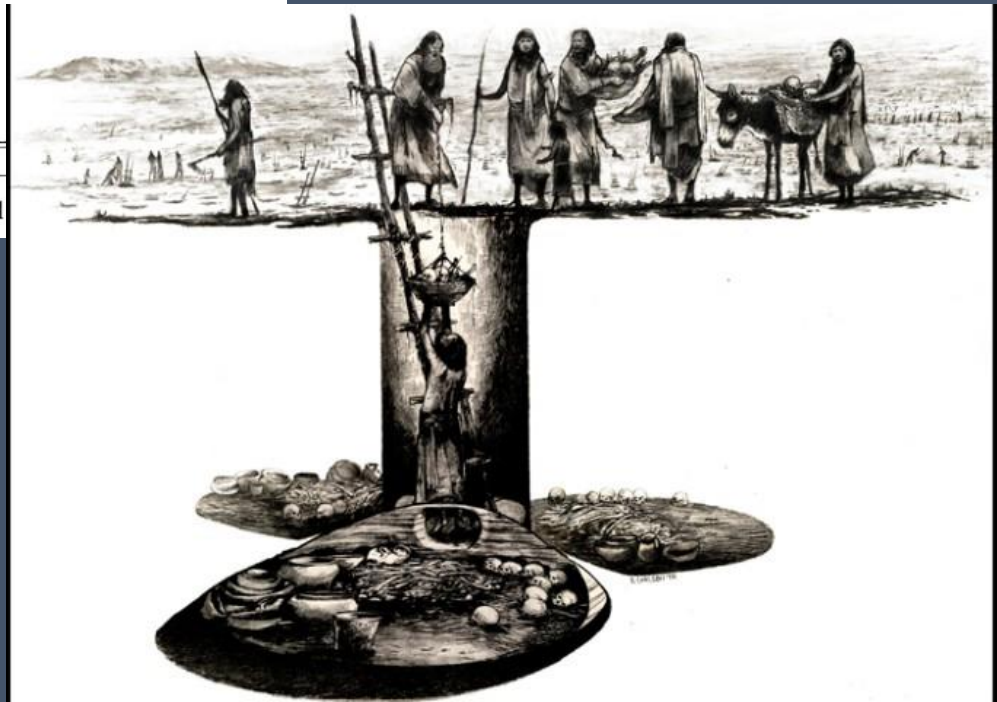

FIGURE 13.2. Plan of Bâb edh-Dhrâ' Tomb A76 (after Lapp 1968b: 1



BAB EDH-DHRA: SO CALLED
„CHARNEL HOUSE” TYPE MULTIPLE
BURIAL

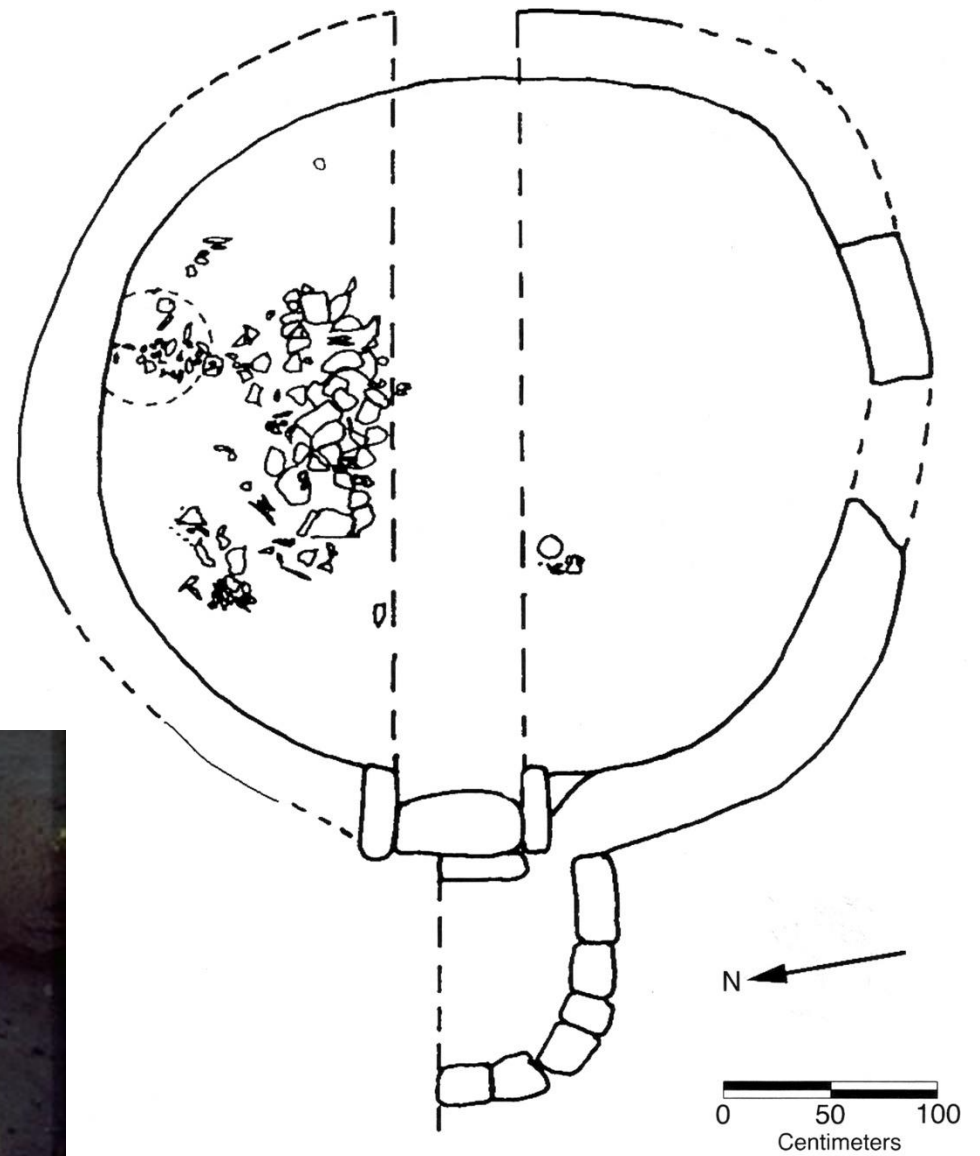
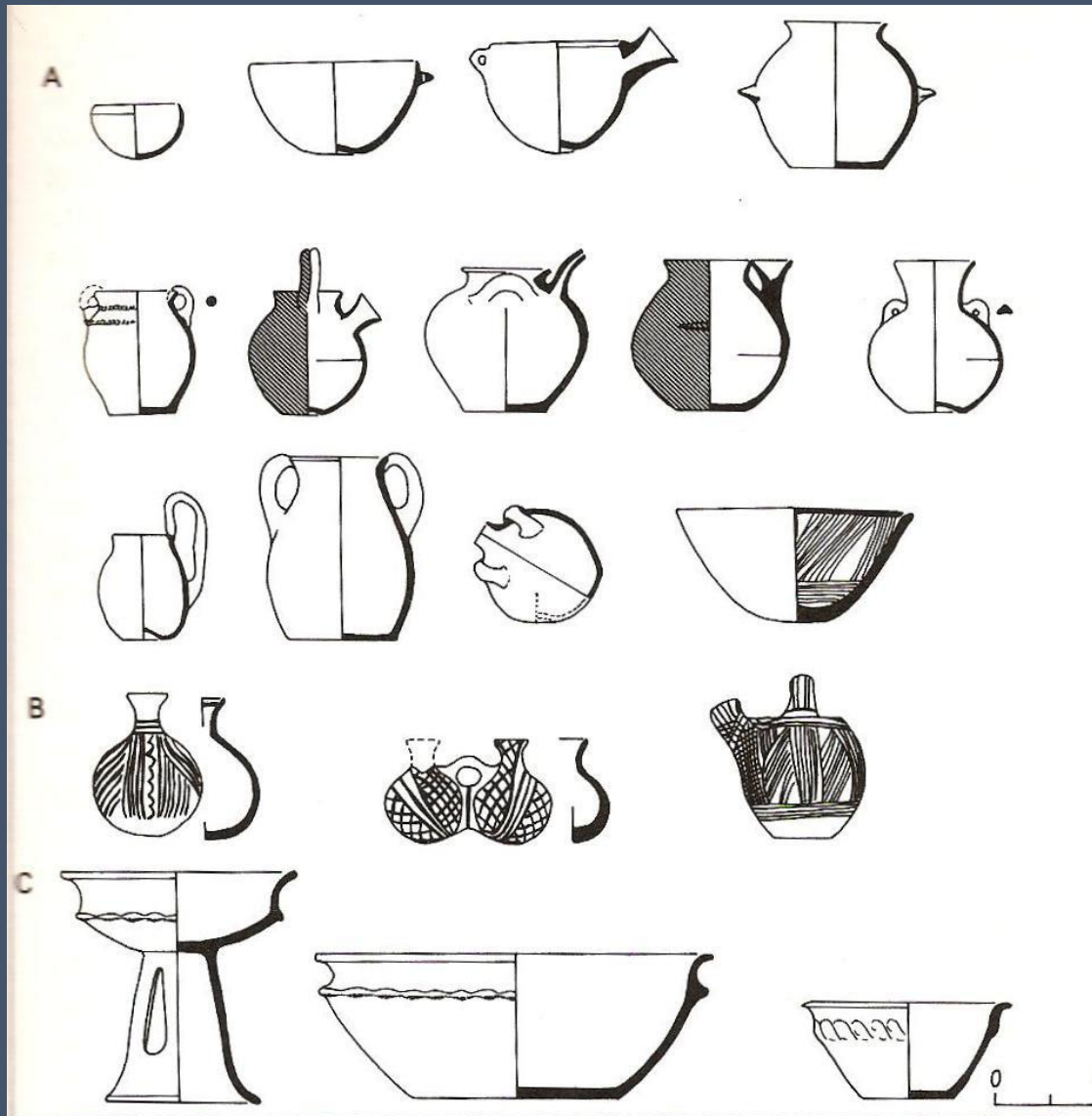

FIGURE 13.4. Plan of Bâb edh-Dhrâ' Charnel House G1 (after Schaub 1981: 64, fig. 23).

EBA I POTTERY



4.4 Selected pottery of Early Bronze I: (A) red slipped pottery; (B) painted pottery of central hill country sites; (C) Gray Burnished Ware.





Chalcolithic copper hoard

EBA copper industry

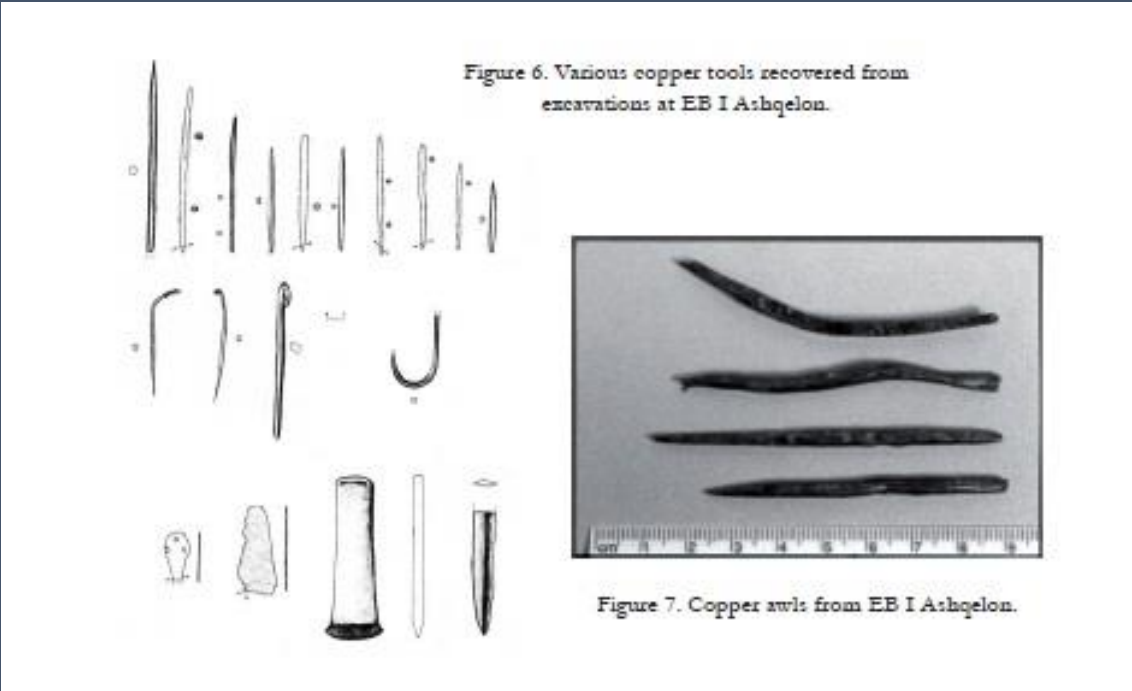

EB Canaanean blades

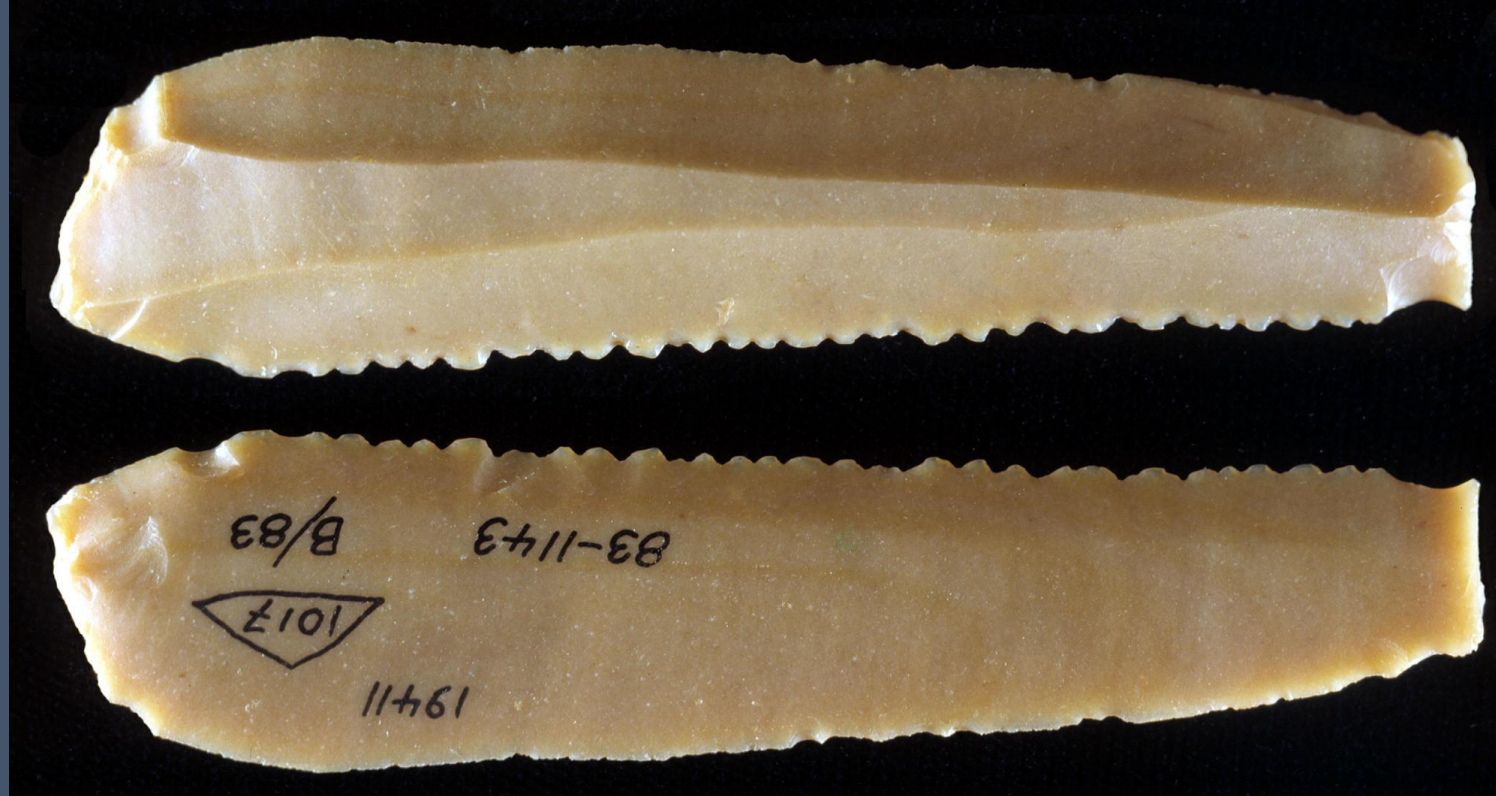

EB I PALESTINE SEALS

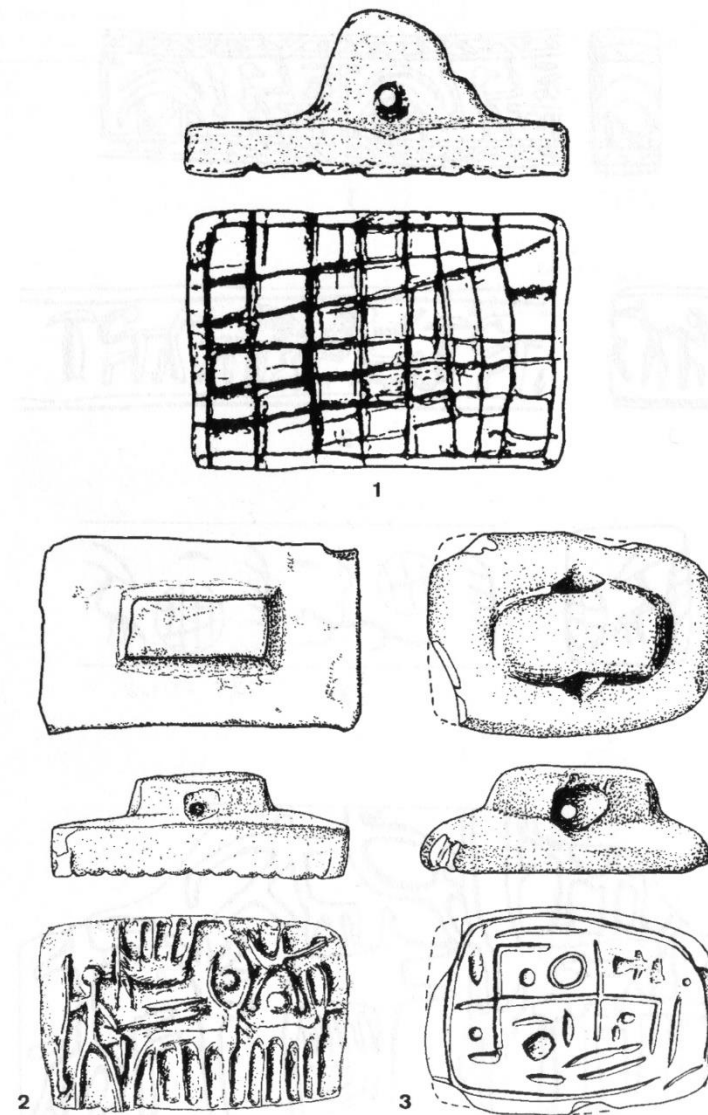

Fig. 5
Sceaux en pierre du Bronze ancien I
1. Tel Qashish. 2. Tel Kitan. 3. Tel Dan
Échelle 3 : 4

EB PALESTINE SEAL IMPRESSIONS

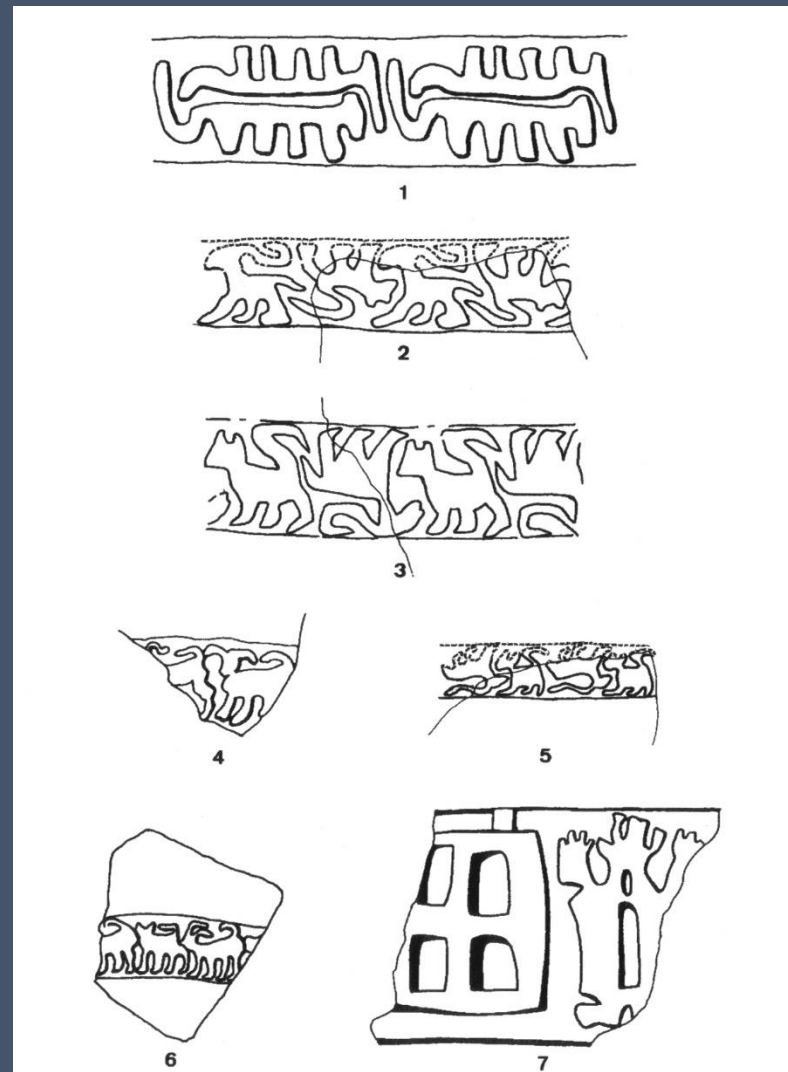

Fig. 6

Empreintes de sceaux-cylindres à décor animalier (n° 1 à 6) et humain (n° 7?) du Bronze ancien I. 1. Mégiddo. 2. En Shadud. 3. Mégiddo. 4. Mégiddo. 5. Tel Qashish 6. Mégiddo. 7. Kabri

Echelle 3 : 4

EARLY EB I = LATE PREDYNASTIC GERZEAN CULTURE IN EGYPT

EB I = DYNASTY 0 AND THE BEGINNING OF THE I DYNASTY

TEL ERANI – SETTLEMENT WITH CLEAR EGYPTIAN INFLUENCES – A TRADE COLONY'?

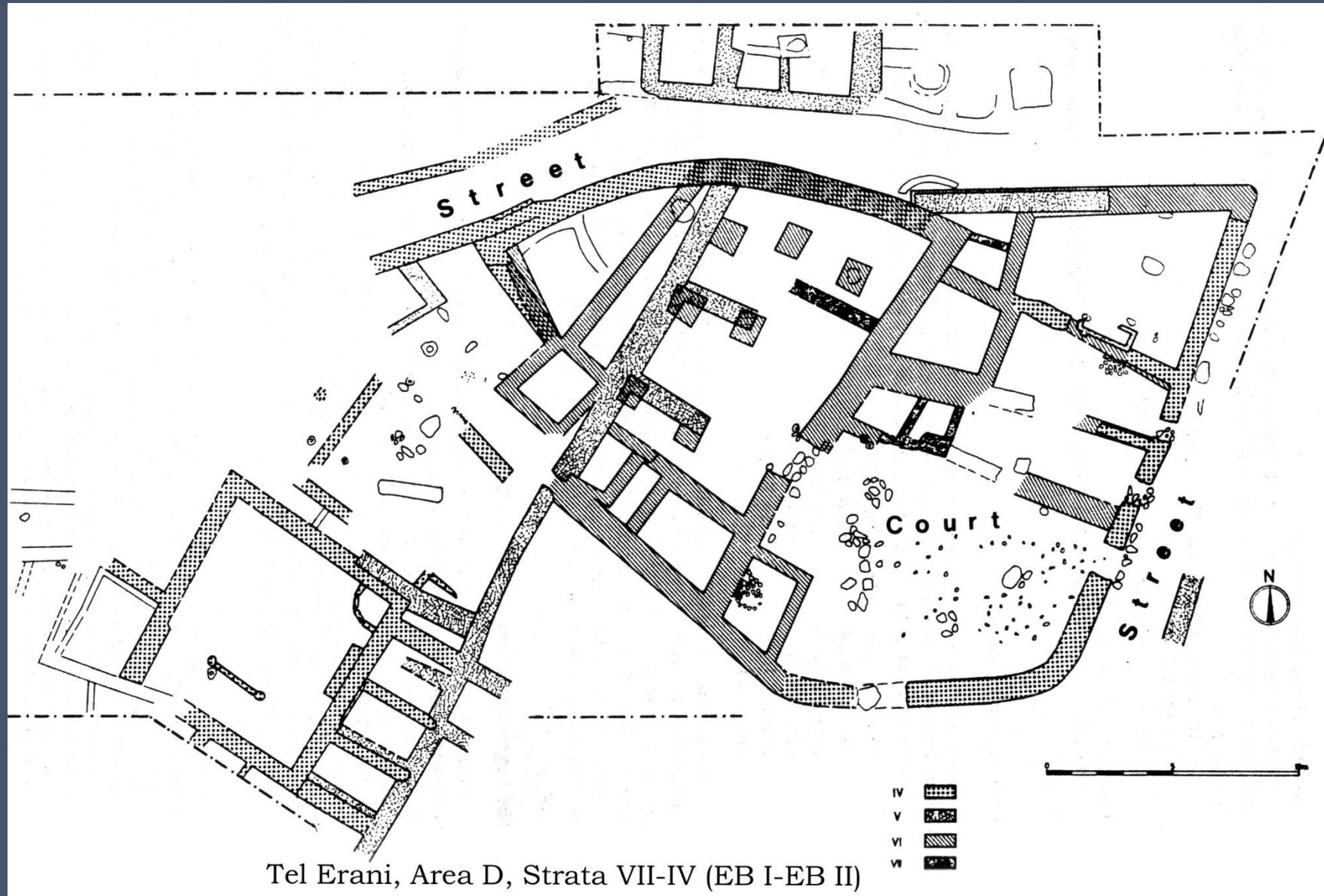

Tel Erani, Area D, Strata VII-IV (EB I-EB II)

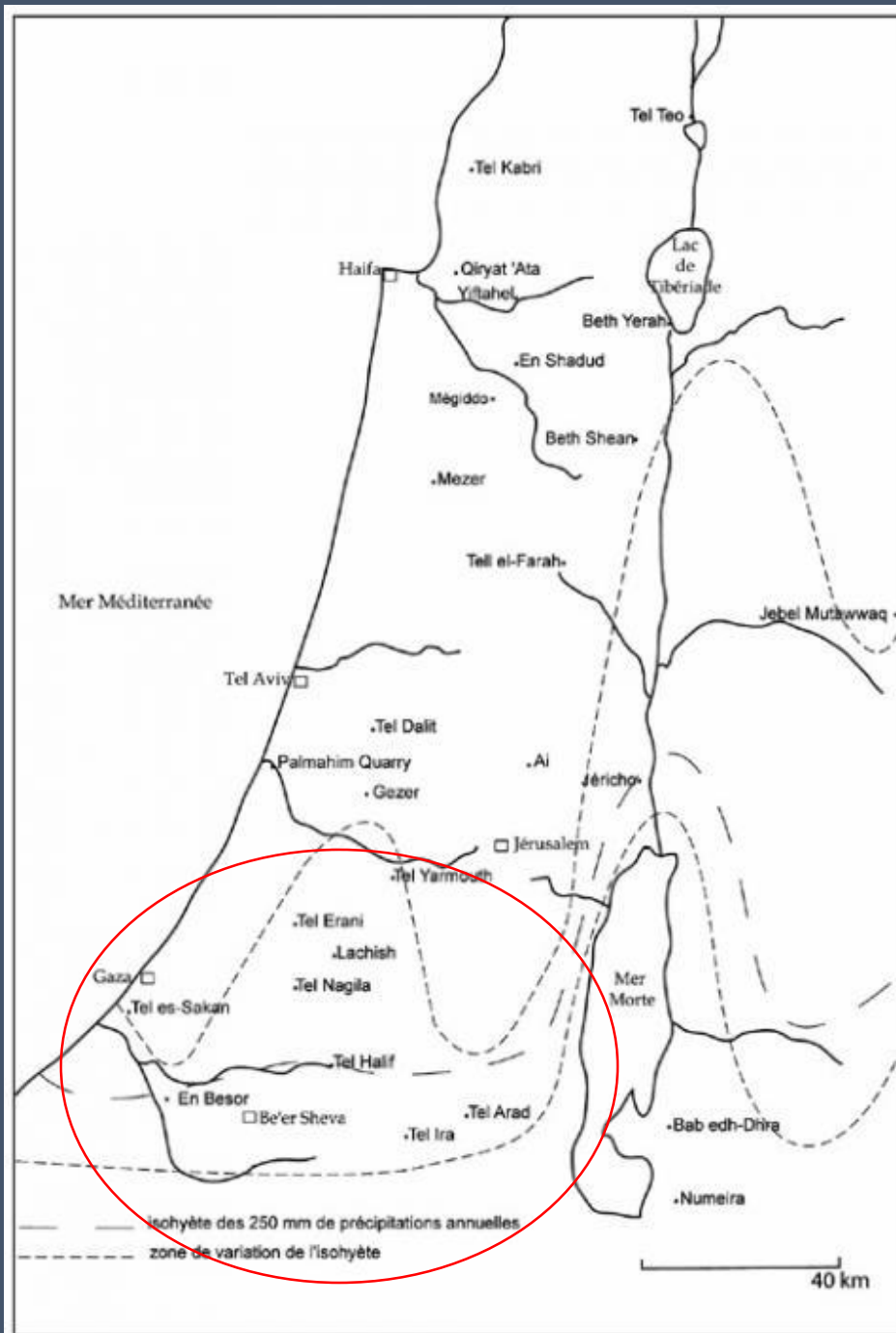

KING NARMER'S PALETTE WITH DEPICTION OF CONQUERED ASIATIC PEOPLE

