

SYRIA – 2nd half of the 3rd
millennium BC

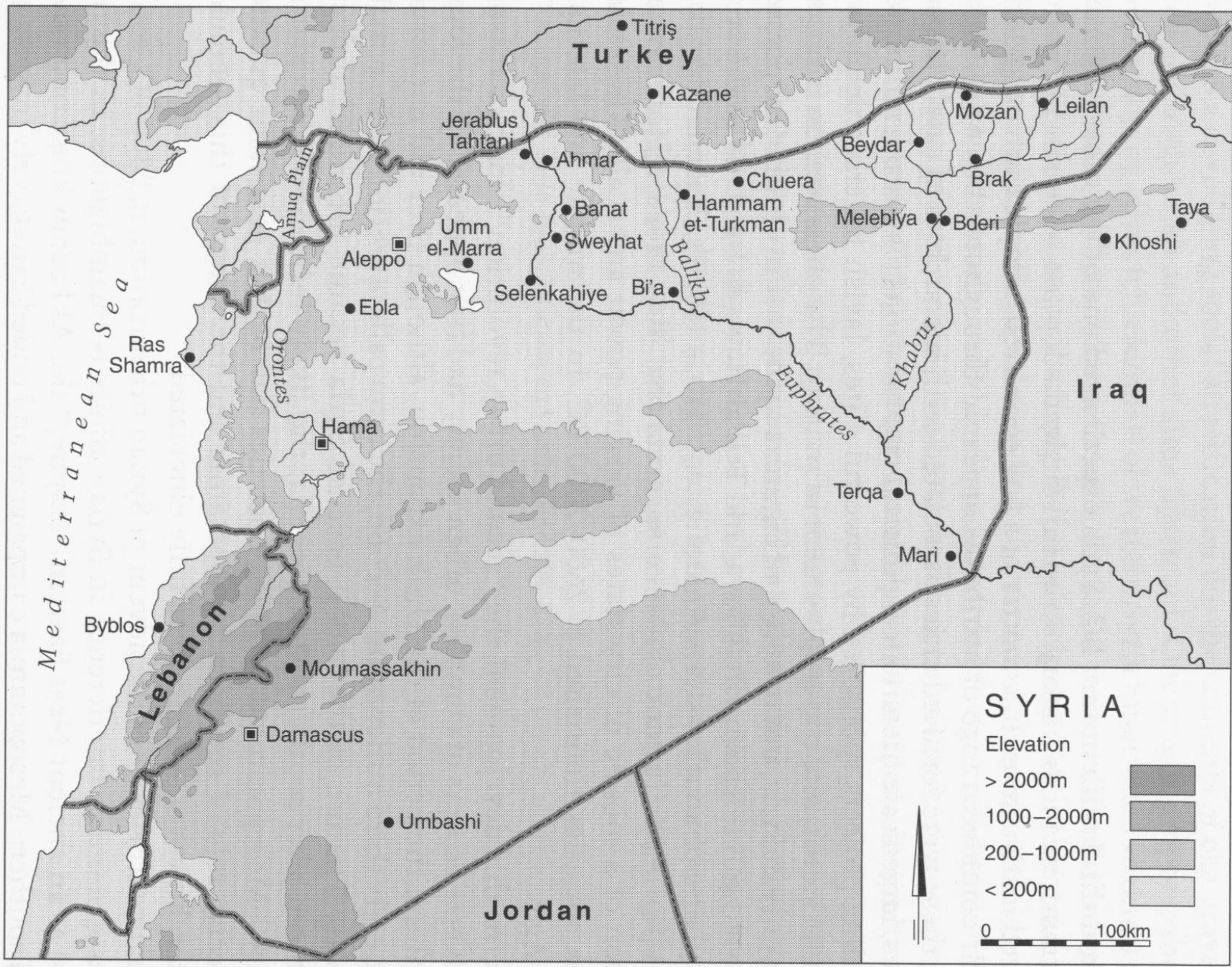

CHRONOLOGY IN THE SECOND HALF OF THE 3rd MILLENNIUM

EBA III-IV

Early Jezireh II – 2600 = ED IIIa (MESOPOTAMIA)

Early Jezireh IIIa - 2500 = ED IIIb

Early Jezireh IIIb – 2350 = ED IIIb

Early Jezireh IIIb – 2300 = Akkad

Early Jezireh IVa – 2250 = Akkad

Early Jezireh IVb – 2200 = Post-Akkad

Early Jezireh V – 2100-2000 = UR III

CERAMIC SEQUENCE

EARLY JEZIREH II (2600-2500) = Late Ninivite 5

EARLY JEZIREH IIIa (2500-2400) = Late Ninivite 5 + Metallic Ware + polichrome painted stands

EARLY JEZIREH IIIb (2400-2300) = Metallic Ware + „Akkadian Assamblage“

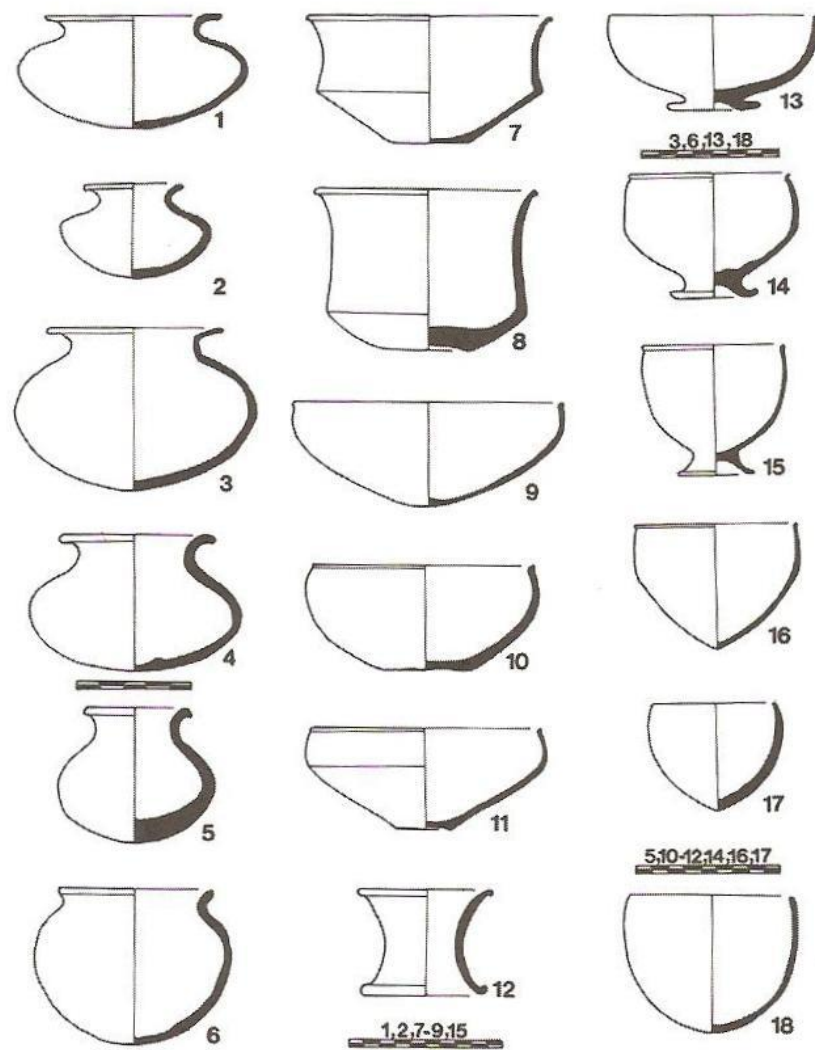

← Ryc. 23. Przykłady ceramiki nie zdobionej z końcowej fazy kultury Niniwa 5 z Tell Leilan (1, 2, 7, 8, 9, 12, 15 – wg Calderone L., Weiss H. 2003, 211, fig. 7:1, 5-7; 213, fig. 8:1, 5, 6), Tell Abu Hafur (4, 10 – wg Koliński R., Lawecka D. 1992, 229, fig. 7:5; 234, fig. 12:3), Tell Atidz (3, 5, 6, 13, 17, 18 – wg Fortin M. 1988, 166, fig. 30, 1990; 237, fig. 17), Tell ar-Raqai (11, 16 – wg Curvers H. H., Schwartz G. M. 1990, 18, fig. 20:7, 21) i Tell Brak (14 – wg Matthews R. J. 1995, 106, fig. 16:8).

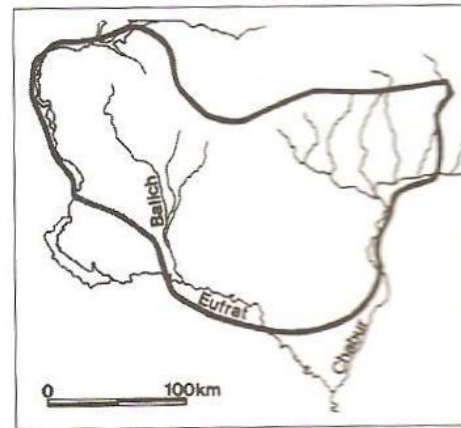

Ryc. 24. Główny obszar występowania ceramiki typu *Metallic Ware* (wg Pruß A. 2000b, 200, fig. 1).

METALLIC WARE (left, top and bottom) POLICHROME PAINTED STANDS (right, bottom)

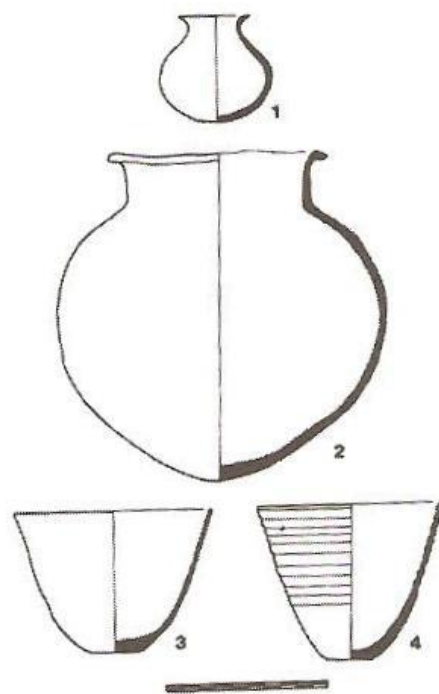

Ryc. 25. Tell Chuera, przykłady naczyń typu *Metallic Ware* (wg Pruß A. 2000b, 203, fig. 2).

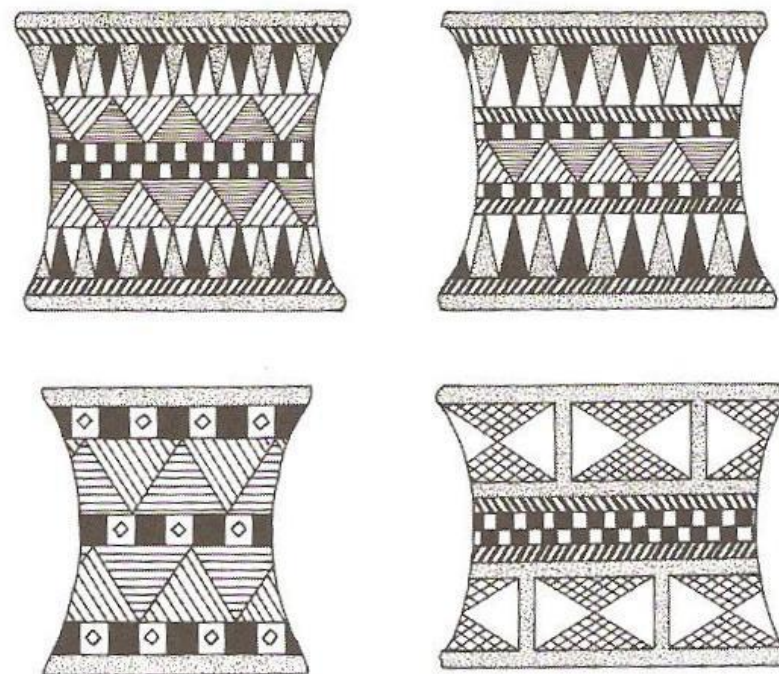

Ryc. 26. Typy malowanych podstawek pod naczynia, okres wczesnodynastyczny II/III (wg Valentini S. 2003, 76, fig. 2).

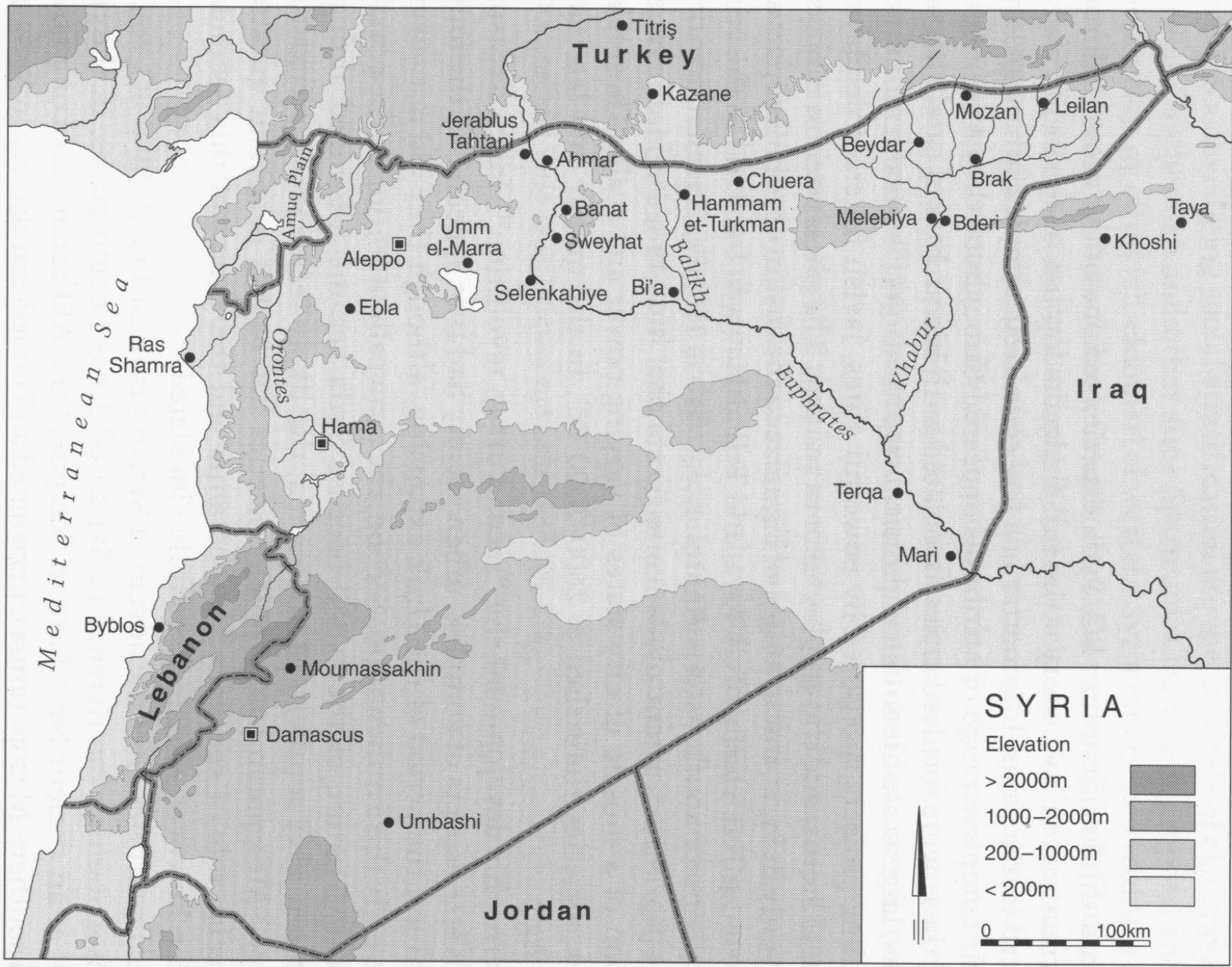

Turkey

Iraq

Lebanon

Jordan

Mediterranean Sea

Titriş

Kazane

Jerablus Tahtani

Ahmar

Beydar

Mozan

Leilan

Chuera

Brak

Banat

Hammam et-Turkman

Melebiya

Bderi

Taya

Aleppo

Umm el-Marra

Sweyhat

Selenkahiye

Bi'a

Khoshi

Ebla

Ras Shamra

Hama

Terqa

Mari

Byblos

Moumassakhin

Damascus

Umbashi

Amuq Plain

Orontes

Balikh

Euphrates

Khabur



TELL BRAK/
ANCIENT NAGAR

TELL BRAK – OVAL BUILDING

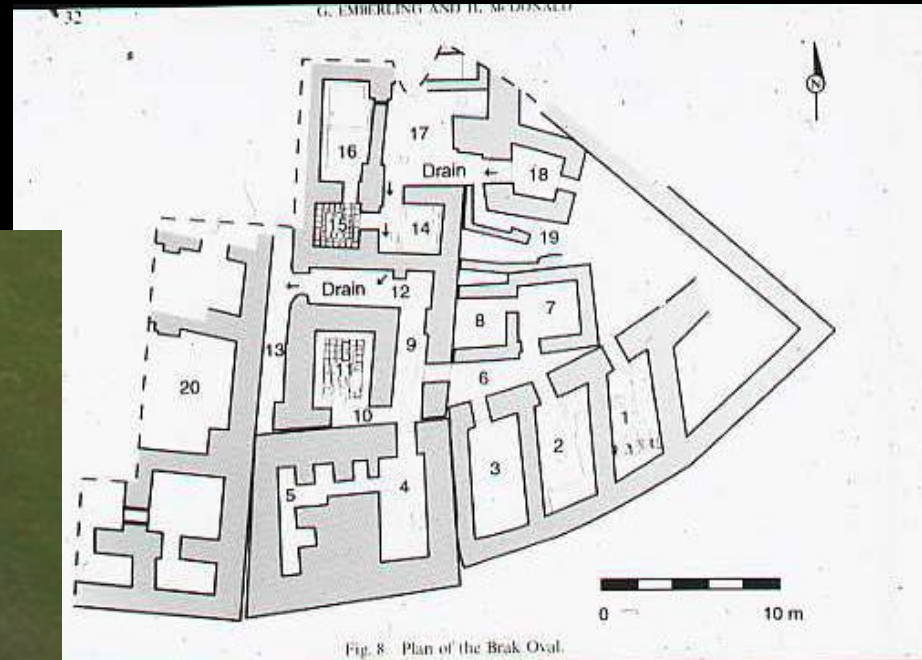

Tell Brak - ED III
© 2000 Learning Sites, Inc.

Tell Brak - NAGAR

CEREMONIAL COMPLEX

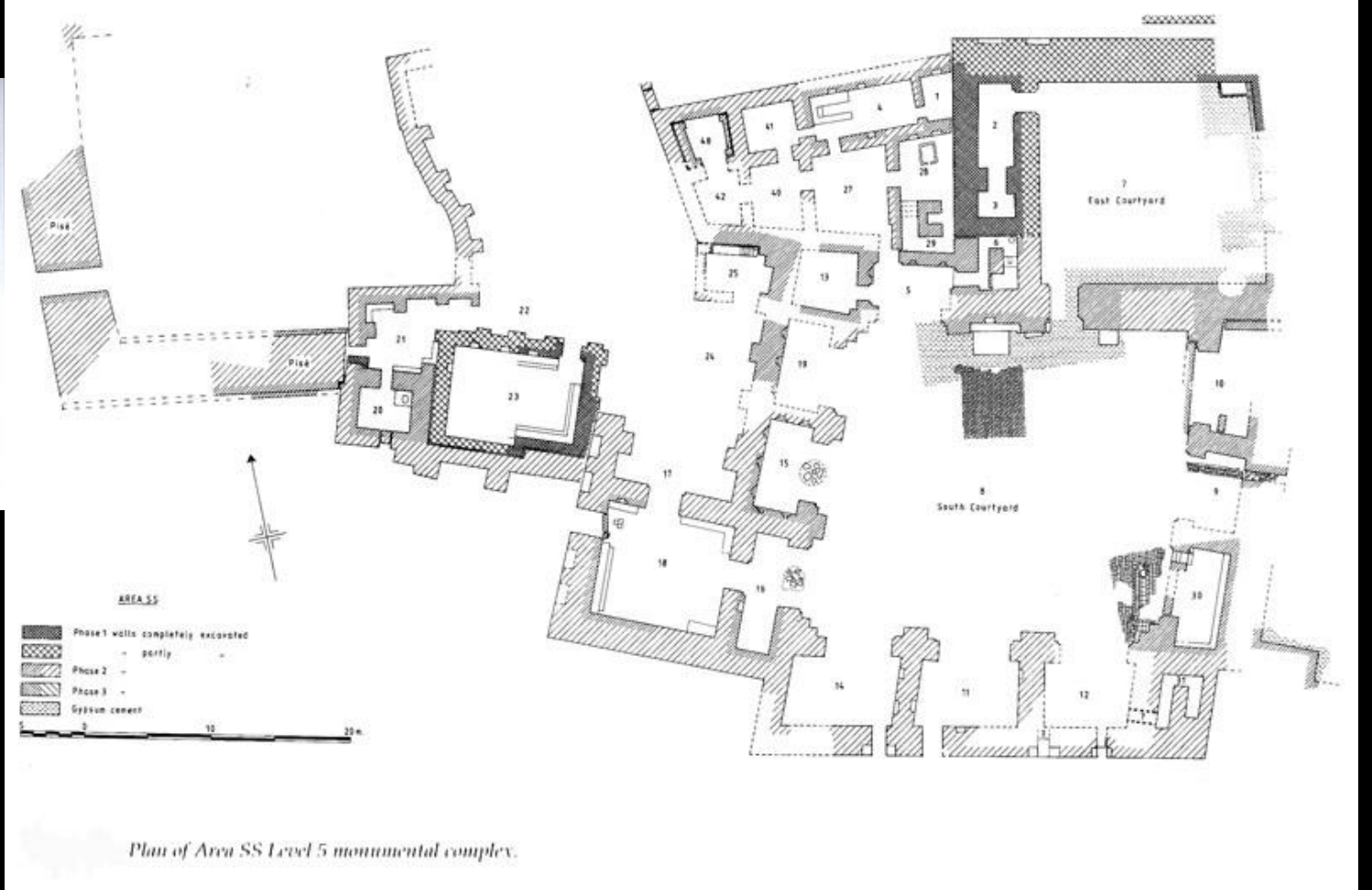

METAL HOARD

TELL BRAK: NARAMSIN'S FORT
AND BUILDINGS OF SACRAL COMPLEX

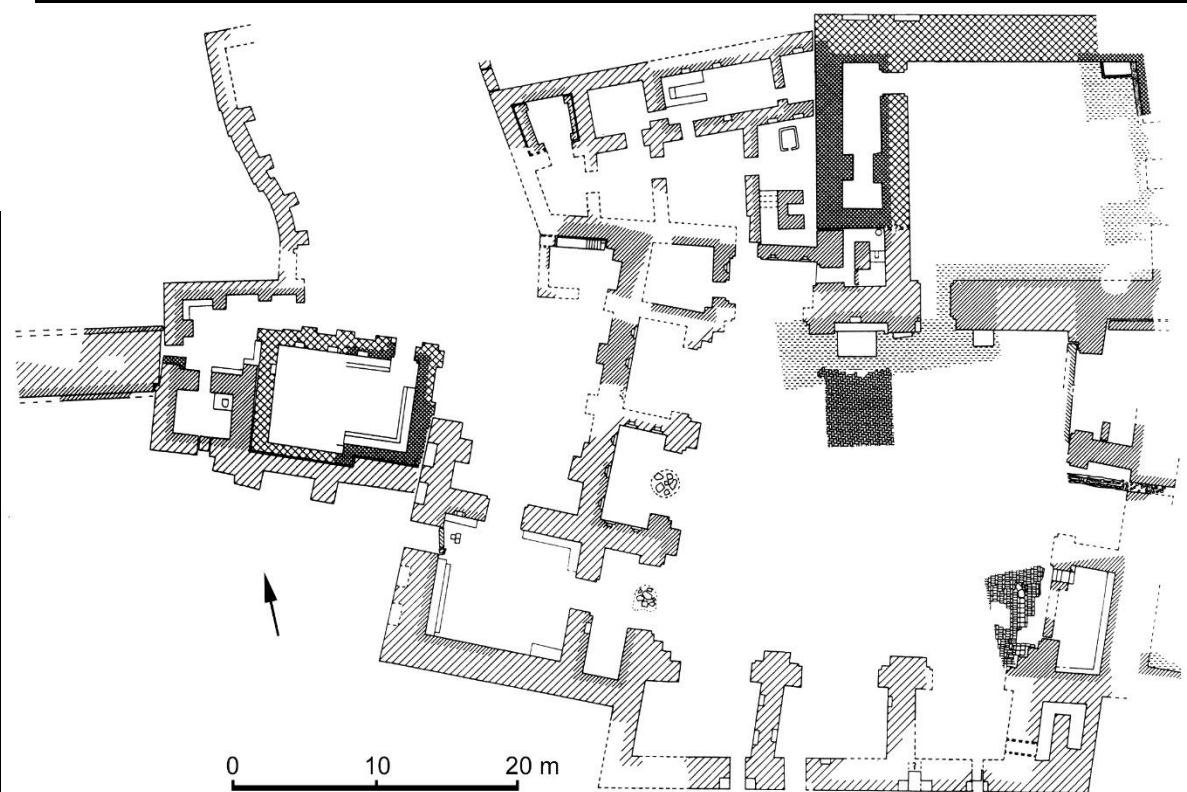
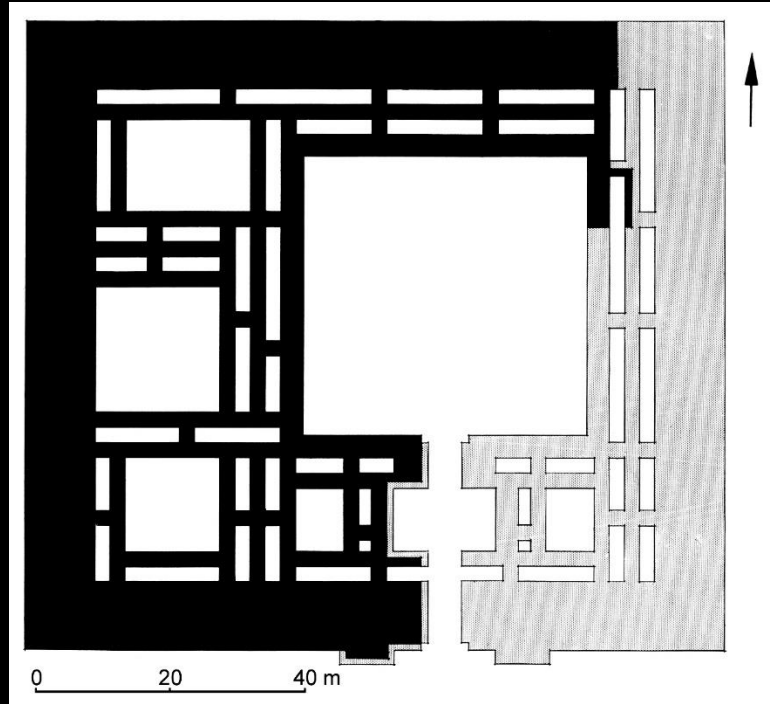

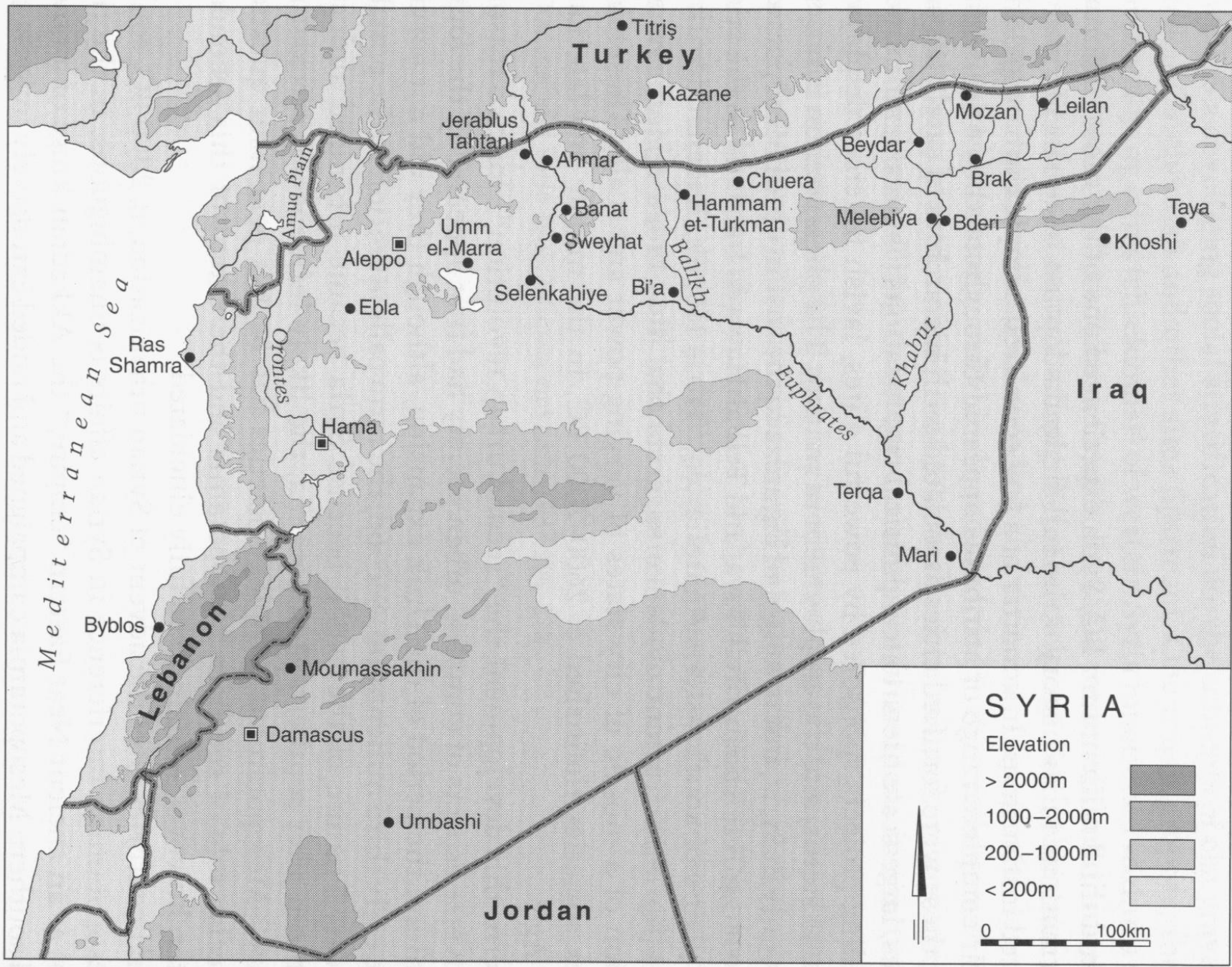

Turkey

Iraq

Lebanon

Jordan

Mediterranean Sea

Titriş

Kazane

Jerablus Tahtani

Ahmar

Beydar

Mozan

Leilan

Chuera

Brak

Banat

Hammam et-Turkman

Melebiya

Bderi

Taya

Aleppo

Umm el-Marra

Sweyhat

Selenkahiye

Bi'a

Khoshi

Ebla

Ras Shamra

Hama

Terqa

Mari

Byblos

Moumassakhin

Damascus

Umbashi

Amuq Plain

Orontes

Balikh

Euphrates

Khabur

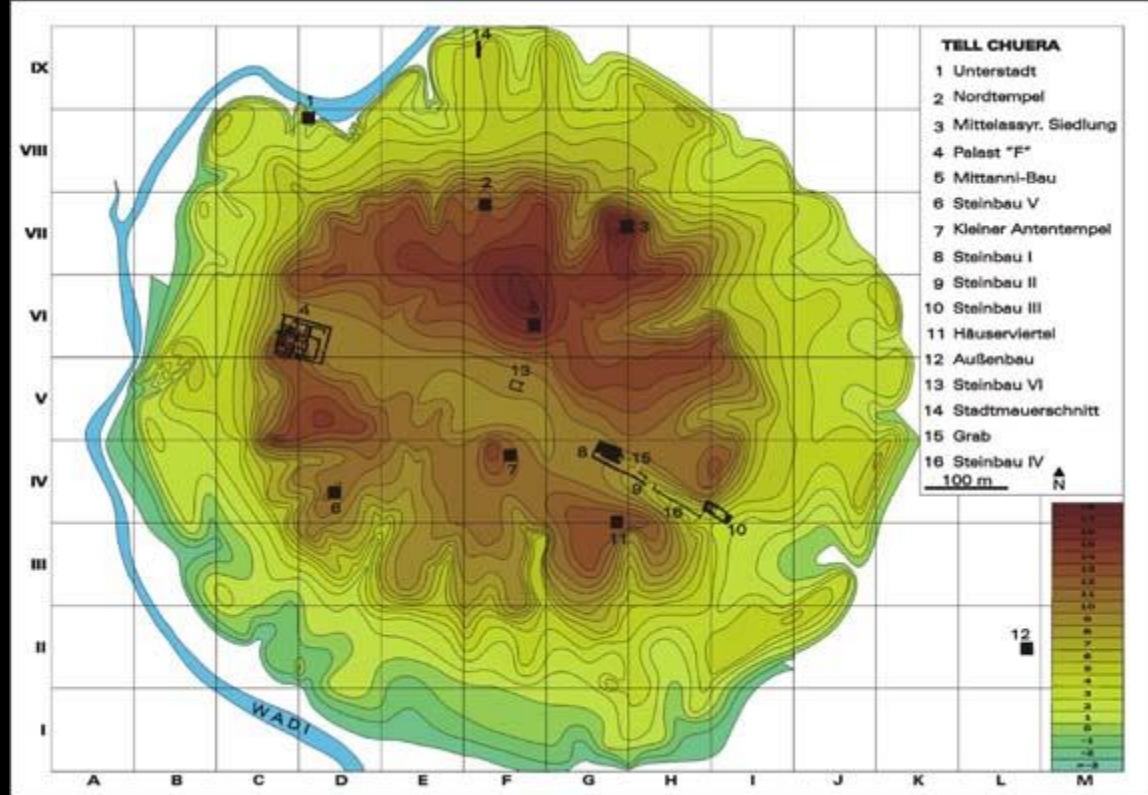

TELL CHUERA –

'KRANZHÜGEL'

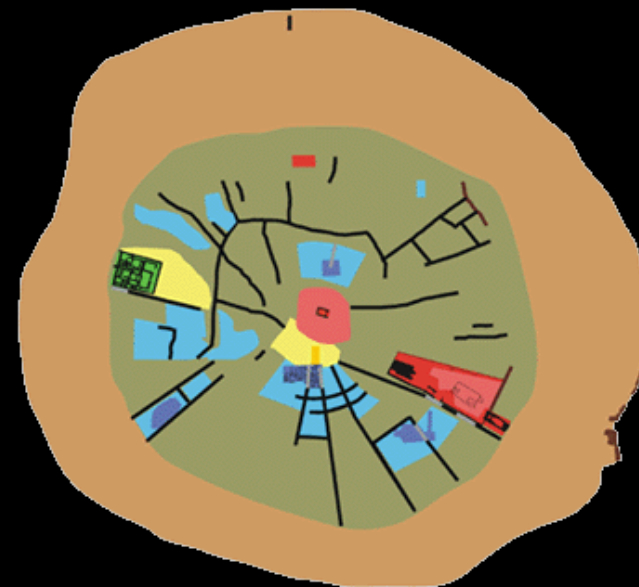

Flächennutzungsplanung

- Unterstadt: Flächennutzung im städtischen Umfeld, vorwiegend überwiegend Wohnbebauung
- Oberstadt: Bereiche mit ungestörter Flächennutzung





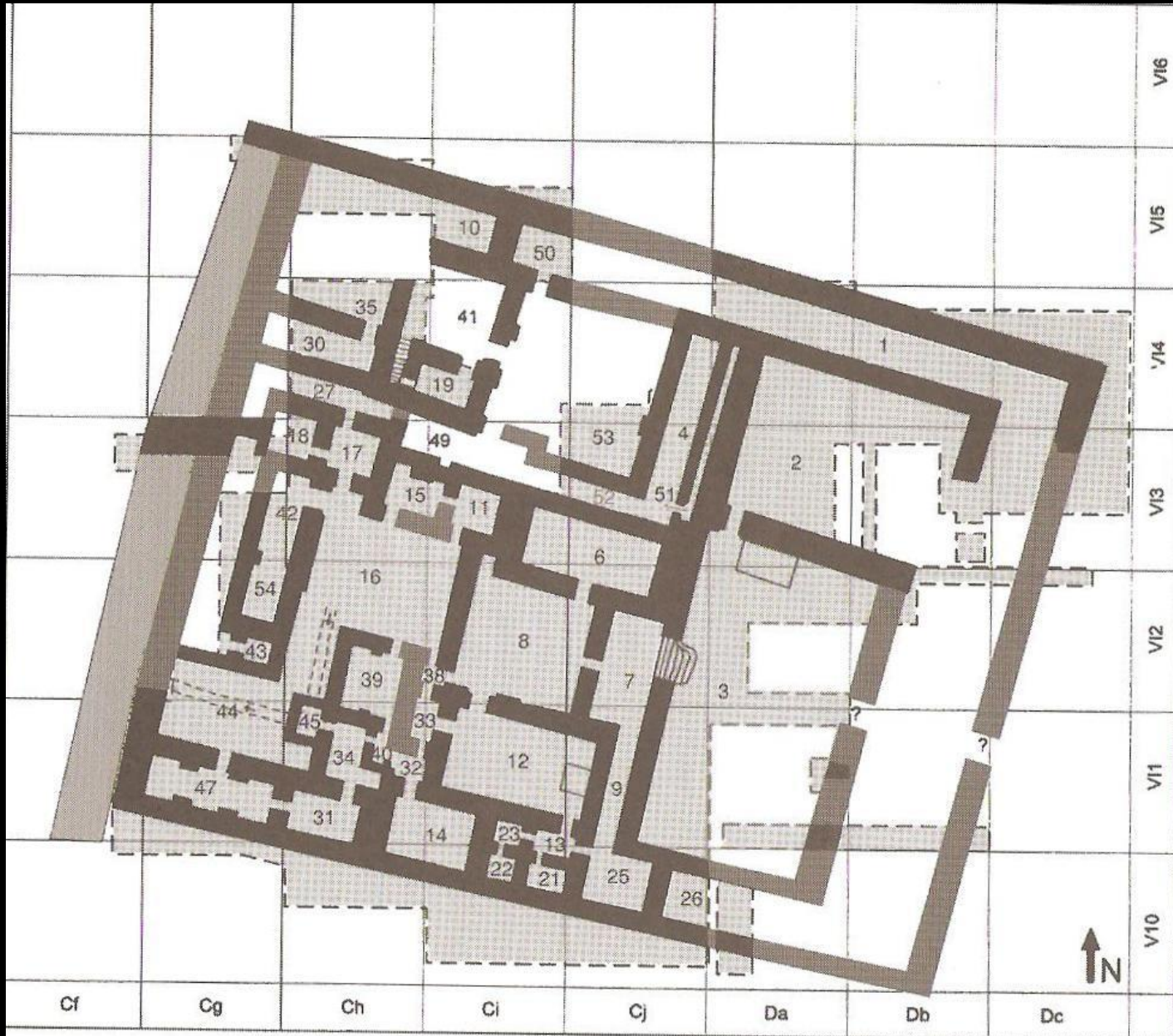

Funktionsbereiche in der Oberstadt:

- | | durch Entfernung
nahgelegenen | nach Freizeitzonen
angelegt |
|-------------------|---|---|
| Wohngebiet | | |
| Tempelbereich | | |
| Freizeitzonen | | |
| Straßen | | |
| Befestigung, Tore | | |
| Palast | | |



Tell Chuera
 Palace F
 Level 2b1
 State of 2000



-  excavated walls
-  reconstructed palace walls
-  reconstructed inner city wall
-  excavated area
-  room number
-  podium
-  drain

0 10m

Temples *in antis* from Tell Chuera in Upper Khabur

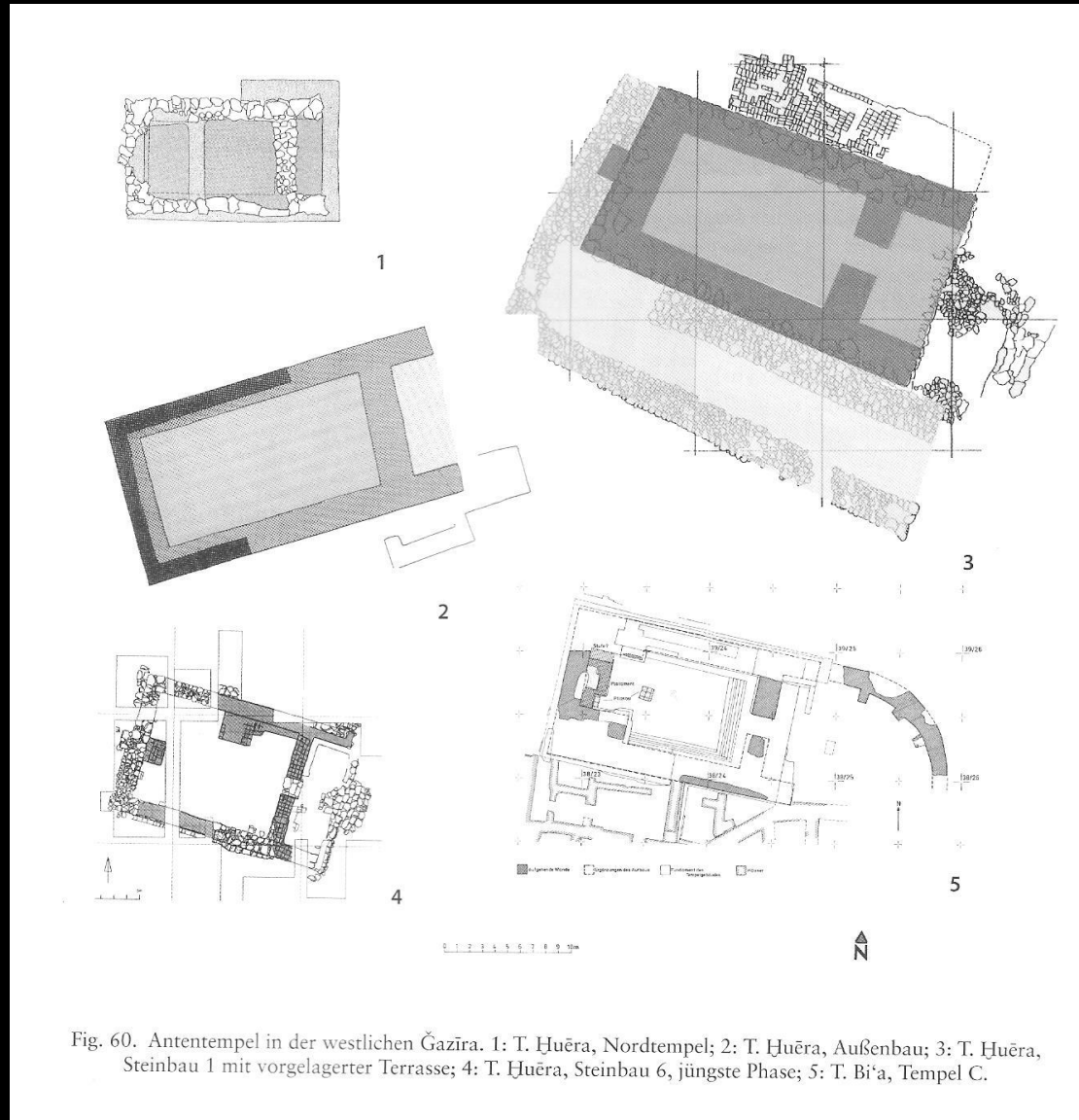

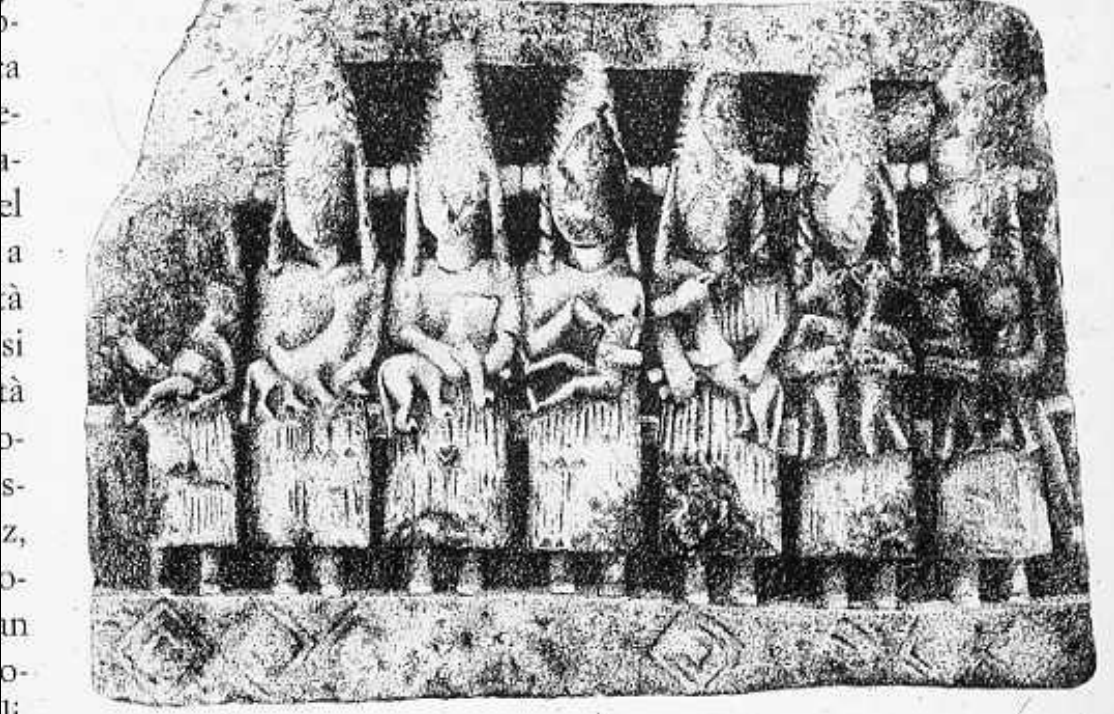

Cultic basin from Tell Chuera
(top, left), praying man figurine
(bottom, right)



TELL BEIDAR

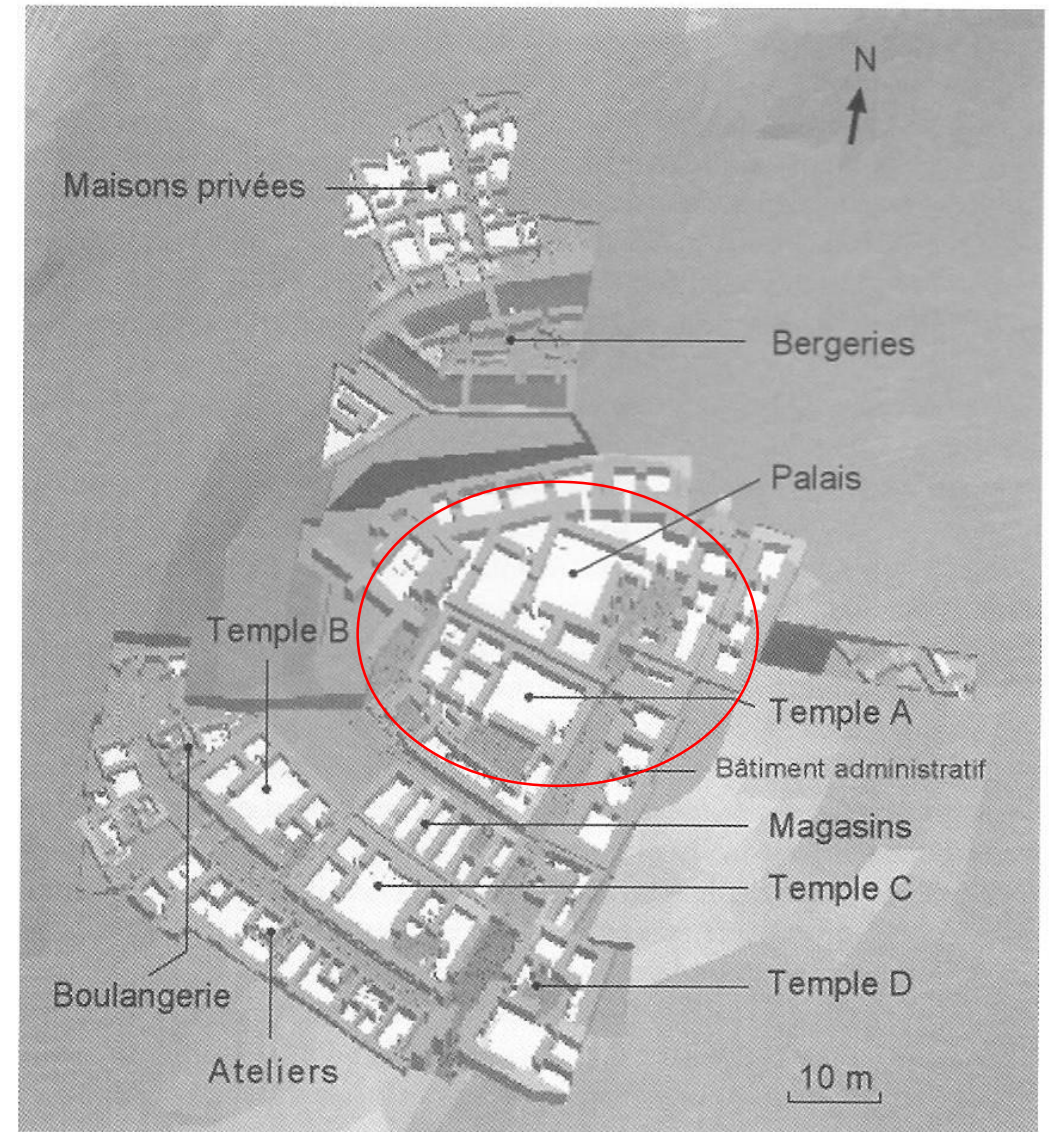
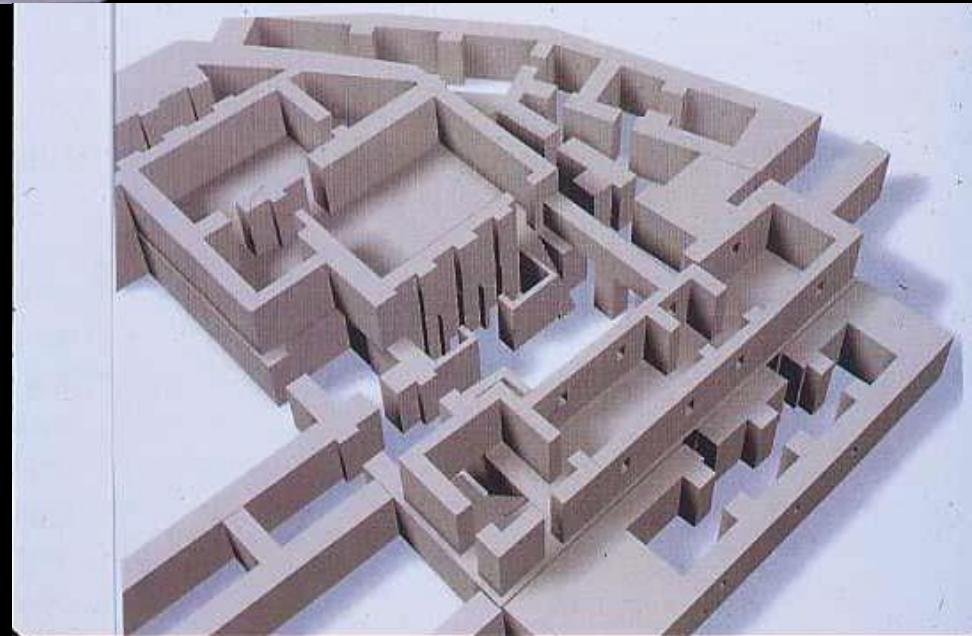
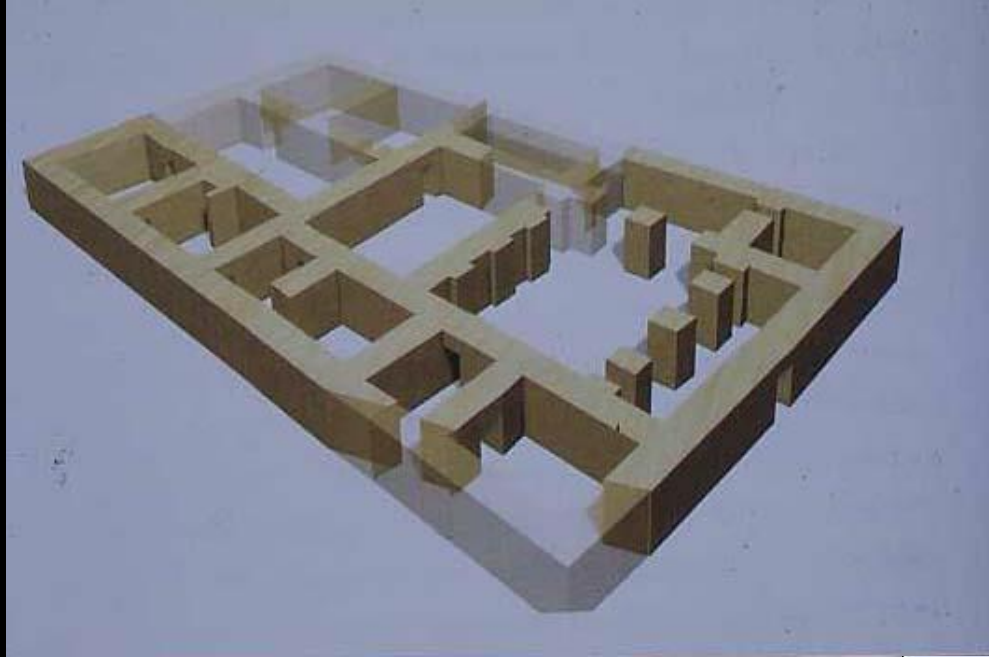

Fig. 45. L'architecture EJIIIb de l'acropole de T. Beidar (reconstitution axonométrique)

TELL BEIDAR PALACE – PHASE 1 AND 2



A granary from Tell Beidar



Tell Beidar – arched passage leading to the palace

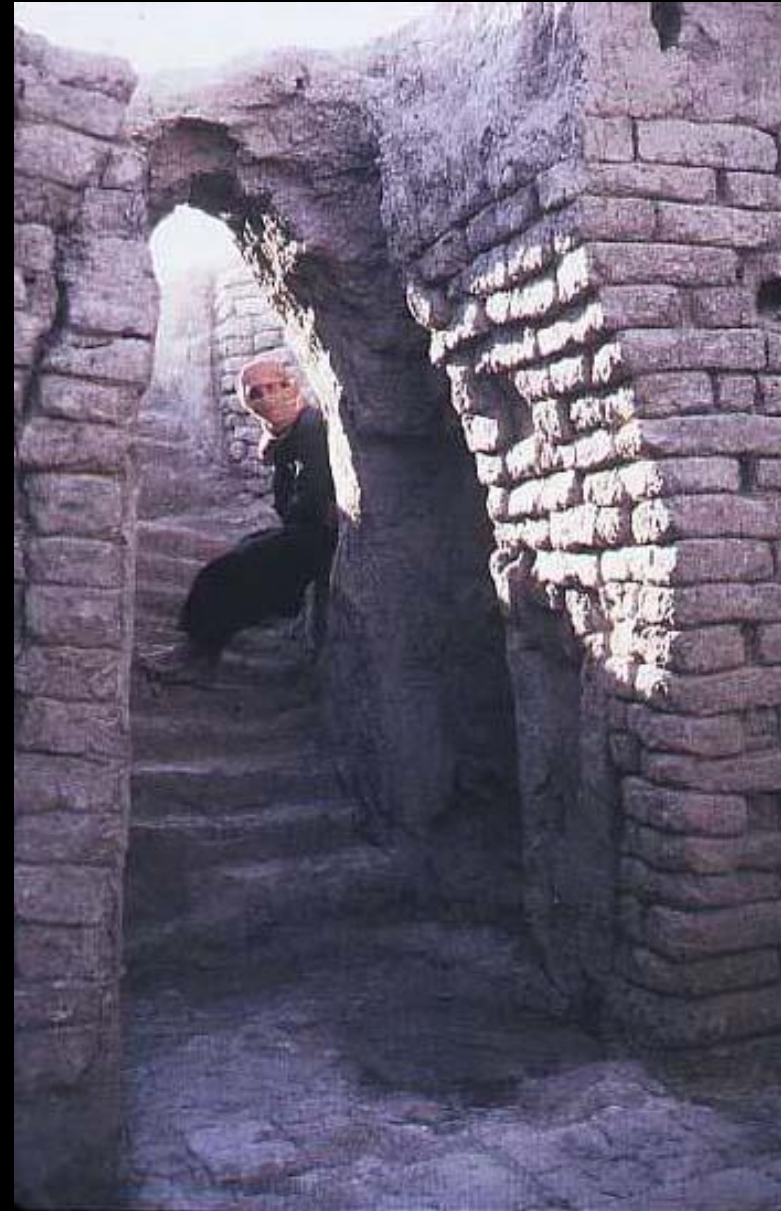

LATE III MILLENNIUM PALACE AT URKESH (Tell Mozan)

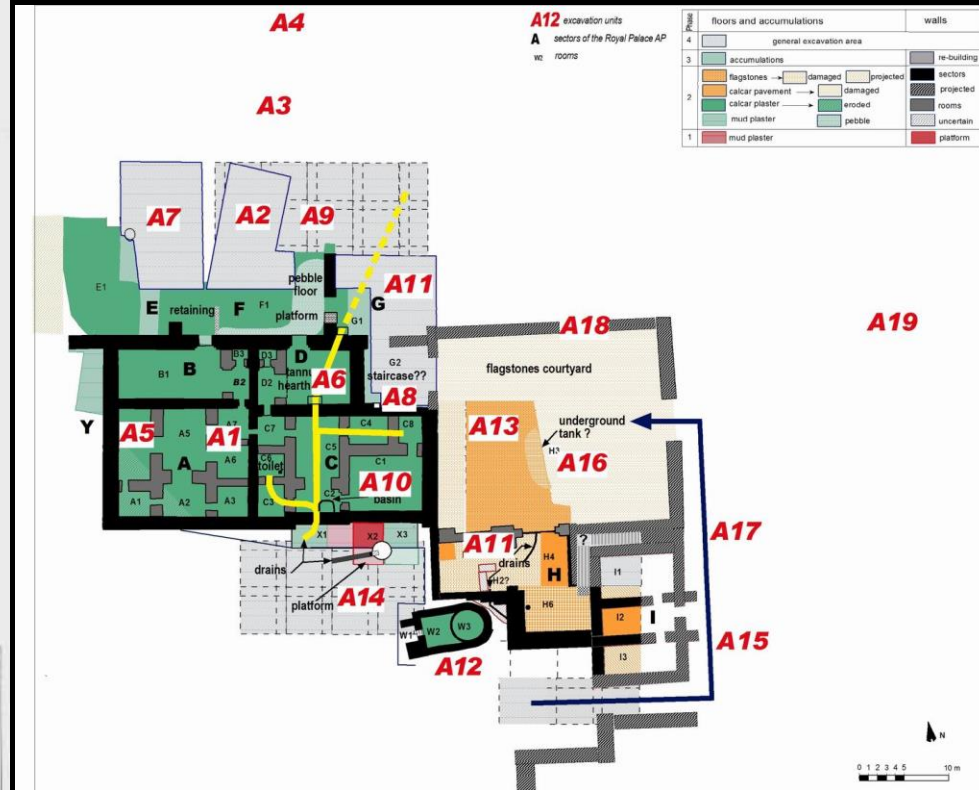
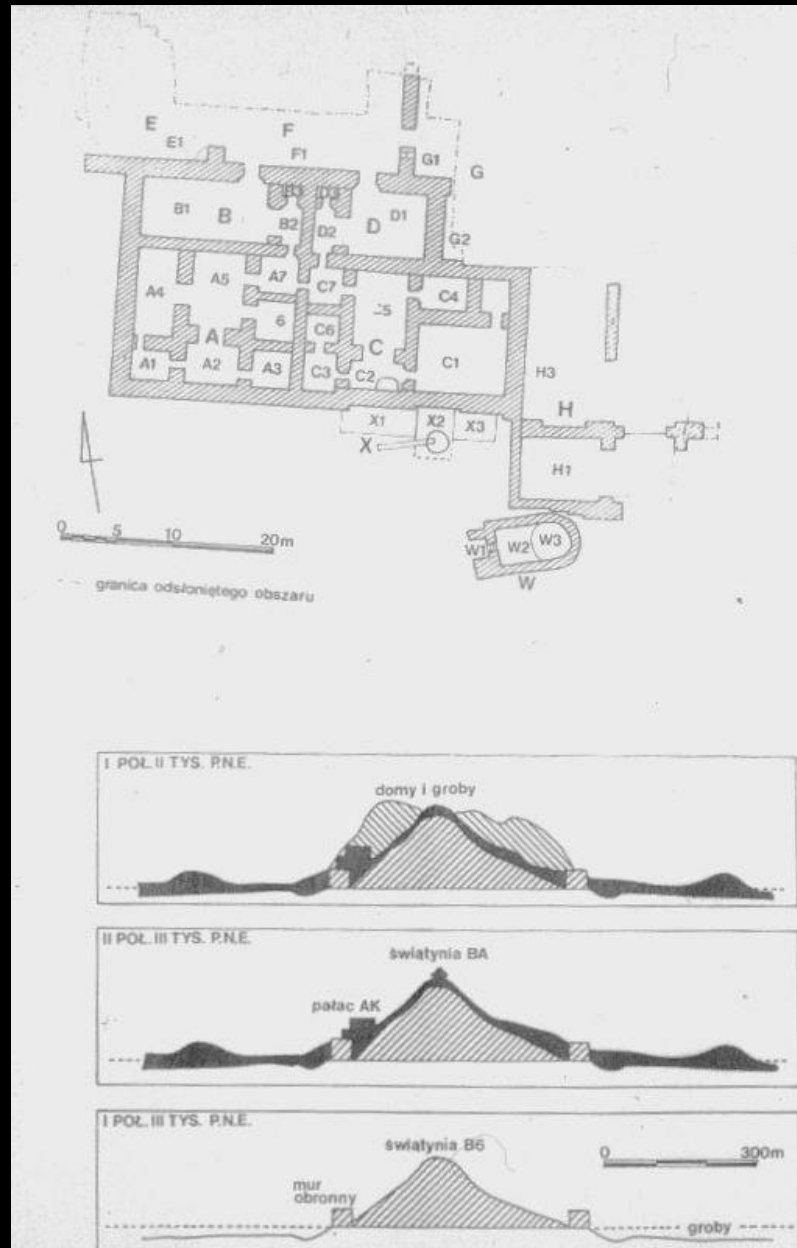

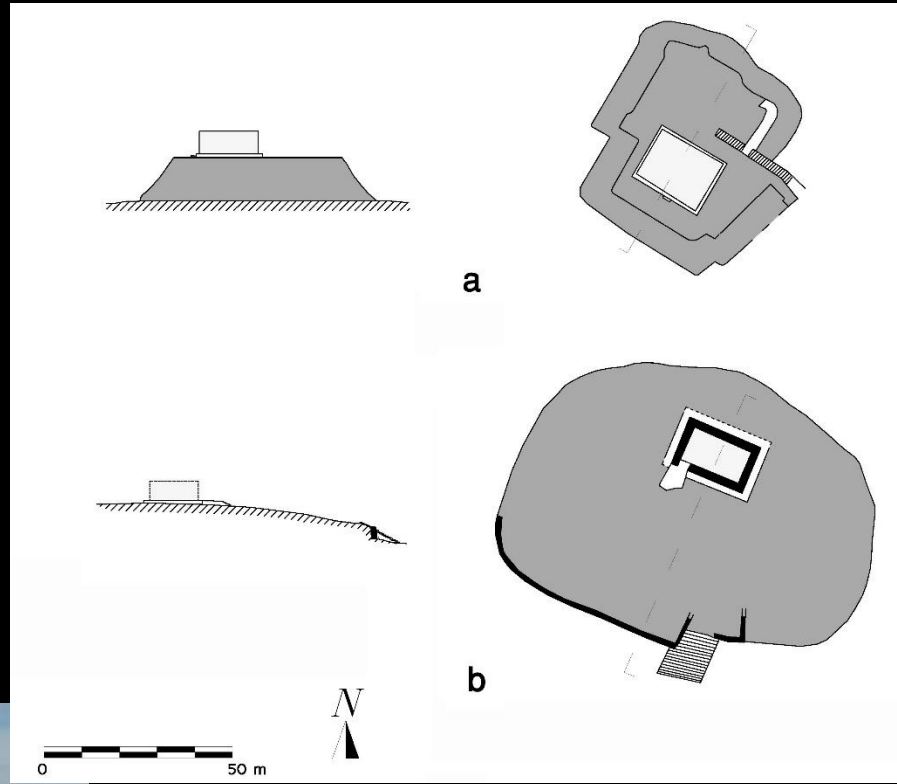
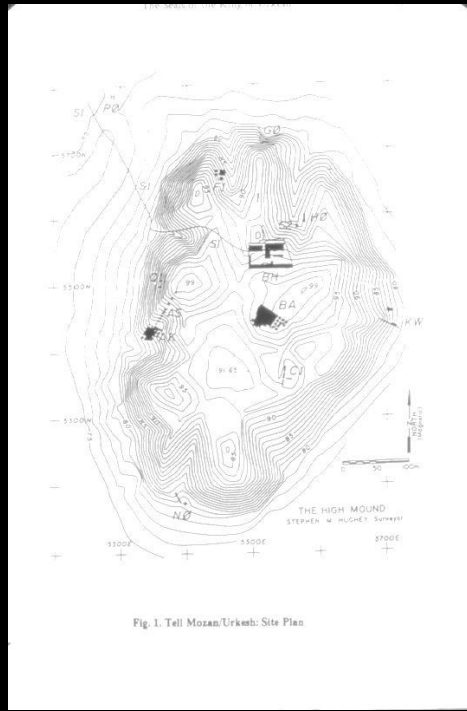



ELITE BURIALS IN THE 2ND HALF OF THE 3RD
MILLENNIUM BC IN NORTHERN
MEOSPOTAMIA AND SYRIA

Tell Sweyhat elite tombs

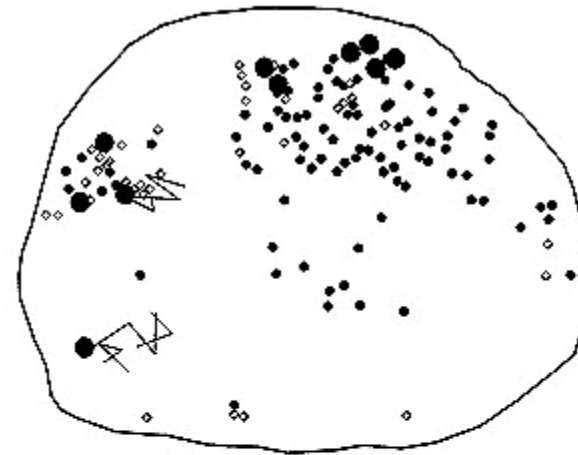
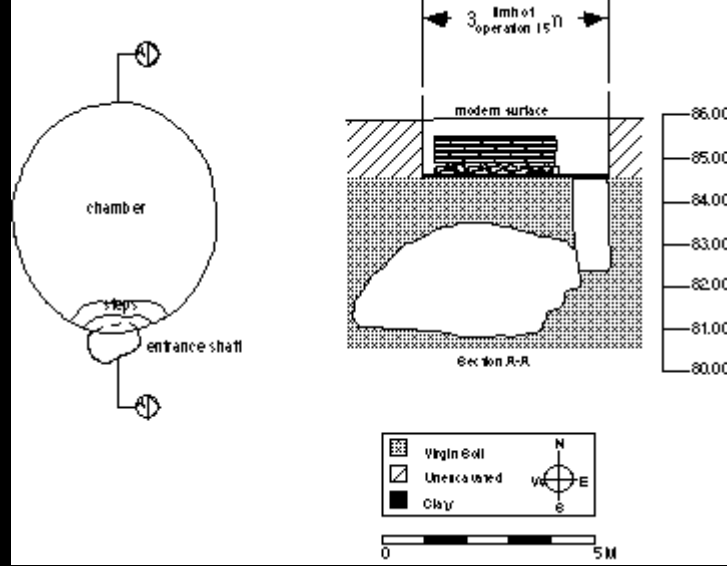

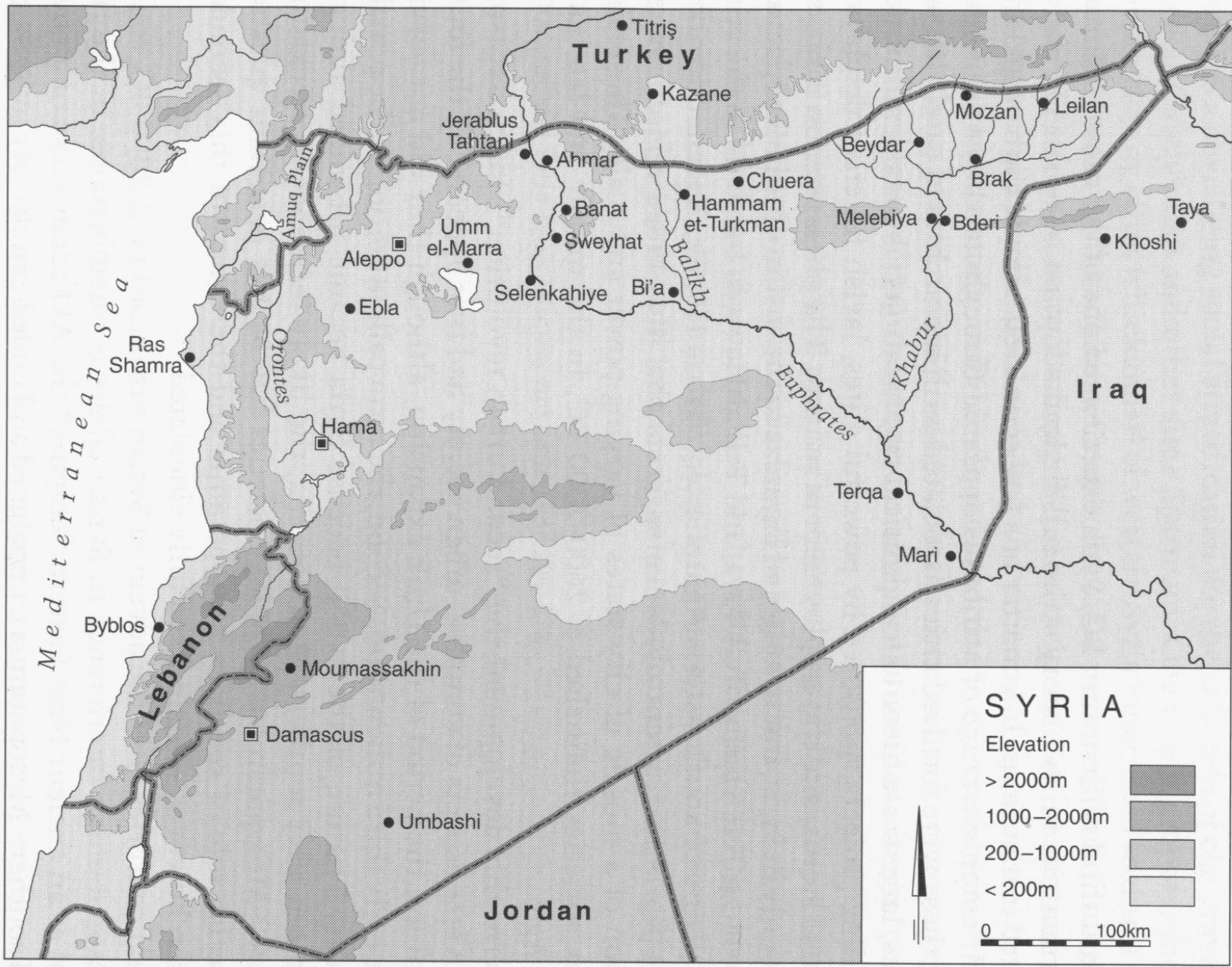

Turkey

Iraq

Lebanon

Jordan

Mediterranean Sea

Titriş

Kazane

Jerablus Tahtani

Ahmar

Beydar

Mozan

Leilan

Chuera

Brak

Banat

Hammam et-Turkman

Melebiya

Bderi

Taya

Aleppo

Umm el-Marra

Sweyhat

Selenkahiye

Bi'a

Khoshi

Ebla

Ras Shamra

Hama

Terqa

Mari

Byblos

Moumassakhin

Damascus

Umbashi

Amuq Plain

Orontes

Balikh

Euphrates

Khabur



UMM EL-MARRA



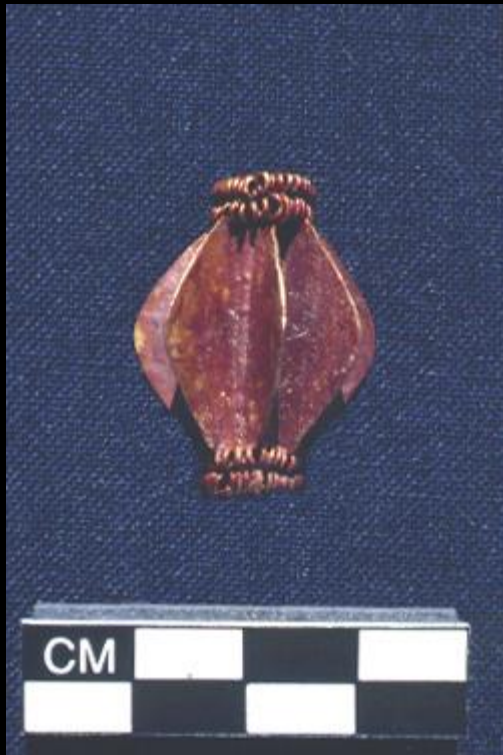

TELL BANAT – TOMB 7 (top)
THE WHITE MONUMENT (bottom) ca. 2600-2450 BC

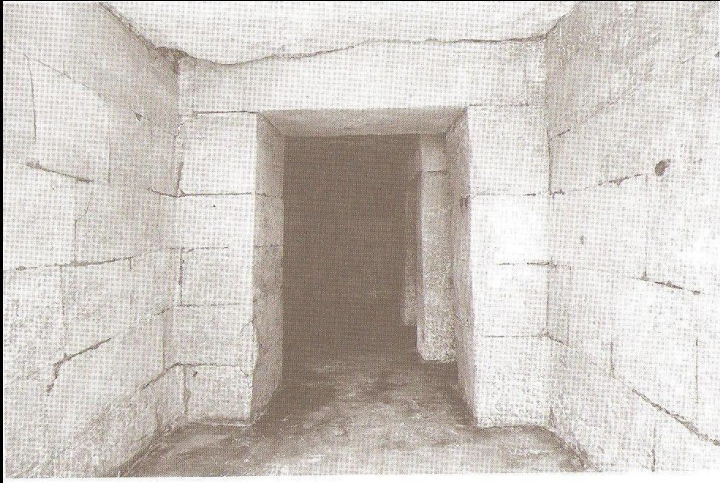
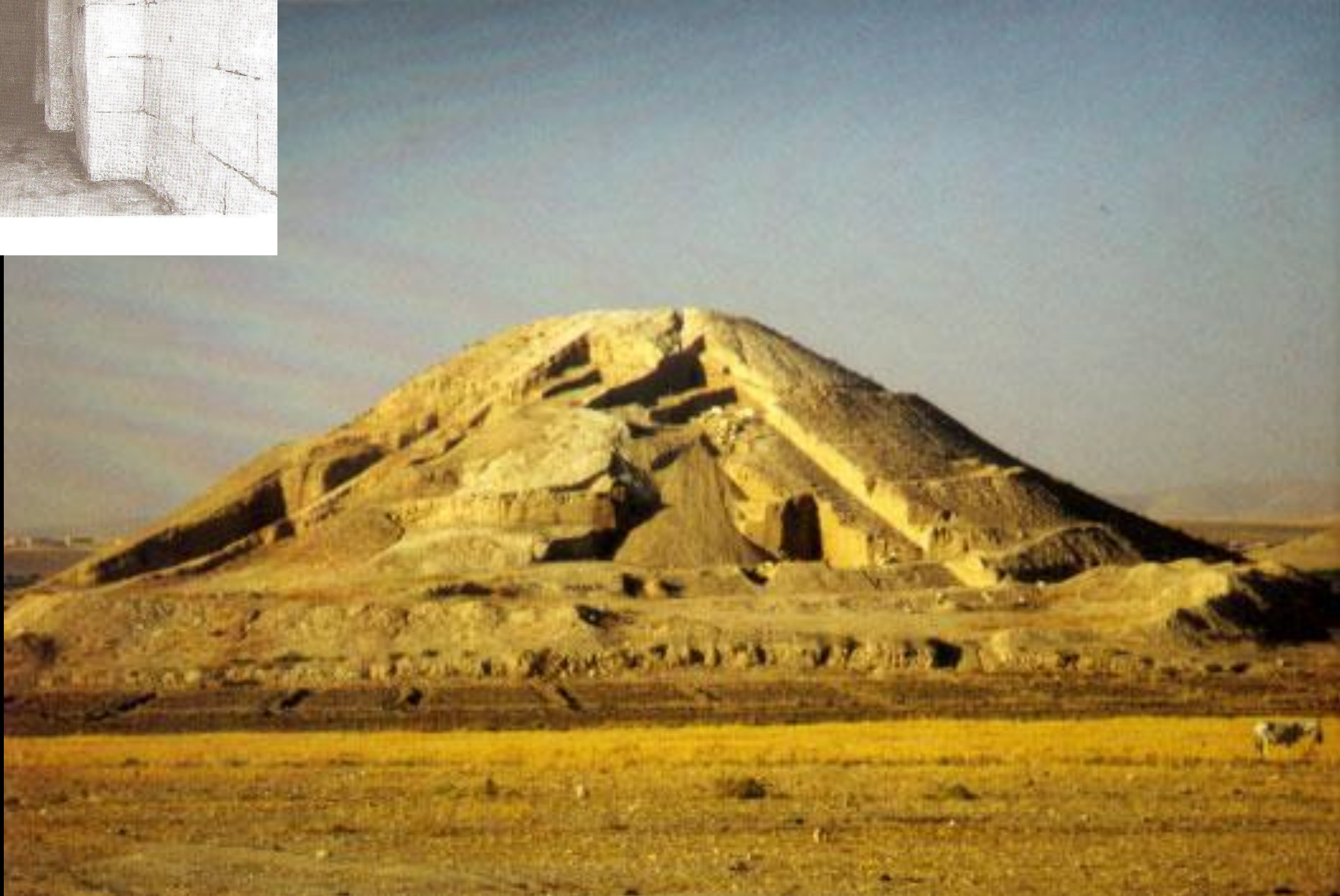
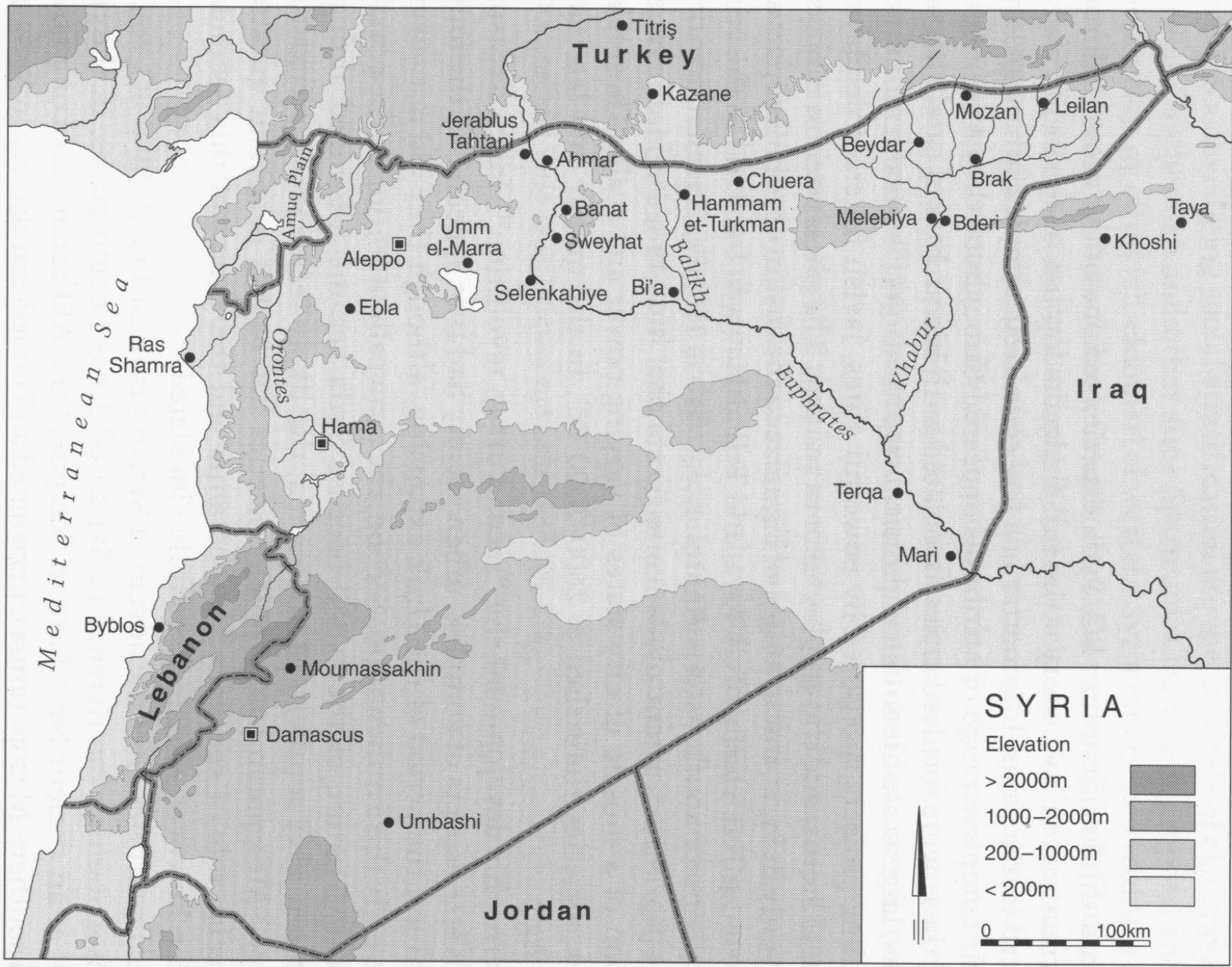

Fig. 8.11 Banat, tomb 7.





Turkey

Iraq

Lebanon

Jordan

Mediterranean Sea

Titriş

Kazane

Jerablus Tahtani

Ahmar

Banat

Sweyhat

Aleppo

Ebla

Umm el-Marra

Selenkahiye

Bi'a

Chuera

Hammam et-Turkman

Melebiya

Brak

Bderi

Taya

Khoshi

Mozan

Leilan

Beydar

Amuq Plain

Orontes

Hama

Euphrates

Khabur

Terqa

Mari

Byblos

Moumassakhin

Damascus

Umbashi

EBLA

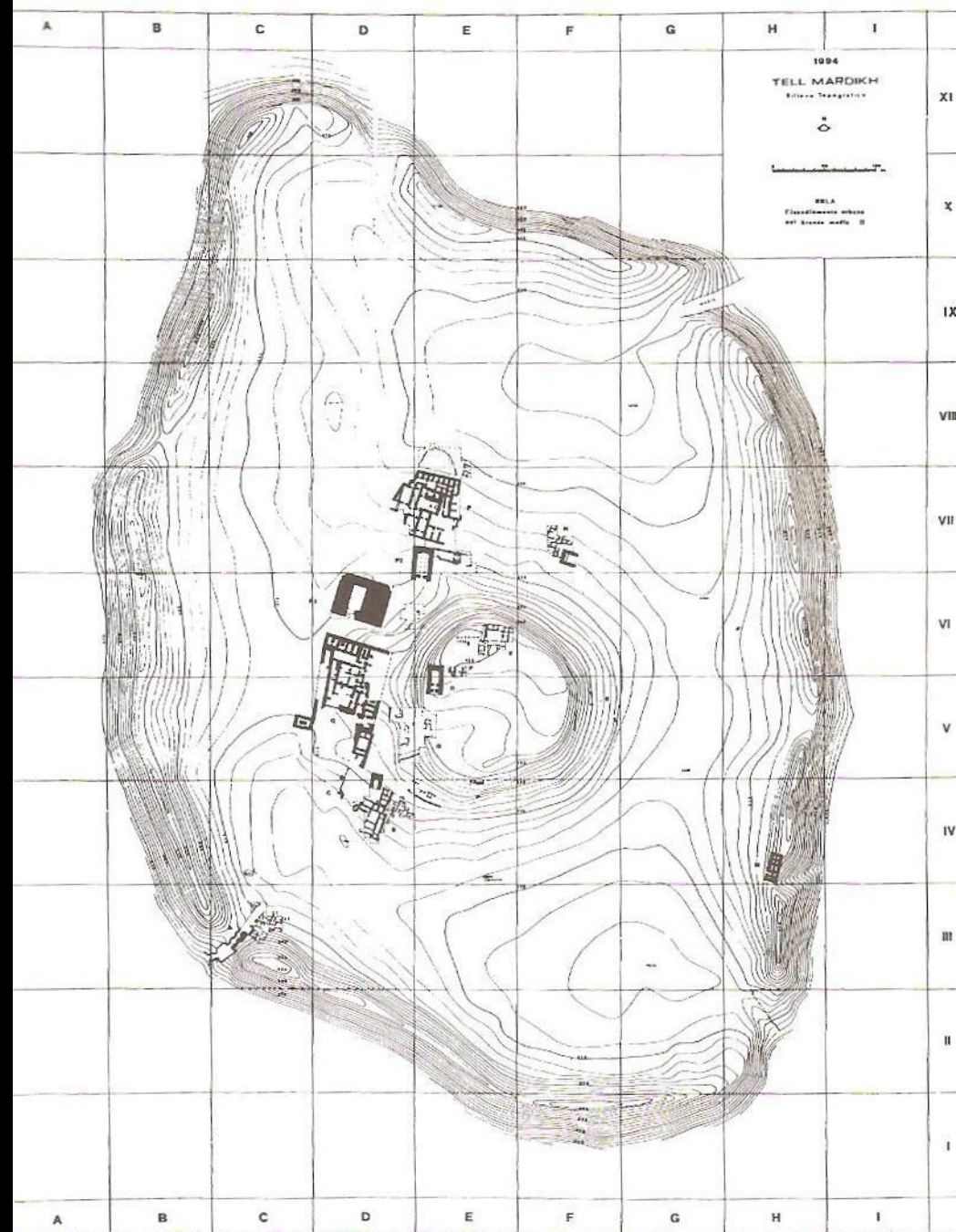

Fig. 9.5 Ebla; note thick enclosure wall around site and acropolis

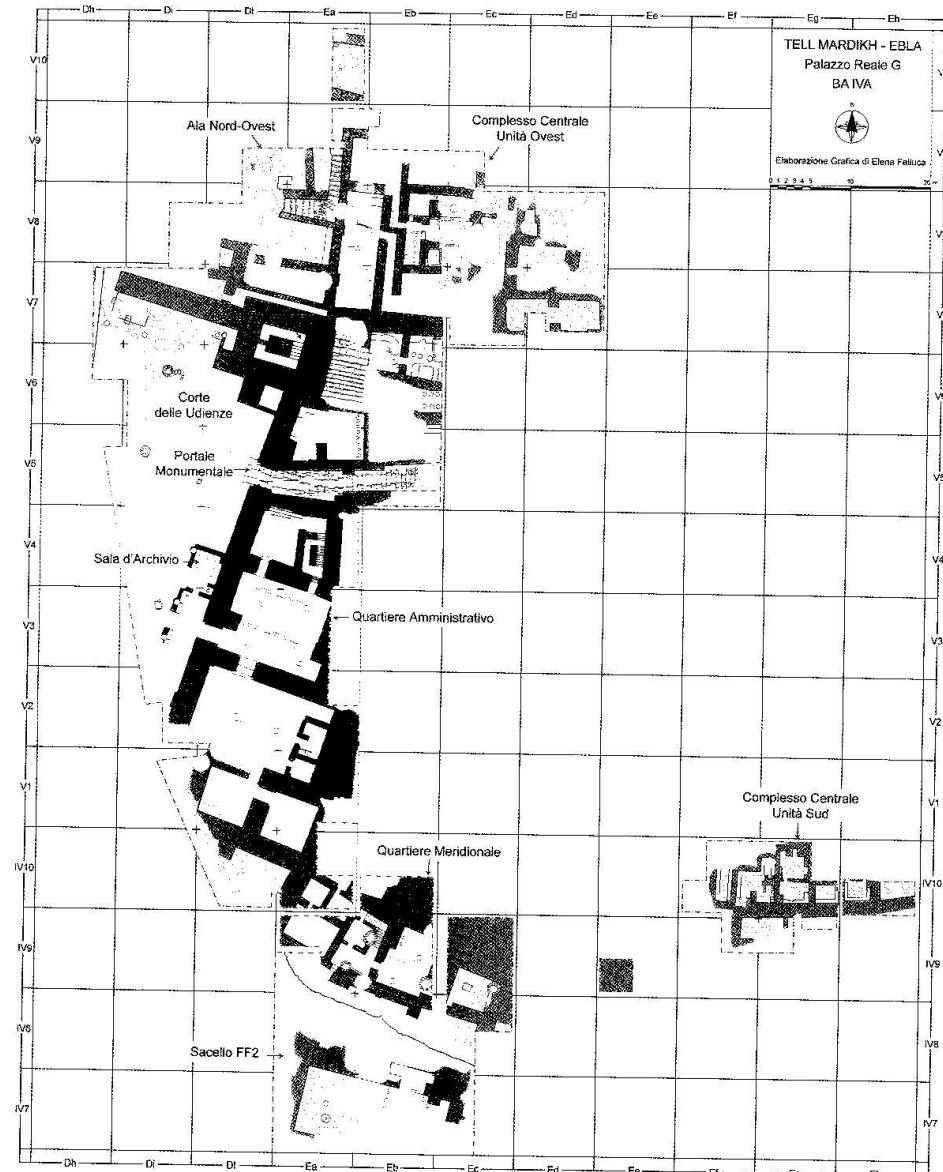

Fig. 69. Ebla, plan of the Royal Palace G, Early Bronze IVA

EBLA PALACE FROM THE 3RD MILLENNIUM

EBLA – PALACE G ca. 2350-2100 BC

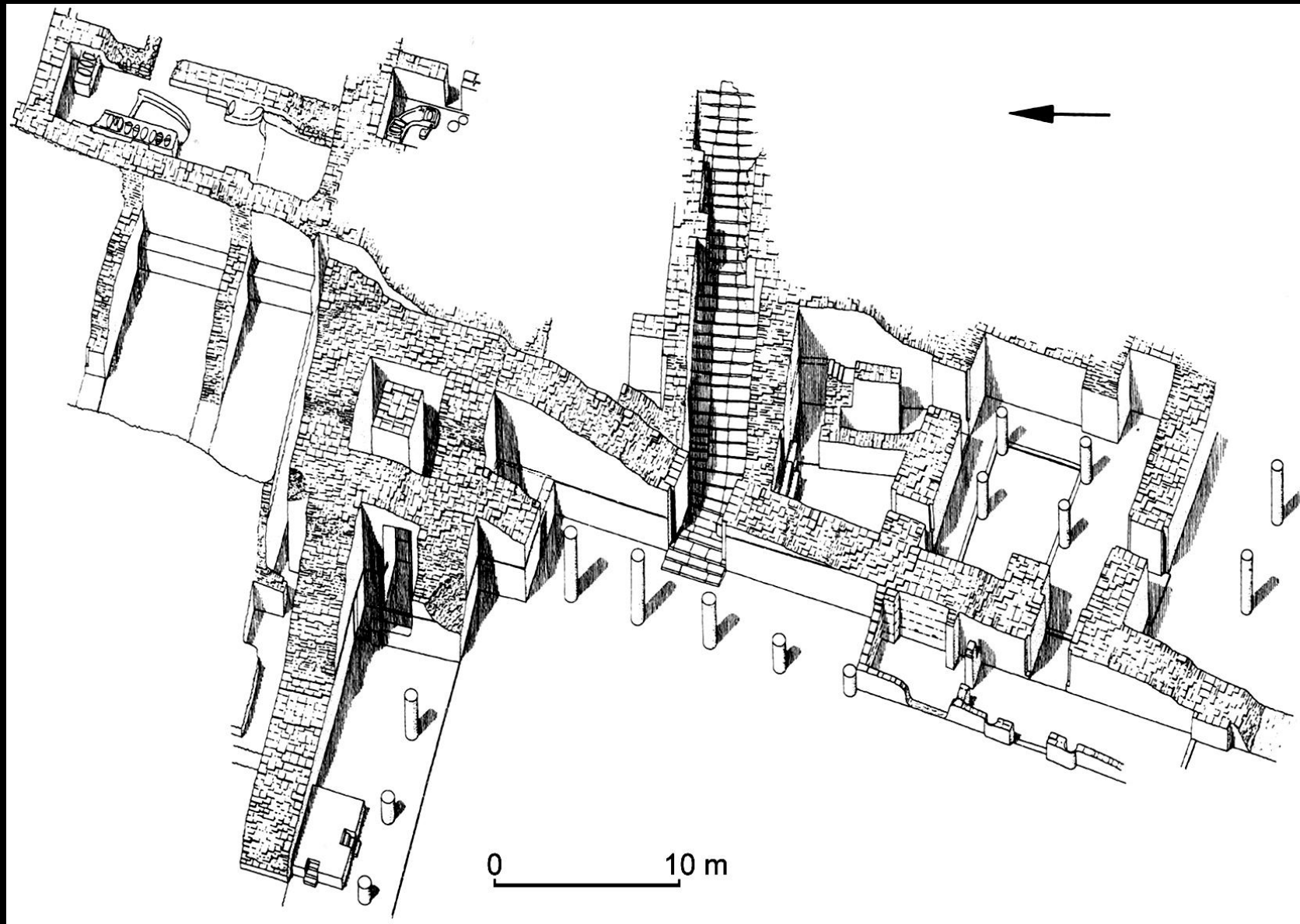



Fig. 71. Ebla, Royal Palace G, Court of Audience, the royal dais under the northern porch, from the east, Early Bronze IVA

Fig. 70. Ebla, Royal Palace G, the Monumental Gateway, from west, Early Bronze IVA

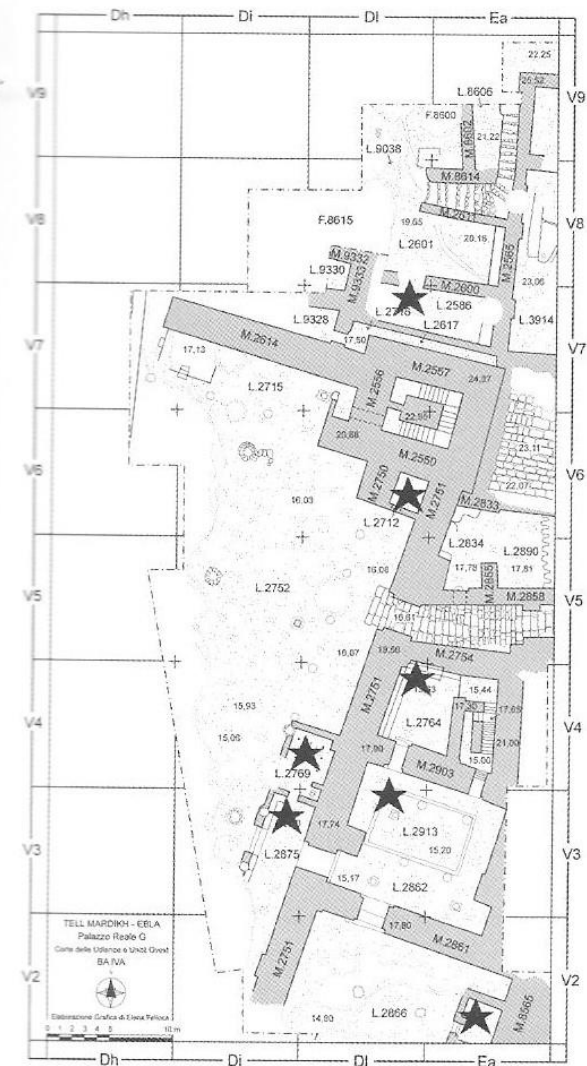

Fig. 72. Ebla, Royal Palace G, plan of the Administrative Quarter with the indication of the cuneiform archives rooms, Early Bronze IVA



Fig. 73. Ebla, Royal Palace G, Great Archive L.2769 with the cuneiform tablets in place against the northern and eastern walls, Early Bronze IVA

CUNEIFORM TABLETS ARCHIVE

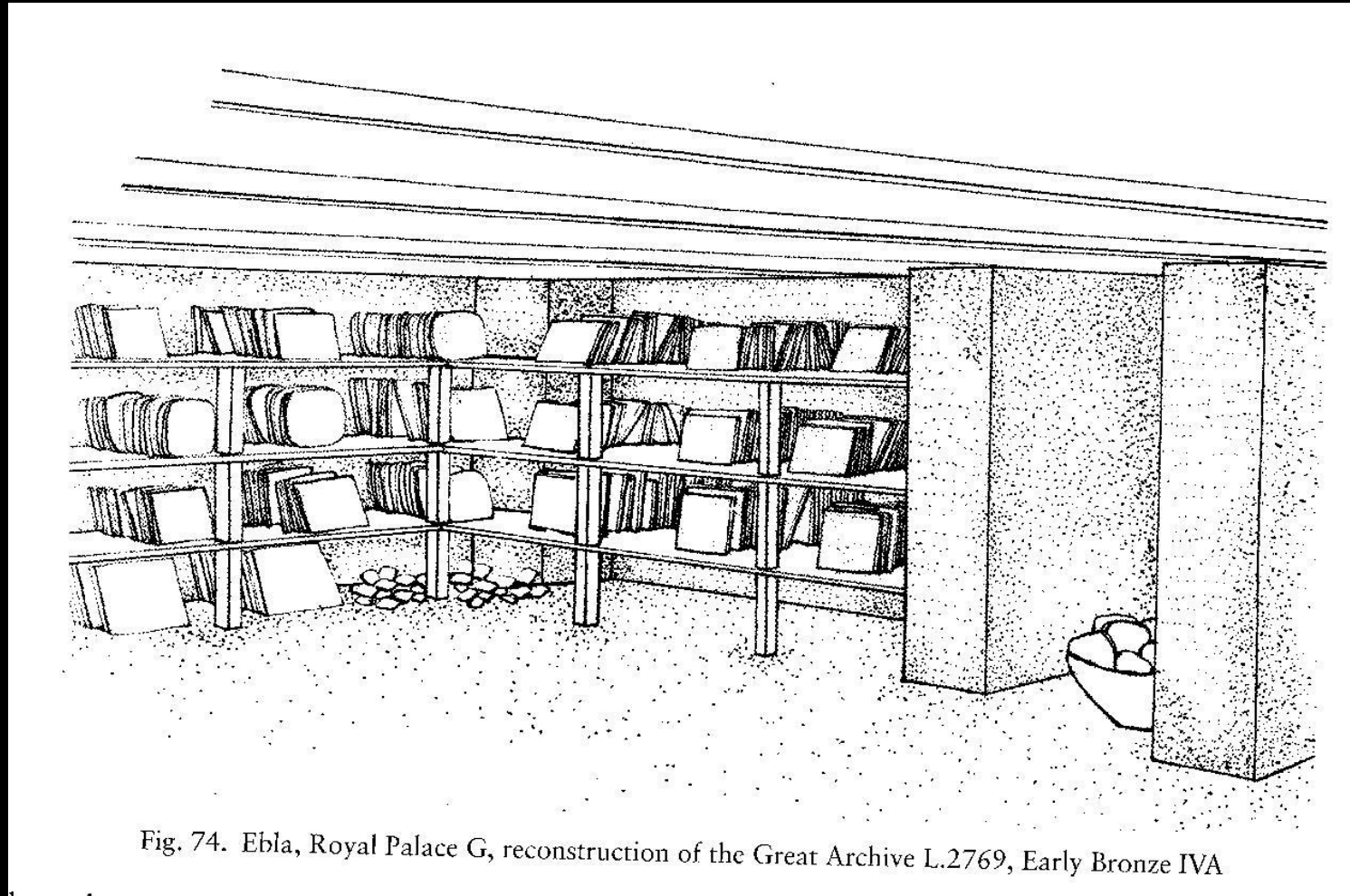

Fig. 74. Ebla, Royal Palace G, reconstruction of the Great Archive L.2769, Early Bronze IVA



EBLA: a bull with human face figurine from, fragment of mother-of –peral mosaïque depicting wa scenes

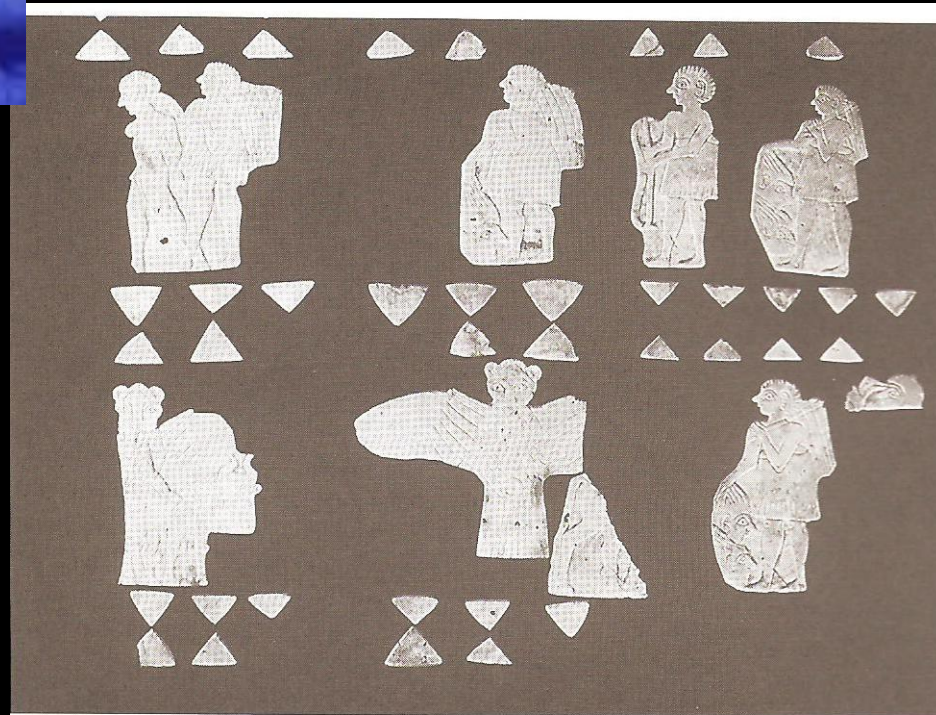
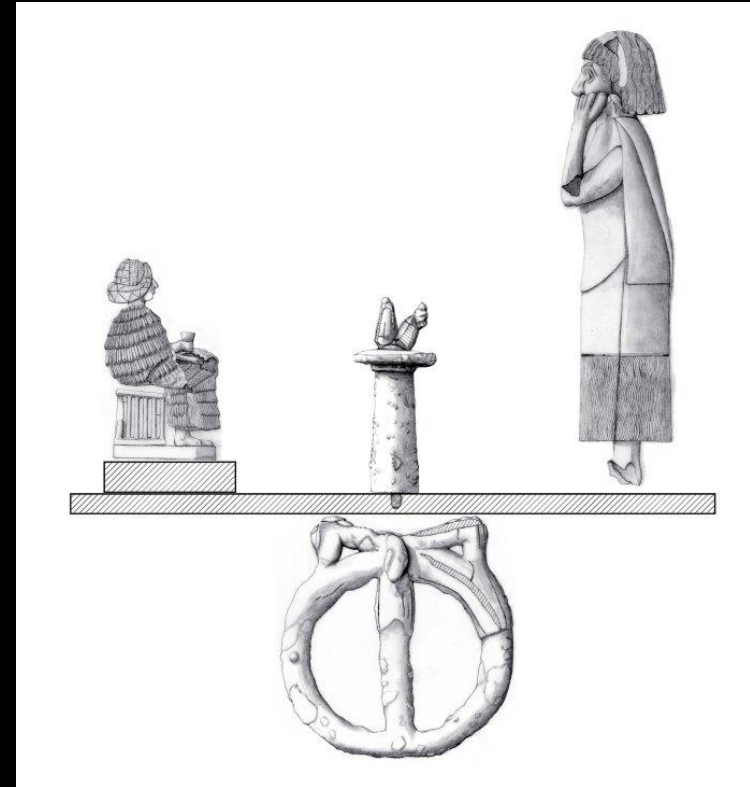

Fig. 8.6 Limestone inlays from the "Standard of Ebla."

ROYAL STANDARD FROM EBLA: QUEEN IN FRONT OF A GODDESS



EBLA 3rd mill. BC: lapis lazuli, gold from palatial workshops



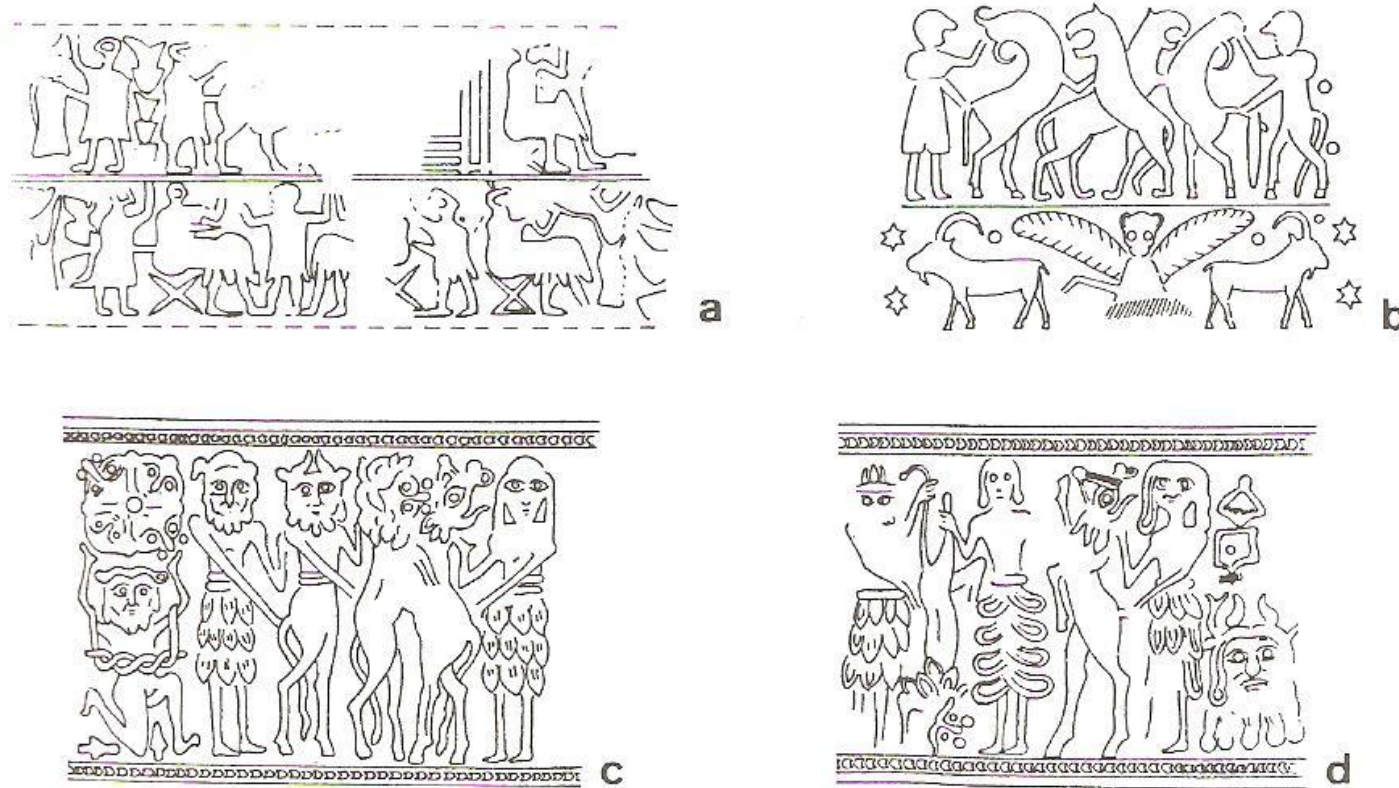

Fig. 8.7 Mid/late third-millennium BC cylinder seal art from Brak (a–b) and Ebla (c–d).

the practice. Noting that the relatively simple, linear sealings on the vessels