

Instalace serveru PostgreSQL

1. <https://www.enterprisedb.com/downloads/postgres-postgresql-downloads>
2. Zvolte verzi (10.10) a operační systém (co máte, standardně windows)
3. Spustíte instalaci

Nastavte si heslo, které si budete pamatovat

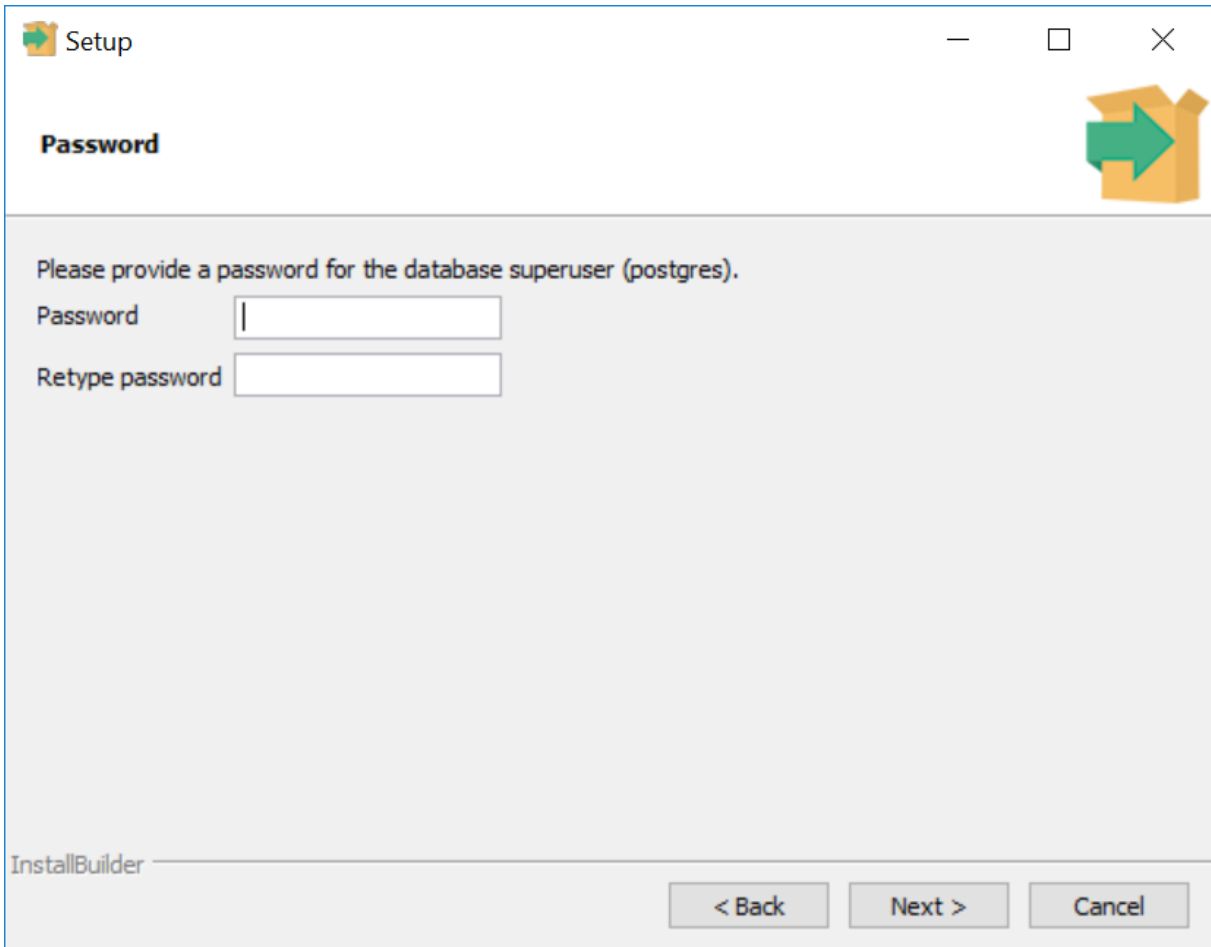

Setup

Password

Please provide a password for the database superuser (postgres).

Password

Retype password

InstallBuilder

< Back Next > Cancel

Port ponechte 5432

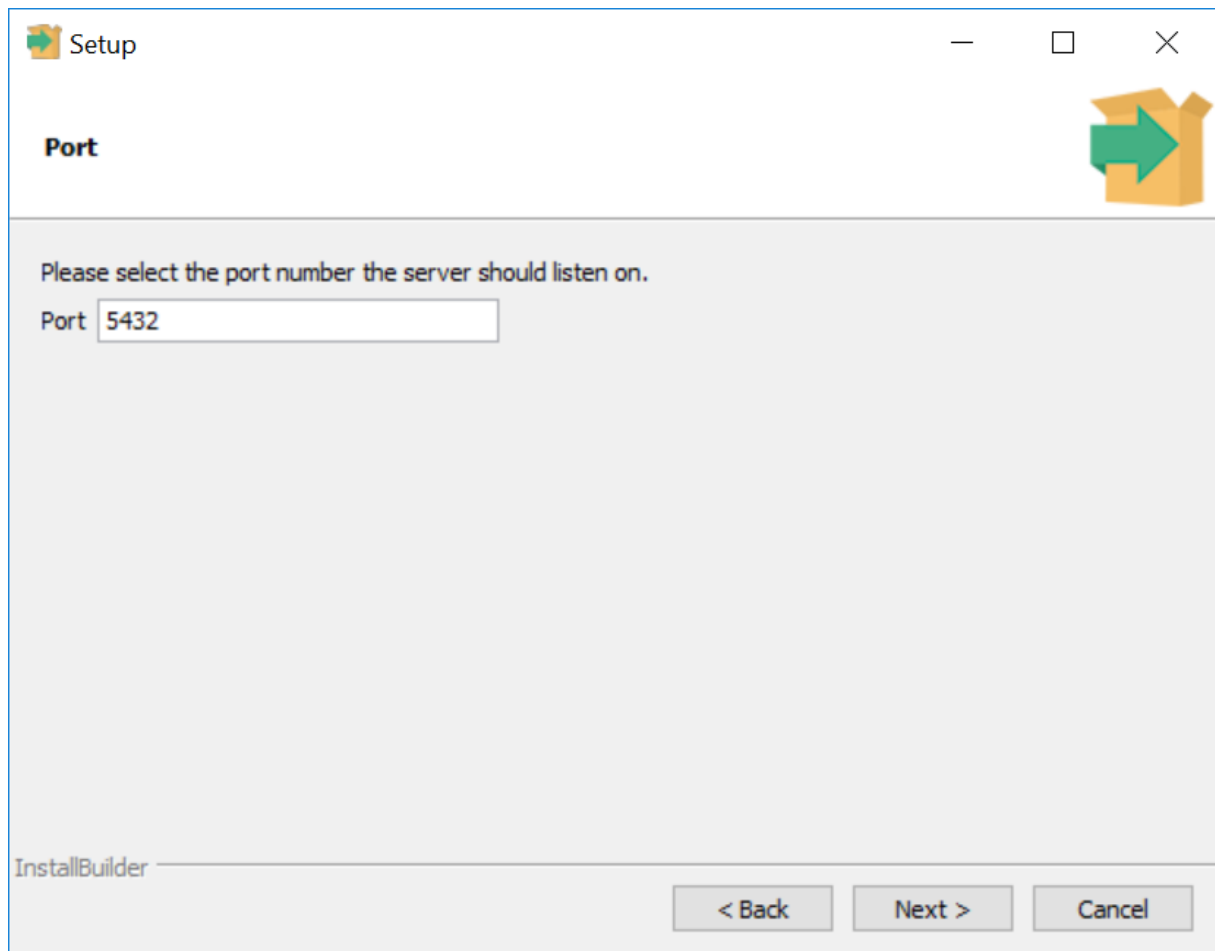

Národní prostředí nastavte na češtinu

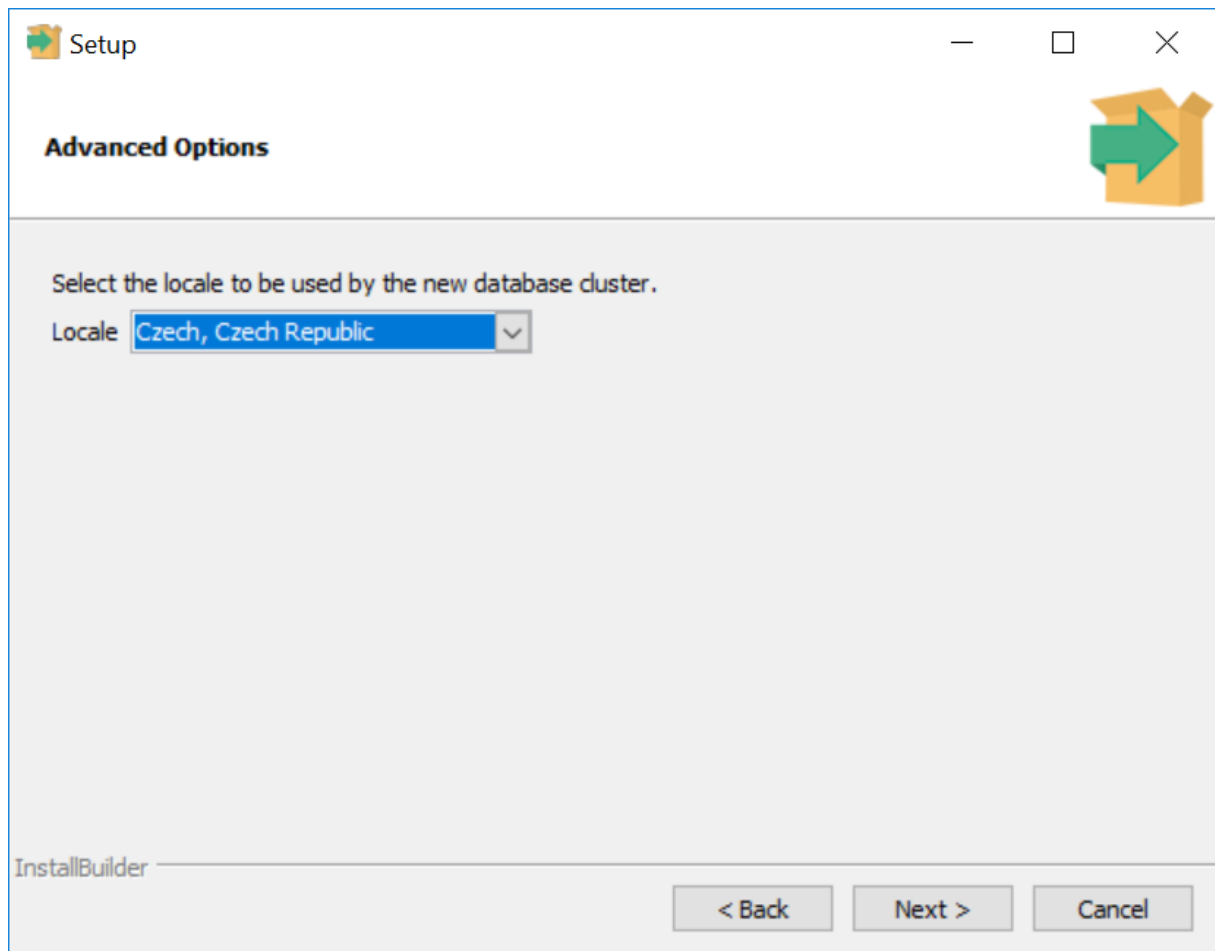

Instalace pgAdmin verze III

<https://www.bigsql.org/pgadmin3/>

Instalace DBeaver

<https://dbeaver.io/download/>

Community edition / nejnovější verze